

**SAFETY  
WARNING**

**SAFETY WARNING:** Failure to obey a safety warning may result in injury to you, to others, or to the product.

## OPERATING INSTRUCTIONS — SUPER-X MODEL 1

**CAUTION:** Always keep the muzzle pointed in a safe direction. Prior to using live ammunition familiarize yourself thoroughly with these operating instructions. Get accustomed to the feel of your new shotgun. Know the forces required to manually operate the bolt assembly, to pull the trigger and, above all, know the location and operation of the safety. See fig. 1 & 2.

**IMPORTANT:** Before assembling or firing your new Super-X Model 1 shotgun, thoroughly clean the interior of the barrel and chamber, removing all grease and other possible obstructions. Always relubricate according to instructions following cleaning.

**SAFETY:** Before assembling, disassembling, loading or unloading your shotgun, always push the safety (located in front of the trigger) to the "on safe" position. The red band marking will not show when shotgun is "on safe".

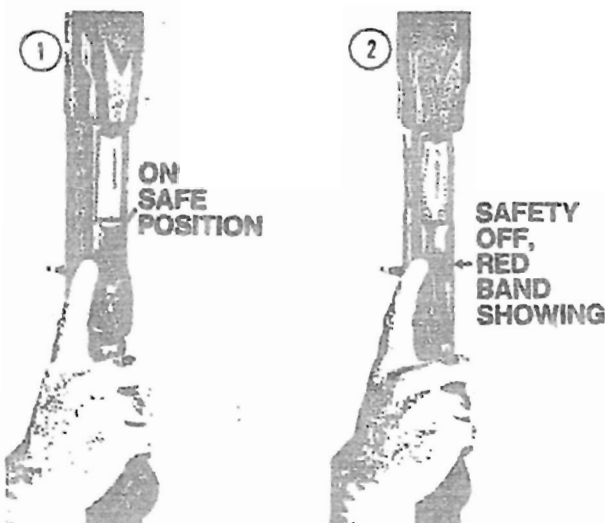

**NOTE:** The safety will only operate when the bolt assembly is opened or the hammer is in the "cocked" position.

The Super-X Model 1 shotgun is shipped with the safety assembled for right-hand shooters, but can be reversed for the left-hand shooter.

**LEFT-HAND SAFETY:** To change the safety from right- to left-hand, remove the trigger guard assembly. Cock the hammer and place the safety in the "on" position. Turn the safety 1/4 turn in either direction. A WORD OF WARNING; to rotate the safety more than a quarter turn when the safety is in the "off" position will lock the safety and

trigger mechanism and require the dismantling of the guard assembly to amend. With the safety turned, push the safety out the right side of the trigger guard.

Turn the safety around and with the plunger depressed surface (the W-shaped cut) down, insert the end with the red band back into the left side of the trigger guard. The safety plunger inside the trigger guard must be depressed with a small screwdriver or a similar tool to allow the safety to pass over the plunger and into position. Test the safety to make sure it is functioning correctly, then refit the guard assembly into the receiver.

You will find the safety quite difficult to turn and it would be best to have this conversion performed by a gunsmith.

### BARREL ASSEMBLY:

The barrel on your Super-X Model 1 shotgun is packed unattached from the receiver for added protection during shipment from the factory. To install the barrel, grasp the cocking handle and pull the bolt assembly all the way to the rear until the bolt locks in the open position.

**CAUTION:** Keep your fingers clear of the ejection port when closing the action. Do not allow the bolt assembly to slam forward when the barrel is not assembled to the receiver. Deformation of surfaces could occur, affecting the performance of your shotgun.

Whenever assembling your shotgun, be sure the safety is "on" and the gun is unloaded. Remove the forearm from the magazine tube by unscrewing the cap located at the forward end of the forearm.

**CAUTION:** Make sure the shotgun is pointed in a safe direction before removing the cap from the magazine. When the magazine cap is removed, the magazine spring is held in the tube by the friction of the magazine plug and if dislodged, the spring will fly out.



To assemble the barrel to the receiver, align the barrel bracket with the magazine tube and insert the barrel extension into the receiver<sup>5</sup>. Check the

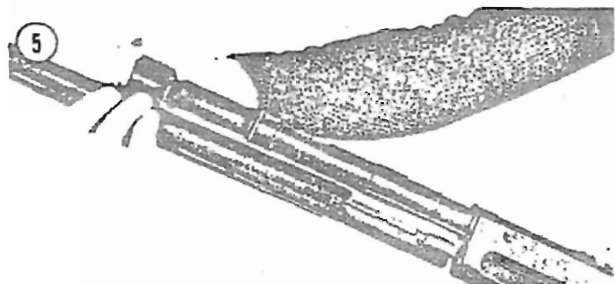

piston rod to make sure it is aligned with the hole in the gas shield and receiver<sup>6</sup>. Refer to the decal to make sure the piston and piston rod spring are properly oriented. When the barrel extension has been fully inserted into the receiver, slide the forearm back over the magazine tube and replace the magazine cap. The cap should be tightened securely by hand until there is no back and forth motion of the barrel or forearm.

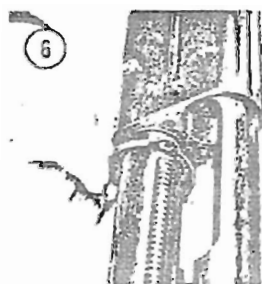

**BARREL REMOVAL:** Pull the bolt assembly back to the locked-open position, and push the safety to the "on safe" position. Remove the magazine cap and slide the forearm off the magazine tube. Pull the barrel forward and off the gun.

**LOADING THE CHAMBER:** Pull the cocking handle rearward to open the action then push the safety to the "on safe" position. Insert a shell through the ejection port<sup>7</sup> (right side of the receiver) and press the carrier release button to close the action<sup>8</sup>. The first shell is now chambered and ready for firing after releasing the safety.

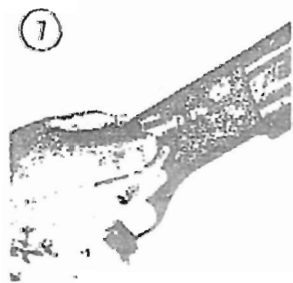

**LOADING THE MAGAZINE:** With the safety in the "on safe" position close the action with the carrier release button. With the carrier

release button depressed, push the shot shell upwards against the carrier<sup>9</sup> and forward into the magazine<sup>10</sup>. The carrier will remain free-floating while the carrier release button is depressed.



**NOTE:** When the carrier is pushed upward into the receiver and the carrier release button is released, the carrier will lock in the upward position for ease of loading. The carrier will drop to the locked-down position when the first shell is fired, or may be manually dropped by depressing the carrier release button.

Load each shell into the magazine, maintaining light pressure with the thumb on the carrier until the rim of the shell snaps past the cutoff. When the magazine has been loaded, release the carrier release button and the carrier will again latch down in the locked position. This assures more positive feeding.

Push the safety from the "on safe" position and the shotgun is ready for firing each time the trigger is pulled. When the last shell is chambered and fired, the action will remain open.

**UNLOADING THE SHOTGUN:** Push the safety to the "on safe" position and with the action closed, depress the carrier release but-

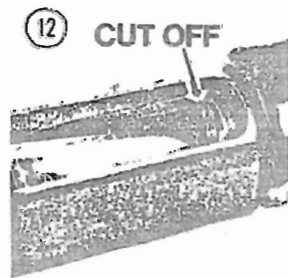

ton and push carrier upwards. When the carrier is fully depressed, the first shell in the magazine tube will release and slide rearward out of the shotgun<sup>11</sup>. To further unload the magazine the procedure of depressing the carrier may be repeated for each shell. As an alternate, by releasing the carrier release button with the carrier fully depressed, the carrier will remain in an upward position. Shells may then be unloaded from the magazine by pressing the cutoff located at the magazine tube opening on the inside wall of the receiver<sup>12</sup>.

## ASSEMBLY AND DISASSEMBLY INS

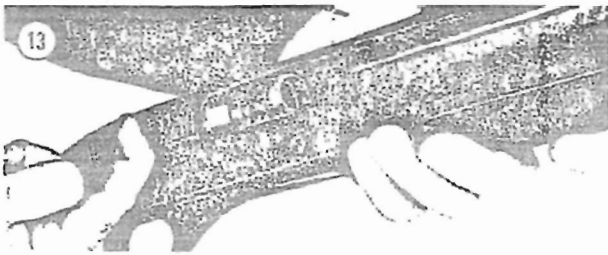

**WARNING:** When the magazine tube has been emptied, the action should be opened by pulling the cocking handle rearward and ejecting the shell from the chamber<sup>12</sup>. Always visually check to be sure your shotgun is completely unloaded before disassembling or storing.



**CAUTION:** Before disassembling your Super-X Model 1 shotgun make certain that the chamber and magazine tube do not contain live ammunition and that the safety is in the "on safe" position. If

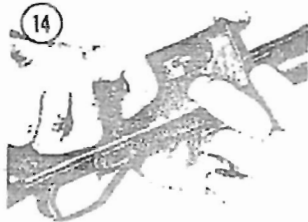

the barrel has been removed from the receiver and the instructions call for the bolt assembly to be closed, grasp the cocking handle prior to depressing the carrier release button and carefully allow the bolt assembly to go forward<sup>14</sup>.

**TRIGGER ASSEMBLY:** To remove the trigger guard assembly from the receiver, close the bolt assembly by depressing the carrier release button. Push out the trigger guard retaining pin from the left<sup>15</sup> (side opposite the ejection port). Grasp the trigger guard bow at the rear and pivot up and out of the receiver<sup>16</sup>. Further disassembly of the trigger guard group is not recommended.

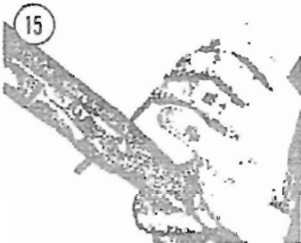

To reassemble the trigger guard assembly into the receiver, insert the front of the guard so that the



lugs on each side of the front of the trigger guard fit into the rails in the receiver<sup>17</sup>. Lower the rear of the trigger guard until the trigger guard retaining pin hole lines up with the holes in the receiver walls. Insert the trigger guard retaining pin from the right side (ejection port side) of the receiver. Push the pin into the receiver until it snaps firmly in place.

**BOLT ASSEMBLY:** In order to remove the bolt assembly from the receiver, close the action by depressing the carrier release button. With the shotgun inverted and the trigger assembly removed, depress the return spring follower<sup>18</sup> with a suitable tool and pivot the bolt slide link upwards. Remove the cocking handle by pulling it out of the bolt slide through the ejection port<sup>19</sup>.

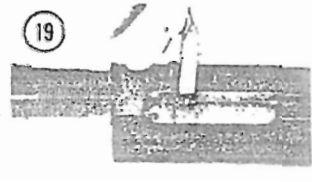
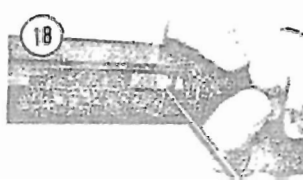

Using the bolt slide link draw the bolt assembly to the rear and lift<sup>20</sup> out of the receiver.

Further disassembly of the bolt assembly component is not recommended.

Before placing the breech bolt assembly back into the receiver check to make sure the locking bolt is in location linking the breech bolt to the breech bolt slide, and the bolt slide link pin does not protrude from the side of the bolt slide.

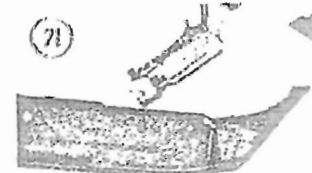

To reinsert the bolt assembly into the receiver, hold it in an inclined position with the bolt head extended<sup>21</sup>. Insert the assembly from the rear of the receiver and rest it on the notched shelf. Using the bolt slide link as a handle, pull the bolt assembly to the rear and allow it to drop through the notches. (Note: the assembly will not drop down if the link pin is protruding.) Push the bolt assembly to the fully forward position<sup>22</sup> and with a suitable tool, depress the return spring follower in the rear of the receiver. Insert the ball end of the link into its socket<sup>23</sup> and release. Push the cocking handle into the bolt slide through the ejection port, snapping it firmly into place.

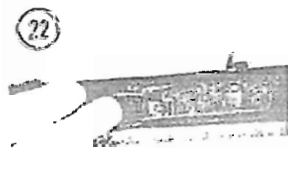

**GAS SYSTEM:** Remove the forearm and barrel from your shotgun as previously described. Make certain that the magazine tube plug is flush with or below the front opening of the magazine tube. Pull the piston sleeve to the rear of the magazine tube, exposing the gas seal and the "O" ring. Roll

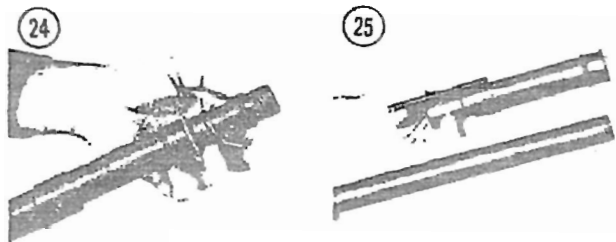

the "O" ring off the front of the magazine tube<sup>24</sup>. Remove the gas seal, and while holding the piston sleeve, piston rod, and piston rod spring, slide the unit forward and off the magazine tube<sup>25</sup>.

Holding the piston sleeve in the left-hand, rotate the piston head with the right-hand, camming the piston head retaining ring out of its seat in the piston sleeve. Remove the piston head from the piston sleeve<sup>26</sup>.

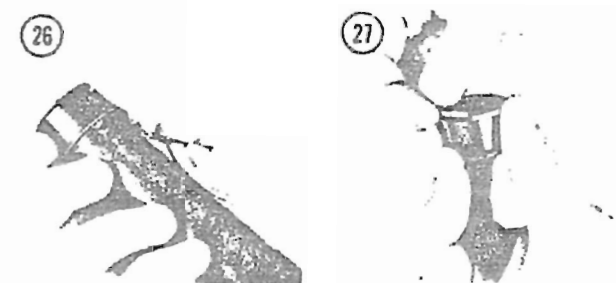

The inside piston ring is now loose and can drop out of the piston head. This inside piston ring is reversible and can be inserted into the rear of the piston head in either direction. The outside piston ring can be removed from the piston head by lifting one side of the ring out of the groove and working around the piston head until the complete ring is free<sup>27</sup>.

**CAUTION:** Do not bend or damage the ring during removal.



To reassemble, replace the outside piston ring in the groove of the piston head. The remaining components are assembled in the reverse order of disassembly.

Refer to the decal on the piston sleeve to properly orient the piston rod, piston rod spring, gas seal, and "O" ring<sup>28</sup>. Incorrect assembly could result in functioning deficiencies or damage to the gun. Be sure that the piston rod passes through the hole in the gas shield and into the receiver. The piston sleeve assembly will be properly located when the barrel is assembled to the gun.

**3 SHOT PLUG:** Your Super-X Model 1 is shipped from the factory with a 3-shot plug in the magazine tube. This plug limits the shell capacity of your shotgun to one in the chamber and two in the magazine in accordance with the Federal Migratory Waterfowl Law.

This plug may be removed to convert your Super-X Model 1 to its full five shot capacity.

To remove the 3 shot plug, disassemble the barrel, forearm cap, and forearm. **Carefully pull out the magazine tube plug from the front of the magazine tube<sup>29</sup>.**

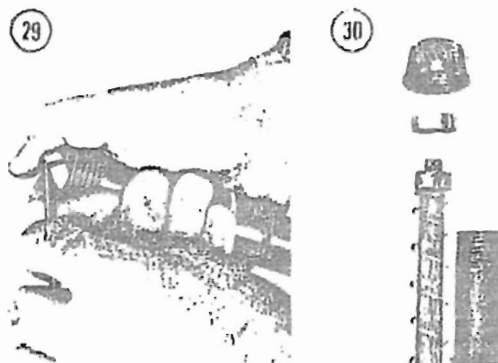

**CAUTION:** Care should be exercised to insure that the magazine tube plug and 3-shot wooden plug do not forcefully escape as they are under compression from the magazine spring. Failure to observe this caution could cause damage or personal injury.

To replace the 3-shot plug follow the above procedure in reverse order<sup>30</sup>.

## CLEANING AND LUBRICATION INSTRUCTIONS

The Super-X Model 1 has been designed and manufactured to provide you with the reliability and endurance that you want in a shotgun. TO INSURE MAXIMUM PERFORMANCE AND CONTINUED SATISFACTION WITH YOUR SHOTGUN, PERIODIC CLEANING AND LUBRICATION ARE ESSENTIAL.

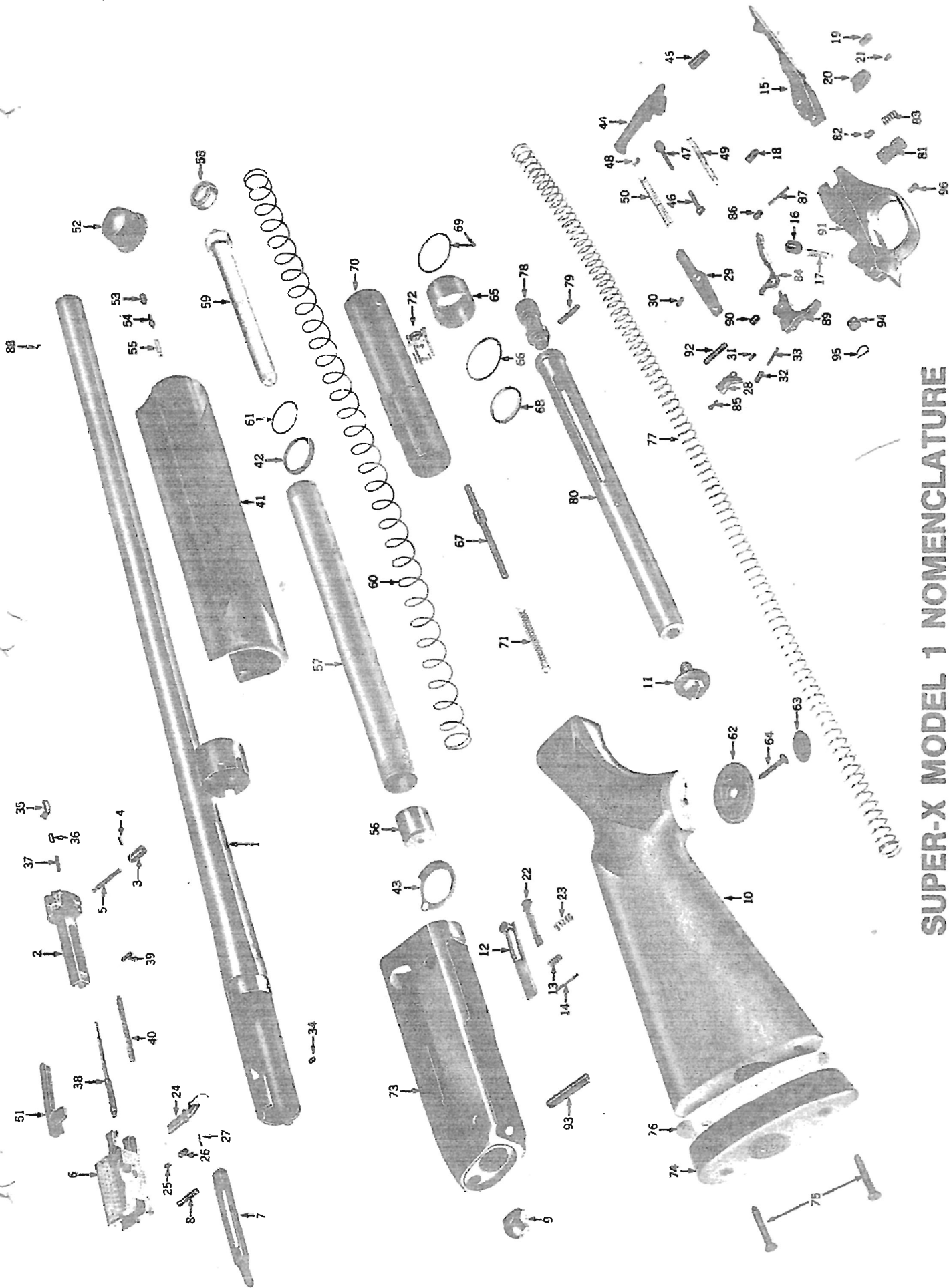

# SUPER-X MODEL 1 NOMENCLATURE

Parts may be ordered directly from Winchester Product Service Dept. Please specify part number, part name, serial #., gauge, chamber length, and grade (i.e., Trap, Skeet, Field, V.R., etc.).

Reference Number	Part Description	Reference Number	Part Description	Reference Number	Part Description
1	Barrel	33	Disconnector Spring	65	Piston Head
* 2	Breech Bolt	34	Ejector	66	Piston Head Retaining Ring
3	Breech Bolt Beard	35	Extractor	67	Piston Rod
4	Breech Bolt Beard Retaining Pin	36	Extractor Plunger	68	Piston Ring — Inside
5	Breech Bolt Beard Spring	37	Extractor Spring	69	Piston Ring — Outside
* 6	Bolt Slide	38	Firing Pin	70	Piston Sleeve
7	Bolt Slide Link	39	Firing Pin Retaining Pin	71	Piston Rod Spring
8	Bolt Slide Link Pin	40	Firing Pin Spring	72	Piston Sleeve Assembling Decal
9	Bolt Slide Buffer	41	Forearm	** 73	Receiver
10	Buttstock	42	Gas Seal	74	Recoil Pad
11	Buttstock Bolt	43	Gas Shield	75	Recoil Pad Screw
12	Carrier Release	44	Hammer	76	Recoil Pad Spacer
13	Carrier Release Spring	45	Hammer Bushing	77	Return Spring
14	Carrier Release Pin	46	Hammer Spring Guide — Outside	78	Return Spring Follower
15	Carrier	47	Hammer Spring Guide — Inside	79	Return Spring Follower Pin
16	Carrier Plunger	48	Hammer Spring Guide — Inside - Rivet	80	Return Spring Tube
17	Carrier Plunger Spring	49	Hammer Spring — Inside	81	Safety
18	Carrier Pin — Left	50	Hammer Spring — Outside	82	Safety Plunger
19	Carrier Pin — Right	* 51	Locking Bolt	83	Safety Plunger Spring
† 20	Carrier Pawl	52	Magazine Cap	† 84	Sear
21	Carrier Pawl Rivet	53	Magazine Cap Retaining Body	85	Sear Screw
22	Cutoff	54	Magazine Cap Retaining Plunger	86	Sear Plunger
23	Cutoff Spring	55	Magazine Cap Retainer Spring	87	Sear Spring
24	Cocking Handle	56	Magazine Follower	88	Sight — Front
25	Cocking Handle Retainer	57	Magazine Tube	89	Trigger
26	Cocking Handle Retainer Spring	58	Magazine Tube Plug	90	Trigger Bushing
27	Cocking Handle Retainer Spring Pin	59	Magazine Plug — 3 Shot	91	Trigger Guard
28	Disconnector	60	Magazine Spring	92	Trigger Pin
29	Disconnector Lever	61	O-Ring	93	Trigger Guard Pin
30	Disconnector Lever Pin	62	Pistol Grip Cap	94	Trigger Guard Pin Bushing
31	Disconnector Pin	63	Pistol Grip Cap Insert	95	Trigger Guard Pin Retaining Spring
32	Disconnector Plunger	64	Pistol Grip Cap Screw	96	Trigger Guard Bushing

\* Sold only to gunsmiths who have executed an agreement with us — otherwise for factory installation only.

\*\* Sold for factory installation only — return complete firearm.

† Not sold to consumers. Installation must be made by a gunsmith. Orders from dealers and distributors will be accepted on the understanding that the parts will be fitted by a gunsmith.