

N.	COD. NO.	Q.ty	PART
1	220001	1	FRAME CAL. 38 SP
2	A200002	1	HAMMER ASS.
3	222003	1	BARREL 24 1/4 Cal. 38 SP
7	220007	1	CARRIER BLOCK Cal. 38 SP
10	200010	1	TRIGGER
15	202015	1	SIGHT
19	200019	1	TRIGGER SPRING
20	200020	1	MAIN SPRING
36	200036	1	MAIN SPRING SCREW
55	A238055	1	REAR ASS.
57	202057	1	BUTT STOCK
58	202058	1	BUTT PLATE
62	200062	2	BUTT PLATE SCREW
63	200063	1	TANG SCREW
67	200067	1	FIRING PIN EXTENSION
68	202068	1	FOREND
72	200072	1	CAM LEVER
73	220073	1	RIGHT SIDE PLATE
74	200074	1	LEFT SIDE PLATE
79	220079	1	EXTRACTOR Cal. 38 SP
83	220083	1	RIGHT REAR LINK
84	220084	1	LEFT REAR LINK
85	220085	1	RIGHT FRONT LINK
86	220086	1	LEFT FRONT LINK
89	200089	1	LEVER
90	200090	1	LIFTER ARM
92	200092	1	RIGHT LEVER SPRING
93	200093	1	LEFT LEVER SPRING
95	070016	1	FIRING PIN SPRING
96	232096	1	MAGAZINE SPRING
97	230097	1	BREECH BLOCK Cal. 38 SP
98	220098	1	FIRING PIN
99	200099	1	TRIGGER PIN
100	200100	1	HAMMER PIN SCREW
101	200101	1	LEVER SCREW
104	200104	1	FIRING PIN STOP
105	200105	2	REAR LINK PIN
106	200106	2	LINK PIN
107	200107	1	LEVER PINK

N.	COD. NO.	Q.ty	PART
108	220108	1	EXTRACTOR PIN Cal. 38 SP
109	200109	1	CAM LEVER PIN
112	200112	1	HAMMER LINK PIN
113	220113	1	MAGAZINE FOLLOWER Cal. 38 SP
114	230114	1	MAGAZINE TUBE PLUNG
115	200115	1	HAMMER LINK
118	232118	1	MAGAZINE TUBE
123	200123	1	SIDE PLATE SCREW
124	200124	2	LEVER SPRING SCREW
127	220127	1	LADLE
128	220128	1	LADLE SCREW
216	202216	1	FOREND PROTECTION
225	202225	1	FOREND PROTECTION BEARING
237	200237	1	LEVER HOOK SPRING
239	238062	1	TRIGGERGUARD SCREW
263	200263	1	TRIGGER SPRING SCREW
275	202275	1	MAGAZINE TUBE BEARING
281	202281	1	MAGAZINE TUBE BEARING PIN
283	202283	2	FOREND PROTECTION SCREW
542	200542	1	HOOK LEVER
552	000035	1	HOOK LEVER SPRING SCREW
ALTERNATIVES			
1	230001	1	FRAME .44/40 - 45Colt.
1	209001	1	FRAME .22
3	229003	1	BARREL 24 1/4 Cal. 45 colt.
3	232003	1	BARREL 24 1/4 Cal. 44-40
3	202003	1	BARREL 24 1/4 Cal. 22 LR
3	212003	1	BARREL 24 1/4 Cal. 22 MAG.
7	230007	1	CARRIER BLOCK .44/40 - 45 colt.
7	200007	1	CARRIER BLOCK .22
79	230079	1	EXTRACTOR .44/40 - 45 colt.
79	200079	1	EXTRACTOR .22
97	230097	1	BREECH BLOCK .44/40 - 45 colt.
108	230108	1	EXTRACTOR PIN .44/40 - 45 colt.
113	230113	1	MAGAZINE FOLLOWER .44/40 - colt.
113	202113	1	MAGAZINE FOLLOWER .22
118	202118	1	MAGAZINE TUBE .22



A. Uberti srl

Via Artigiani, 1
Gardone V.T. (Brescia) - ITALY

Instruction Manual

1866 MODEL SPORTING RIFLE AND CARBINE

TO LOAD THE FIREARM

(1) Turn the lever locking latch to the release position. Releasing the latch should allow the lever to go down approximately 1/2". Do not push the loading lever forward. (Photos 1 A- 1 B).

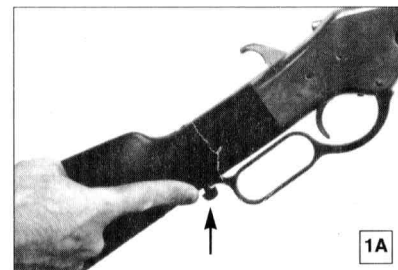

(2) Load the tubular magazine by pressing the cartridge into the ladle, which is located on the right side of the receiver. Push the cartridge forward and insert it into the tubular magazine (Photo 2).

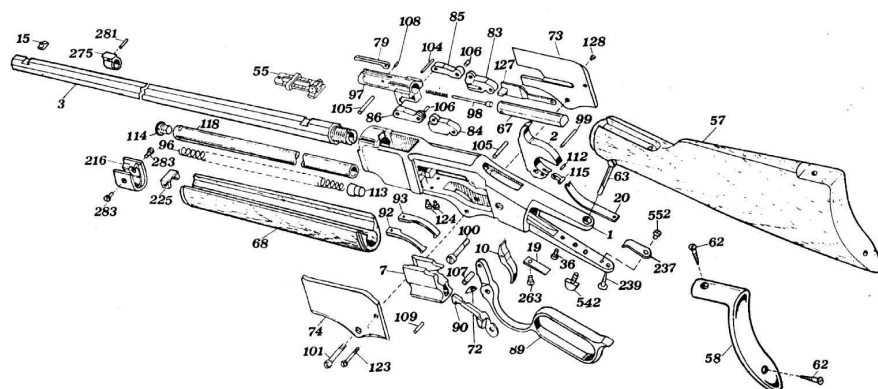

When loading cartridges through the ladle, leave the rim of each cartridge protruding sufficiently to hold the ladle open. When loading the last cartridge, insert it fully into the magazine thereby allowing the ladle to close. For optimum reliability, only load 10 cartridges in the 24" rifle and 8 cartridges in the 19" carbine. Overloading the magazine may result in improper feeding.

3) When you are ready to actually fire the firearm, the loading lever is pushed forward as far as it will go and is then pulled straight back. Your finger should not touch the trigger while manipulating the loading lever. (Photo 3)



The rifle will now be fully cocked and will fire when the trigger is pulled. If the lever does not go forward, release the loading lever latch by turning the small knob perpendicular to the rifle.

(4) After you have fired the first shot, the next cartridge is loaded by repeating step 3.

UNLOADING THE FIREARM

(5) With the firearm pointed in a safe direction, place your fingers through the rear portion of the loading lever. Be sure your first and second fingers are inside the lever loop. **DO NOT TOUCH THE TRIGGER**, depressing or touching the trigger, **EVEN WHEN THE LEVER IS FULLY OPEN OR PARTIALLY CLOSED**, may cause the gun to accidentally discharge and cause serious injury or death to you or anyone in the line of fire of the rifle. Then push the lever straight forward and then pull it back. The cartridge that was in the chamber should be automatically ejected by the firearm and another cartridge from the magazine will be automatically loaded into the firearm (Photo 4).



(6) Repeat step 5 until all cartridges have been ejected from the firearm. After all cartridges have been ejected, cycle the action four or five more times as described in step 5 as an added precaution to assure that all rounds were ejected.

(7) After step 6, move the loading lever to the forward position while visually inspecting both the chamber and the carrier block, to confirm that no cartridges are still in the firearm.

(8) Pull the loading lever to the rear and, with your thumb on the hammer, pull the trigger and with your thumb slowly lower the hammer.

SPECIAL SAFETY INSTRUCTIONS

- 1) Uberti lever action rifles should never be carried with a cartridge in the chamber.
 - 2) Carrying this style of rifle with a cartridge in the chamber can result in an accidental discharge if the firearm is accidentally dropped or if the hammer is struck.
 - 3) Due to the fact that in a tubular magazine rifle the cartridges are stacked in front of each other, only factory ammunition should be used.
 - 4) We recommend against using old ammunition in these rifles as primers, powder, and the brass cartridge cases can deteriorate and cause damage to the rifle or injury to the shooter or others.
 - 5) Uberti assumes no liability for incidents occurring through the use of reloaded ammunitions.
- Use **ONLY COMMERCIALY** loaded ammunitions that have been loaded in accordance with SAAMI-C.I.P. standards.

ONLY for lever rifle .22

Loading carbines and rifles .22 (after setting the gun into safety as per photos 1 A and 1 B).

The cartridges are introduced through the outside loader tube mouth, after removing the loader tube by rotating the checkered plug from left into right. The rifle must be head pointed away from your face and at an angle so that the cartridges slide slowly down the magazine.

After introduction of the cartridges by dropping, (for optimum reliability, only load max. 10 cartridges) the loading tube must be reset under pressure and relocked by rotating the plug from right to left.