

Owner's Manual Star Bonifacio Echeverria Model HK .22 LR Caliber Pistol

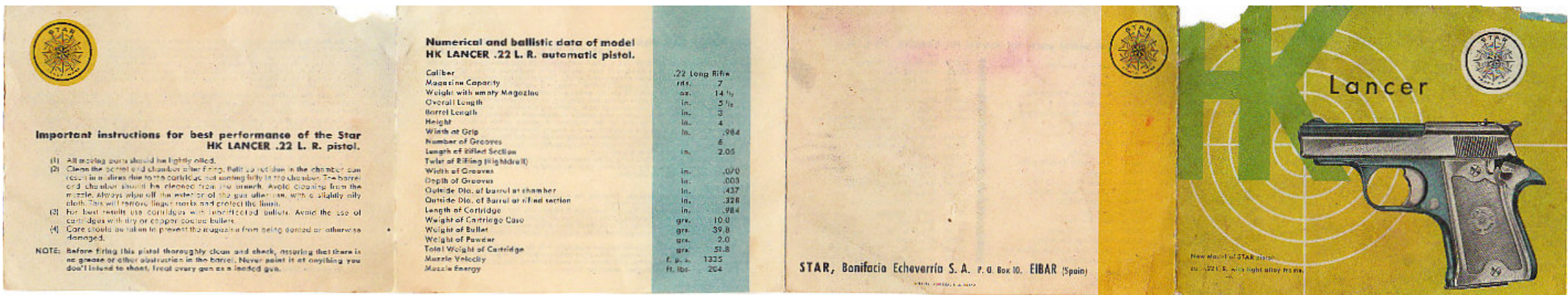

This manual was originally in a quad-fold format, printed front and back. To facilitate printing and reading on screen, it is presented below in two-page reader spreads formatted for legal-size paper.

The pages have been restored to be more legible and print better as well. The source document, in it's original format, is represented here:

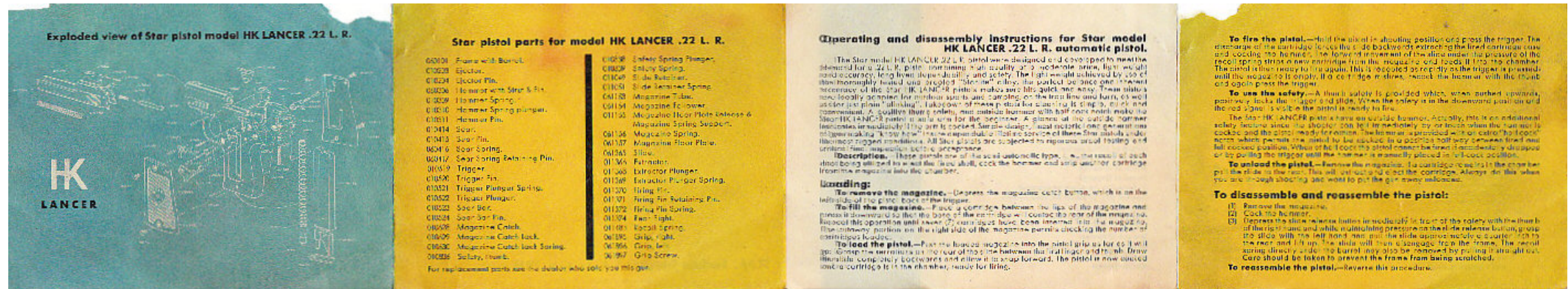



STAR, Bonifacio Echeverría S. A. P. O. Box 10. EIBAR (Spain)

IMPRESA INDUSTRIAL S. A. BILBAO

HK Lancer

New Model of STAR pistol
cal. .22 L.R. with light alloy frame.



Exploded view of Star pistol model HK LANCER .22 L. R.

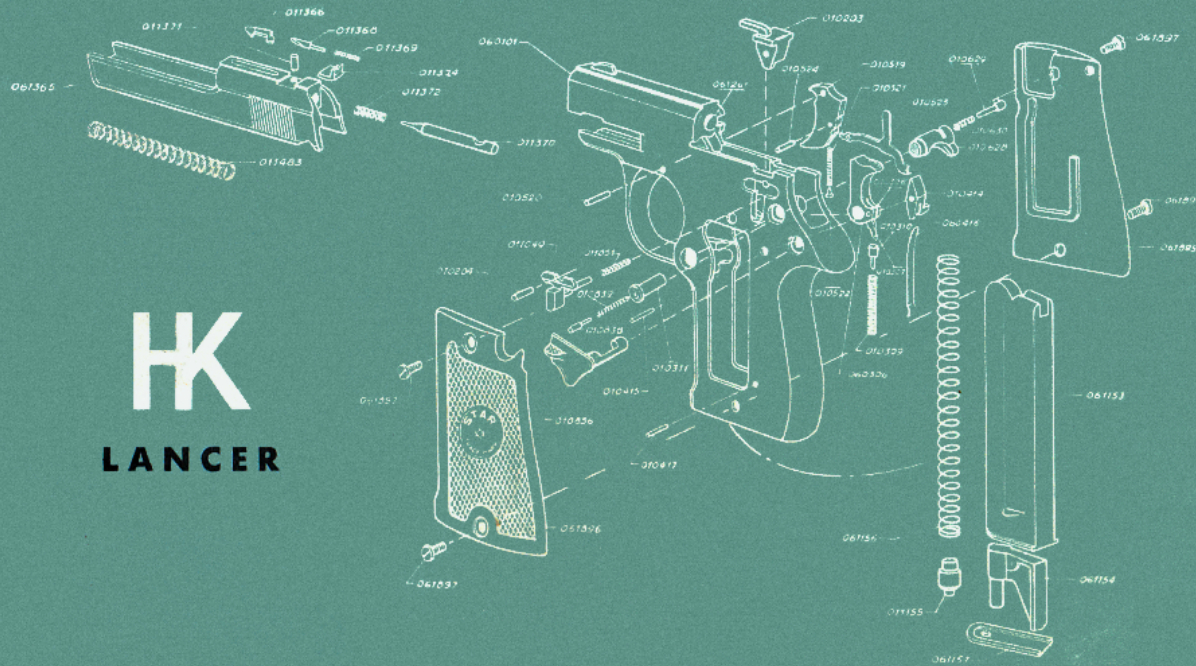

Star pistol parts for model HK LANCER .22 L. R.

- | | | | |
|--------|-----------------------------|--------|---|
| 060101 | Frame with Barrel. | 010838 | Safety Spring Plunger. |
| 010203 | Ejector. | 010839 | Safety Spring. |
| 010204 | Ejector Pin. | 011049 | Slide Retainer. |
| 060306 | Hammer with Strut & Pin. | 011051 | Slide Retainer Spring. |
| 010309 | Hammer Spring. | 061153 | Magazine Tube. |
| 010310 | Hammer Spring plunger. | 061154 | Magazine Follower. |
| 010311 | Hammer Pin. | 011155 | Magazine Floor Plate Release & Magazine Spring Support. |
| 010414 | Sear. | 061156 | Magazine Spring. |
| 010415 | Sear Pin. | 061157 | Magazine Floor Plate. |
| 060416 | Sear Spring. | 061365 | Slide. |
| 060417 | Sear Spring Retaining Pin. | 011366 | Extractor. |
| 010519 | Trigger. | 011368 | Extractor Plunger. |
| 010520 | Trigger Pin. | 011369 | Extractor Plunger Spring. |
| 010521 | Trigger Plunger Spring. | 011370 | Firing Pin. |
| 010522 | Trigger Plunger. | 011371 | Firing Pin Retaining Pin. |
| 010523 | Sear Bar. | 011372 | Firing Pin Spring. |
| 010524 | Sear Bar Pin. | 011374 | Rear Sight. |
| 010628 | Magazine Catch. | 011483 | Recoil Spring. |
| 010629 | Magazine Catch Lock. | 061895 | Grip, right. |
| 010630 | Magazine Catch Lock Spring. | 061896 | Grip, left. |
| 010836 | Safety, thumb. | 061897 | Grip Screw. |

For replacement parts see the dealer who sold you this gun.



Operating and disassembly instructions for Star model HK LANCER .22 L. R. automatic pistol.

The Star model HK LANCER .22 L. R. pistol were designed and developed to meet the demand for a .22 L. R. pistol combining high quality at a moderate price, light weight and accuracy, long lived dependability and safety. The light weight achieved by use of the thoroughly tested and proofed "Starlite" alloy, the perfect balance and inherent accuracy of the Star HK LANCER pistols makes sure hits quick and easy. These pistols are ideally adapted for outdoor sports and camping, on the trap line and farm, as well as for just plain "plinking". Takedown of these pistols for cleaning is simple, quick and convenient. A positive thumb safety, and outside hammer with half cock notch make the Star HK LANCER pistol a safe arm for the beginner. A glance at the outside hammer indicates immediately if the arm is cocked. Simple design, finest material and generations of gun making "know how" insure dependable lifetime service of these Star pistols under the most rugged conditions. All Star pistols are subjected to rigorous proof testing and critical final inspection before acceptance.

Description.—These pistols are of the semi-automatic type, i. e., the recoil of each shot being utilized to eject the fired shell, cock the hammer and strip another cartridge from the magazine into the chamber.

Loading:

To remove the magazine.—Depress the magazine catch button, which is on the left side of the pistol back of the trigger.

To fill the magazine.—Place a cartridge between the lips of the magazine and press it downward so that the base of the cartridge will contact the rear of the magazine. Repeat this operation until seven (7) cartridges have been inserted into the magazine. The cutaway portion on the right side of the magazine permits checking the number of cartridges loaded.

To load the pistol.—Push the loaded magazine into the pistol grip as far as it will go. Grasp the serrations on the rear of the slide between the first finger and thumb. Draw the slide completely backwards and allow it to snap forward. The pistol is now cocked and a cartridge is in the chamber, ready for firing.

To fire the pistol.—Hold the pistol in shooting position and press the trigger. The discharge of the cartridge forces the slide backwards extracting the fired cartridge case and cocking the hammer. The forward movement of the slide under the pressure of the recoil spring strips a new cartridge from the magazine and feeds it into the chamber. The pistol is then ready to fire again. This is repeated as rapidly as the trigger is pressed—until the magazine is empty. If a cartridge misfires, recock the hammer with the thumb and again press the trigger.

To use the safety.—A thumb safety is provided which, when pushed upwards, positively locks the trigger and slide. When the safety is in the downward position and the red signal is visible the pistol is ready to fire.

The Star HK LANCER pistols have an outside hammer. Actually, this is an additional safety feature since the shooter can tell immediately by or touch when the hammer is cocked and the pistol ready for action. The hammer is provided with an extra "half cock" notch which permits the pistol to be cocked in a position half way between fired and full cocked position. When at half cock the pistol cannot be fired if accidentally dropped or by pulling the trigger until the hammer is manually placed in full-cock position.

To unload the pistol.—Remove the magazine. If a cartridge remains in the chamber pull the slide to the rear. This will extract and eject the cartridge. Always do this when you are through shooting and want to put the gun away unloaded.

To disassemble and reassemble the pistol:

- (1) Remove the magazine.
- (2) Cock the hammer.
- (3) Depress the slide release button immediately in front of the safety with the thumb of the right hand and while maintaining pressure on the slide release button, grasp the slide with the left hand and pull the slide approximately a quarter inch to the rear and lift up. The slide will then disengage from the frame. The recoil spring directly under the barrel may also be removed by pulling it straight out. Care should be taken to prevent the frame from being scratched.

To reassemble the pistol.—Reverse this procedure.



**Important instructions for best performance of the Star
 HK LANCER .22 L. R. pistol.**

- (1) All moving parts should be lightly oiled.
- (2) Clean the barrel and chamber after firing. Built up residue in the chamber can result in misfires due to the cartridge not seating fully in the chamber. The barrel and chamber should be cleaned from the breech. Avoid cleaning from the muzzle. Always wipe off the exterior of the gun after use, with a slightly oily cloth. This will remove finger marks and protect the finish.
- (3) For best results use cartridges with lubricated bullets. Avoid the use of cartridges with dry or copper coated bullets.
- (4) Care should be taken to prevent the magazine from being dented or otherwise damaged.

NOTE: Before firing this pistol thoroughly clean and check, assuring that there is no grease or other obstruction in the barrel. Never point it at anything you don't intend to shoot. Treat every gun as a loaded gun.

**Numerical and ballistic data of model
 HK LANCER .22 L. R. automatic pistol.**

| | |
|--|----------------|
| Caliber | .22 Long Rifle |
| Magazine Capacity | rds. 7 |
| Weight with empty Magazine | oz. 14 1/2 |
| Overall Length | in. 5 1/2 |
| Barrel Length | in. 3 |
| Height | in. 4 |
| Width at Grip | in. .984 |
| Number of Grooves | 6 |
| Length of Rifled Section | in. 2.05 |
| Twist of Rifling (Rightdrill) | |
| Width of Grooves | in. .070 |
| Depth of Grooves | in. .003 |
| Outside Dia. of barrel at chamber | in. .437 |
| Outside Dia. of Barrel at rifled section | in. .328 |
| Length of Cartridge | in. .984 |
| Weight of Cartridge Case | grs. 10.0 |
| Weight of Bullet | grs. 39.8 |
| Weight of Powder | grs. 2.0 |
| Total Weight of Cartridge | grs. 51.8 |
| Muzzle Velocity | f. p. s. 1335 |
| Muzzle Energy | ft. lbs. 204 |