

# OWNERS MANUAL



**Savage**  
**Stevens FOX**  
SPORTING FIREARMS

## **Savage Stevens** **AUTOLOADING** **RIM FIRE RIFLES**

- OPERATIONS
- MAINTENANCE
- SAFETY INSTRUCTIONS

**MODELS**  
**980-DL-987**

**READ THIS OWNERS' MANUAL COMPLETELY TO INSURE BEST PERFORMANCE AND SAFETY**

### PART NAMES AND LOCATIONS

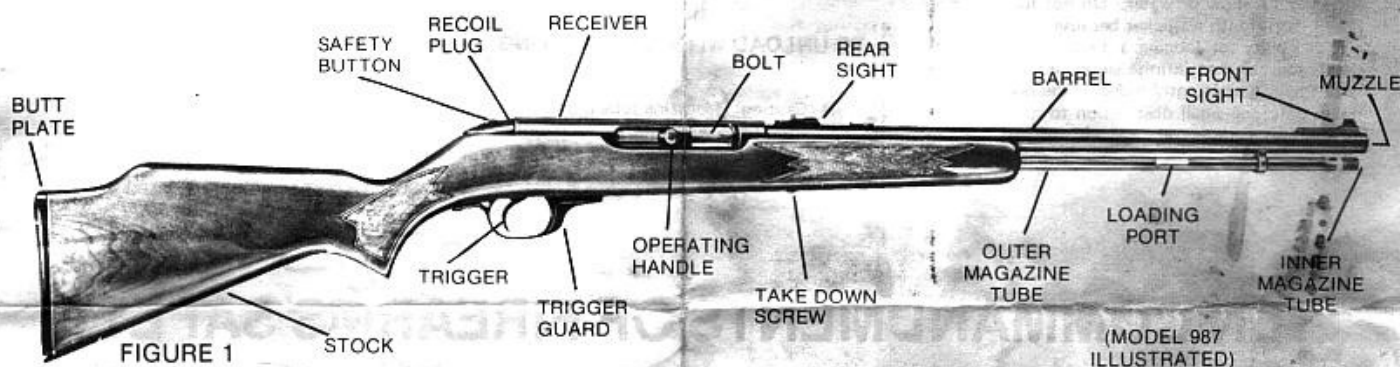

### OPERATING INSTRUCTIONS



**FAILURE TO OBEY A SAFETY WARNING MAY RESULT IN INJURY TO YOU OR TO OTHERS.**



**ALWAYS KEEP THE MUZZLE POINTED IN A SAFE DIRECTION**

Prior to using live ammunition, familiarize yourself thoroughly with these operating instructions. See Figure 1. Get used to the feel of operating the mechanism of your new rifle — know the feel and effort needed to operate the action, open and close the bolt, pull the trigger and **KNOW HOW TO LOCATE AND PLACE SAFETY IN THE "ON" POSITION.** The safety is located on the top rear of receiver. The safety is in "ON" position when pulled to the rear as indicated by "S". The safety can be put in the "ON" position **ONLY WHEN THE ACTION IS COCKED.** When carried in the field the safety should be in the "ON" position whether the action is open or closed. See Figure 2.



**MAKE SURE THE RIFLE IS NOT LOADED**

**TO ASSEMBLE (Stock with Barrel)** — Fit barrel to stock by inserting trigger into trigger slot in stock. Be sure barrel stud fits into the hole in stock. Tighten takedown screw until barrel and stock are rigidly joined. (Check screw after heavy firing to make sure action is tightly locked to stock).



FIGURE 2

### HOW TO OPERATE

1. Draw back on the operating handle opening the action, then press inward on the operating handle latching the breech bolt in the open position. See Figure 2.
2. Put the safety "ON" by pulling the safety all the way to rear as indicated by "S". (**GUN MUST BE COCKED.**)



**USE THE CORRECT AMMUNITION AS IDENTIFIED ON THE BARREL. CLEAN INSIDE OF THE BARREL AND CHAMBER TO REMOVE ALL GREASE AND OTHER POSSIBLE OBSTRUCTIONS BEFORE FIRING.**

### TO LOAD

1. To Load — With the safety in the "ON" position, pull outward on the operating handle and allow the bolt to close. Turn the magazine tube cap to unlock the magazine and withdraw the inner magazine tube until the red colored follower clears the loading port in the magazine. With the **MUZZLE POINTED UPWARD IN A SAFE DIRECTION**, insert the cartridge's rimmed end first. See Figure 3. The magazine is filled to capacity when a cartridge is visible in the loading port. The magazine will come under spring tension, so securely grip the magazine tube cap and carefully push the magazine tube down into position and turn to lock.

**2. TO LOAD THE CHAMBER** — Pull rearward on the operating handle, then release the handle allowing the breech bolt to snap forward. The chamber is now loaded and the gun is ready for firing.

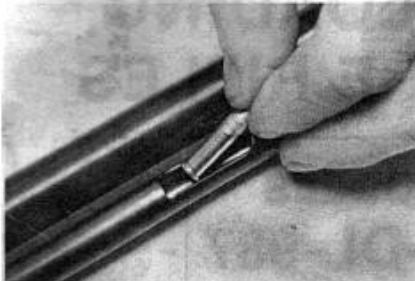

FIGURE 3

### TO CARRY

**SAFETY WARNING** Do not permit the muzzle to dip into mud, snow or water. Do not thrust the barrel into a thicket because of the possibility of lodging a twig in the bore. Mud, snow and an infinite variety of other objects may inadvertently lodge in the barrel. It takes only one small obstruction to ruin (swell or rupture) a gun barrel.

### TO FIRE

- SAFETY WARNING** 1. Do not put safety in the "OFF" position until you are ready to fire.
- SAFETY WARNING** 2. Keep your finger off the trigger and out of trigger guard until you are ready to fire.
- SAFETY WARNING** 3. Place the gun to your shoulder, put safety in the "OFF" position, take aim, place your finger lightly on trigger. When on target, squeeze the trigger. The gun will fire and automatically eject the fired cartridge case and reload a new cartridge each time the trigger is pulled until the magazine is empty.
- SAFETY WARNING** 4. The ejected cartridge cases are hot. Do not hold your hand over the ejection port when firing, or attempt to catch the fired case.
- SAFETY WARNING** 5. Always put the safety in the "ON" position when not firing.

### TO UNLOAD WITHOUT SHOOTING

**SAFETY WARNING** Caution: Magazine tube is under tension from follower spring.

With the safety in the "ON" position and the **MUZZLE POINTED IN A SAFE DIRECTION**, remove magazine tube and tilt muzzle down to remove cartridges from magazine. Replace magazine tube. With muzzle still pointed in a safe direction, open breech bolt to extract live round from chamber. Latch breech bolt in open position and view chamber and action area to insure gun is unloaded.

**SAFETY WARNING** YOU MUST SEE BOTH THE EMPTY CHAMBER AND THE RED COLORED MAGAZINE FOLLOWER IN THE ACTION.

### SIGHT ADJUSTMENTS

To raise or lower point of impact, raise or lower rear sight blade. To adjust windage left or right, move rear sight blade left or right. The point of impact of the bullet will always move in the same direction that the rear sight blade is moved.

## TEN COMMANDMENTS OF FIREARMS SAFETY.

A good hunter is a safe hunter. He knows there is no place for horseplay in hunting. He learns and obeys the commandments of firearms safety and insists that his companions know and follow them too.

Every hunter — whether novice or experienced outdoorsman — should review these commandments before each hunting season to be sure that his gun handling, both at home and in the field, sets a good example for others.

1. Don't rely on your gun's safety. Treat every gun as if it were loaded and ready to fire.
2. Don't shoot unless absolutely sure of your target and what is beyond it.
3. Always be sure the barrel is clear of obstructions. Only carry ammunition of the proper size for the gun you are using.
4. Never point your gun at anything you do not want to shoot. Watch your muzzle so the other person doesn't have to.
5. Never leave your gun unattended unless you unload it first.
6. Avoid alcoholic beverages both before and during shooting.
7. Never carry a loaded gun when you climb a tree, cross a fence, jump a ditch or go through areas where you are apt to slip or trip.
8. Never shoot at a hard, flat surface or the surface of water. Make sure you have a safe backstop.
9. Carry only empty guns, taken down or with the action open, into your camp, car or home.
10. Store guns and ammunition separately, beyond the reach of children.



It is recommended that **SHOOTING GLASSES** be worn at all times and that **EAR PROTECTION** be used where practical.

**IMPORTANT** — Savage firearms are designed, manufactured and proof-tested for use with fresh factory loaded ammunition. Improperly loaded shells are dangerous. Savage does not assume responsibility for damages or injury caused by reloads or improperly loaded ammunition. This firearm has been manufactured to Savage specifications. Savage recommends against and is not responsible for, alterations or modifications not made by Savage factory personnel or for the replacement of any parts with parts not of Savage manufacture.

**SAFETY WARNING** **TO DISASSEMBLE FOR CLEANING — MAKE CERTAIN MAGAZINE AND CHAMBER ARE UNLOADED** — Remove stock. Close bolt and leave cocked. Press down on end of Safety Slide to release pressure on Safety Slide Retaining Ring and remove Ring. Remove Safety Slide from Trigger Housing.

**SAFETY WARNING** **IMPORTANT** — Uncock gun by pulling Trigger to remove pressure of Hammer Spring against Recoil Plug. Unscrew Recoil Plug and draw out Recoil Plug, Hammer and Firing Pin. Remove Operating Handle which was retained by Firing Pin. Hold Trigger back and slide Breech Bolt out rear of receiver. See Figure 4.

**SAFETY WARNING** **THIS TRIGGER ASSEMBLY IS FACTORY ADJUSTED. DO NOT ATTEMPT TO DISASSEMBLE OR ADJUST.**

**TO REASSEMBLE AFTER CLEANING** — Reverse above procedure. Install hammer, firing pin, and breech bolt as a unit while holding trigger back. Withdraw hammer and firing pin sufficiently to insert operating handle into breech bolt then push hammer and firing pin back into receiver until hammer touches rear of breech bolt. Adjust recoil plug to fit breech bolt locked in open position with operating handle pushed into hole in left side of receiver.

**SAFETY WARNING** **TO INSURE PROPER SAFETY OPERATION MAKE CERTAIN THAT RETAINING RING IS SECURELY ASSEMBLED.**

### HOW TO CARE FOR YOUR RIFLE

Protect your rifle with good gun care products. To help assure trouble free performance, it is important periodically, or after 500 shots have been fired, to remove the bolt and push a patch, moistened with a good solvent

through the entire length of the bore several times, using long even strokes. Push clean patches through the bore in the same manner until the last patch comes out unsoiled. Then push a lightly oiled patch through the entire length of the bore.

**SAFETY WARNING** **CHECK BORE AT THIS POINT FOR POSSIBLE OBSTRUCTIONS.**

Brush or blow any residue from action area. Also with a brush and solvent clean the bolt face and extractors. Wipe dry all metal parts and oil lightly.

Between seasons, apply a coat of oil to the bore and metal parts and store in a dry place. **DO NOT PLUG THE BARREL** or store in a case that is made of a fabric or material which will absorb the lubricant from the rifle.

### FURTHER CARE

This firearm should be checked periodically by a competent gunsmith to insure proper operation and any worn or damaged parts replaced.

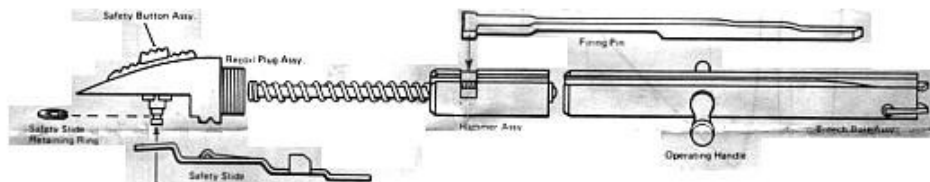

FIGURE 4

## INSTRUCTIONS FOR ORDERING REPLACEMENT PARTS

All parts must be ordered from one of our **CENTRAL PARTS DISTRIBUTORS** (see enclosed listing). No parts are sent directly from the factory.

Help speed up your order and help avoid errors. Here is how:

1. Order by **PARTS NUMBER** and **PARTS NAME**. Specify **MODEL NUMBER** (include **LETTER** if any), stamped on barrel or frame of firearm, **SERIAL NUMBER**, **CALIBER** or **GAUGE**.

2. Please **DO NOT** ship sample to **CENTRAL PARTS DISTRIBUTOR** unless it is impossible to identify from the parts list.

3. Certain replacement parts require **SPECIAL TOOLS** and **GAUGES** for proper installation.

For this reason, certain Savage components are **RESTRICTED** for factory installation **ONLY**. Certain other components are sold and **RESTRICTED** to installation by **GUNSMITHS** as noted on parts sheet. **NOTE:** Parts will be furnished for **DISCONTINUED MODELS** as long as the supply of existing parts last.

### INSTRUCTIONS FOR RETURNING COMPLETE FIREARM FOR SERVICE

**SAFETY WARNING** **MAKE SURE CHAMBER AND MAGAZINE ARE UNLOADED**

**IMPORTANT** — It is a **FEDERAL OFFENSE** to ship firearms and ammunition together.

Before packing firearms for shipment, all live ammunition must be removed.

If service is required, your complete firearm may be sent to any of the **SAVAGE FACTORY RECOMMENDED GUNSMITHS** in your area! (See enclosed listing).

Or, if you wish, send to:

S.A.  
P.O. BOX 1170  
WESTFIELD, MA 01086

**NOTE:** **DO NOT** send scopes, slings or gun cases with your firearm.



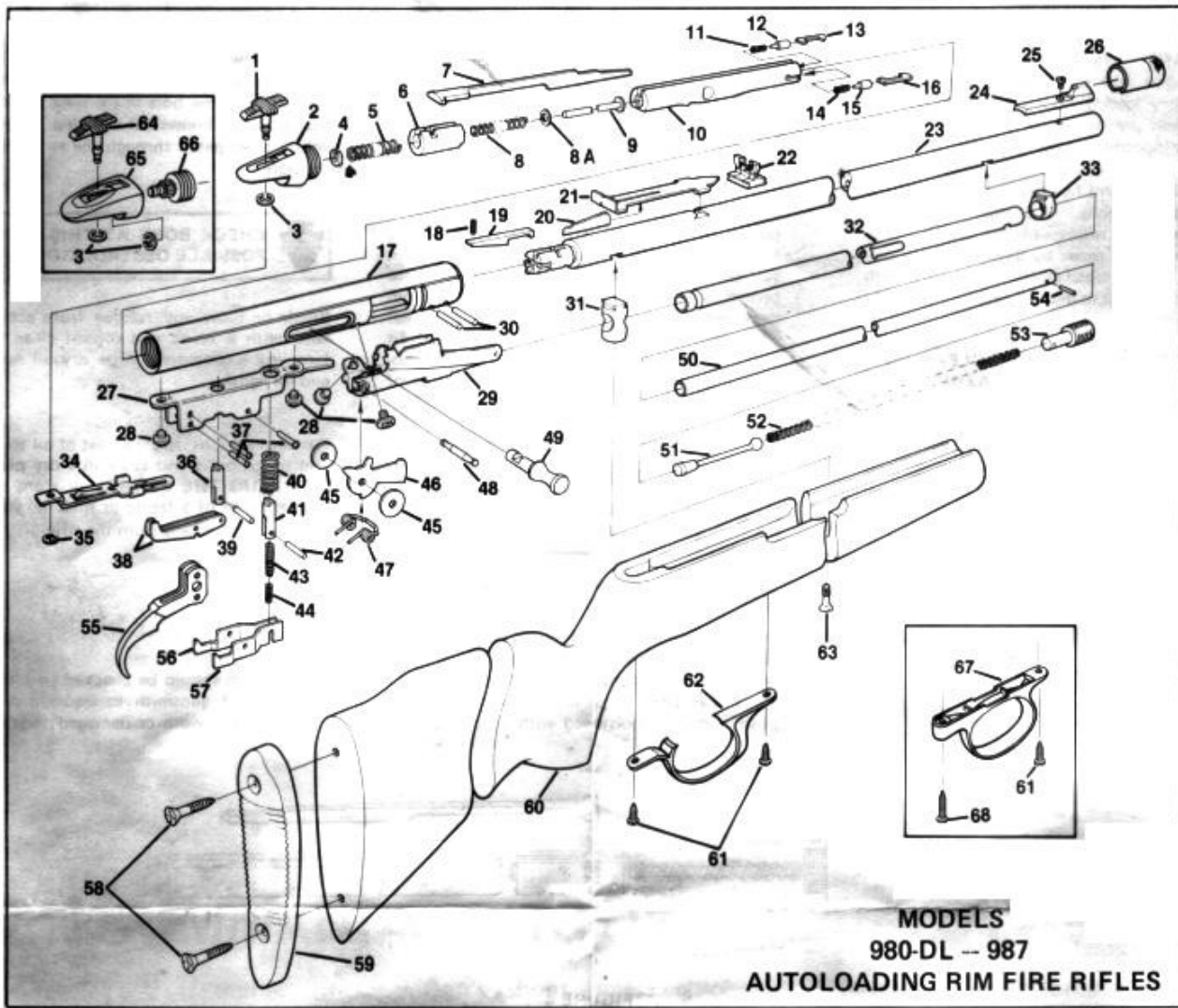

**MODELS**  
**980-DL -- 987**  
**AUTOLOADING RIM FIRE RIFLES**

WHEN ORDERING PARTS, IT IS NECESSARY TO SPECIFY MODEL NUMBER SERIES, CALIBER AND SERIAL NUMBER.

980-DL - 987 2-82

Key No.	Part No.	Part Name	Key No.	Part No.	Part Name	Key No.	Part No.	Part Name
1	A987019300	Safety Button Assy.	25	P340523800	Front Sight Hood	50	P087016000	Inside Magazine Tube
2	P087J17700	Recoil Plug	26	P076018200	Release Housing		1A087016000	Inside Magazine Tube Assy.
	1A087J17700	Recoil Plug Assy.		1A076018200	Release Housing & Trigger Assy.	51	P087014300	Magazine Follower
3	P087J76300	Safety Button Retaining Ring	28	P087085300	Release Housing Screw	52	P066015600	Magazine Follower Spring
4	P076011100	Hammer Spring Washer	29	P087029300	Magazine Guide	53	P066014900	Magazine Plug
5	P087H11000	Hammer Spring		1A087029300	Magazine Guide Assy.	54	P066015000	Magazine Plug Pin
6	P088010700	Hammer	30	P053001300	Barrel Pin	55	P987027900	Trigger
	1A088010700	Hammer Assy	31	P087014800	Magazine Mount, (Rear)		1A987027900	Trigger Assy.
7	P087N07700	Firing Pin	32	P087035500	Outside Magazine Tube	56	P0870044L0	Detent Lever, (Left)
8	P076002600	Breech Bolt Spring	33	P087014700	Magazine Mount, (Front)	57	P0870044R0	Detent Lever, (Right)
8a	P076002800	Breech Bolt Spring Washer	34	P980064500	Safety Slide	58	P084003200	Butt Plate Screw
9	P076002700	Breech Bolt Spring Rod	35	P980063500	Safety Retaining Ring	59	P046000500	Butt Plate
10	***P088002500	Breech Bolt	36	P076018700	Release Plunger	60	A987000300	Stock Assy.
	1***A088002500	Breech Bolt Assy.	37	P076004800	Trigger, Detent & Release Lever Pin	61	P125010200	Trigger Guard Screws
11	P087N068L0	Extractor Plunger Spring (Left)				62	P084809900	Trigger Guard
12	P087N06700	Extractor Plunger	38	P987018400	Release Lever	63	P980026800	Takedown Screw
13	P087N069L0	Extractor, Left		1A087018400	Release Lever Assy.			
14	P087N068R0	Extractor Plunger Spring (Right)	39	P084009300	Release Plunger Pin	<b>Parts for Model 980</b>		
15	P087N06700	Extractor Plunger	40	P076018900	Release Spring	1P980027900		Trigger
16	P087N069R0	Extractor, Right	41	P076004700	Detent Plunger	1A980027900		Trigger Assembly
17	*P087J00200	Receiver		1A076004700	Detent Plunger Assy.	A980019300		Safety Button Assy.
18	P087064300	Bumper Spring	42	P056028500	Trigger Pin	P088017700		Recoil Plug
19	P076002900	Bumper	43	P076004900	Detent Plunger Spring	1A088017700		Recoil Plug Assy.
20	P003023300	Rear Sight Step	44	P0760068L0	Detent Plunger Inner Spring	P088065700		Recoil Plug Insert
21	P0030229L0	Rear Sight (Low)	45	P076013100	Lifter Spacer	P980009900		Trigger Guard
22	P099F22900	Rear Sight (Folding)	46	P087012100	Lifter	P125010300		Trigger Guard Screw Long (Rear)
23	*P980001DG	Barrel	47	P076013200	Lifter Spring	1*P088000200		Receiver
24	P006D21900	Front Sight Base	48	P076012800	Lifter Pin	1A980000300		Stock Assy.
25	P325027700	Front Sight Screw	49	P087036000	Operating Handle	1P085061600		Butt Plate Liner

\*Sold for factory installation only. Complete firearm to be returned to factory.

\*\*Sold only to Savage Recommended Gunsmiths who have executed an agreement with us. Otherwise, for factory installation only.

\*\*\*Not sold to consumers. Must be installed by a gunsmith. Orders from dealers and distributors accepted with the understanding that parts will be fitted by a gunsmith.

†Parts not illustrated.

SAVAGE INDUSTRIES INC.  
 WESTFIELD, MASSACHUSETTS 01085

P987015100



**Savage**

Printed in U.S.A.

WHEN ORDERING PARTS, IT IS NECESSARY TO SPECIFY MODEL NUMBER SERIES, CALIBER AND SERIAL NUMBER.

980-DL - 987 2-82

Key No.	Part No.	Part Name	Key No.	Part No.	Part Name	Key No.	Part No.	Part Name
1	A987019300	Safety Button Assy.	26	P340S23800	Front Sight Hood	50	P087016000	Inside Magazine Tube
2	P087J17700	Recoil Plug	27	P076018200	Release Housing	†A087016000	P087014300	Inside Magazine Tube Assy.
	†A087J17700	Recoil Plug Assy.		†A076018200	Release Housing & Trigger Assy.	51	P066015600	Magazine Follower
3	P087J76300	Safety Button Retaining Ring	28	P087085500	Release Housing Screw	52	P066014900	Magazine Follower Spring
4	P076011100	Hammer Spring Washer	29	P087029300	Magazine Guide	53	P066015000	Magazine Plug
5	P087H11000	Hammer Spring		†A087029300	Magazine Guide Assy.	54	P987027900	Magazine Plug Pin
6	P088010700	Hammer	30	P053001300	Barrel Pin	55	†A987027900	Trigger
	†A088010700	Hammer Assy	31	P087014800	Magazine Mount, (Rear)		P0870044L0	Trigger Assy.
7	P087N07700	Firing Pin	32	P087035500	Outside Magazine Tube	56	P0870044R0	Detent Lever, (Left)
8	P076002600	Breech Bolt Spring	33	P087014700	Magazine Mount, (Front)	57	P094003200	Detent Lever, (Right)
8a	P076002800	Breech Bolt Spring Washer	34	P980064500	Safety Slide	58	P046000500	Butt Plate Screw
9	P076002700	Breech Bolt Spring Rod	35	P980083500	Safety Retaining Ring	59	A987000300	Butt Plate
10	***P088002500	Breech Bolt	36	P076018700	Release Plunger	60	P125010200	Stock Assy.
	†***A088002500	Breech Bolt Assy.	37	P076004600	Trigger, Detent & Release Lever Pin	61	P094009900	Trigger Guard Screws
11	P087N068L0	Extractor Plunger Spring (Left)				62	P980026800	Trigger Guard
12	P087N06700	Extractor Plunger	38	P987018400	Release Lever	63		Takedown Screw
13	P087N059L0	Extractor, Left		†A087018400	Release Lever Assy.			
14	P087N068R0	Extractor Plunger Spring (Right)	39	P094009300	Release Plunger Pin	Parts for Model 980		
15	P087N06700	Extractor Plunger	40	P076018900	Release Spring		†P980027900	Trigger
16	P087N059R0	Extractor, Right	41	P076004700	Detent Plunger		†A980027900	Trigger Assembly
17	*P087J00200	Receiver		†A076004700	Detent Plunger Assy.		A980019300	Safety Button Assy.
18	P087054300	Bumper Spring	42	P056028500	Trigger Pin	64	P088017700	Recoil Plug
19	P076002900	Bumper	43	P076004900	Detent Plunger Spring	65	†A088017700	Recoil Plug Assy.
20	P003023300	Rear Sight Step	44	P0760068L0	Detent Plunger Inner Spring		P088065700	Recoil Plug Insert
21	P0030229L0	Rear Sight (Low)	45	P076013100	Lifter Spacer	66	P980009900	Trigger Guard
22	P099F22900	Rear Sight (Folding)	46	P087012100	Lifter	67	P125010300	Trigger Guard Screw Long (Rear)
23	*P9800001DG	Barrel	47	P076013200	Lifter Spring	68	†*P088000200	Receiver
24	P006D21900	Front Sight Base	48	P076012900	Lifter Pin		†A980000300	Stock Assy.
25	P325022700	Front Sight Screw	49	P087036000	Operating Handle		†P065061600	Butt Plate Liner

\*Sold for factory installation only. Complete firearm to be returned to factory.

\*\*Sold only to Savage Recommended Gunsmiths who have executed an agreement with us. Otherwise, for factory installation only.

\*\*\*Not sold to consumers. Must be installed by a gunsmith. Orders from dealers and distributors accepted with the understanding that parts will be fitted by a gunsmith.

†Parts not illustrated.

P987015100

Owners Manual

SAVAGE INDUSTRIES INC.  
WESTFIELD, MASSACHUSETTS 01085

P987015100



**Savage**

Printed in U.S.A.