



Model 916-A
PUMP ACTION SHOTGUN

**OWNERS
GUIDE**

AVAILABLE OPTIONS INCLUDE:
VENTILATED RIB —
RECOIL PAD —
RIFLE SIGHTS —
EXTENDED MAGAZINE
TUBE —



**SELECTED ALLOY STEEL BARREL
PERMANENTLY ALIGNED
TO RECEIVER
PROOF TESTED FOR ALL
REGULAR AND 3" MAGNUM
SHELLS IN 12 & 20 GAUGE**

PARTS-SUBASSEMBLIES FOR 12 & 20 GAUGE

Model 916-A
PUMP ACTION SHOTGUN

12509 BREECH BOLT ASSEMBLY

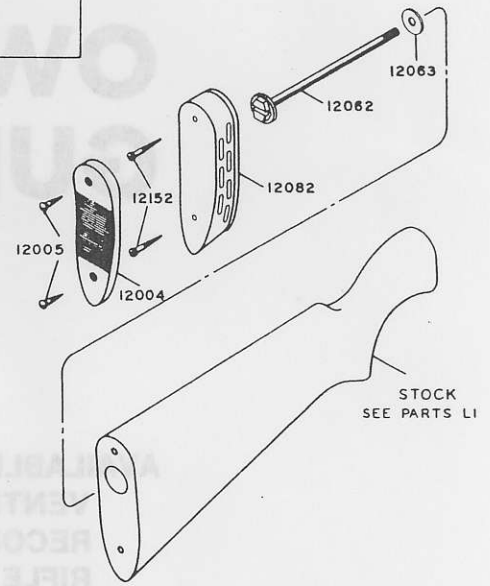
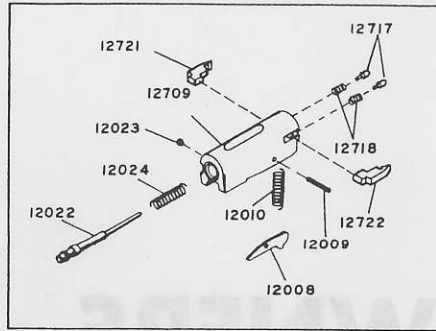

| Part Number | Description |
|-------------|--------------------------|
| 12003 | Breech Bolt Slide |
| 12004 | Butt Plate |
| 12005 | Butt Plate Screws |
| 12008 | Cartridge Stop 12 ga. |
| 12009 | Cartridge Stop Pin |
| 12010 | Cartridge Stop Spring |
| 12015 | Detent |
| 12016 | Detent Rivet |
| 12017 | Detent Trip |
| 12018 | Detent Trip Pin |
| 12019 | Ejector |
| 12021 | Ejector Screw 12 ga. |
| 12022 | Firing Pin |
| 12023 | Firing Pin Screw |
| 12024 | Firing Pin Spring |
| 12025 | Forend Retainer Front |
| 12028 | Forend Wood Plain |
| 12031 | Front Sight |
| 12033 | Hammer Pin |
| 12043 | Lifter Spring |
| 12045 | Magazine Mount 12 ga. |
| 12046 | Magazine Spring (6 shot) |
| 12047 | Magazine Spring Follower |
| 12048 | Magazine Tube (8 shot) |
| 12049 | Main Spring |
| 12050 | Main Spring Follower |
| 12052 | Release Actuator Spring |
| 12053 | Release Lever |

| Part Number | Description |
|-------------|-----------------------------------|
| 12054 | Release Booster Spring |
| 12055 | Lifter & Release Pivot Screw |
| 12058 | Safe Button Pin |
| 12062 | Stock Bolt |
| 12063 | Stock Bolt Washer |
| 12065 | Top Safe Button |
| 12066 | Top Safe Lever |
| 12067 | Top Safe Lever Pivot Pin |
| 12069 | Trigger Pin |
| 12070 | Trigger Plate Pin 12 ga. |
| 12071 | Trigger Plate Screw 12 ga. |
| 12072 | Trigger Spring |
| 12073 | Trigger Plate |
| 12074 | Wood Plug (3 shot reduction) |
| 12082 | Soft Rubber Recoil Pad |
| 12084 | Magazine Cap |
| 12085 | Safety Spring |
| 12000 | *Barrel 28" Full Choke 12 ga. |
| 12088 | *Barrel Full Choke 28" 20 ga. |
| 12109 | *Barrel Cyl Bore 18" 12 ga. |
| 12110 | *Barrel Cyl Bore 20" 12 ga. |
| 12111 | *Barrel Imp Cyl Choke 26" 12 ga. |
| 12112 | *Barrel Full Choke 30" 12 ga. |
| 12114 | *Barrel Imp Cyl Choke 26" 20 ga. |
| 12169 | *Barrel Modified Choke 28" 12 ga. |
| 12170 | *Barrel Modified Choke 28" 20 ga. |
| 12089 | *Vent Rib 28" 12 ga. |
| 12090 | *Vent Rib 30" 12 ga. |

*Must be returned to factory for installation.

ONLY STEEL BARREL
W/ALIGNED
RECEIVER
PROOF TESTED FOR ALL
REGULAR AND 3" MAGNUM
SHELLS IN 12 & 20 GAUGE

DISASSEMBLY — RIB

To disassemble Action proceed as follows:

1. Close Action.

2. Remove screw in top of Bolt Plate or recoil pad.

3. Loosen bottom screw. Swing out plate 90° either way with a long screw driver (at least 8" long shaft).

4. Remove screw top. Put stock against to remove.

5. With a 1/2" pin punch drive trigger plate pin out from back.

6. Use a 1/2" pin punch to drive trigger plate screw. Put trigger plate against rear of stock. Remove.

7. Open action of the way forward. Remove trigger plate.

8. Remove trigger plate from stock. Remove.

9. Clean action of the way forward. Remove trigger plate.

10. Remove trigger plate from stock. Remove.

11. Remove trigger plate from stock. Remove.

12. Remove trigger plate from stock. Remove.

13. Remove trigger plate from stock. Remove.

14. Remove trigger plate from stock. Remove.

15. Remove trigger plate from stock. Remove.

16. Remove trigger plate from stock. Remove.

17. Remove trigger plate from stock. Remove.

18. Remove trigger plate from stock. Remove.

19. Remove trigger plate from stock. Remove.

20. Remove trigger plate from stock. Remove.

21. Remove trigger plate from stock. Remove.

22. Remove trigger plate from stock. Remove.

23. Remove trigger plate from stock. Remove.

24. Remove trigger plate from stock. Remove.

25. Remove trigger plate from stock. Remove.

26. Remove trigger plate from stock. Remove.

27. Remove trigger plate from stock. Remove.

28. Remove trigger plate from stock. Remove.

29. Remove trigger plate from stock. Remove.

30. Remove trigger plate from stock. Remove.

31. Remove trigger plate from stock. Remove.

32. Remove trigger plate from stock. Remove.

33. Remove trigger plate from stock. Remove.

34. Remove trigger plate from stock. Remove.

35. Remove trigger plate from stock. Remove.

36. Remove trigger plate from stock. Remove.

37. Remove trigger plate from stock. Remove.

38. Remove trigger plate from stock. Remove.

39. Remove trigger plate from stock. Remove.

40. Remove trigger plate from stock. Remove.

41. Remove trigger plate from stock. Remove.

42. Remove trigger plate from stock. Remove.

43. Remove trigger plate from stock. Remove.

44. Remove trigger plate from stock. Remove.

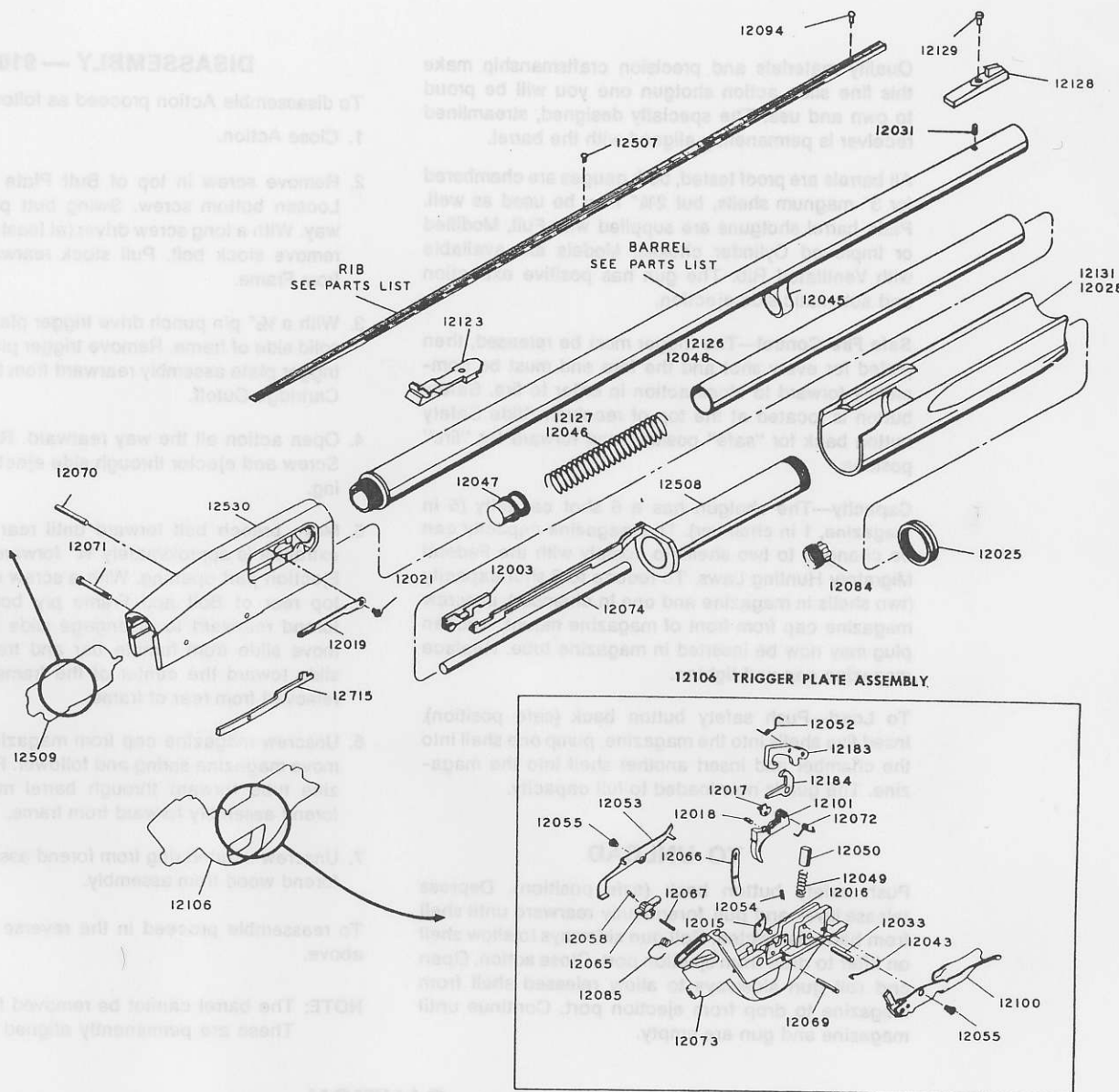

| Part Number | Description |
|-------------|--|
| 12115 | *Vent Rib 26" 12 ga. |
| 12117 | *Vent Rib 26" 20 ga. |
| 12125 | *Vent Rib 28" 20 ga. |
| 12094 | Rib Front Sight |
| 12100 | Lifter Sub Assembly 12 ga. (Consists of the Following) |
| 12038 | Lifter |
| 12039 | Lifter Pawl |
| 12040 | Lifter Pawl Spring |
| 12041 | Lifter Pawl Spring Post |
| 12042 | Lifter Pawl Stud |
| 12101 | Trigger Assembly (Consists of the Following) |
| 12068 | Trigger |
| 12017 | Detent Trip |
| 12018 | Detent Trip Pin |
| 12106 | Trigger Plate Assembly Complete 12 ga. |
| 12124 | Magazine Mount 20 ga. |
| 12126 | Magazine Tube (8 shot) |
| 12127 | Magazine Spring (8 shot) |
| 12135 | Stock Ass'y — Hard Butt 12 ga. |
| 12139 | Stock Ass'y — Hard Butt 20 ga. |
| 12143 | Stock Ass'y — Recoil Pad 12 ga. |
| 12147 | Stock Ass'y — Recoil Pad 20 ga. |
| 12152 | Recoil Pad Screw |
| 12153 | Cartridge Slop 20 ga. |
| 12160 | Ejector Screw 20 ga. |
| 12162 | Trigger Plate Screw 20 ga. |
| 12163 | Trigger Plate Pin 20 ga. |
| 12164 | Trigger Plate Assembly Complete 20 ga. |

| Part Number | Description |
|-------------|--|
| 12183 | Hammer |
| 12184 | Sear Assembly (Consists of the Following) |
| 12060 | Sear |
| 12122 | Sear Stop Pin |
| 12197 | Lifter Sub Assembly 20 ga. (Consists of the Following) |
| 12161 | Lifter 20 ga. |
| 12039 | Lifter Pawl |
| 12040 | Lifter Pawl Spring |
| 12041 | Lifter Pawl Spring Post |
| 12042 | Lifter Pawl Stud |
| 12507 | Mid Point Sight Bead |
| 12508 | Handle Bar Tube Assembly (Consists of the Following) |
| 12034 | Handle Bar Tube |
| 12130 | Forend Retainer Rear |
| 12729 | Operating Bar |
| 12509 | Breech Bolt Assembly 12 ga. |
| 12510 | Breech Bolt Assembly 20 ga. |
| 12530 | *Frame 12 ga. |
| 12531 | *Frame 20 ga. |
| 12709 | *Breech Bolt 12 ga. |
| 12710 | *Breech Bolt 20 ga. |
| 12715 | Cartridge Cut Off 12 ga. |
| 12716 | Cartridge Cut Off 20 ga. |
| 12717 | Extractor Plunger |
| 12718 | Extractor Plunger Spring |
| 12721 | Left Hand Extractor |
| 12722 | Right Hand Extractor |

Quality materials and precision craftsmanship make this fine slide action shotgun one you will be proud to own and use. The specially designed, streamlined receiver is permanently aligned with the barrel.

All barrels are proof tested, both gauges are chambered for 3" magnum shells, but 2¾" may be used as well. Plain barrel shotguns are supplied with Full, Modified or Improved Cylinder chokes. Models are available with Ventilated Rib. The gun has positive extraction and automatic side ejection.

Safe Fire Control—The trigger must be released, then pulled for every shot and the fore end must be completely forward to close action in order to fire. Safety button is located at the top of receiver. Slide Safety button back for "safe" position and forward for "fire" position.

Capacity—The shotgun has a 6 shot capacity (5 in magazine, 1 in chamber). The magazine capacity can be changed to two shells to comply with the Federal Migratory Hunting Laws. To reduce to 3 shot capacity (two shells in magazine and one in chamber), unscrew magazine cap from front of magazine mount, wooden plug may now be inserted in magazine tube. Replace magazine cap and tighten.

To Load—Push safety button back (safe position). Insert five shells into the magazine, pump one shell into the chamber and insert another shell into the magazine. The gun is now loaded to full capacity.

TO UNLOAD

Push safety button back (safe position). Depress release lever and pull forend fully rearward until shell from barrel is ejected. Roll gun sideways to allow shell on lifter to drop from ejection port. Close action. Open and roll gun sideways to allow released shell from magazine to drop from ejection port. Continue until magazine and gun are empty.

DISASSEMBLY — 916A

To disassemble Action proceed as follows:

1. Close Action.
2. Remove screw in top of Butt Plate or recoil pad. Loosen bottom screw. Swing butt plate 90° either way. With a long screw driver (at least 8" long shank) remove stock bolt. Pull stock rearward to remove from Frame.
3. With a ½" pin punch drive trigger plate pin out from solid side of frame. Remove trigger plate screw. Pull trigger plate assembly rearward from frame. Remove Cartridge Cutoff.
4. Open action all the way rearward. Remove Ejector Screw and ejector through side ejection part opening.
5. Move breech bolt forward until rear of right hand extractor is approximately ¼" forward of the rear of Ejection part opening. With a screw driver between top rear of Bolt and Frame pry bolt down. Push forend rearward to disengage slide from bolt. Remove slide from handle bar and track by moving slide toward the center of the frame. Bolt may be removed from rear of frame.
6. Unscrew magazine cap from magazine mount. Remove magazine spring and follower. Remove magazine tube forward through barrel mount. Remove forend assembly forward from frame.
7. Unscrew knurled ring from forend assembly and pull forend wood from assembly.

To reassemble proceed in the reverse order outlined above.

NOTE: The barrel cannot be removed from the frame. These are permanently aligned at the factory.

CAUTION

Use of proper safety precautions, including adequate eye and ear protection, is recommended for the user of this product and for others in the vicinity of the user.

Smith & Wesson



Smith & Wesson

BANGOR PUNTA Company

2100 Roosevelt Ave.
Springfield, Massachusetts 01101, U.S.A.