

9MM AUTOMATIC PISTOL

DOUBLE ACTION MODEL No. 439/539

PARTS LIST • INSTRUCTIONS FOR USE • MAINTENANCE • SPECIFICATIONS

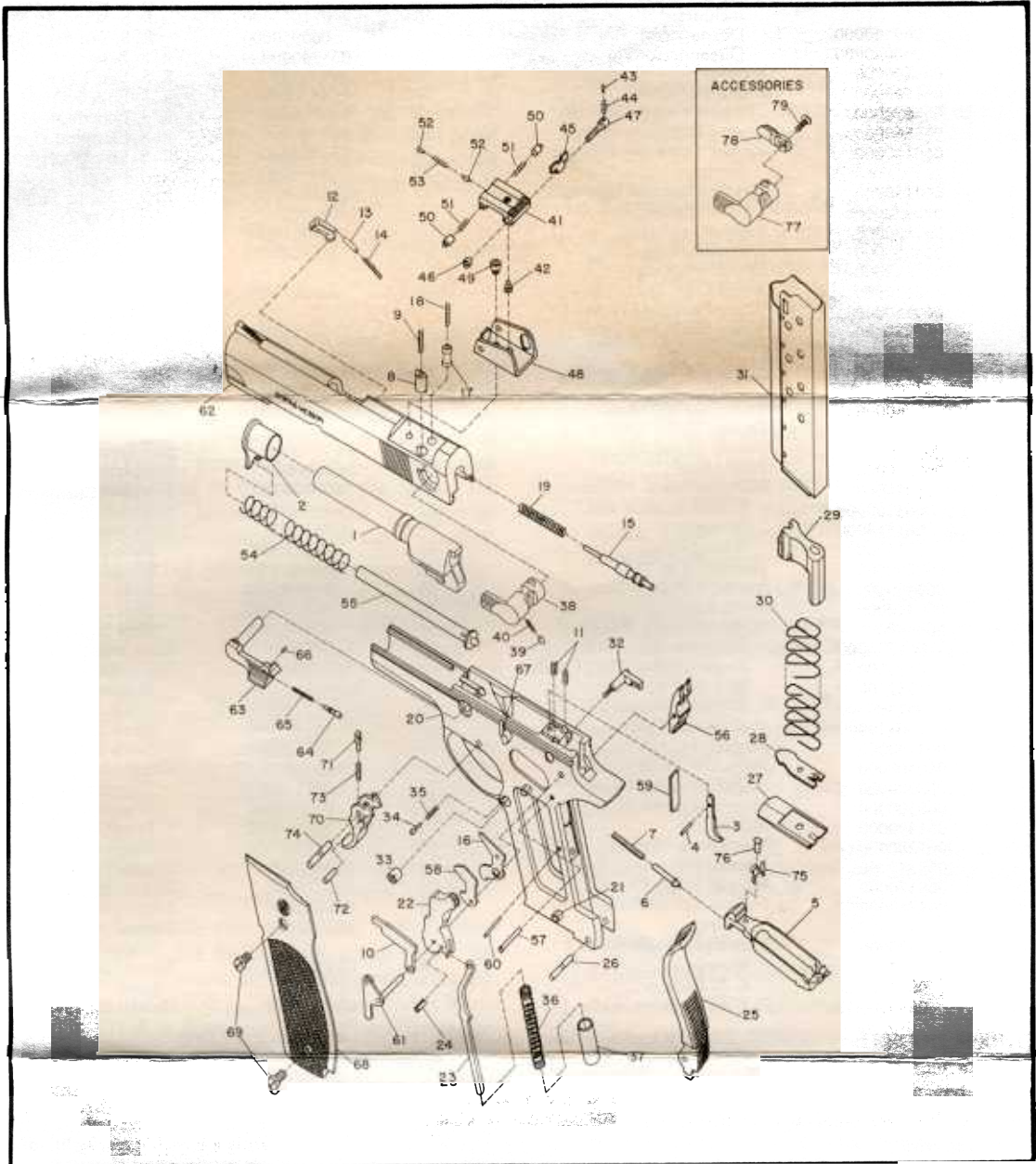

This Isometric Drawing and parts list conform to the current specifications provided by our Engineering Department. From time to time improvements are made in all our models. For this reason, the gun which you own may not correspond exactly with the information provided on this sheet. When requesting information or ordering parts for your gun, please provide the serial number and approximate date of purchase.



SMITH & WESSON 9MM AUTOMATIC PISTOL DOUBLE ACTION MODEL No. 439/539

PARTS LIST

View No.	Part No.	Description	View No.	Part No.	Description
		Barrel	43	071580000	R. S. Plunger
		Barrel Bushing	44	071590000	R. S. Plunger Spring
		Disconnecter Ass'y.	45	060760000	R. S. Slide
		Includes:	46	051070000	R. S. Windage Nut
3		Disconnecter	47	060950000	R. S. Windage Screw
4		Disconnecter Pin	48	063740000	R. S. Base
5		Drawbar	49	069380000	R. S. Base Screw
6		Drawbar Plunger	50	068440000	R. S. Body Plunger
7		Drawbar Plunger Spring	51	063800000	R. S. Body Plunger Spring
8		Ejector Depressor Plunger	52	063780000	R. S. Elevation Plunger
		Ejector Depressor Plunger Spring	53	063810000	R. S. Elevation Spring
		Ejector Magazine Depressor	54	060480000	Recoil Spring
10		Ejector Spring	55	063230000	Recoil Spring Guide Ass'y.
11		Extractor			(1) Includes:
12		Extractor Plunger	—	060610000	Recoil Spring Guide
13		Extractor Spring	—	060620000	Recoil Spring Guide Bushing, N.I.
14		Firing Pin	—	060630000	Recoil Spring Guide Plunger, N.I.
15		Firing Pin Safety Lever	—	060640000	Recoil Spring Guide Plunger Spring, N.I.
16		Firing Pin Safety Lever Plunger			Sear
17		Firing Pin Safety Lever Spring	56	069270000	Sear Pin
18		Firing Pin Spring	57	060660000	Sear Release Lever
19		*Frame, Model 439	58	068850000	Sear Spring
20		*Frame, Model 539	59	068590000	Sear Spring Retaining Pin
		Frame Stud	60	063940000	Sideplate
22-24		Hammer Ass'y. Includes:	61	061170000	Sideplate Button, N.I.
22		Hammer (1)	—	060750000	Slide
		Stirrup	62	069560000	Slide Stop Ass'y. Includes:
24		Stirrup Pin	63-66	064820000	Slide Stop & Pin Ass'y.
		Hammer Pin, N.I.	63	064830000	Slide Stop Pin
25		Insert	—	060820000	Slide Stop Plunger
26		Insert Pin	64	060830000	Slide Stop Plunger Spring
27-31		Magazine Ass'y. Includes:	65	068710000	Slide Stop Spiral Pin
27		Magazine Butt Plate	66	064700000	Slide Stop Button
28		Magazine Butt Plate Catch	67	060810000	Stock Ass'y., Ch'k'd.
29		Magazine Follower	68-69	161090000	Walnut Includes:
30		Magazine Spring			Stock, Lt. (1)
31		Magazine Tube	68	061330000	Stock, Rt. (1), N.I.
32		Magazine Catch	69	062210000	Stock Screw
33		Magazine Catch Nut	70-73	063610000	Trigger Ass'y. Includes:
34		Magazine Catch Plunger	70	061530000	Trigger (1)
35		Magazine Catch Spring	71	068780000	Trigger Plunger
36		Mainspring	72	060110000	Trigger Plunger Pin
37		Mainspring Plunger	73	061220000	Trigger Plunger Spring
38		Manual Safety	74	060310000	Trigger Pin
39		Manual Safety Plunger	75	061270000	Trigger Play Spring
40		Manual Safety Plunger Spring	76	061260000	Trigger Play Spring Rivet
		Rear Sight Body Ass'y.	77	064930000	Manual Safety, Ambidextrous
		Includes:			Manual Safety, Rt. Side
41		R. S. Body	78	064980000	Lever
42		R. S. Elevation Screw	79	064910000	Manual Safety Screw

*Requires Factory Installation

(1): Sold as an Assembly Only
N.I.: Not Illustrated

SPECIFICATIONS

Caliber	9mm Luger and Parabellum	Sights	Fixed, 1/8-inch serrated ramp front; Fully adjustable rear sight adjustable for windage and elevation
Magazine Capacity	8	Stocks	Checked walnut with S&W Monograms
Barrel Length	4 inches	Finish	S&W Blue or Nickel
Length Over All	7 1/16 inches	Ammunition	9mm Luger and Parabellum
Weight, Aluminum	29 oz. (822g) without magazine		
Steel	36 oz. (1021g) without magazine		

Smith & Wesson will refinish handguns of its own manufacture. No change of finish is offered on the Victory or Airweight® model or on Models 28, 39, 59, 60, 63, 64, 65, 66, 67, 439, 459, 629, 681, or 686. Repair or replacement of parts are in addition to refinishing price.

SERVICE

Should your Smith & Wesson revolver require adjustment, repair, or refinishing, we recommend most sincerely that the weapon be returned to the factory or authorized service center. There is no other way to insure that the work will be done in a properly equipped and staffed shop.

Charges are very reasonable, being based on the cost of parts replaced plus a labor charge for the time expended on the job. A labor charge for one hour is usually sufficient to cover all but very extensive overhaul jobs.

Revolvers returned to the factory or authorized service center should be MARKED FOR THE ATTENTION OF THE SERVICE

DEPARTMENT. A letter of instructions should be enclosed with the gun, and shipment must be made Prepaid. Adherence to these suggestions will prevent loss of time in handling at the factory.

When returning guns for service, please remove custom stocks and holsters. We cannot assume responsibility for these items.

When your revolver arrives for service, it will be very carefully inspected, together with your letter of instructions. Next, a quotation covering total cost of work to be performed will be sent to you. No actual work will be commenced before receiving your approval of our quotation.

**SEE YOUR AUTHORIZED SMITH & WESSON
SERVICE CENTERS LIST FOR YOUR LOCAL SERVICE CENTER**

SMITH & WESSON DOUBLE ACTION 9MM AUTOMATIC PISTOL

INSTRUCTIONS FOR USE

Before proceeding to use this weapon, a word of caution is in order. This pistol is as safe to handle and use as we can make it, but there is no fool-proof firearm. Be sure that the muzzle is pointing in a safe direction at all times, whether the gun is loaded or not. Make safe gun handling a habit.

To Load

Magazine capacity is 8 rounds. Release magazine by pressing magazine catch nut on left side of frame back of trigger guard. Hold MAGAZINE in one hand with the rounded or forward edge away from the palm. Place a cartridge on the forward end of the FOLLOWER, press down and to the rear with the cartridge head or base toward the rear of flat edge of the MAGAZINE. Succeeding cartridges are loaded in the same manner, one on top of another.

Place MANUAL SAFETY in the lower or "safe" position. Insert MAGAZINE in butt until engaged with MAGAZINE CATCH. Simply press magazine into place — do not drive in forcibly, as this practice may in time cause distortion of magazine lips and resultant malfunctions. Draw SLIDE all of the way to the rear and release. With HAMMER down and SAFETY in "safe" position, the first shot may be discharged by simply placing the MANUAL SAFETY in the upper or "fire" position and pulling the TRIGGER. The DOUBLE ACTION FEATURE cocks and releases the HAMMER in one operation as in firing a double action revolver. Subsequent shots may be fired as in traditional automatic pistols.

Upon firing the last round, the SLIDE STOP engages the SLIDE holding the action open. The MAGAZINE may now be withdrawn and reloaded. To release the SLIDE STOP press downward. When SLIDE STOP is disengaged, SLIDE will move forward to closed position. If it is desired to continue firing, the SLIDE may be left open and a loaded MAGAZINE inserted, in which case the slide can be released by drawing the slide rearward to its limit and letting it spring to battery position.

Note that a cartridge in the CHAMBER cannot be fired when the MAGAZINE is disengaged from the MAGAZINE CATCH. This is a valuable safety feature.

When unloading a loaded pistol, put MANUAL SAFETY in "safe" or low position. Press MAGAZINE RELEASE BUTTON and remove MAGAZINE. Next, draw SLIDE to rear, thus removing loaded cartridge from the CHAMBER.

The cartridges in the MAGAZINE may be removed by pushing forward on the head of each cartridge until it is released from the MAGAZINE LIPS.

To Disassemble (Field Strip)

1. Remove MAGAZINE by pressing MAGAZINE RELEASE BUTTON on left side of FRAME to the rear of TRIGGER GUARD, and drawing MAGAZINE out of BUTT.
2. Inspect CHAMBER to assure that pistol is not loaded.
- ~~3. Put SAFETY in "fire" or upper position.~~
4. While pressing to left on right end of SLIDE STOP (above TRIGGER on right side of FRAME) draw SLIDE to rear until RECESS in the lower left side of SLIDE is aligned with forward end of SLIDE STOP. Draw SLIDE STOP completely from FRAME.
5. Pull SLIDE forward off from FRAME.
6. With SLIDE upside down, compress RECOIL SPRING and lift out RECOIL SPRING GUIDE ASSEMBLY.
7. Remove BARREL BUSHING by rotating lower portion toward left side of SLIDE and drawing forward out of SLIDE.
8. Remove BARREL by lifting rear end back and out of SLIDE.

No further disassembly is recommended, as the pistol may be properly cleaned and lubricated when field-stripped as described above.

To Reassemble

1. Replace BARREL in SLIDE.
2. Replace BARREL BUSHING.
3. Replace RECOIL SPRING and RECOIL SPRING GUIDE ASSEMBLY, making sure that RECOIL SPRING GUIDE BUSHING is engaged in the small radius cut in barrel lug and properly centered. Failure to center properly will leave RECOIL SPRING GUIDE protruding from BARREL BUSHING after assembly.
4. Replace SLIDE on FRAME, depressing EJECTOR, and SEAR RELEASE and FIRING PIN SAFETY LEVERS in turn, so that SLIDE will travel to rear over them. When slide stop cut on SLIDE is aligned with slide stop hole in FRAME, insert SLIDE STOP and allow SLIDE to return to forward position.
5. Replace MAGAZINE.

Care and Cleaning

Pistols should be field stripped and cleaned at reasonably frequent intervals to insure proper functioning.

Use any good commercial solvent, and after cleaning, lubricate sparingly with a light weight gun oil. Outside surfaces may be protected from corrosion by coating lightly with a rust inhibiting oil or grease.

Be careful not to drop magazines, as they may be sufficiently deformed to cause failure to feed properly.

To Disassemble Slide Assembly

NOTE: For pistols with ambidextrous safeties — remove the right side lever of the safety by unscrewing the button head cap screw utilizing a Hex wrench.

While depressing the firing pin safety plunger, press rear end of firing pin forward as far as possible with drift punch. The firing pin safety plunger may now be released. Grasp forward end of firing pin with pliers and hold. Turn manual safety thumbpiece to point halfway between "fire" and "safe" positions and press right end of safety bar. Manual safety may now be drawn out of slide. Hold thumb over rear end of firing pin, again depress firing pin safety plunger allowing the firing pin and firing pin spring to be removed. Manual safety plunger and plunger spring may also be removed from manual safety.

Remove extractor by inserting the blade of a screwdriver between the extractor and the extractor plunger, and prying the rear of the extractor outward. Extractor plunger and extractor spring may now be removed.

To Reassemble

Place slide on side and install extractor spring and extractor plunger in hole. Place extractor in the front of the extractor slot and press rearward until extractor snaps into place.

Replace manual safety spring and plunger in manual safety. Depress firing pin safety plunger and hold. Insert firing pin and spring. Push rear end of firing pin forward as far as possible. (Firing pin safety plunger may now be released). Hold forward end of firing pin with pliers. Insert manual safety until manual safety plunger contacts slide. Release grip on pliers and depress manual safety plunger, pressing manual safety into position.

Note: For pistols with ambidextrous safeties — reattach right side lever of the manual safety with the button head cap screw by using a Hex wrench.

To Disassemble Frame Assembly (After Removing Slide and Magazine)

Remove stocks by removing four stock screws. Drive out insert pin located just above lanyard loop. Remove insert by pulling lower portion of insert rearward. Mainspring and mainspring plunger may then be lifted out of insert. Pull out sideplate assembly on right side of frame. Lift out hammer and stirrup. Remove ejector, ejector spring, firing pin safety lever, and sear release lever and spring. Push sear pin out from either side of frame, allowing sear to drop out. Drive trigger pin out from left side, allowing drawbar to slide back toward rear of frame. Let disconnecter drop out, and pull drawbar and trigger play spring assembly out from rear of frame. Tip frame to vertical position, butt down, allowing drawbar plunger and spring to drop out. Push trigger upward and forward out of frame. Place frame on right side so magazine catch body is supported. Using drift, press down magazine catch plunger and hold. Turn magazine catch nut counter-clockwise to loosen.

To Reassemble Frame Assembly

Insert magazine catch body in frame. Support frame on solid surface and insert magazine catch spring and plunger. Depress plunger and assemble magazine catch nut. Turn until shank of magazine catch body is slightly below surface of nut. Release plunger and let it snap into notch.

Insert trigger downward through top of frame. Insert drawbar plunger and spring into hole forward of trigger. Insert drawbar through rear of frame, engaging drawbar plunger. Hold drawbar in position, and with frame bottom side up insert disconnecter.

Grasp trigger and work drawbar and trigger play spring assembly all the way forward so that rear of drawbar is under the foot of the disconnecter. Insert trigger pin. Be sure drawbar moves *under* foot of disconnecter.

Insert sear and sear pin, headed end of pin on right side of frame.

Hold trigger back and insert stirrup and hammer. Insert spring, sear release lever, and firing pin safety lever. Insert side plate stud through right side of frame, firing pin safety lever, sear release lever, and partially through hammer stud hole. Insert ejector spring in hole and set ejector in place. Press sideplate stud completely through hammer ejector and frame.

Place mainspring and mainspring plunger over stirrup. Bring insert into position by guiding mainspring plunger into recess in insert. Place top of insert in frame and swing base into place. Drive in insert pin.

Replace stocks and stock screws.



Smith & Wesson

a BANGOR PUNTA Company

P.O. Box 2208 • Springfield, MA 01101 U.S.A.

Printed in U.S.A.