



RG INDUSTRIES, INC.

2485 N.W. 20th STREET/P.O. BOX 862 BISCAYNE ANNEX/MIAMI, FLORIDA 33152

OPERATING INSTRUCTIONS

Unscrew and remove cylinder pin (RG 14: #2826) and cylinder will swing out to your left. Insert cartridges and swing cylinder back to original position. Insert and screw in cylinder pin. For unloading swing out cylinder, and eject each cartridge with cylinder pin.

RG 14 SWINGOUT REVOLVER

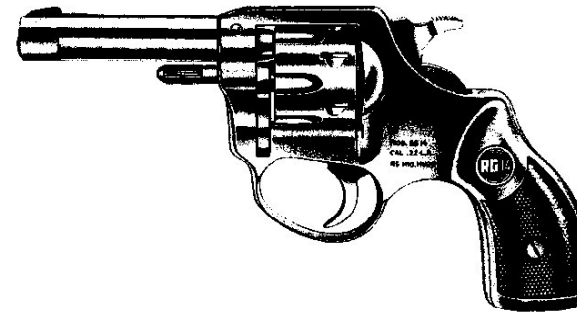

GENERAL RULES

Never point a weapon at anyone even when unloaded.

When loading and unloading point the muzzle to the floor.

Use only the caliber of ammunition which is stamped on the gun. When using reloads, be sure of proper load.

For the protection of others as well as yourself, always use extreme care. **You are handling something that is considered a firearm.**

RG assumes no responsibility for physical injury or property damage resulting from either intentional or accidental discharge of this weapon.

Stock No.	Model/Fin.	Cal.	Barrel Length	Overall Length	Capacity	Weight
0283901	RG 14 BL	22 LR	1¾"	5½"	6	15
0280001	RG 14 BL	22 LR	3"	6¾"	6	16



RG 14

Cal-22 LR

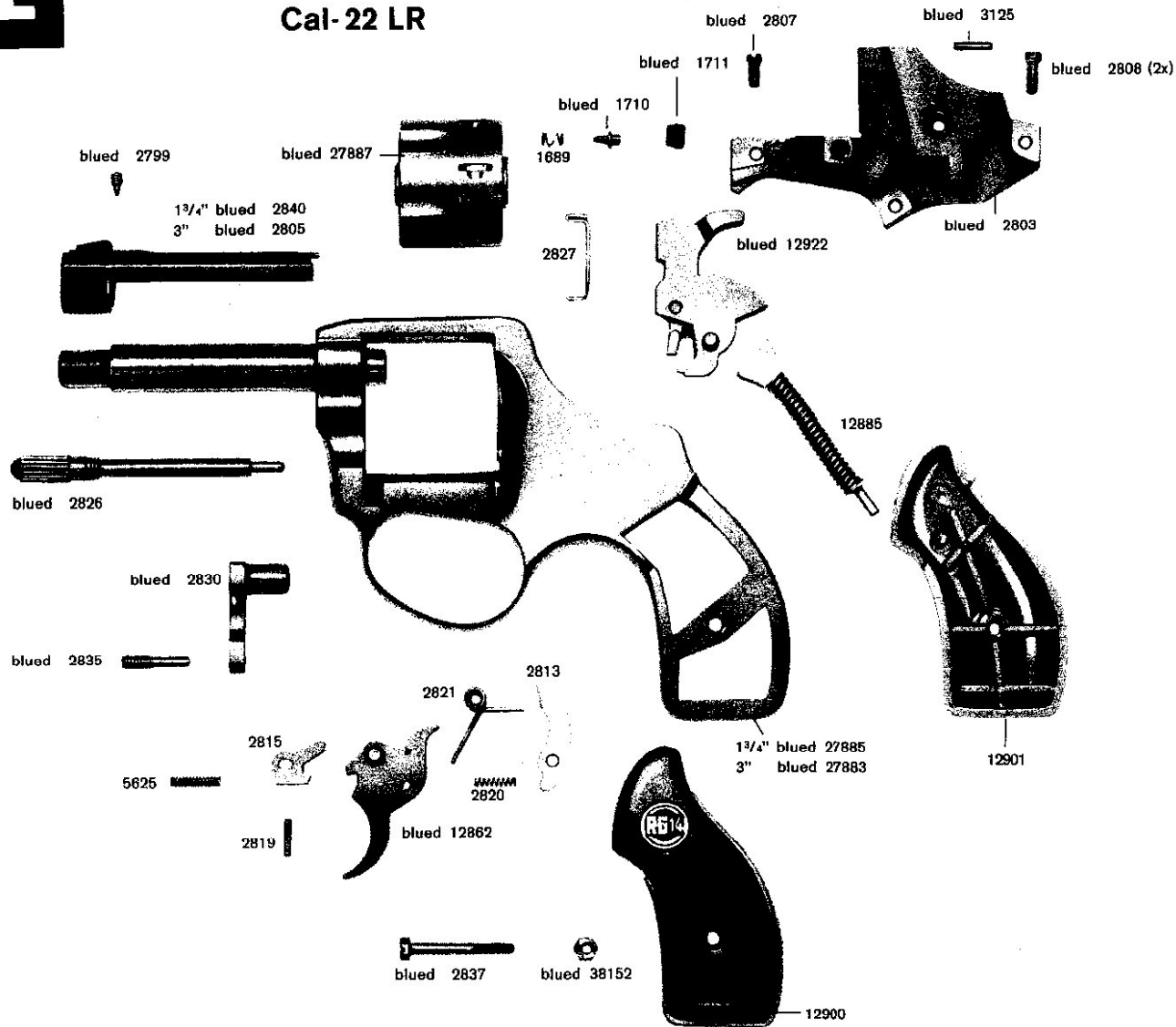

Stock No.	Description	List Price
1689	Firing pin spring	.40
1710	Firing pin, bl.	.40
1711	Firing pin sleeve, bl.	.40
2799	Barrel rib screw, bl.	.40
2803	Side plate, bl.	1.00
2805	Front sight, bl. 3"	1.00
2807	Plate screw, bl.	.40
2808	Plate screw, bl. (2x)	.40
2813	Hand	.60
2815	Cylinder stop	.40
2819	Straight pin	.40
2820	Pressure spring	.40
2821	Trigger spring	.40
2826	Cylinder pin, bl.	1.00
2827	Safety spring	.40
2830	Cylinder crane, bl.	.80
2835	Cylinder crane screw, bl.	.40
2837	Grip plate screw, bl.	.40
2840	Front sight, bl. 1 3/4"	.80
3125	Straight pin, bl.	.40
5625	Pressure spring	.40
12862	Trigger, bl.	1.80
12885	Main spring	.60
2809	Grip plate, left, compl.	1.00
2810	Grip plate, right, compl.	1.00
12922	Hammer, compl., bl.	2.20
*27883	Frame, bl. 3"	
*27885	Frame, bl. 1 3/4"	
2824	Cylinder, bl.	6.50
38152	Grip nut, bl.	.40

*must be factory fitted

PARTS ORDER INSTRUCTIONS: Although we strictly sell wholesale, parts may be obtained directly from us. Please order by model, cal. and parts number. Send your check together with your order and add \$2.00 to the total amount for postage and handling.