

Remington Arms Company, Inc.
870 Remington Drive
PO Box 700
Madison, NC 27025-0700
(336) 548-8700
800-243-9700

REMINGTON

Arms Company, Inc.

MODEL 31 REPEATING SHOTGUN

- **Shooting Safety Commandments**
- **Information**
- **Instructions for Operation & Care of Shotgun**
- **Components Parts Listing**
- **Value and Reference Book Listing**

NOTE: We are pleased to accommodate your request for the Model 31 Repeating Shotgun information. The following documentation represents all information available on this model from the Remington Arms Co., Inc.

DO NOT MAKE CHANGES OR ALTERATIONS TO ANY PARTS OF A FIREARM. USE ONLY REMINGTON PARTS. NEVER MAKE AN ADJUSTMENT TO THE TRIGGER, OR CHANGE THE SHAPE OR SIZE OF THE SEAR, SEAR NOTCH, OR OTHER PARTS.

Ten Commandments of Shooting Safety

1. Always keep the muzzle pointed in a safe direction.
2. Firearms should be unloaded when not in use.
3. Don't rely on your gun's "safety".
4. Be sure of your target and what is beyond it.
5. Use correct ammunition.
6. If your gun fails to fire when the trigger is pulled, handle with care!
7. Always wear eye and ear protection when shooting.
8. Be sure the barrel is clear of obstructions before shooting.
9. Do not alter or modify your gun, and have guns serviced regularly.
10. Learn the mechanical and handling characteristics of the firearm you are using.

JOBBER'S PRICE LIST
(CONFIDENTIAL—NET PRICES)



Remington
MODERN FIREARMS

June 21, 1932

Deliveries f.o.b. Ilion, N. Y.

WHOLESALE PRICES may be given to recognized Gun Dealers.

RETAIL PRICES to consumers and all others.

REMINGTON MODEL No. 31 - REPEATING SHOTGUNS - 12 Gauge
3 or 5-Shot, Side Ejection



FOR SPECIAL LONG RANGE BARRELS
see next page

Standard Length Barrel: 30 in. Option of 26, 28 or 32 inches;
Cylinder, Modified or Full Choke

	Net*	Whole-sale**	Retail**
No. 31A. "Standard" Grade.....	\$27.63	\$35.90	\$47.90
Extra barrel.....	10.79	14.00	18.70

Standard dimensions of stock, 14 inches long, 2 1/4 inches drop at heel, 1 1/4 inches drop at comb. Half pistol grip. Any other length or drop of stock made to order at an advance of.....

10.50	14.00	16.45	
No. 31R. "Riot" Grade.....	27.63	35.90	47.90
No. 31B. "Special" Grade.....	45.06	58.60	78.00
Extra barrel.....	10.79	14.00	18.70

Standard dimensions of stock same as 31A. Will furnish made to order drops from 2 inches to 3 1/4 inches at heel and 1 1/4 to 1 3/4 inches at comb, and lengths from 13 1/2 to 15 inches without extra charge. Stocks of dimensions outside of these limits will be subject to an additional charge of.....

*Jobber's net prices subject to 2 1/2% discount on full case lots—Barrel lengths and bores may be assorted.

	Net*	Whole-sale**	Retail**
No. 31D. "Tournament" Grade.....	\$78.69	\$102.30	\$136.40
Extra barrel.....	15.87	20.65	27.50
No. 31E. "Expert" Grade.....	118.04	153.45	204.60
Extra barrel.....	20.30	26.40	35.20
No. 31F. "Premier" Grade.....	157.38	204.60	272.80
Extra barrel.....	24.11	31.35	41.80

Nos. 31 D, E and F supplied with any grip length or drop desired without additional charge.

Raised solid matted rib, extra.....	4.52	6.00	8.00
Matted top surface of barrel, extra.....	4.62	6.00	8.00
Raised Ventilated rib (12 Gauge only), extra.....	11.76	15.30	20.40
Extras and parts (excepting barrels).....	15 & 17 1/2%	15% List Net	

NOTE—Only regular dimensions carried in stock. Special stocks require from five to eight weeks to make and orders for such are POSITIVELY NOT SUBJECT TO CANCELLATION.

REMINGTON Model No. 31 - TRAP GUNS - 12 Gauge
Remington No. 31TC with Ventilated Rib

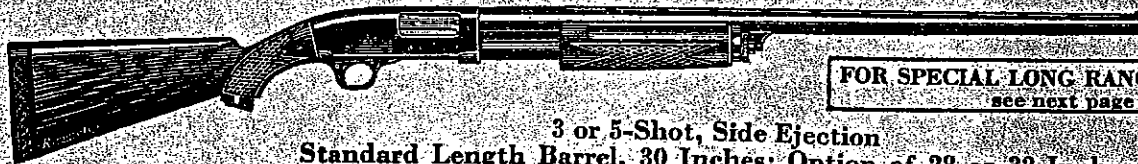

FOR SPECIAL LONG RANGE BARRELS
see next page

3 or 5-Shot, Side Ejection
Standard Length Barrel, 30 inches; Option of 28 or 32 inches
Full Choke; Option of Modified Choke or Cylinder Bore

	Net*	Whole-sale**	Retail**
No. 31TC. "Target" Grade with Ventilated Rib.....	\$47.60	\$61.90	\$82.50
Extra barrel with Ventilated Rib.....	22.55	29.30	39.10

Standard stock dimensions, 14 1/2 inches long including Hawkin's recoil pad, 1 1/4 inches drop at heel, 1 1/2 inches drop at comb. Full pistol grip with cap; option of straight grip. Choice high grade walnut stock and fore-end.

NOTE—Only regular dimensions carried in stock. Special stocks require from five to eight weeks to make and orders for such are POSITIVELY NOT SUBJECT TO CANCELLATION.

*Jobber's net prices subject to 2 1/2% discount on full case lots.

	Net*	Whole-sale**	Retail**
No. 31S. "Trap Special" Grade with Raised Solid Rib or matted top surface of barrel.....	\$37.45	\$48.70	\$64.90
Extra barrel, matted or with Raised Solid Rib.....	15.41	20.00	26.70

Standard stock dimensions, 14 1/2 inches long including Hawkin's recoil pad, 1 1/4 inches drop at heel, 1 1/2 inches drop at comb. Half pistol grip; option of straight grip. American walnut stock and fore-end.

Shortening regular stock up to 1 inch, Nos. 31TC or 31S, extra.....	1.65	2.20	2.60
Special drop or greater length of stock, Nos. 31TC or 31S, extra.....	10.50	14.00	16.45

Nos. 31TC & 31S weight per case of one, 12 pounds

Remington No. 31S with Raised Solid Rib

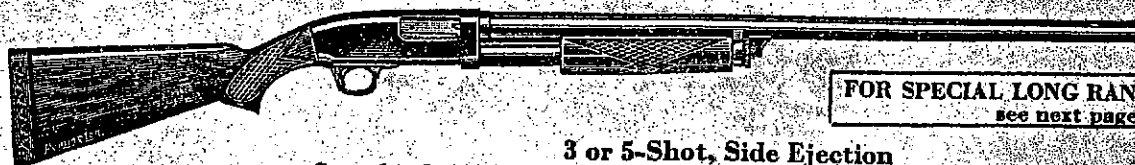

FOR SPECIAL LONG RANGE BARRELS
see next page

3 or 5-Shot, Side Ejection
Standard length barrel, 30 inches; Option of 28 or 32 inches.
Full Choke; Option of Modified Choke or Cylinder Bore

** EXCISE TAX INCLUDED

* U. S. EXCISE TAX OF 10% TO BE ADDED

ARMS WORKS
ILION, NEW YORK

REMINGTON ARMS COMPANY, Inc.
Bridgeport, Conn.

AMMUNITION WORKS
BRIDGEPORT, CONN.

MODEL 31 ACTION OPEN

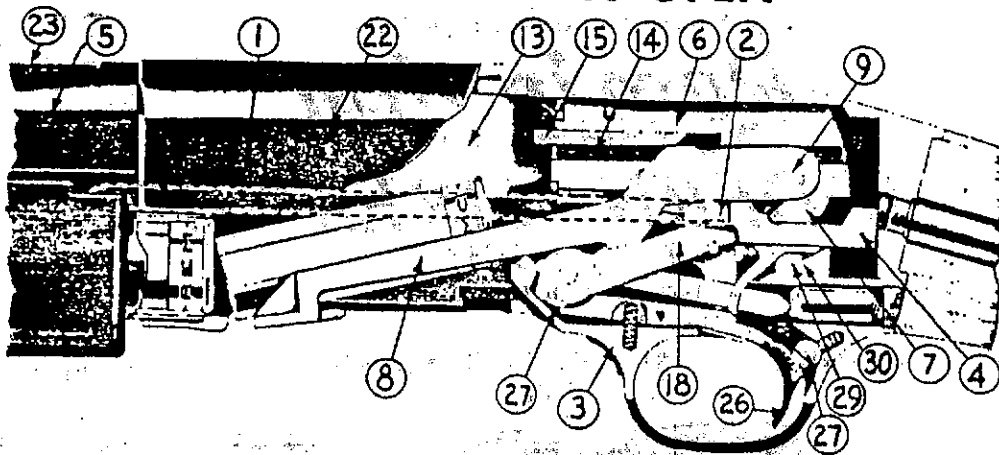

MODEL 31 ACTION CLOSED

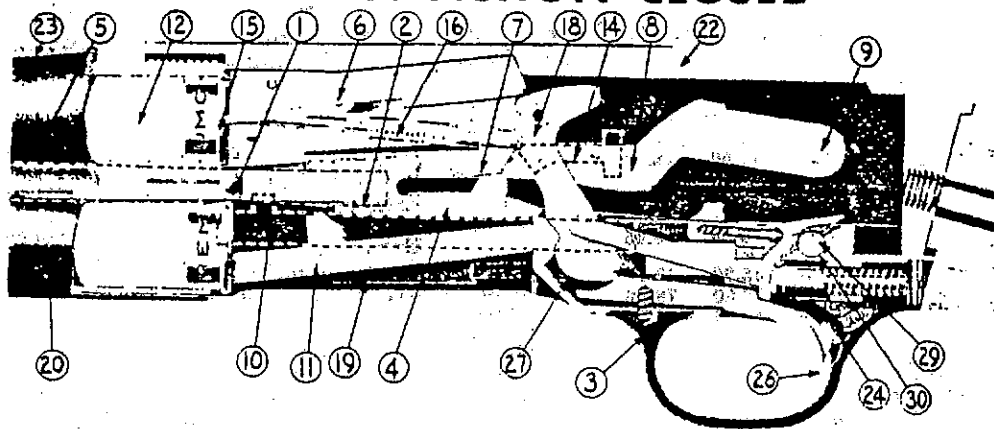

**"DISCONTINUED
NO PARTS AVAILABLE
FROM REMINGTON"**

PARTS LIST*

MODEL 31

- 1 Action Bar
- 2 Action Bar Lug
- 3 Action Release
- 4 Action Slide
- 5 Barrel
- 6 Breech Block
- 7 Breech Block Heel
- 8 Carrier
- 9 Carrier Pivots
- 10 Cartridge Stop (Right)
- 11 Cartridge Stop (Left)
- 12 Chamber
- 13 Ejection Port
- 14 Ejector
- 15 Extractors
- 16 Firing Pin
- 17 Fore-end
- 18 Hammer
- 19 Loading Slot
- 20 Magazine Tube
- 21 Pistol Grip
- 22 Receiver
- 23 Rib
- 24 Safety
- 25 Take Down Nut
- 26 Trigger
- 27 Trigger Plate (or Fire Control Mechanism)
- 28 Trigger Plate Lugs
- 29 Trigger Plate Pin
- 30 Trigger Plate Pin Hole

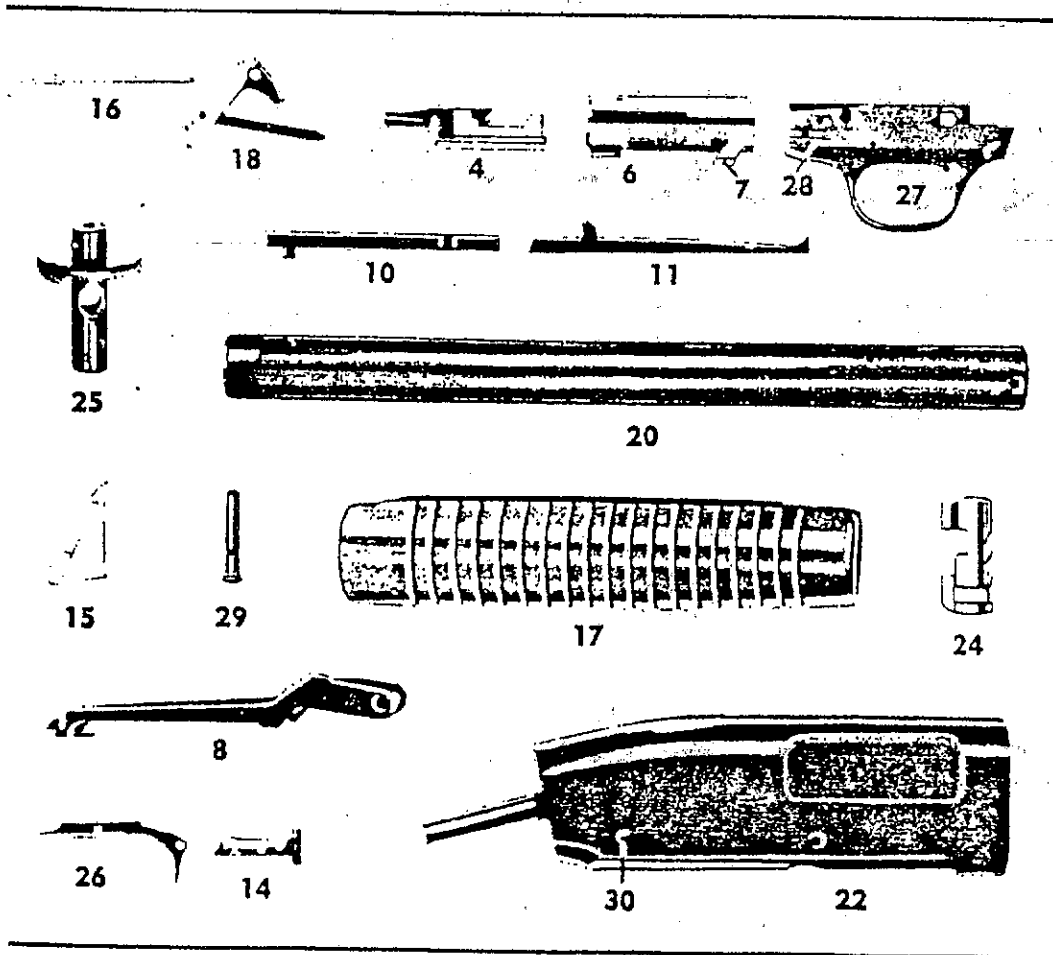

Do not use these numbers when ordering parts. Refer to instruction folder.

MODEL 31

REPEATING SHOTGUN

12, 16 and 20 Gauges — Side Ejection

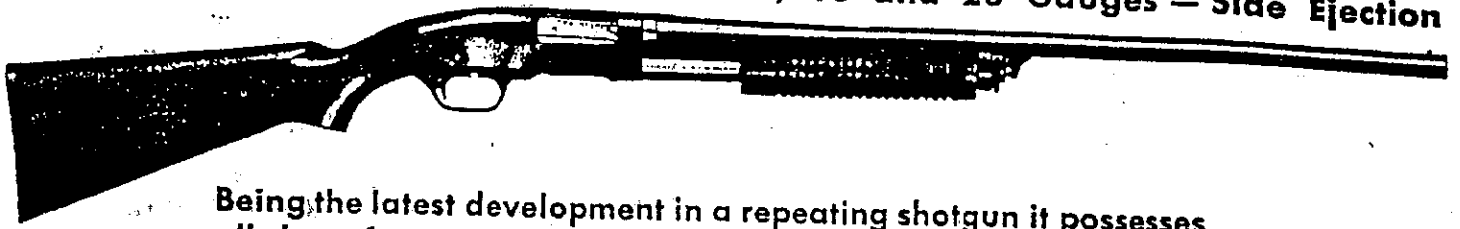

Being the latest development in a repeating shotgun it possesses all those features demanded by the discriminating sportsmen—beautiful lines, perfect balance, dependability, rugged construction, simplicity, ease and smoothness of operation, and hard shooting qualities.

Action Open

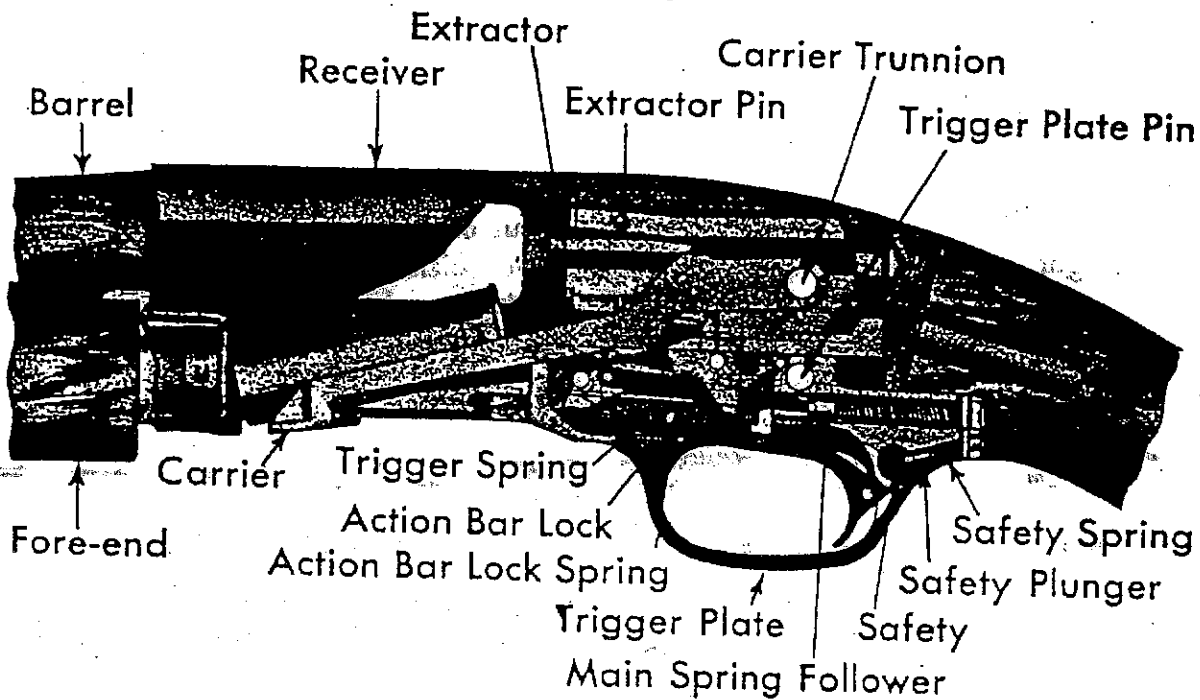

Action Closed

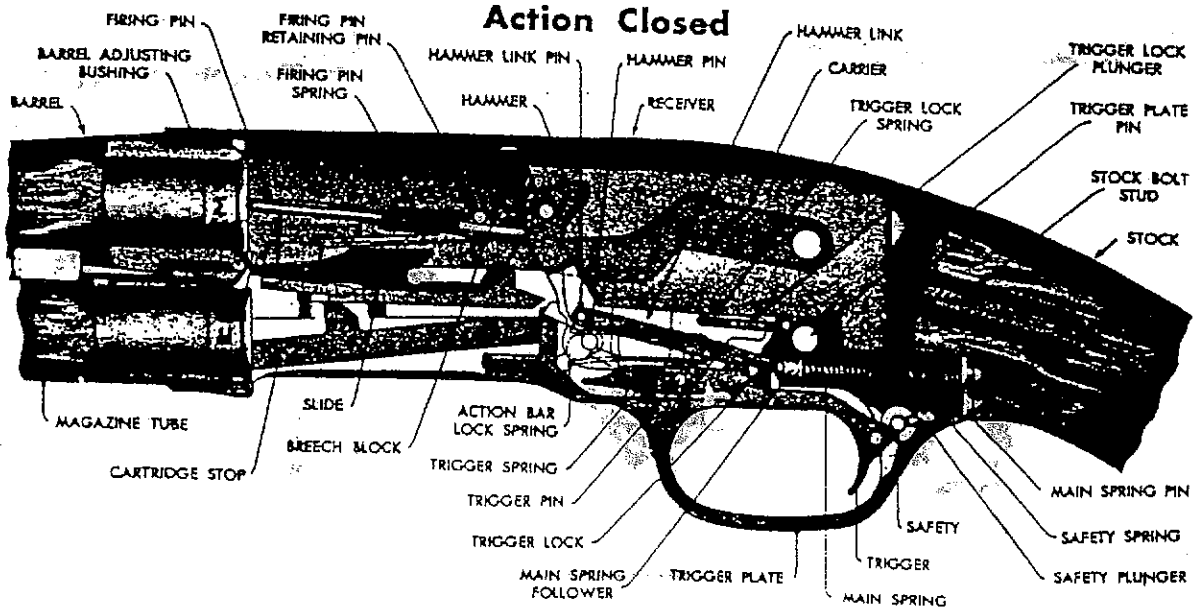

Features to Remember

FASTEST, EASIEST AND SMOOTHEST WORKING ACTION OF ITS TYPE. Parts are made and finished to the most exact precision, insuring perfect fit and smooth, dependable operation.

SHORTER FORE-END TRAVEL — Permits faster shooting.

PERFECT BALANCE — Weight evenly distributed, fast pointing, fast handling, "comes up" well—not muzzle light.

POSITIVE EJECTION assured by means of double extractors and sturdily constructed ejector, operated by a coil spring—not a flat spring that is liable to break.

MAGAZINE EASILY UNLOADED — Shells can be removed one at a time from the magazine without being worked through the action and without falling to the ground.

TRIGGER PULL — Light, snappy, permanently adjusted.

THE GRIP IS CORRECTLY SHAPED to permit a firm hold when gun is being fired, eliminating the possibility of absorbing recoil on middle finger.

COIL SPRINGS USED EXCLUSIVELY, minimizing the possibility of broken springs.

SINGLE LOADING FOR TRAPSHOOTING — Easily accomplished by dropping the shell into the opening on the right side of the receiver and closing the action.

POSITIVE FIRE CONTROL — Important safety feature. Trigger must be pulled and released for each shot. Constant pressure on trigger when closing the action will not fire the gun. Gun cannot be fired until action is completely closed and locked.

CROSS-BOLT SAFETY IS POSITIVE — Cannot be jarred out of place by recoil. Conveniently located for quick operation with trigger finger. Not easily moved "on" or "off" by accident.

Component Parts

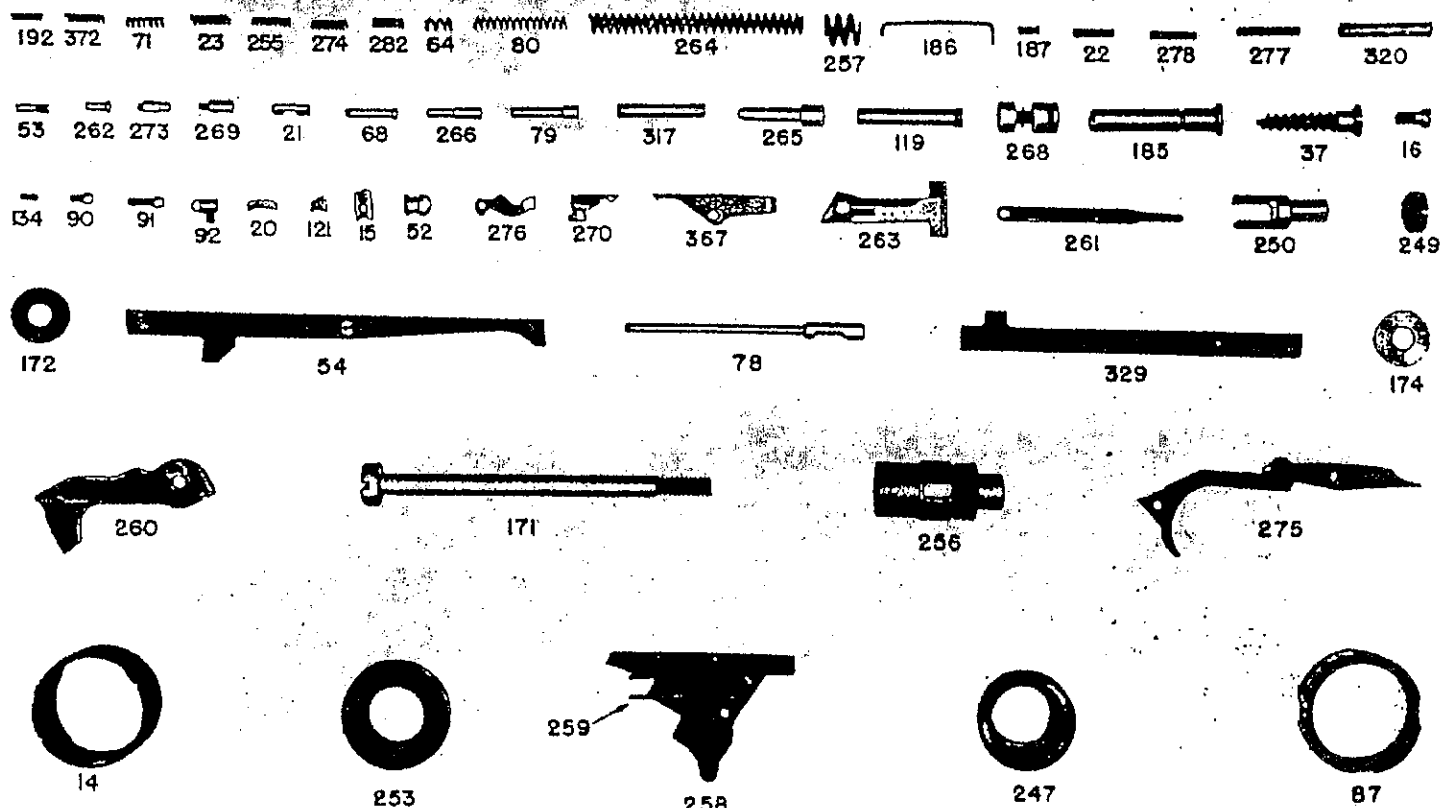

Firearms Value & Reference Books

NOTE: We do not provide information on firearms' values. You may want to have your firearm appraised by a gunsmith. The following sources may also be helpful. We do not accept responsibility for the goods or services provided by these sources.

Firearms Value Books

Blue Book of Gun Values

Blue Book Publications
8009 34th Avenue South #175
Minneapolis, MN 55425
800-877-GUNS

Flayderman's Guide to Firearm Values

Gun List
Modern Gun Values
Krause Publications
700 East State Street
Iola, WI 54990-0001
847-573-8530

Gun Trader's Guide

Stoeger Publishing Company
5 Mansard Court
Wayne, NJ 07470
973-872-9500

Reference Books

The Remington 700

John Flacy
Brownells, Inc.
200 South Front Street
Montezuma, IA 50171
515-623-5401

Cartridges of the World

Frank C. Barnes
Standard Catalog of Firearms
Krause Publications
700 East State Street
Iola, WI 54990-0001
847-573-8530

Shooter's Bible

Stoeger Publishing Company
5 Mansard Court
Wayne, NJ 07470
973-872-9500

Remington, America's Oldest

Gunmanker
Remington Arms Co.
PO Box 700
Madison, NC 27025
Attention: History Book
800-423-8495

