



*New Haven*

MODEL  
**251C**

.22 CALIBER AUTO-LOADING RIFLE

**F E A T U R E S**

1. BARREL — Tapered, blued steel with crowned muzzle and AC-KRO-GRUV rifling. Chambered ONLY for .22 caliber LONG RIFLE standard or high speed ammunition, dry or lubricated.
2. STOCK — Monte Carlo stock with plastic Butt Plate and molded Trigger Guard with finger grooves.
3. MAGAZINE — 15 shot capacity, STRAIGHT LINE FEED through the stock.
4. SAFETY — Positive safety, located "right under your thumb". Action can be locked in open position, locking both trigger and sear.
5. Receiver milled with dovetail slots for telescope mounting.
6. Self loading and ejecting. Shoots 15 shots as fast as the trigger can be pulled. Sufficient weight to prevent whip for better accuracy.
7. Bead type front sight.
8. Open sporting rear sight.
9. Weight 5½ pounds.

Do not "dry fire" since this has a tendency to crystallize the firing pin causing breakage.

A clean gun works better. Some types of ammunition foul the action quicker than others. Clean an automatic action after 500 rounds with gasoline if heavily coated with burnt powder-oil mixture. Lubricate action with light oil. DO NOT USE GREASE.

1. **TO TAKE DOWN** — Remove Front Swivel and Barrel Band (Model 351C Only). Loosen Take Down Screw and lift Barrel up.

**TO ASSEMBLE — HOLD TRIGGER BACK.** Set Receiver and Barrel into Stock, being sure that Sear Pin #32 goes into slots in Trigger #31 and that Magazine Housing #41 engages in cross slots in Receiver. THESE PARTS SHOULD GO TOGETHER EASILY. Press and hold Barrel into Stock and tighten Take Down Screw securely. On MODEL 351C, replace Front Swivel and Barrel Band.

**DO NOT REMOVE OUTSIDE MAGAZINE TUBE.** This feeding mechanism is accurately adjusted at the factory and could easily be distorted when out of the stock.

2. **TO LOAD** — Quarter-turn Magazine Plug #61 and pull out Inside Magazine Tube until Follower is clear of loading port. Then insert 15 or less LONG RIFLE cartridges through loading port in Stock. Be sure to have the lead bullets pointing forward toward Barrel. Push in and lock Tube.

With a reasonably fast motion, pull Cocking Knob #37 rearward as far as possible

and let go. This movement will insert the first cartridge in the chamber and the rifle is ready to fire. From this point on, it is only necessary to pull the Trigger for each shot until the Magazine is empty, as the loading and ejection are done automatically.

A special safety Sear prevents the Hammer from falling until the action is sufficiently closed. If at any time the Trigger does not release the Hammer, PUSH FORWARD ON COCKING KNOB TO CLOSE ACTION AND THUS RELEASE THE SEAR.

3. **SAFETY** — The Safety is located on the right side of the Receiver. To put on safe, pull back on the Safety Lever. To take off Safe, push Safety Lever forward.
4. **TO LOCK ACTION OPEN** — Pull Cocking Knob all the way back and press into recess in rear of Receiver slot.
5. **WHEN REMOVING LOADED CARTRIDGES FROM MAGAZINE** — If the action is locked fully open, be sure that the first cartridge, which is held by the Cartridge Cut Off #42 is removed. This will not slide out by tipping

the barrel upwards as the other cartridges will unless the action is closed.

6. **TO REMOVE BOLT** — Remove the Stock. Unscrew and remove Breech Plug #1, then slide Bolt back until the Cocking Knob lines up with the last hole in Receiver. Remove Cocking Knob by lifting straight out.

Grasp the Retracting Spring Bushing #3 which now projects from the rear end of the Receiver and slide the Bolt out.

7. **TO DISASSEMBLE BOLT** — Drive out Retaining Pin #62 after which Bolt can be taken apart.
8. **TO REASSEMBLE BOLT** — Place the Retracting Spring Plunger in the Retracting Spring Bushing so that the head of the Plunger goes into the cup of the Bushing. Slide the Retracting Spring and Mainspring over the plunger. Slide the Hammer over the Retracting Spring with the large hole of the Hammer toward the rear so that it goes over the front section of the Mainspring. Now push the Retracting Spring and Plunger into the Bolt until the hole in the Plunger

lines up with the hole in the Bolt. Keep the two holes lined up and push Pin into the hole. Then insert the Firing Pin in the slot with the square end to the rear and hooked into the Hammer.

9. **TO REPLACE BOLT IN RECEIVER** — Hold the Bolt with the Firing Pin on top and slide into Receiver until the large hole in the Bolt lines up with the last hole in the Receiver. Place the Cocking Knob in the hole with the double cut on the top and line up slots in Cocking Knob with the slots in the Receiver. Press in on the Sear #33 and slide the Bolt forward. Replace the Breech Plug and tighten in place. Unscrew until flat side of Plug is on the bottom.
10. **TO ADJUST THE REAR SIGHT** — If the rifle shoots low raise the rear sight leaf by sliding the elevation slide to the rear. If the rifle shoots high, lower the leaf by sliding the elevation forward. If the rifle shoots to the left, loosen the windage sighting plate screw and move the windage sighting plate to the right and then tighten the screw. If the rifle shoots to the right, loosen the windage sighting plate and slide the windage sighting plate to the left and then tighten the screw.

This rifle was tested at the factory for accuracy and the sights set, but owing to the differences in ammunition, eyes, method of holding and the possibility that someone has moved the adjustments it may be necessary for you to adjust the sights. When setting the sights use the same kind of ammunition that you will use when shooting the rifle.

11. **CAUTION** — Do NOT use match ammunition. WHEN USING HOLLOW POINT ammunition, do not load more than 5 or 6 cartridges as more will tend to flatten the nose of the bullet.

## SUGGESTIONS

Keep Take Down Screw tight.

If your rifle should jam, remove magazine and any live cartridges. Pull back on Cocking Knob and be sure that the barrel is not pointing at something you do not want to hit. After finding the cause of the jam, remove the offending cartridge before allowing bolt to close.

Misfires are usually caused by a dirty action.

If hammer is cocked, there will be an opening in rear of cocking knob slot on receiver.

## DON'T BLAME THE GUN

This rifle was triple tested with all types of ammunition before leaving the factory.

All automatic .22 caliber rifles are solely dependent on pressures to operate the action. Occasionally, you may find a cartridge too weak to operate the action because the pressures are not up to standard. If you should fire a cartridge that gives a faint report or a report that sounds weak, be sure to check the barrel before firing another shot, as the bullet from the weak sounding cartridge may still be in the barrel. Should a bullet become lodged in the barrel from this or from a so-called "squib" load (one that does not ignite all the powder), force it out with a ramrod. **DO NOT ATTEMPT TO SHOOT IT OUT AS THIS IS DANGEROUS** and may result in the barrel forming a pressure bulge, crack, or break. If you have trouble of this nature, try ammunition of another lot.



# MODEL 251C PARTS LIST

Part Number	Name	Price Each
1 - 1065	Breech Plug .....	\$1.50
2 - 1091	Retracting Spring Plunger ....	.40
3 - 473	Retracting Spring Bushing ..	.35
4 - 1092	Mainspring .....	.30
5 - 291	Retracting Spring .....	.30
6 - 2377	Hammer .....	1.50
7 - 2650	Bolt complete, includes 2378, 1091, 1092, 1323, 2377, 2192, 291, 473 .....	6.50
1299	Bolt only .....	3.00
1323	Bolt with Extractor, includes 1299, 1093, 471, 481 .....	4.00
8 - 2378	Firing Pin .....	1.40
9 - 1093	Extractor Pin .....	.20
10 - 1087	Ejector .....	.55
11 - 1445	Disconnecter Pin .....	.20
12 - 1317	Retaining Ring .....	.20
13 - *1450	Receiver .....	7.00
14 - 2204	Safety Pin .....	.35
15 - 1444	Safety Lever .....	.50
16 - 1210	Retaining Ring .....	.20
17 - 763	Deflector .....	.40
S141	Sporting Rear Sight, complete	1.50
18 - 2342	Elevation Slide .....	.30
19 - 1440	Windage Plate .....	.25
20 - 1453	Washer .....	.20
21 - 1441	Windage Plate Screw .....	.20
22 - 1439	Base .....	.40
23 - *3045	Barrel, 18 1/2", Model 251C	9.50
*3045A	Barrel and Receiver, Model 251C .....	11.25
24 - 2321	Beaded Front Sight .....	.85
25 - 481	Extractor Spring .....	.20
26 - 471	Extractor .....	.70
27 - 1443	Disconnecter Bracket .....	.70
28 - 1454	Disconnecter Bracket Screw, rear .....	.20
29 - 479	Disconnecter & Sear Spring ..	.40
30 - 2348	Disconnecter Bracket Screw, front .....	.20
31 - 1304	Trigger .....	1.40
32 - 1353	Sear Pin .....	.20
33 - 1300	Sear .....	1.75
34 - 1320	Disconnecter .....	.70
35 - 306	Trigger Spring .....	.20
36 - 301	Take Down Stud .....	.50
37 - 1120	Cocking Knob .....	.85
38 - 286	Tension Spring Screw .....	.20
39 - 285	Tension Spring .....	.50
40 - 302	Take Down Bushing .....	.50
41 - 278	Magazine Tube complete, outside .....	2.10
42 - 260	Cartridge Cut Off .....	.50
43 - 261	Cartridge Cut Off Spring .....	.35
48 - 3047	Stock complete .....	12.50
49 - 1146	Take Down Screw .....	.40
50 - 305	Trigger Pin .....	.20
51 - 147	Trigger Guard Screw .....	.20
52 - 943	Trigger Guard .....	.70
59 - 569	Butt Plate .....	.70
60 - 624	Butt Plate Screw .....	.20
61 - 281	Magazine Tube complete, inside .....	2.50
62 - 2192	Retaining Pin .....	.20

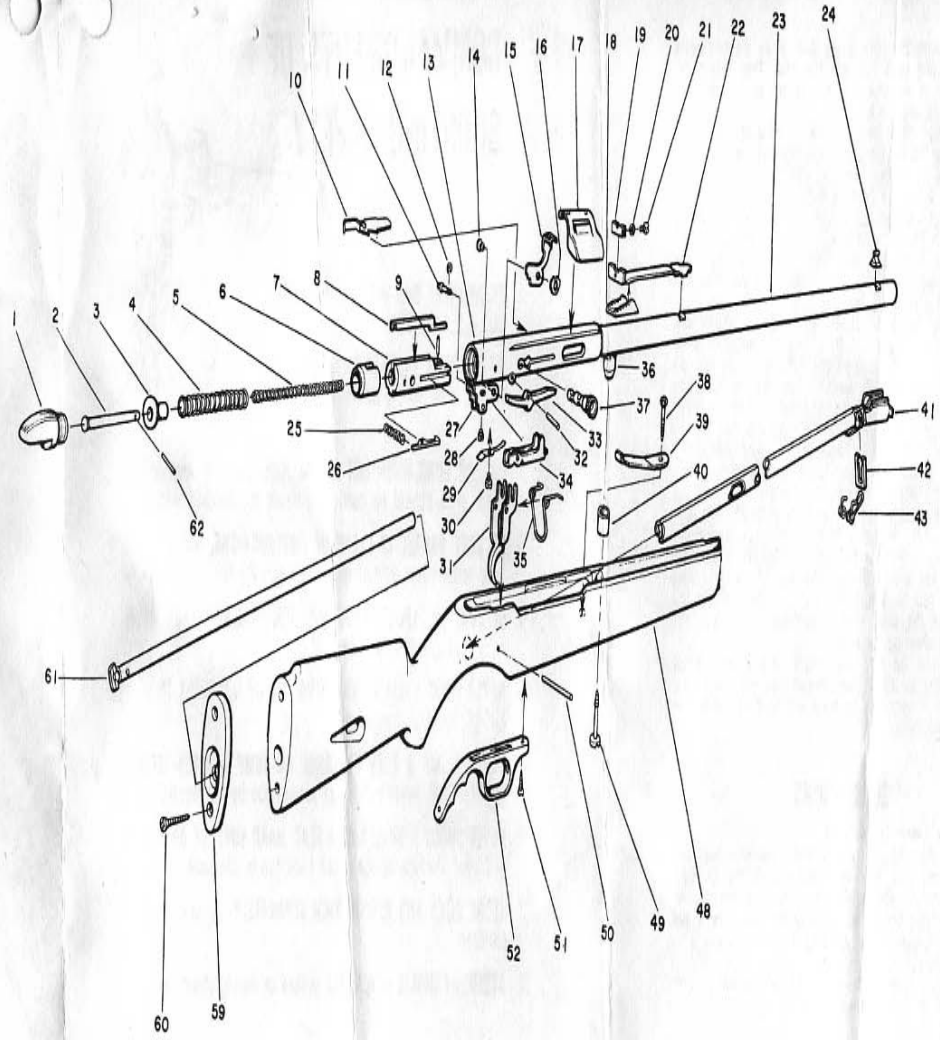

\*Gun must be sent to factory or to a competent gunsmith to have this part fitted. When ordering parts, use complete Part Number and Model Number as stamped on barrel. Prices are subject to change without notice.

NO ORDER ACCEPTED UNDER \$1.00.