

# MUZZLE LOADING ROLLING BLOCK

## Disassembling the Frame

### Tools required

- Medium and small screwdrivers
- Hammer
- 1/40" brass punch
- 1/16" steel punch

\*\*\* (N/E) = NOT ESSENTIAL \*\*\*

**1** (N/E) Undo the screw at the top rear of the tang and pull the butt off, it may be tight so slap the front of the comb with your hand.

**2** Looking at the left side of the receiver you will see the hammer and breech block axis pins; in-between is a plate (the button). Remove the screw that secures it and take the button off. Note both pins have flat faces that engage with the sides of the button to stop them rotating. These face inwards.

**3** Cock the hammer and drive or push out the forward (breech block) axis pin to the left with the brass punch. As the pin clears the block will jump up slightly.

**4** Lower the hammer and push it down/forward past its normal position and tap or push out its pivot pin to the left and lift it up and out.

**5** N/E Undo the two screws at the front and rear of the left side of the receiver (lower edge) and pull the trigger mechanism out. These can be very tight, so it's important to use the correct sized blade.

And that's pretty much that. At this stage you have access to the breech block should you need to remove the firing pin or replace the trigger and hammer springs.

### Back together

NOTE: For breech block and hammer insertion, both axis pins go in from the left with the flange end last.

**1** Drop in the hammer and push it forward so you can insert the axis pin through the left side of the receiver.

**2** Cock the hammer.

**3** In this position, slide the block back in and align and insert its pivot pin here. Downwards pressure must be applied to the block to allow easy operation.

**4** Reposition the trigger plate and re-fit the front retaining screws. Once in position, push a long screwdriver up through the rear of the action to ensure the main spring engages the lobe at the rear of the hammer. Re-fit the rear retaining screw.

**5** Re-position the button between the pivot pins and re-fit the retaining screw. This can only be achieved if both flats are facing inwards.

**6** Re-fit the butt and insert the stock screw.

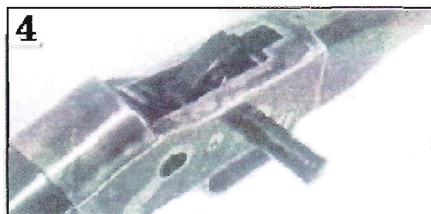

# ROLLING BLOCK MUZZLELOADER RIFLE

## How to disassemble the nipple and the breech plug

**Make sure the gun is unloaded**

- 1A** Cock the hammer (20)
- 2A** Withdraw the breech block (28)
- 3A** With the nipple and breech wrench (46) it is possible to get between the breech block and the barrel to unscrew the nipple and the breech plug.

## How to disassemble the barrel from the frame

**Make sure the gun is unloaded**

- 1B** Unscrew and remove the forend screw (10)
- 2B** Loosen, without removing, the screw (49) which is inside the hole previously closed by the screw (10) using the proper hexagonal wrench (51)
- 3B** Loosen the screw (49) slightly, such to move the rear band (8a) and push forward the forend (13), to disassemble it from the frame (19)  
Pay attention to the ramrod spring (6) which can engage the forend (13) hampering disassembling. In this case keep the spring slightly compressed using a screwdriver or a punch.
- 4B** If you need to remove the rear band (8a) from the barrel, it will be necessary:
  - A) disassemble the front sight
  - B) disassemble the front and middle bands (8-9) undoing the screws (17)
- 5B** Cock the hammer (20)
- 6B** Withdraw the breech block (28)
- 7B** Using the wrench (2) (eventually helping with the wrench 46) undo the blocking ring (3) counterclockwise
- 8B** Keeping the rifle in a standing position with the muzzle at the top, tap on the frame front, using a wood or plastic hammer, until the barrel separates from the frame.
- 9B** To reassemble the rifle work in reverse order

## How to change the musket firing pin

- 1C** To replace the firing pin, please follow instructions points 1-2-3 of the enclosed page (disassembling the frame)
- 2C** Pay attention that once the breech block is disassembled from the rifle, do not uncock the hammer or the mainspring (26) will get out of alignment and placing it back can be difficult.
- 3C** When the breech block is disassembled, undo the screw (41) remove the spring (42) and the firing pin ball (43)
- 4C** Remove the pin (44) using the 1/16" punch and remove the firing pin retractor (23)
- 5C** Remove the firing pin (30)
- 6C** To reassemble the firing pin (30) follow instructions in reverse taking care backwards, caring to place the firing pin in the correct position with the cut on the bottom, such that the firing pin retractor lever (23) can fit into this cut.
- 7C** To change the nipple from one model to an other, use wrench (46).

# Fucile Rolling Block Rolling Block rifle Fusil Rolling Block

S.882

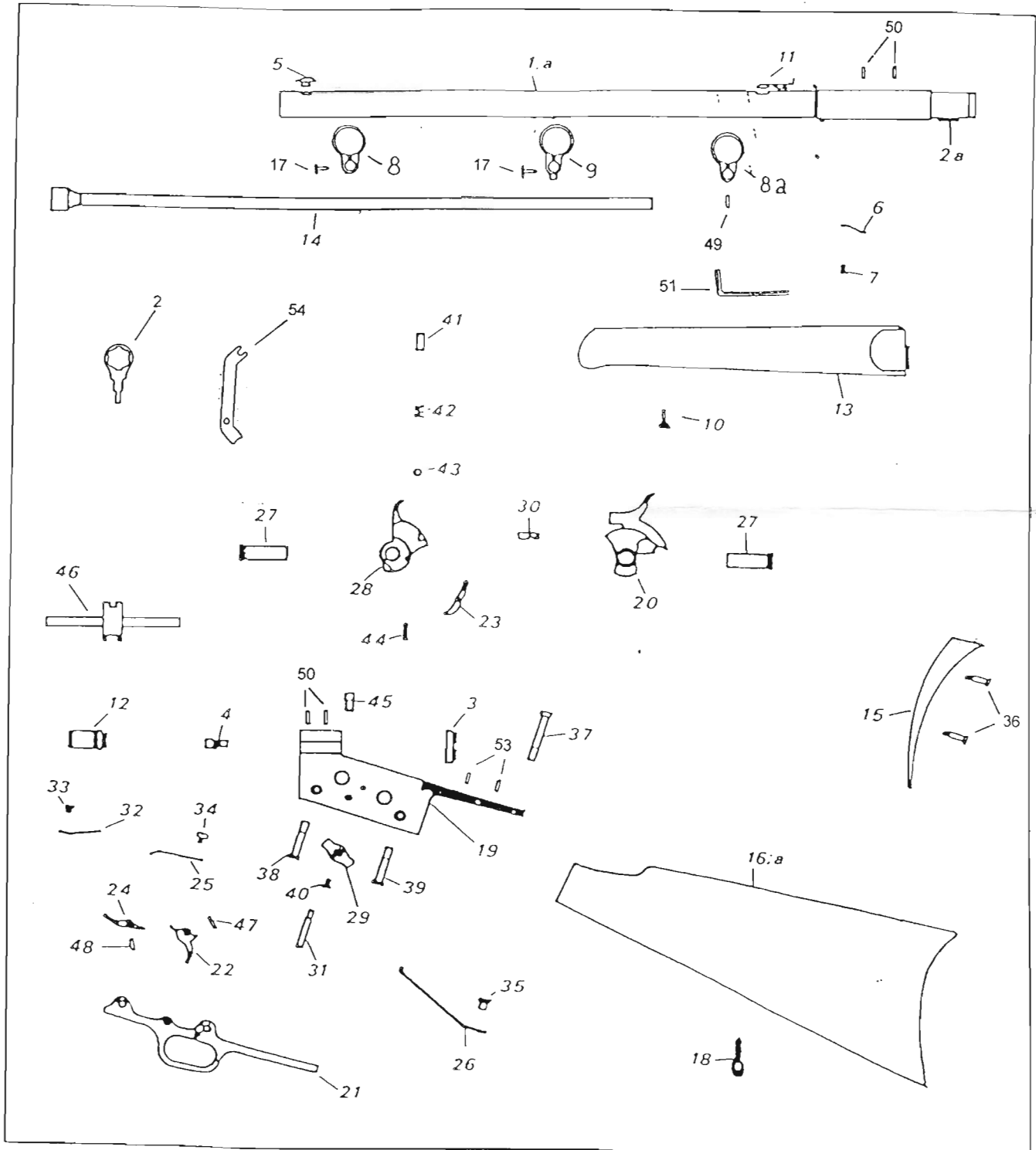

Nomenclatura / List / Liste				Codice Reference
No.	Italiano	English	Français	Référence
1	Canna cal. .50	Barrel .50 cal.	Canon Cal 50	M860002703
1a	Canna cal. .50 completa	Barrel .50 cal. with spares	Canon Cal 50 complet	M86002703B
2	Chiave per ghiera	Ring wrench	Clef pour la bague de blocage	M860002652
2a	Chiavetta posizionamento canna	Position barrel stud	Tenon pour positionner le canon	M860002548
3	Ghiera bloccaggio	Blocking ring	Bague de blocage	M860003213
4	Luminello capsule moderne	Shotgun primer nipple	Cheminée pour amorces modernes	M860003562
5	Mirino con fibra ottica	Fiber optic front sight	Guidon en fibre optique	M860003791
6	Molla bacchetta	Ramrod spring	Ressort de baguette	M860003685
7	Vite molla bacchetta	Ramrod spring screw	Vis du ressort de baguette	M70PFC5403
8	Fascetta anteriore	Front band	Bande antérieure	M860002988
8a	Fascetta posteriore	Rear band	Bande postérieure	M860002989
9	Fascetta intermedia	Middle band	Grenadière	M860002990
10	Vite astina	Forend screw	Vis fût ou devant	M70TFC5239
11	Tacca di mira con fibra ottica	Fiber optic rear sight	Cran de mire en fibre optique	M860004975
12	Tappo canna	Breech plug	Bouchon de culasse	M860004960
13	Astina	Forend	Fût ou devant	M870002055
14	Bacchetta in fibra completa	Glass fiber ramrod with jag	Baguette en fibre avec porte-chiffons	M870002326
15	Calciolo in gomma	Butt plate	Plaque de couche	M870002848
16	Calcio	Stock	Crosse	M870003500
16a	Calcio finito	Stock finished	Crosse ouvragé	M87003500A
17	Vite fascetta ant./inter.	Front and middle band screws	Vis de bande antér. et de grenadière	M70PFC5240
18	Vite posteriore per portacinghia	Rear screw for swivel	Vis postérieur pour battant	M70SPC5244
19	Bascula	Frame	Bascule	M880002283
20	Cane	Hammer	Chien	M880002472
21	Sottoguardia	Trigger plate	Sous-garde	M880003015
22	Grilletto	Trigger	Détente	M880003032
23	Leva recupero	Firing pin retractor	Levier de rappel	M880003416
24	Leva scatto	Sear	Gâchette	M880003418
25	Molla grilletto	Trigger spring	Ressort de détente	M880003636
26	Molla cane	Mainspring	Ressort du chien	M880003637
27	Perno cane e portapercussore	Breech block and hammer pin	Pivot du chien et porte-percuteur	M880004237
28	Portapercussore	Breech block	Porte-percuteur	M8800V4238
29	Piastrina bascula	Frame plate	Platine de bascule	M880004240
30	Percussore	Firing pin	Percuteur	M880004320
31	Perno bloccaggio leva	Retractor pin	Pivot de blocage	M70SPC5456
32	Molla leva scatto	Sear spring	Ressort de gâchette	M870003613
33	Vite molla leva scatto	Sear spring screw	Vis du ressort de gâchette	M70TFC5367
34	Vite molla grilletto	Trigger spring screw	Vis du ressort de détente	M70TFC5261
35	Vite molla cane	Hammer spring screw	Vis du ressort du chien	M70PFC5423
36	Vite calciolo	Butt plate screw	Vis de plaque de couche	M70LFC5395
37	Vite codetta	Tang screw	Vis de queue de bascule	M70TFM5554
38	Vite anteriore sottoguardia	Front trigger plate screw	Vis antérieure de sous-garde	M70PFM5260
39	Vite posteriore sottoguardia	Rear trigger plate screw	Vis postérieure de sous-garde	M70PFM5260
40	Vite piastrina bascula	Frame plate screw	Vis de platine de bascule	M70TFC5367
41	Vite recupero percussore	Firing pin screw	Vis de rappel percuteur	M700ST5479
42	Molla recupero percussore	Firing pin spring	Ressort de rappel percuteur	M880003743
43	Sfera recupero percussore	Firing pin ball	Bille de rappel percuteur	M880004700
44	Copiglia recupero percussore	Firing pin, pin	Goupille rappel percuteur	M70COP5373
45	Vite bloccaggio ghiera	Ring screw	Vis de blocage bague	M700ST5480
46	Chiave luminello e tappo canna	Nipple and breech plug wrench	Clef cheminée et bouchon de culasse	USA 013
47	Copiglia grilletto	Trigger pin	Goupille de détente	M70COP5382
48	Copiglia leva scatto	Sear pin	Goupille de gâchette	M70COP5382
49	Grano fascetta posteriore	Rear band screw	Vis de bande postérieure	M700ST5243
50	Grano canna/bascula	Barrel and frame screws	Vis du canon et du bascule	M700ST5242
51	Chiave grano fascetta posteriore	Wrench for rear band screw	Clef pour vis de bande postérieure	M860002845
52	Tenone	Tenon	Tenon	M860004889
53	Grano chiusura fori diottra	Screw for diopter mounting hole	Vis du trou montage dioptr	M700ST5481
54	Leva capsule	Shotgun primer decapper	Désamorçeur	M860003563