



LEMAT® REVOLVER INSTRUCTIONS

(Addendum to Navy Arms Percussion Revolver Shooting and Maintenance Instructions)

Step #1 - Cylinder is chambered for the ever popular .451 cal. round ball. Loading procedures of the LeMat revolvers are identical to standard revolvers as described in the enclosed booklet. However, the loading lever situated on the left hand side of the frame is operated by moving it in an upward direction thereby causing the rammer head to seat the ball into the chamber.

To fire the revolver, the face of the chamber selector should be in the uppermost position.

Step #2 - LOADING THE LOWER BARREL

The lower barrel is .65 caliber and is intended to shoot a .63 cal. patched round ball with a charge not to exceed 25 grains of FFFg. powder.

TO LOAD:

1. Ensure that bore is free of any obstruction and oil residue.
2. Ensure that nipple is clear by firing a cap without a main charge.
3. Using a powder measure, carefully measure the aforementioned 25 grains of FFFg. black powder and pour into barrel with revolver held in the upright position.
4. Place a pre-lubricated patch and .63 cal. round ball in the .65 caliber smoothbore barrel and ram home using the conveniently situated ramrod located in the main rammer housing. This is simply extracted by placing thumb and forefinger on the flat circular projection and pulling out.
5. Return ramrod to original housing.
6. To fire .65 caliber SB barrel, place hammer in half cock position and place cap onto nipple located in the center of the frame.
7. In order to fire, depress the barrel selector located on the hammer nose in a downward direction.
8. To fire, point revolver in safe direction, pull hammer back to full cock position and pull the trigger.



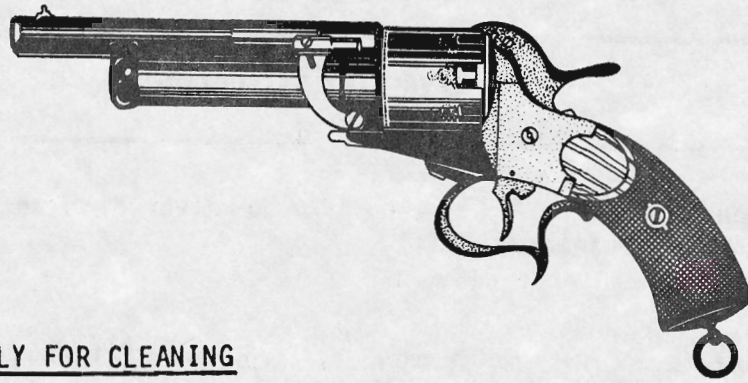

DISASSEMBLY FOR CLEANING

CAVALRY MODEL - Lower the lever latch located at bottom front of frame. The barrel will then fully unscrew in a counter - clockwise direction.

ARMY & NAVY MODELS - It is suggested that the tension be removed from the barrel pin retaining spring by carefully loosening the retaining spring screw in a counter clockwise direction. This will allow the barrel retaining pin located at front lower portion of frame to be pulled out towards the muzzle of the revolver thus allowing the barrel assembly to be removed in a counter-clockwise direction.

After removing barrel assembly, cylinder can be removed by sliding forward from the cylinder pin. Cleaning procedures are as described in the booklet.

Reverse procedure for re-assembly.



Le Mat Cavalry

Le Mat Cavalry Model

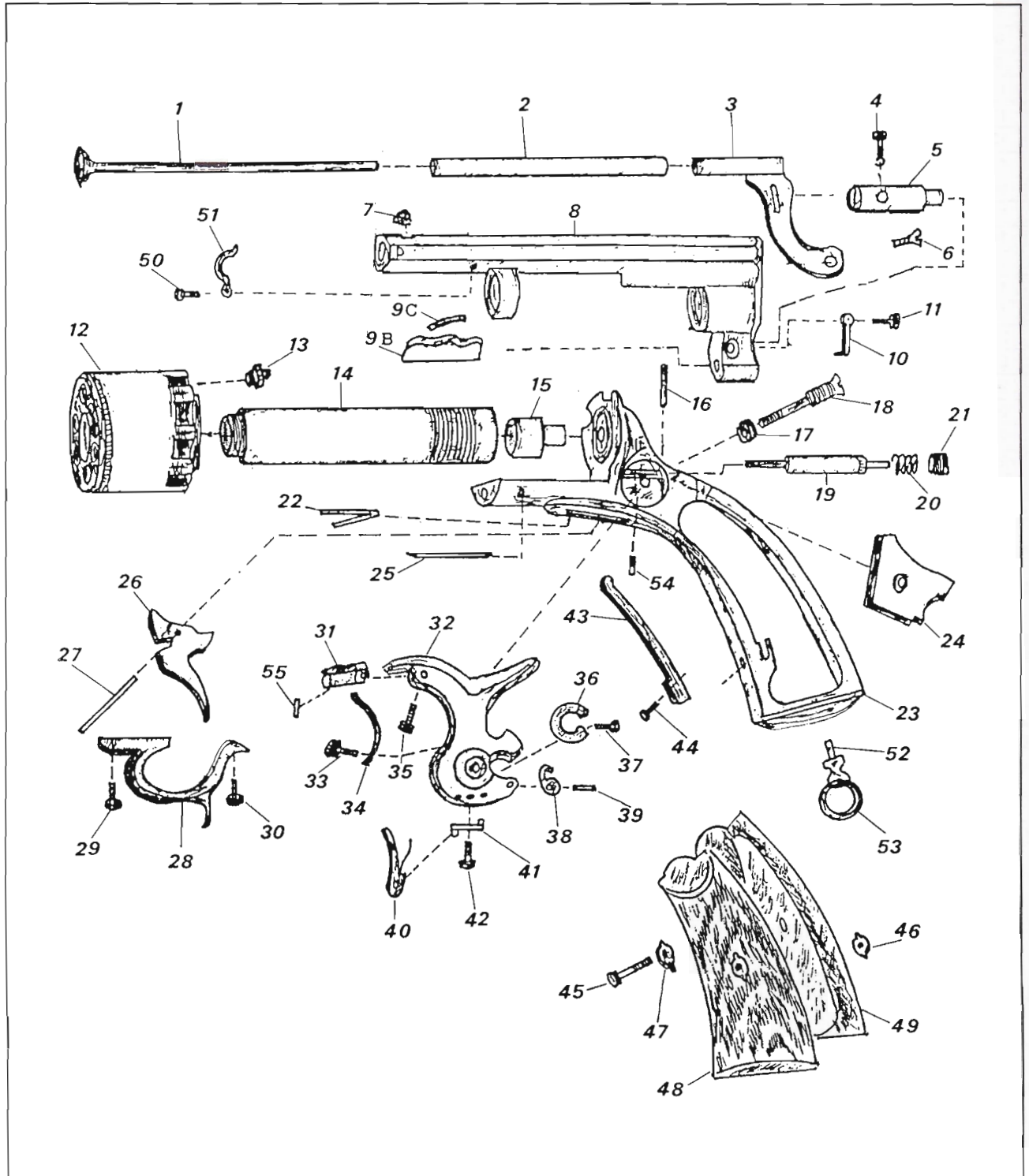

Nomenclatura / List			Rif. Fabbrica/Factory Ref.
No.	Italiano	English	F. A. P.
1	Perno prolunga leva caricamento	Loading lever extention stud	3015
2	Tubetto leva caricamento	Loading lever tube	3014
3	Leva caricamento	Loading lever	3013
4	Vite calcatio	Plunger screw	3017
5	Calcatio	Plunger	3016
6	Vite leva caricamento	Loading lever screw	3061
7	Mirino	Front sight	3007
8	Canna	Barrel	3006
9B	Piastrina guida canna	Barrel bracket	4131
9C	Molla piastrina guida canna	Barrel bracket spring	4130
10	Molla fermo perno guida canna	Barrel bracket locking stud spring	3009
11	Vite molla fermo perno guida canna	Barrel bracket locking stud spring screw	3010
12	Cilindro	Cylinder	3004
13	Luminello	Nipple	3005
14	Canotto castello	Frame smooth bore tube	3003
15	Tappo castello	Breech plug	3002
16	Vite regolaione molla scatto pistoncino	Sear adjustment screw	3050
17	Rondella vite cane	Hammer screw washer	3022
18	Vite cane	Hammer screw	3021
19	Pistoncino fermo cilincro	Cylinder stop stud	3030
20	Molla pistoncino fermo cilincro	Cylinder stop stud spring	3031
21	Rondella pistoncino fermo cilincro	Cylinder stop stud washer	3032
22	Molla grilletto	Trigger spring	3040
23	Castello	Frame	3000
24	Piastra castello	Frame plate	3001
25	Spina fermo piastra guida	Barrel bracket locking pin	3038
26	Grilletto	Trigger	3039
27	Spina grilletto	Trigger pin	3041
28	Guardamano	Trigger guard	3042
29	Vite anteriore guardamano	Front trigger guard screw	3044
30	Vite posteriore guardamano	Rear trigger guard screw	3043
31	Nottolino di sparo	Firing pin	3019
32	Cane	Hammer	3020
33	Vite molla nottolino di sparo	Firing pin spring screw	3024
34	Molla dente nottolino di sparo	Firing pin latch spring	3025
35	Vite nottolino di sparo	Firing pin screw	3023
36	Molla pistoncino scatto	Sear stud spring	3027
37	Vite molla pistoncino scatto	Sear stud spring screw	3037
38	Tirantino molla cane	Main spring rod	3028
39	Spina tirantino	Main spring rod pin	3029
40	Leva avanzamento cilindro + molla	Hand + spring	3033
41	Supporto leva avanzamento cilindro	Hand bracket	3034
42	Vite supporto leva avanzamento cilindro	Hand bracket screw	3036
43	Molla cane	Main spring	3026
44	Vite molla cane	Main spring screw	3035
45	Vite guancina	Grip screw	3048
46	Ghiera guancina destra	Right escutcheon plate	3046
47	Ghiera guancina sinistra	Left escutcheon plate	3047
48	Guancina sinistra	Left grip	3049 - S
49	Guancina destra	Right grip	3049 - D
50	Vite molla leva caricamento	Loading lever spring screw	3012
51	Molla leva caricamento	Loading lever spring	3011
52	Piolo maglietta	Swivel pin	3045
53	Anello maglietta	Swivel ring	3058
54	Vite pistoncino fermo cilindro	Cylinder stop stud screw	450
55	Spina nottolino di sparo	Firing pin, pin	3062
56			
57			
58			