

MOSSBERG

MODEL 353

SYMBOL NO. 353-170

22 CALIBER AUTO-LOADING RIFLE
WITH 7 SHOT CLIP

FEATURES

1. Genuine American Walnut checkered stock with Monte-Carlo and molded but plate and trigger guard. Hinged stock extension will pull down and form forearm grip.
2. 18" tapered, blued steel barrel with crowned muzzle and AC-KRO-GRUV rifling. Handles all .22 caliber long rifle regular or high speed ammunition.
3. Convenient thumb operated safety.
4. Receiver milled with dovetail slots for telescope mounting.
5. Self loading and ejecting - shoots 7 shots as fast as you can pull the trigger.
6. 1" sling swivels fitted with $\frac{1}{8}$ " web strap.
7. Beaded ramp front sight.
8. Sporting Rear Sight with adjustment for windage and elevation.
9. Weight about 5 lbs.

Do not "dry fire" since this has a tendency to crystallize the firing pin causing breakage.

A clean gun works better. Some types of ammunition foul the action quicker than others. Clean an automatic action after 500 rounds with gasoline if heavily coated with burnt powder-oil mixture. Lubricate action with light oil. DO NOT USE GREASE.

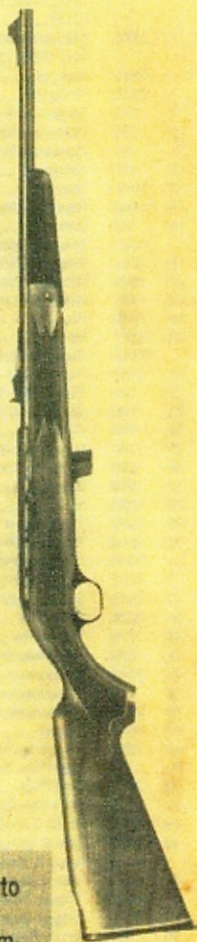

MODEL 353 PARTS LIST

Part Number	Name
1	1065 Breech Plug
2	1091 Retracting Spring Plunger
3	473 Retracting Spring Bushing
4	1089 Retracting Spring
5	1092 Mainspring
6	2377 Hammer
7	2649 Bolt Complete (includes 473, 2378, 2192, 1089, 1091, 1092, 1402, 2377)
1402	Bolt with extractor (includes 471, 481, 1093, 1313)
1313	Bolt only
8	2378 Firing Pin
9	2192 Retaining Pin
10	1093 Extractor Pin
11	481 Extractor Spring
12	471 Extractor
13	1087 Ejector
14	*1448 Receiver (See also #20)
15	763 Deflector
4505	Sporting Rear Sight
16	2343 Elevation Slide
17	1440 Windage Plate
18	1441 Windage Plate Screw
19	1439 Base
20	*3793 Barrel
*4543	Barrel & Receiver
21	3761 Ramp Front Sight Complete
22	301 Take Down Stud
23	1120 Cocking Knob
24	494 Angle Bar
25	1150 Magazine Latch
26	495 Angle Bar Screw
27	1353 Sear Pin
28	1300 Sear
29	1444 Safety Lever
30	1210 Retaining Ring
31	1446 Disconnecter Pin
32	1317 Retaining Ring
33	1443 Disconnecter Bracket
34	2204 Safety Pin
35	1315 Trigger Pin
36	1320 Disconnecter
37	1454 Disconnecter Bracket Screw
38	479 Disconnecter Spring
39	2348 Disconnecter Bracket Screw, Rear
40	1312 Trigger
41	1069 Trigger Spring
42	171 Butt Plate Screw
43	1425 Butt Plate
44	1174 Butt Plate Spacer
45	3825 Stock Complete
46	2093 Swivel Complete
47	171 Swivel Screw
48	147 Trigger Guard Screw
49	1306 Trigger Guard
50	147 Stock Plate Screw
51	508 Magazine Stock Plate
52	503 Take Down Screw
3235	Magazine Assembly
53	2916 Magazine Shell & Channel
54	502 Magazine Follower

Part Number	Name
57	132 Extension Grip Spring
58	606 Extension Grip Bushing
59	605 Extension Grip Plunger
60	604 Extension Grip
61	2333 Swivel Assembly
62	2073 Loop & Nut Assembly
63	2334 Strap
64	1453 Washer

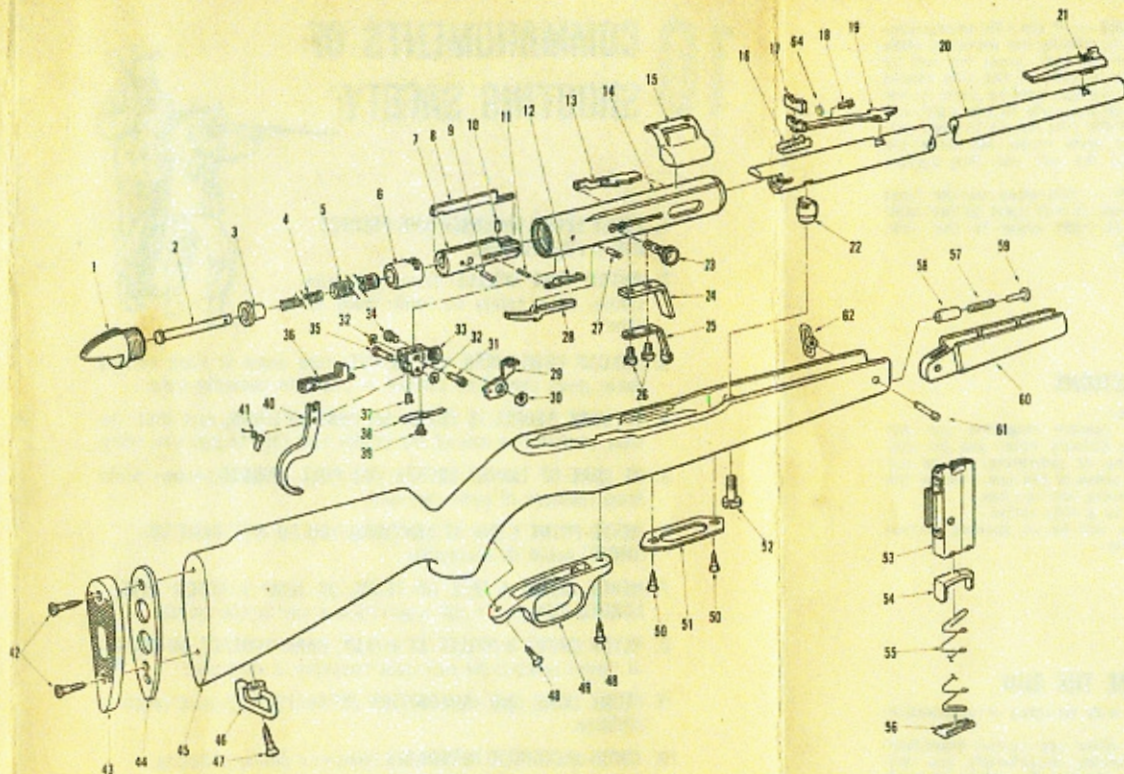

*Gun must be sent to a competent gunsmith or to the factory to have part fitted.
Prices subject to change without notice.
No orders accepted under \$1.00.
When ordering parts give the Part Number and the Model Number (as marked on the barrel).

1. **TO LOAD** — Remove the Magazine by pressing back on the Magazine Latch and sliding the Magazine out. This rifle is equipped with a Magazine that will handle long, and long rifle cartridges. Do not mix cartridges in the same load. Insert 7 cartridges in the Magazine and replace Magazine in the rifle.

2. **TO FIRE THE RIFLE** — Replace the loaded Magazine in the rifle. Pull the Cocking Knob all the way back and allow it to SNAP forward. This will place a cartridge in the chamber and the rifle is ready to fire.

3. **SAFETY** — The Safety is located on the right side of the Receiver. To put on safe, pull back on the Safety Lever. To take off safe, push the Safety Lever forward.

4. **TO TAKE DOWN** — Remove the Magazine #2384 by pressing back the Magazine Latch #1150 and sliding the Magazine out of the Stock. Loosen the Take Down Screw and lift up on the Barrel.

5. **TO REMOVE THE BOLT** — Remove Stock. Unscrew and remove Breech Plug #1065. Slide Bolt back until the Cocking Knob lines up with the hole furthest back in the Receiver. Remove the Cocking Knob by lifting straight out. Grab the Retracting Spring Bushing 473 which now projects from the rear end of the receiver and slide the Bolt out.

6. **TO DISASSEMBLE THE BOLT** — Drive out the Retaining Pin 267 after which all Bolt parts can be taken apart.

7. **TO REASSEMBLE THE BOLT** — Place the Retracting Spring Plunger in the Retracting

Spring Bushing so that the head of the Plunger goes into the cup of Bushing. Slide the Retracting Spring and Mainspring over the Plunger. Slide the Hammer over the Retracting Spring with the large hole of the Hammer toward the rear so that it goes over the front section of the Mainspring. Now push the Retracting Spring and Plunger into the Bolt until hole in the Plunger lines up with hole in the Bolt. Keep the two holes lined up and push Pin into the hole. Then insert the Firing Pin in the slot with the square end to the rear and hooked into the Hammer.

8. **TO REPLACE BOLT IN RECEIVER** — Hold the Bolt with Firing Pin on top and slide into Receiver until the large hole in Bolt lines up with hole in the receiver. Place the Cocking Knob in the hole and line up slots in Cocking Knob with the slots in the Receiver. Pull the Trigger and slide the Bolt forward. Replace the Breech Plug and tighten in place. Then unscrew it until the flat side of the Plug is on the bottom.

9. **TO ADJUST THE REAR SIGHT** — If the rifle shoots low, raise the rear sight leaf by sliding the elevation slide to the rear. If the rifle shoots high, lower the leaf by sliding the elevation slide forward. If the rifle shoots to the left, loosen the windage sighting plate screw and move the windage sighting plate to the right and then tighten the screw. If the rifle shoots to the right, loosen the windage sight plate screw and slide the windage sighting plate to the left and then tighten the screw.
10. **TO USE EXTENSION GRIP** — Pull down on the front end of the Stock extension, it will pivot at the front swivel and turn down at right angle to the rifle, forming a convenient grip.

SUGGESTIONS

Keep Take Down Screw tight.

If your rifle should jam, remove magazine and any live cartridges. Pull back on Cocking Knob and be sure that the barrel is not pointing at something you do not want to hit. After finding the cause of the jam, remove the offending cartridge before allowing bolt to close.

Misfires are usually caused by a dirty action.

If hammer is cocked, there will be an opening in rear of cocking knob slot on receiver.

DON'T BLAME THE GUN

This rifle was triple tested with all types of ammunition before leaving the factory.

All automatic .22 caliber rifles are solely dependent on pressures to operate the action. Occasionally, you may find a cartridge too weak to operate the action because the pressures are not up to standard. If you should fire a cartridge that gives a faint report or a report that sounds weak, be sure to check the barrel before firing another shot, as the bullet from the weak sounding cartridge may still be in the barrel. Should a bullet become lodged in the barrel from this or from a so-called "squib" load (one that does not ignite all the powder), force it out with a ramrod. **DO NOT ATTEMPT TO SHOOT IT OUT AS THIS IS DANGEROUS** and may result in the barrel forming a pressure bulge, crack, or break. If you have trouble of this nature, try ammunition of another lot.

10 COMMANDMENTS OF SHOOTING SAFETY



1. **TREAT EVERY GUN WITH THE RESPECT DUE A LOADED GUN.**
2. **WATCH THAT MUZZLE!** Carry your gun safely; keep safety on until ready to shoot.
3. **UNLOAD GUNS WHEN NOT IN USE,** take down or have actions open; guns should be carried in cases to shooting area.
4. **BE SURE BARREL IS CLEAR OF OBSTRUCTIONS,** and that you have ammunition only of the proper size for the gun you carry.
5. **BE SURE OF TARGET BEFORE YOU PULL TRIGGER;** know identifying features of game you hunt.
6. **NEVER POINT A GUN AT ANYTHING YOU DO NOT WANT TO SHOOT;** avoid all horseplay.
7. **NEVER CLIMB A TREE OR FENCE OR JUMP A DITCH WITH A LOADED GUN;** never pull a gun toward you by the muzzle.
8. **NEVER SHOOT A BULLET AT A FLAT, HARD SURFACE OR WATER;** at target practice be sure your backstop is adequate.
9. **STORE GUNS AND AMMUNITION SEPARATELY,** beyond reach of children.
10. **AVOID ALCOHOLIC BEVERAGES** before or during shooting.

**DO YOUR PART:
KEEP SHOOTING
A SAFE SPORT**



JOIN
THE NATIONAL RIFLE ASSOCIATION
1600 RHODE ISLAND AVE., N.W.
WASHINGTON, D.C. 20036

O. F. MOSSBERG & SONS, INC.
NORTH HAVEN, CONNECTICUT, U.S.A.