

MODEL
31

J. Higgins

MODEL 31

.22 CAL. SEMI-AUTOMATIC RIFLE



Shoots short, long, or long rifle cartridges,
either regular or high speed, interchangeably
and automatically without adjustment!

MODEL 31...

Here is America's newest rifle! The versatile Model 31 is tops for field shooting and target practice. It operates with regular or high speed ammunition in .22 cal. rimfire Short, Long, or Long Rifle. These cartridges can be used interchangeably, without adjustment, in the magazine which holds 17 Long Rifle, 19 Long, or 25 Short shells. Outstanding with this rifle are a built-in mount base, a roll-away Nylon carrying sling, and a ramp-style front sight. A 4 power telescopic sight is available which is specifically adaptable to the Model 31. The many custom features of this autoloading rifle have made it America's favorite among all .22 cal. rifles!

IMPORTANT:

Before firing this rifle, be sure to clean barrel thoroughly of grease, or any obstruction.

CLEANING & LUBRICATING

Your Model 31 is treated with new siliconized and polarized oil. This exclusive patented process gets down into the pores of the steel and protects against perspiration and other corrosive elements which cause rust. This oil makes J. C. Higgins guns the most rust resistant of any guns you can buy. It gives the best lubrication of any oil tested. And it protects and beautifies stock and forearm.

The performance of any semi-automatic rifle depends on how clean it is kept. Exclusive use of J. C. Higgins' ammunition will keep fouling to a minimum, but, because a semi-automatic rifle depends on the powder gases for the repeating action, it must be kept clean to function efficiently. We recommend that your gun be thoroughly cleaned after firing 200 to 250 rounds for continued top performance.

Disassemble the gun, following complete instructions contained in this instruction sheet, into the three basic parts. (a) stock, receiver and barrel group, (b) trigger assembly, and (c) breech bolt assembly.

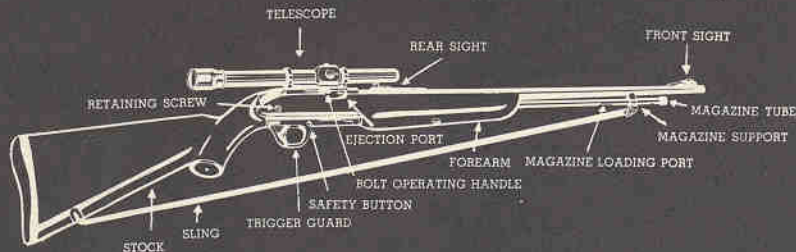

FIG. 1

Using a tooth brush soaked in solvent, clean trigger assembly, getting powder fouling out of springs, magazine throat, etc. In same manner clean bolt, getting fouling out of extractor, off of bolt face and firing pin, and out of machined cuts in bolt. Push a patch, moistened with a good solvent through the barrel from the muzzle end. Push a brass brush, soaked in solvent through the entire length of the bore several times, using long even strokes. Push clean patches through the bore in the same manner until the last patch comes out unsoiled. Push lightly oiled patch through the entire length of the bore. Wipe both trigger assembly and bolt dry, oil lightly, and replace, following instructions for assembly, which follow.

A J. C. Higgins Rifle Cleaning Kit is available especially for .22 caliber rifles (at any Sears Store or from the catalogue), which includes all the necessary materials to carry out the above operations. Another valuable piece of equipment is a J. C. Higgins Silicone Cloth which will help by protecting the outside surfaces of the rifle from rust and moisture.

OPERATING INSTRUCTIONS

TO MAKE GUN SAFE: Safety is located in trigger guard bow forward of trigger. With hammer cocked, push safety from left to right until red band is covered. This movement locks trigger, and gun cannot be fired. Always lock the trigger when carrying a loaded gun.

TO RELEASE SAFETY: Push safety from right to left, exposing red band, and gun is ready to fire.

TO LOAD MAGAZINE: With safety on, turn knurled knob on inner magazine tube, pull tube out and insert cartridges into cartridge opening, continuing the operation until last cartridge is visible (See figure 2). Grasping knurled portion of inside magazine tube, press down with rotating action until magazine tube is fully down and located in supporting notch.

TO LOAD CHAMBER: Retract action fully to the rear and allow to close. Push safety so that the red band appears. Gun is now ready to fire.

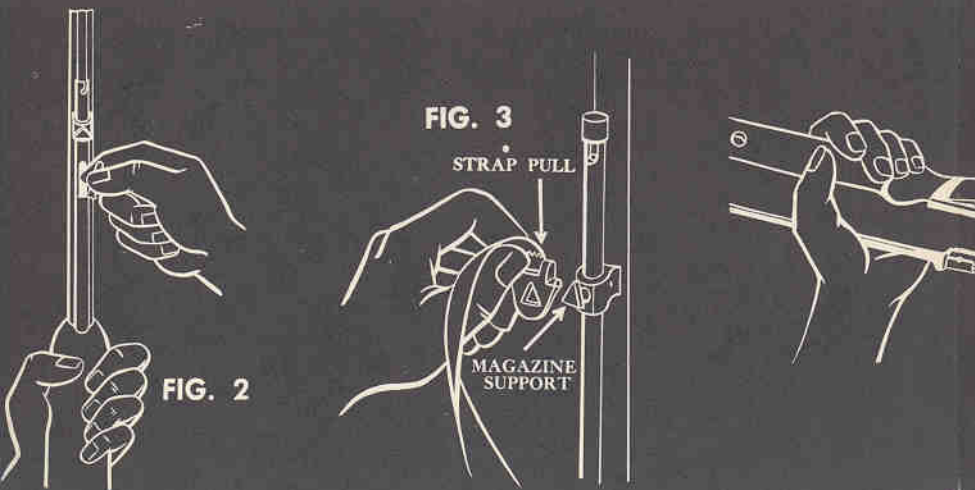

TO REMOVE CARTRIDGES WITHOUT FIRING: Remove inside magazine tube, and by pointing gun muzzle downward, all cartridges in the magazine tube will drop into the hand. With safety on, work action twice to remove cartridges from barrel chamber and from trigger guard assembly through the ejection port. Pull bolt operating handle back and examine barrel chamber to make sure gun is now empty of cartridges. Inside magazine tube may now be replaced.

TO ENGAGE CARRYING SLING: Pull sling forward from butt stock, invert strap pull and slip over magazine support (See figure 3). Sling will snap into position. Sling may be disengaged by reversing this process.

TO ASSEMBLE J. C. HIGGINS 4-X TELESCOPE SIGHT TO RIFLE: Engage mating slot on telescope mount with mating slot on receiver top. The eye piece of the scope should be to the rear and slide forward against the stop. Tighten scope mounting screw and the assembly is complete. (See figure 1).

DISASSEMBLY

TO REMOVE TRIGGER ASSEMBLY: Turn the gun upside down, remove trigger guard retaining screw. Grasp trigger guard and pull up and toward the butt stock. Trigger guard assembly will come free of the receiver as a unit (See figure 4). It is advisable to remove this assembly only when necessary.

BOLT: With gun still upside down, pull bolt operating handle completely to rear. While holding in this position, lift up front of bolt and ease bolt out of receiver releasing pressure on driving spring slowly. Bolt operating handle may then be pulled forward to the ejection port and removed from the gun. (See figure 5).

FORE-ARM: May be disassembled by removing fore-arm retaining screw and sliding fore-arm from receiver.



FIG. 4

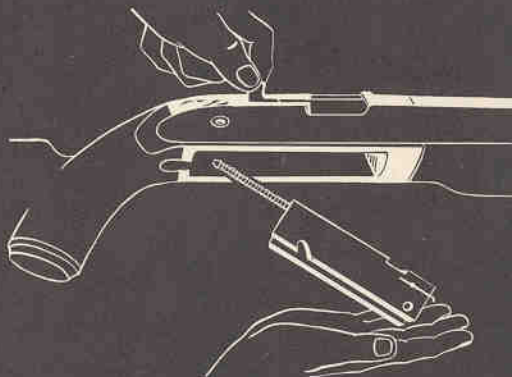

FIG. 5

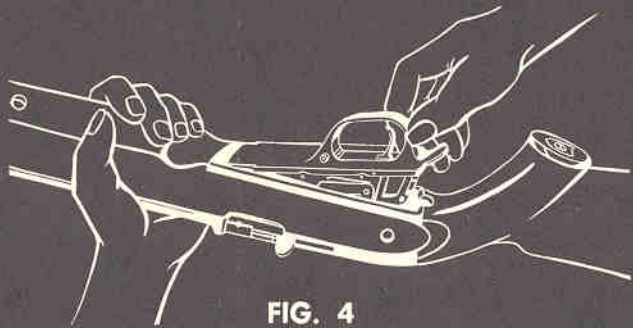

FIG. 4

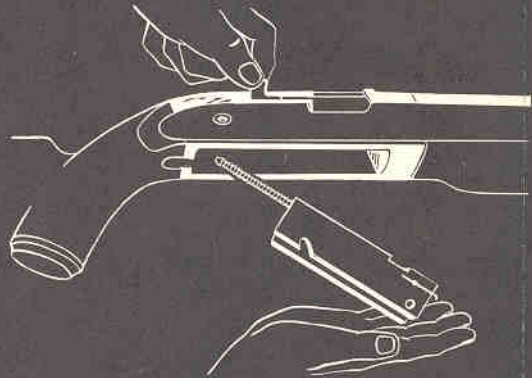

FIG. 5

ASSEMBLY

BOLT ASSEMBLY: With gun upside down, replace bolt operating handle back in position so that the notch in the handle faces the opening for the trigger guard assembly. Slide bolt operating handle fully to rear. Insert the driving spring guide into spring and insert spring into hole in bolt. Then fit driving spring guide into the hole at rear of receiver. Push block to rear of receiver against the pressure of the driving spring. (See Fig. 6). Hold the bolt with it inclined slightly and set down over the bolt operating handle and allow the bolt to move forward.

TRIGGER ASSEMBLY: Make sure that hammer is in cocked position. (See Figure 7). With the gun in upside down position, replace trigger assembly by inserting lug on front end of trigger assembly mating slot inside forward end of receiver. Press down and forward against rear portion of trigger guard until fully seated. Insert and tighten trigger guard retaining screw. The gun is now completely re-assembled.

SPECIFICATIONS

Length of Pull	13 $\frac{3}{4}$ inches
Drop at Heel	2 $\frac{1}{4}$ inches
Drop at Comb	1 $\frac{1}{2}$ inches
Barrel Length	23 $\frac{1}{4}$ inches
Over-All Length	41 $\frac{3}{4}$ inches
Weight of Gun	5 lbs. 7 oz.
Weight of Scope and Mount	8 oz.
Magazine Capacity	17 L.R., 19 Long, or 24 Short
Front Sight	Ramp type
Rear Sight	head Rocky Mountain patridge type with serrated blade for elevation at 25 yard intervals.
Butt Stock & fore-end	American black walnut

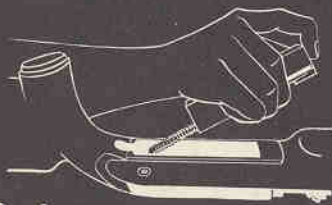
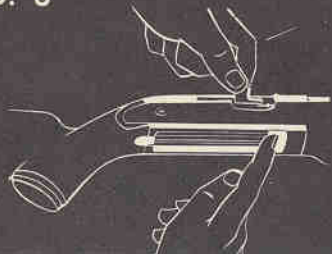

FIG. 6



HAMMER IN COCKED POSITION
(TO REASSEMBLE)

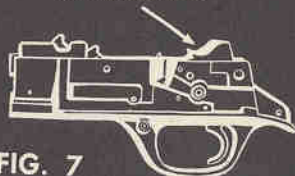
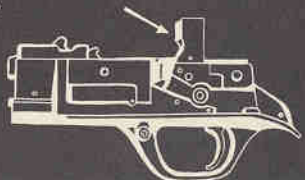

FIG. 7

HAMMER UNCOCKED



List of Parts and Assemblies

J. C. HIGGINS MODEL 31 .22 CAL. Model Number 583.75 (this number is marked on the barrel. Be sure to mention it when ordering).

WHERE TO ORDER REPAIR PARTS — Any Sears retail or mail order store will handle your order.

HOW TO ORDER — Specify Model No., Reference No., Part No. and Part Name. Parts marked with an asterisk (*) must be fitted by gunsmiths in Sears mail order houses, or by outside gunsmiths.

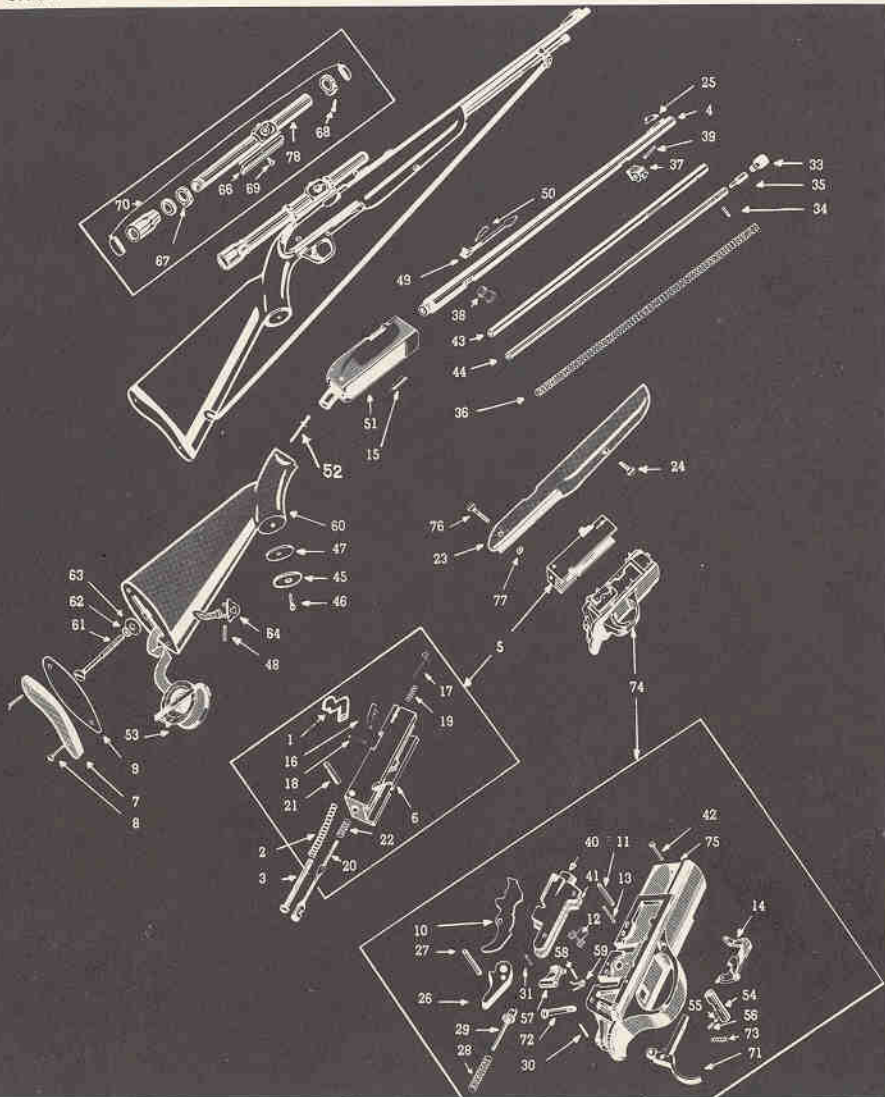

REF. NO.	PART NO.	PART NAME	REF. NO.	PART NO.	PART NAME
4	456	Barrel	53	412M	Reel Assembly
5	457M	Bolt Assembly (Composed of: 457 Bolt 468 Firing Pin 320 Firing Pin Spring 469 Firing Pin Retaining Pin 465 Extractor 466 Extractor Retaining Pin 467 Extractor Spring)			(Composed of: 412 Reel 414 Reel Frame 416 Reel Frame Spacer 415M Reel Frame Stud Assembly 411 Reel Gripper Pin 413 Reel Spring 407M Strap Assembly)
6	457	Bolt	54	346	Safety Button
1	483	Bolt Operating Handle.	55	347	Safety Button Plunger
7	344	Butt Plate	56	348	Safety Button Plunger Spring
8	345	Butt Plate Screw	57	428	*Sear
9	404	Butt Plate Trim	58	350	Sear Pin
10	459	Cartridge Lifter	59	351	Sear Spring
11	308	Cartridge Lifter Pin	60	485	Stock
12	460	Cartridge Lifter Spring	61	353	Stock Bolt
13	310	Cartridge Lifter Spring Retaining Pin	62	354	Stock Bolt Lock Washer
			63	182	Stock Bolt Washer
11	492	Cartridge Lifter Stop Pin	64	405	Strap Pull
14	462M	*Disconnecter Assembly (Composed of: 462 Disconnecter 312 Disconnecter Hinge Pin)	78	436	Telescope 4X
			66	490	Telescope Base
			67	386	Telescope Base Clamp Ring
			68	387	Telescope Base Clamp Ring Screw
			69	385	Telescope Base Lock Screw
17	463	Disconnecter Spring	70	434M	Telescope Eye Piece Cap
18	461	Disconnecter Spring Retaining Pin			Assembly
2	495	Driving Spring			(Composed of: 420 Telescope Eye Piece Cap 419 Telescope Front Dust Cap 434 Telescope Dust Cover Cord)
3	489	Driving Spring Guide			
15	464	*Ejector			
16	465	*Extractor			
31	466	Extractor Retaining Pin			
19	467	Extractor Spring	71	427M	Trigger & Trigger Extension Assembly
20	468	Firing Pin			Trigger Pin
21	469	Firing Pin Retaining Pin	72	359	Trigger Spring
22	320	Firing Pin Spring	73	360	Trigger Guard Assembly
23	470M	Forearm Assembly (Composed of: 470 Forearm 399 Trigger Guard Retaining Screw Nut)	74	491M	(Composed of: 459 Cartridge Lifter 308 Cartridge Lifter Pin 492 Cartridge Lifter Stop Pin 460 Cartridge Lifter Spring 310 Cartridge Lifter Spring Retaining Pin 462M Disconnecter Assembly 463 Disconnecter Spring 461 Disconnecter Spring Retaining Pin 472M Hammer Assembly 325 Hammer Pin 326 Hammer Spring 327 Hammer Spring Guide 328 Hammer Spring Pin 474 Magazine Throat, R.H. 475 Magazine-Throat, L.H. 381 Magazine Throat Retain- ing Pin 346 Safety Button 347 Safety Button Plunger 348 Safety Button Plunger Spring 428 Sear 350 Sear Pin 351 Sear Spring 427M Trigger & Trigger Extension Assembly 491 Trigger Guard 359 Trigger Pin 360 Trigger Spring)
24	323	Forearm Retaining Screw			
25	356	Front Sight, Low, or			
	392	Front Sight, Medium, or			
	378	Front Sight, High			
26	472M	Hammer Assembly (Composed of: 472 Hammer 330 Hammer Strut Pin)			
27	325	Hammer Pin			
28	326	Hammer Spring			
29	327	Hammer Spring Guide			
30	328	Hammer Spring Pin			
33	331	Magazine Cap			
34	332	Magazine Cap Pin			
35	473	Magazine Follower			
36	336	Magazine Spring			
37	337	*Magazine Support			
38	335	*Magazine Support, Rear			
39	338	Magazine Support Pin			
40	474	Magazine Throat, Right Hand			
41	475	Magazine Throat, Left Hand			
42	381	Magazine Throat Retaining Pin			
43	476	Magazine Tube			
44	334	Magazine Tube, Inside			
45	401	Pistol Grip Cap			
46	403	Pistol Grip Cap Screw			
47	402	Pistol Grip Cap Trim			
48	409	Pull Gripper Pin	75	491	Trigger Guard
49	478	Rear Sight	76	398	Trigger Guard Retaining Screw
50	479	Rear Sight Elevator	77	399	Trigger Guard Retaining Screw Nut
51	497	*Receiver			
52	150	Receiver Tang			Parts List

OTHER FAMOUS *J. C. Higgins* GUNS

See these other J. C. Higgins models at your nearest Sears Store, or send a postcard for descriptive literature on all J. C. Higgins Guns to: Sears Roebuck and Company, Dept. T39, Chicago, Illinois. Ask for J. C. Higgins Circular No. 6495. Remember, these guns give you more quality and shooting pleasure for every dollar you invest!

Model 20 PUMP ACTION SHOTGUN



Here is the fastest selling 12 gauge pump shotgun on the market . . . because this one gun is ideal for *all* kinds of shooting at *all* hunting ranges! It is furnished with a choke compensator and 3 interchangeable tubes, which will reduce barrel whip, muzzle blast, and recoil up to 60%.

A sleek ventilated rib helps you to aim faster with the Model 20. It also features an exclusive free-falling action, sturdy recoil pad, choice-grained walnut stock, and a silver nameplate.

Model 50 HIGH-POWERED RIFLE



The Model 50 is available in either the .30-06 or .270 caliber . . . America's most popular big game cartridges. This rifle features a genuine Mauser action made in Belgium by Fabrique Nationale, and a chrome molybdenum steel barrel with chromed bore. The stock is of genuine walnut fitted with a pistol grip cap and hard rubber butt plate. This super-accurate hunting rifle is available with either a 2½ or 4 power telescopic sight.

Model 10 BOLT-ACTION SHOTGUN



Parts List 995-14

Printed in U.S.A.

The lowest priced 6-shot repeater available! Your choice of 12, 16 or 20 gauge, with full or modified choke. This is a safe and accurate gun with a fast action bolt. It loads from beneath into a smooth tubular magazine. There's *no* clip to lose with this gun! Genuine walnut stock, and rubber recoil pad are furnished as standard equipment.

J. C. Higgins Guns are sold **ONLY** by Sears, Roebuck and Co. and Simpsons-Sears Limited