

*J. C. Higgins*  
OUR OWN TRADE MARK



**MODEL 28**

**AUTO - LOADING**

**.22 CAL. RIFLE**

**WITH OR WITHOUT**

**4 POWER TELESCOPE**

**J. C. Higgins Products are Sold  
Only by Sears, Roebuck and Company**

September, 1951

# INSTRUCTIONS FOR OPERATION AND CARE

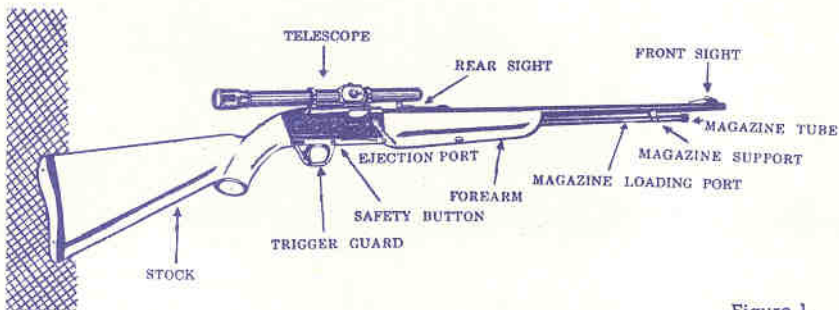

Figure 1

**IMPORTANT:** Before firing this gun, be sure to clean barrel thoroughly of all grease or of any obstruction.

**CLEANING AND LUBRICATING:** The performance of any automatic rifle depends upon how clean it is kept. Exclusive use of Sears' ammunition will keep powder fouling to a minimum but, because an automatic rifle depends on the powder gases for the repeating action, it must be kept clean to function efficiently. We recommend that your gun be thoroughly cleaned after firing 200 to 250 rounds for continued top performance.

In cleaning, be sure to use the proper size rod, brushes and patches, those especially dimensioned for .22 caliber rifles.

Disassemble the gun, following complete instructions contained in this instruction sheet, into the three basic parts. (a) stock, receiver and barrel group, (b) trigger assembly, and (c) breech bolt assembly.

Using a toothbrush soaked in solvent, clean trigger assembly, getting powder fouling out of springs, magazine throat, etc. In same manner clean bolt, getting fouling out of extractor, off of bolt face and firing pin, and out of machined cuts in bolt. Push a patch, moistened with a good solvent through the barrel from the muzzle end. Push a brass brush, soaked in solvent through this entire length of the bore several times, using long even strokes. Push clean patches through the entire length of the bore in the same manner until the last patch comes out unsoiled. Push lightly oiled patch through the entire length of the bore. Wipe both trigger assembly and bolt dry, oil lightly and replace, following instructions on this sheet for assembly.

Using a lightly oiled rag, rub the entire outside of the rifle. Be careful to rub off any fingerprints. Acid from perspiration of the hands will quickly rust a gun unless neutralized by oil.

Sears, Roebuck and Company carries a complete line of J. C. Higgins cleaning equipment, all at popular money-saving prices.

**TO MAKE GUN SAFE:** Safety is located in trigger guard bow forward of trigger. With hammer cocked, push safety from left to right until red band is covered. This movement locks trigger, and gun cannot be fired. Always lock the trigger when carrying a loaded gun.

**TO RELEASE SAFETY:** Push safety from right to left, exposing red band, and gun is ready to fire.

**TO LOAD MAGAZINE:** With safety on, turn knurled knob on inner magazine tube, pull tube out and insert cartridges into cartridge opening, (See figure 2.) continuing the operation until last cartridge is visible. Grasping knurled portion of inside magazine tube, press down with rotating action until inside magazine tube is fully home and located in supporting notch.

**TO LOAD BARREL:** Retract action fully to the rear and allow to close. Push safety so that the red band appears, and gun is now ready to fire.

**TO REMOVE CARTRIDGES; WITHOUT FIRING:** Remove inside magazine tube, and by pointing gun muzzle downward, all cartridges in the magazine tube will drop into the hand. With safety on, work action TWICE to remove cartridges from barrel chamber and from trigger guard assembly through the ejection port. Pull action bar handle back and examine barrel chamber to make sure gun is now empty of cartridges. Inside magazine tube may now be replaced.

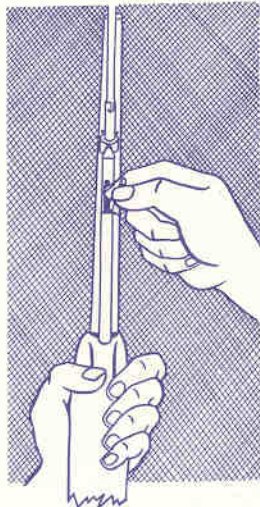

Figure 2

**TO ASSEMBLE J. C. HIGGINS 4-X TELESCOPE SIGHT TO RIFLE:** Engage mating slot on telescope mount with mating slot on receiver top with eye piece to the rear, slide forward against stop. Tighten scope mounting screw and gun is ready to fire. (See figure 1.)

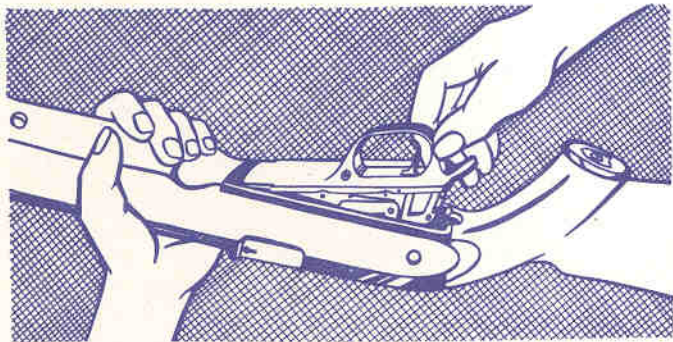

Figure 3

## DISASSEMBLY

**TO REMOVE TRIGGER ASSEMBLY:** (Do only when necessary). Turn the gun upside down, remove trigger guard retaining screw. Grasp trigger guard and pull up and toward the butt stock. Trigger guard assembly will come free of the receiver as a unit. See figure 3.

**BOLT:** May be disassembled (see figure 4) by grasping retracting handle and pulling toward the rear, permitting the bolt assembly to drop into the hand. The gun is now completely disassembled for cleaning purposes.

**FORE-ARM:** May be disassembled by removing fore-arm retaining screw and sliding fore-arm from receiver.

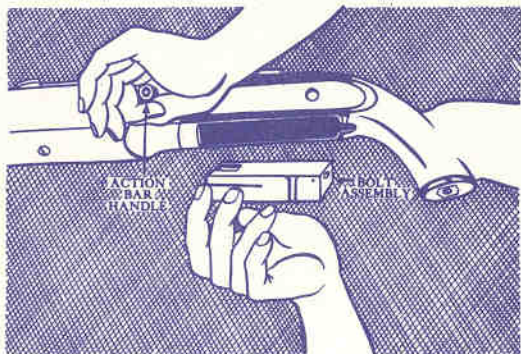

Figure 4

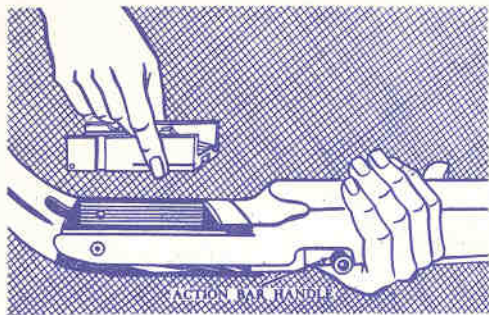

Figure 5

## ASSEMBLY

**BOLT ASSEMBLY:** With gun upside down, drop bolt (as shown in figure 5) into receiver, work retracting handle back and forth, breech bolt will drop into place, at top of receiver. Bolt is now assembled in receiver.

**TRIGGER ASSEMBLY:** Remove inside magazine tube. Pull retracting handle back half way, and making sure that hammer is in cocked position (see figure 6.) replace trigger assembly by inserting lug on front end of trigger assembly to mating slot inside forward end of receiver. Holding gun in upside down position (see figure 3.) press down and forward against rear portion of trigger guard until it is fully home and seated. If it does not immediately drop into position, work retracting handle short distance back and forward. Insert and tighten trigger insert retaining screw, work the action by pulling back on the action bar handle to make sure that bolt functions. The gun is now completely re-assembled.

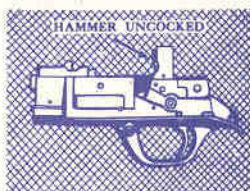
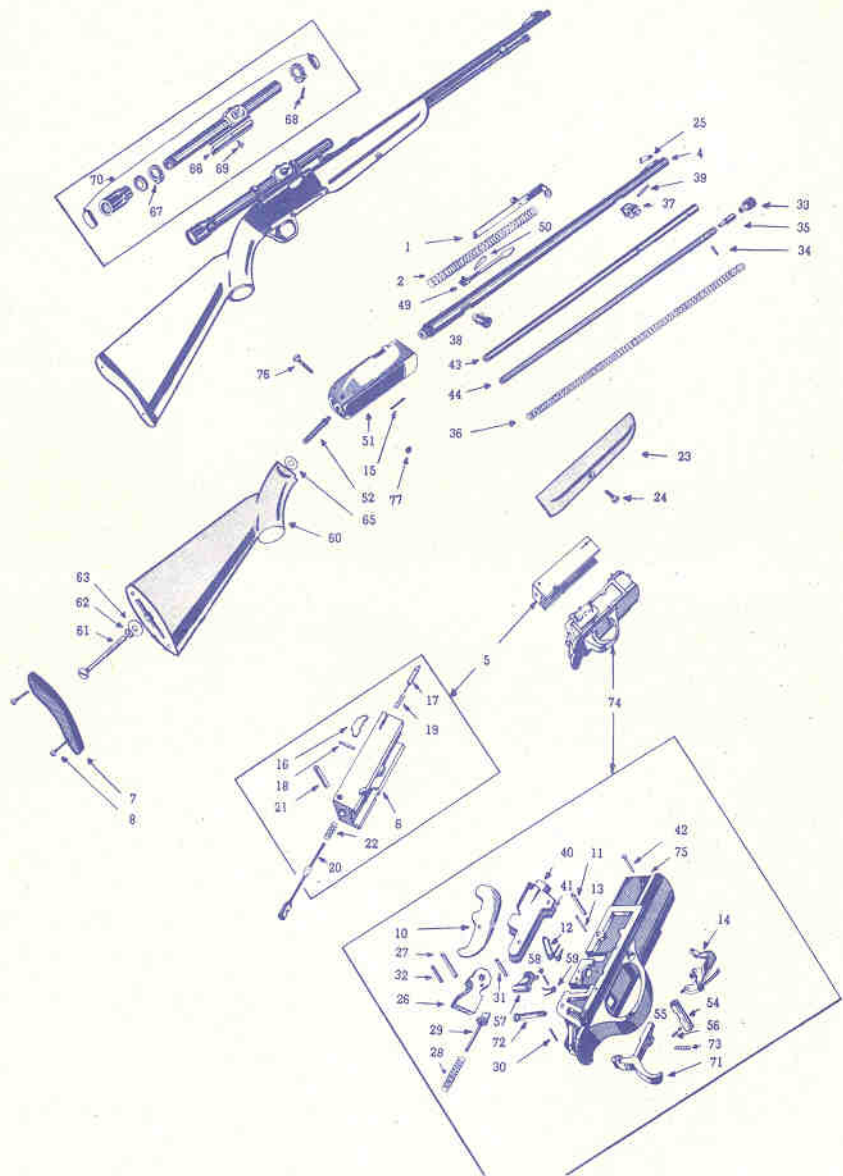

Figure 6

## SPECIFICATIONS

Length of Pull	13¾ inches
Drop at Heel	2¼ inches
Drop at Comb	1½ inches
Barrel Length	23¼ inches
Over-All Length	41¾ inches
Weight of Gun	5 lbs. 5 oz.
Weight of Scope and Mount	8 oz.
Magazine Capacity	18 Long rifle
Front Sight	Ramp type with gold bead
Rear Sight	Rocky Mountain partridge type with serrated blade for elevating at 25 yard intervals.
Butt Stock & Fore-end	American black walnut.

Your new J. C. Higgins Model 28 .22 caliber auto-loading rifle is the finest auto-loading .22 rifle ever offered — and at an amazingly low price. Built to last a lifetime — of the finest materials and workmanship. Your complete satisfaction is guaranteed.



**LIST OF PARTS AND ASSEMBLIES FOR  
J. C. HIGGINS MODEL 28.22 CALIBER  
AUTO-LOADING RIFLE**

**MODEL NUMBER 583.71**

This is the Model Number of your Shotgun. It will be found on the left side of barrel, just forward of receiver. Always mention this Model Number when communicating with us regarding the gun or when ordering parts.

**HOW TO ORDER REPAIR PARTS**

All parts listed herein may be ordered through any Sears retail or mail order store. In ordering parts by mail from the mail order store which serves the territory in which you live, always be sure to follow instructions below. Save this list—it is valuable.

**WHEN ORDERING REPAIR PARTS AND/OR ASSEMBLIES**

Please specify Model No., Reference No., Parts No. and Part Name. All parts identified with an asterisk (\*) must be fitted to the gun by gunsmiths in the Sears mail order houses or by qualified gunsmiths.

Ref. No.	Part No.	PART NAME	Ref. No.	Part No.	PART NAME
1	300M	*Action Bar Assembly .....	12	309	Cartridge Lifter Spring .....
		(Composed of:	13	310	Cartridge Lifter Spring Retaining
		300 Action Bar			Pin .....
		302 Action Bar Handle)	14	311M	*Disconnecter Assembly .....
2	304	*Action Bar Spring .....			(Composed of:
4	305M	*Barrel and Ramp Assembly.....			311 Disconnecter
		(Composed of:			312 Disconnecter Hinge Pin
		305 Barrel			313 Disconnecter Pin
		393 Front Sight Ramp)			314 Disconnecter Spring)
5	306M	Bolt Assembly .....	15	315	*Ejector .....
		(Composed of:	16	316	Extractor .....
		306 Bolt	17	317	Extractor Plunger .....
		320 Firing Pin Spring	18	432	Extractor Plunger Retaining Pin.....
		319 Firing Pin	19	318	Extractor Spring .....
		379 Firing Pin Retaining Pin	20	319	Firing Pin .....
		318 Extractor Spring	21	379	Firing Pin Retaining Pin .....
		317 Extractor Plunger	22	320	Firing Pin Spring .....
		316 Extractor	23	322	Forearm, .....
		432 Extractor Plunger Retaining	24	323	Forearm Retaining Screw .....
		Pin)	25	392	Front Sight .....
6	306	Bolt .....	26	324	*Hammer .....
7	344	Butt Plate .....	27	325	Hammer Pin .....
8	345	Butt Plate Screw .....	28	326	Hammer Spring .....
10	307	Cartridge Lifter .....	29	327	Hammer Spring Guide .....
11	308	Cartridge Lifter Pin .....	30	328	Hammer Spring Pin .....

Ref. No.	Part No.	PART NAME	Ref. No.	Part No.	PART NAME
31	329	Hammer Stop Pin .....	71	357	Trigger .....
32	330	Hammer Strut Pin .....	72	359	Trigger Pin .....
33	331	Magazine Cap .....	73	360	Trigger Spring .....
34	332	Magazine Cap Pin .....	74	422M	Trigger Guard Assembly .....
35	333	Magazine Follower .....			(Composed of:
36	336	Magazine Spring .....			358 Trigger Guard
37	437	*Magazine Support .....			346 Safety Button
38	335	*Magazine Support, Rear .....			347 Safety Button Plunger
39	338	Magazine Support Pin .....			348 Safety Button Plunger Spring
40	340	Magazine Throat, Right Hand .....			382 Safety Button Spring Retain-
41	339	Magazine Throat, Left Hand .....			ing Screw
42	381	Magazine Throat Retaining Pin.....			357 Trigger
43	341	Magazine Tube .....			360 Trigger Spring
44	334	Magazine Tube, Inside .....			359 Trigger Pin
49	394M	Rear Sight Assembly .....			349 Sear
		(Composed of:			350 Sear Pin
		394 Rear Sight			351 Sear Spring
		396 Rear Sight Support)			329 Hammer Stop Pin
50	395	Rear Sight Elevation .....			324M Hammer Assembly
51	421	*Receiver .....			325 Hammer Pin
52	343	Receiver Tang .....			327 Hammer Spring Guide
54	346	Safety Button .....			326 Hammer Spring
55	347	Safety Button Plunger .....			328 Hammer Spring Pin
56	348	Safety Button Plunger Spring.....			309 Cartridge Lifter Spring
57	349	*Sear .....			310 Cartridge Lifter Spring Re-
58	350	Sear Pin .....			taining Pin
59	351	Sear Spring .....			340 Magazine Throat, R.H.
60	423	Stock .....			339 Magazine Throat, L.H.
61	353	Stock Bolt .....			307 Cartridge Lifter
62	354	Stock Bolt Lock Washer .....			308 Cartridge Lifter Pin
63	355	Stock Bolt Washer .....			381 Magazine Throat, Retaining
65	424	Stock Washer .....			Pin
66	384	Telescope Base .....			311M Disconnecter Assembly)
67	386	Telescope Base Clamp Ring .....	75	358	Trigger Guard .....
68	387	Telescope Base Clamp Ring Screw	76	376	Trigger Guard Retaining Pin
69	385	Telescope Base Lock Screw .....	77	377	Trigger Guard Retaining Pin
70	434M	Telescope Eye Piece Cap Assembly			Spring
		(Composed of:			
		420 Telescope Eye Piece Cap			
		419 Telescope Front Dust Cap			
		434 Telescope Dust Cover Cord)			