

Important customer
information. Do not
remove from gun.



Ithaca gun

Model 51

The gas-auto with
a lifetime operational
warranty.



Congratulations

on the purchase of your new Ithaca Model 51, the gas-semiautomatic shotgun with the lifetime operational warranty.

All you need to assemble the Model 51 are your bare hands. No special tools are needed. To insure proper assembly, follow the steps outlined in your Owner's Guide. Then fill out and mail the warranty card on the last page to receive your lifetime operational warranty card.

Your Model 51 is the result of over 90 years of gun building. It is so well designed, "we call it the Simple Shooting Machine". Its Everlast™ gas system has only one moving part; it has a machined steel receiver, tough Roto-Forged® BARREL and an exclusive triple-locking rotary bolt. We're proud of the Model 51, the way it works, the way it lasts. We're confident that over many years of longed use, you will be too.



Assembly

When removed from the shipping carton, your new Ithaca Model 51 will have the barrel removed. To assemble, proceed as follows:

- 1.** Unscrew the forend nut and remove the forend from the receiver assembly.

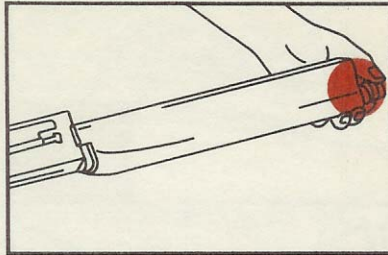

- 2.** Pull back the charging handle to lock the action open.

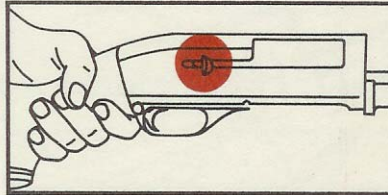

- 3.** Insert barrel in receiver, making certain that the barrel is fully seated. When you hear a metallic "click", the barrel is fully seated.

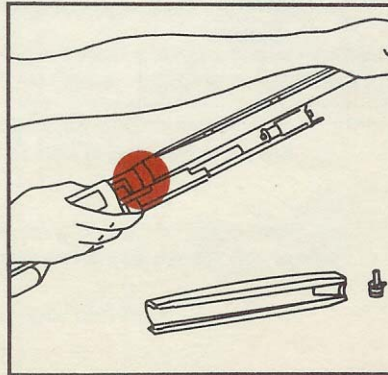

- 4.** Replace forend, and screw down forend nut hand tight.

Loading

The Model 51 has a three shot capacity.

NOTE: Standard gun is designed for all 2 $\frac{3}{4}$ " shells. Magnum gun is designed for 2 $\frac{3}{4}$ " and 3" magnum shells ONLY.

1. Always be certain your gun is pointed in a safe direction when loading or unloading.
2. Put safety in the "On" or "Safe" position. Safety is "On" when the red ring around the safety button *cannot* be seen.
3. Open action by pulling back charging handle.

4. Place one shell in chamber.

5. Close action by depressing the carrier release button located just forward of the trigger guard.

6. Two additional shells may now be placed in the magazine. Depress the carrier release button with the front of the shell and push

forward into the magazine until the rim passes the cartridge stop. Load the second shell in an identical manner. Note! The Model 51 is designed to allow the shell in the magazine to be seen by having the shell extend $\frac{5}{8}$ " out of the magazine tube.

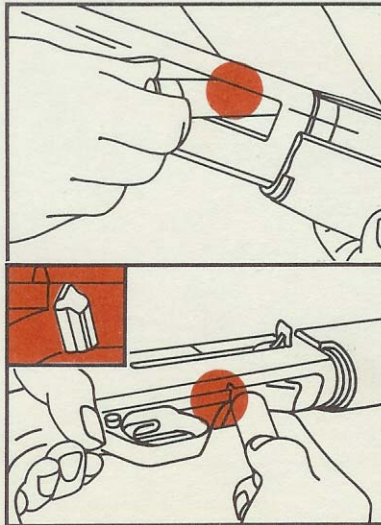

Unloading

1. To unload, with the safety "On", the shells are removed by working them through the action manually. Carrier release must be depressed on each opening.

Take Down and Assembly

For inspection and complete cleaning the Model 51 can be easily field stripped. Be certain that the gun is unloaded, then proceed as follows:

Removing Barrel

1. Pull back charging handle to lock action open.
2. Remove forend nut and forend.
3. Remove barrel.

Removing Action Assembly

1. Close action slowly, holding charging handle to prevent bolt from closing rapidly.
2. Remove charging handle by pulling straight out from bolt.
3. Pull action assembly forward and remove from receiver.

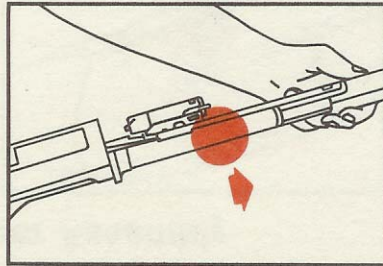
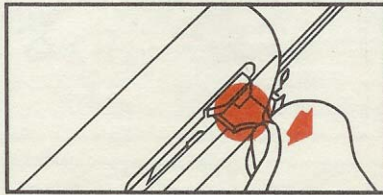

Removing Trigger Assembly

1. Press out the two pins on the side of the receiver.

2. Pull down on trigger guard to remove assembly.

NOTE: Further disassembly of the action should not be required. Additional takedown should be performed only by a competent gunsmith. To reassemble, reverse the above procedures.

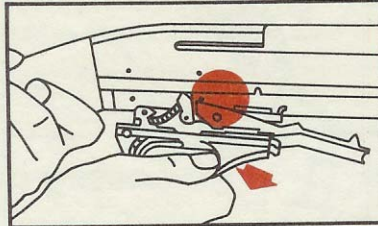
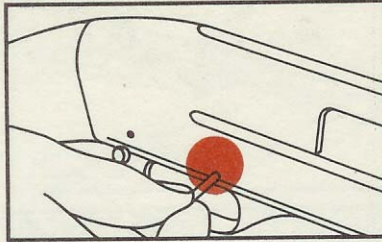

Cleaning

The gas system of the Model 51 is essentially self-cleaning. It should be inspected, however, at regular intervals to make certain that no buildup of foreign material is present.

The gas cylinder can be inspected by removing the gas piston. To remove the piston, pull the gas piston retainer far enough out of its hole to permit withdrawal of the piston. The piston and cylinder can be cleaned.

Care should be taken that *no* oil or lubricant is left in the gas system as this increases fouling.

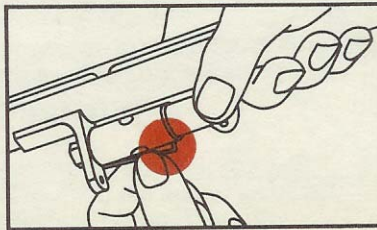

Lubrication

To insure proper functioning and satisfactory performance the Model 51 should be given the care and protection accorded any fine firearm. After each shooting session the metal parts of the gun should be wiped free of moisture using a soft dry cloth. A light film of gun oil should be applied to all metal parts to retard corrosion. A periodic thorough cleaning of the gun with any of the commercially available gun cleaning solvents followed by a light application of gun oil will help to insure many years of trouble-free performance. The evaporative type industrial cleaning solvents are not recommended and should be avoided.

Cold Weather Use

When extremely low temperatures are expected all oil or grease type lubricants should be removed and the moving parts of the gun should be lubricated with one of the commercially available dry lubricants.

Prolonged Storage

To protect your Model 51 during extended periods of storage or non-use it is recommended that the gun be cleaned thoroughly and that all metal parts should be given a light coating of gun grease. This grease should be removed before the gun is returned to service.

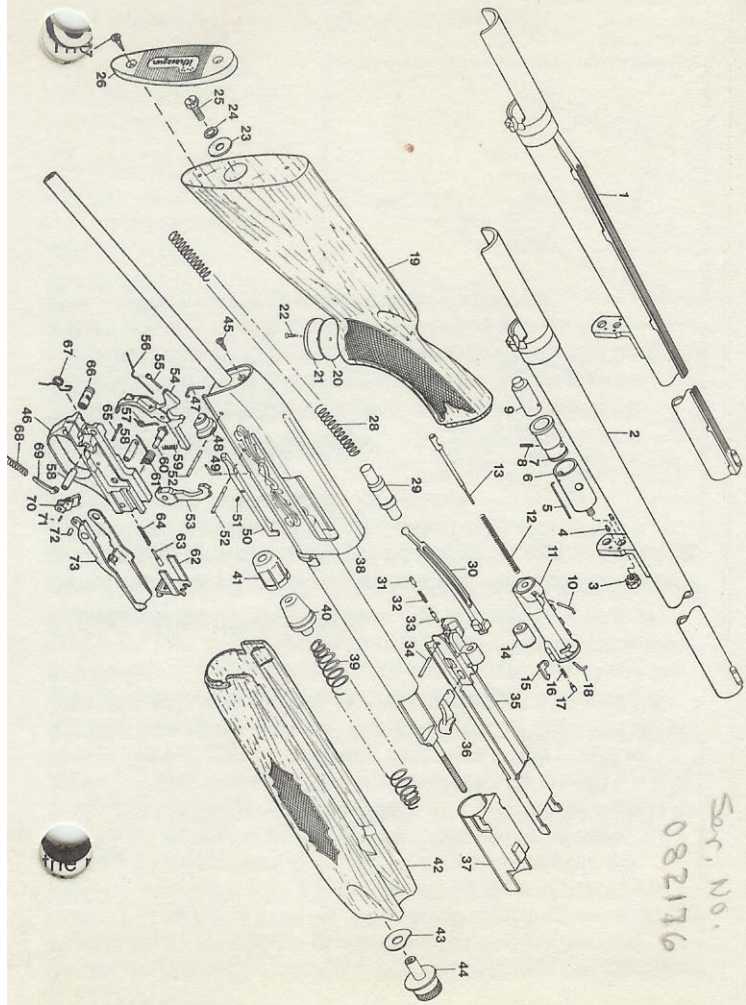

Ser. No.
082176

Ithaca Model 51 Gas-Operated Semiautomatic Shotgun

Exploded View Parts List

- | | |
|---|--|
| 1 barrel sub-assembly | 36 charging handle |
| 2 competition rib & field
made rib) | 37 rail extension tube |
| 2 barrel sub-assembly
(plain barrel) | 38 receiver sub-assembly |
| 3 gas cylinder nut | 39 magazine spring |
| 4 gas cylinder lug pins (2) | 40 inner magazine cup |
| 5 gas piston retainer | 41 outer magazine cup |
| 6 gas cylinder | 42 forend |
| 7 gas piston | 43 forend washer |
| 8 gas piston pin | 44 forend nut |
| 9 gas piston buffer | 45 receiver buffer screw |
| 10 firing pin retainer | 46 trigger plate |
| 11 bolt | 47 action spring retainer pin |
| 12 firing pin spring | 48 receiver buffer |
| 13 firing pin | 49 cartridge stop pivot |
| 14 bolt buffer | 50 cartridge stop |
| 15 extractor | 51 cartridge stop spring |
| 16 extractor spring | 52 trigger guard pins (2) |
| 17 extractor plunger | 53 hammer |
| 18 extractor pivot pin | 54 trigger |
| 19 stock | 55 disconnecter plunger |
| 20 grip cap spacer | 56 carrier pivot retainer spring |
| 21 grip cap | 57 disconnecter spring |
| 22 grip cap screw | 58 safety spring and carrier
pivots (2) |
| 23 stock bolt washer | 59 trigger spring |
| 24 stock bolt lock washer | 60 hammer pivot |
| 25 stock bolt | 61 hammer spring |
| 26 butt plate | 62 carrier release |
| 27 butt plate screws (2) | 63 carrier release plunger |
| 28 action spring | 64 carrier release spring |
| 29 action spring plunger | 65 trigger pivot pin |
| 30 link | 66 safety |
| 31 link plunger | 67 safety spring |
| 32 charging handle and
link spring | 68 carrier spring |
| 33 charging handle plunger | 69 carrier spring guide |
| 34 link pivot pin | 70 carrier cam |
| 35 action slide assembly | 71 carrier spring guide pivot |
| | 72 carrier cam pin |
| | 73 carrier |

 On all guns returned (non-warranty) a handling charge of \$3.00 will be in addition to regular charges. All orders not from Ithaca Dealers with an established account will be returned C.O.D. less any advance payment.

Model 51—Lifetime Operational Warranty*

This Ithaca Model 51 shotgun is warranted to operate satisfactorily for as long as you own it. This warranty covers any and all defects in parts, material or workmanship which affects the satisfactory operation of this gun. In addition, *but for one year from date of purchase only*, this warranty covers the cracking or splitting of wood components as well as manufacturing defects other than those that affect the satisfactory operation of the gun. Our warranty obligation is limited to the repair or replacement of any part or parts in the model 51 product which are returned to the factory or any authorized Warranty Repair Station and which are determined by us to be defective or to affect adversely the satisfactory operation of the gun. We assume no liability for any incidental or consequential damages.

Our warranty is made to the original owner of the Model 51 and is not transferable. The following items are specifically excluded from coverage under this warranty.

- (a) Normal wear of the protective or decorative finishes of the wood or metal components.
- (b) Damage or malfunction resulting from accident, negligence, misuse, or unauthorized repair or alteration;
- (c) Damage or malfunction resulting from barrel obstructions;
- (d) Damage or malfunction resulting from use of other than factory loaded (lead shot) ammunition.

This warranty is valid only upon registration with the manufacturer of the enclosed warranty card, which must be filled out and mailed within 30 days of the original purchase. Notification of registration of this warranty will be made to you in the form of a convenient wallet-sized warranty card on which your name and the serial number of your Model 51 will be recorded.

Guns to be serviced under this warranty must be brought directly or shipped prepaid to an Ithaca authorized Warranty Repair Station or to: Service Department, Ithaca Gun Company, 123 Lake Street, Ithaca, New York 14850. All guns shipped to a factory Warranty Repair Station or the Ithaca Gun Company Service Department are subject to a \$5 postage and handling charge. The handling charge will be in the form of a C.O.D. return shipment.

NO WARRANTIES ARE MADE OR ARE AUTHORIZED TO BE MADE OTHER THAN THOSE EXPRESSLY STATED HEREIN. THIS WARRANTY IS EXPRESSLY IN LIEU OF ANY OTHER EXPRESSED OR IMPLIED WARRANTY, AND OF ANY OTHER OBLIGATION OF THE MANUFACTURER.

Printed in U.S.A.