



HI-STANDARD REVOLVER



PARTS PRICE LIST—.22 CALIBER MODEL "R-106" "SENTINEL DELUXE"

NUMBERS ARE ONLY FOR BLUED GUNS — SEE PARTS LIST FOR NICKEL

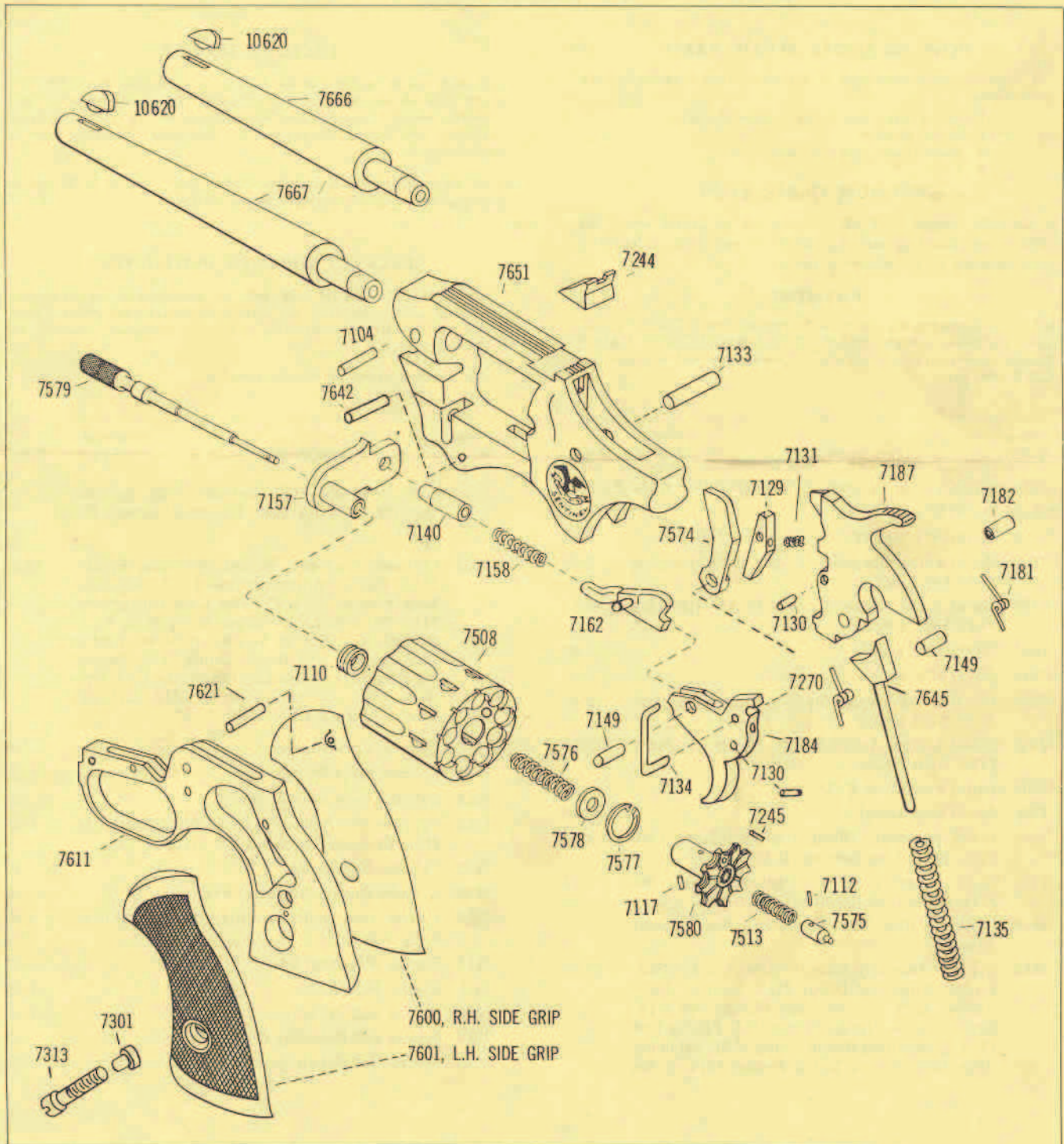

THE HIGH STANDARD MANUFACTURING CORPORATION

HAMDEN • CONNECTICUT

HI-STANDARD

.22 CALIBER DOUBLE - AND SINGLE-ACTION REVOLVER

PARTS LIST AND PRICES

(Prices Subject to Change Without Notice)

"SENTINEL DELUXE"

MODEL R-106 BLUED AND NICKEL

HOW TO ORDER REPAIR PARTS

The following information must be furnished when ordering replacement parts:

1. Model Name and Series Number (R-106)
2. Serial Number
3. Number and Name of Parts
4. Color

MINIMUM ORDER \$1.00

A minimum charge of \$1.00 is made on all orders where the normal cost would be less than \$1.00. If you wish, order extra parts to make up the minimum charge.

PAYMENT

All parts shipments will be made by Parcel Post C.O.D. unless advance remittance is made. PLEASE DO NOT SEND CASH OR STAMPS. Checks, Money Orders, or Drafts are acceptable and will save you C.O.D. charges.

FACTORY SERVICE

If parts are to be fitted at the factory, send revolver marked for the attention of our SERVICE DEPARTMENT, furnishing complete and specific repair instructions. A cost estimate of the parts and labor charges will be immediately sent for your approval before work is started.

Unless a flat rate charge is specified, a MINIMUM of \$6.50 will be charged on servicing revolver at the factory.

REVOLVER SHIPPING INSTRUCTIONS

BONAFIDE DEALERS IN FIREARMS are permitted by postal regulations to send revolvers to the factory by Parcel Post. INDIVIDUALS are not permitted to mail firearms and we recommend shipment by railway express.

All shipments to factory must be prepaid.

Part Number	Part Name	Model (R-106)	Price
Parts Marked With an Asterisk (*) Must Be Fitted at the Factory			
*7666	Barrel (4"), Blued		\$ 7.00
*7448	Barrel (4"), Nickel		9.00
*7656	Barrel & Sight Assembly (4", 6"), Blue, (includes Front Sight 10620)		8.50
*7455	Barrel & Sight Assembly (4"), Nickel, (includes Front Sight 10620)		10.50
*7667	Barrel (6"), Blued		7.00
*7449	Barrel (6"), Nickel		9.00
*7657	Barrel & Sight Assembly (6"), Blued, (includes Front Sight 10620)		8.50
*7456	Barrel & Sight Assembly (6"), Nickel, (includes Front Sight 10620)		10.50
7104	Barrel Pin, Blued 4", 6"		.30
7196	Barrel Pin, Nickel		.40
7157	Crane Assembly, Blued, (includes Crane Link 7105, Crane Link Bearing 7107)		3.00
7197	Crane Assembly, Nickel, (includes Crane Link 7233, Crane Link Bearing 7107)		4.00
7508	Cylinder, (Not Sold Separately) See Cylinder Assembly		
7634	Cylinder Assembly, Blue, (includes Ejector 7580, Ejector Alignment Dowel 7117, Cylinder Lock Plunger 7575, Cylinder Lock Plunger Pin 7112, Cylinder Lock Plunger Spring 7513, Ejector Rod 7579, Ejector Rod Return Spring 7576, Retaining Ring 7577, Return Spring Washer 7578, Crane		18.50

Part Number	Part Name	Model (R-106)	Price
	Link Assembly 7157, Cylinder 7508, Cylinder Bushing 7110, Cylinder Ejector Alignment Pin 7245)		
7635	Cylinder Assembly, Nickel, (includes Ejector 7580, Ejector Alignment Dowel 7117, Cylinder Lock Plunger 7575, Cylinder Lock Plunger Pin 7112, Cylinder Lock Plunger Spring 7513, Ejector Rod 7477, Ejector Rod Return Spring Washer 7578, Ejector Rod Return Spring 7576, Retaining Ring 7577, Crane Link Assembly 7197, Cylinder 7508, Cylinder Bushing 7110, Cylinder Ejector Alignment Pin 7245)		20.50
7575	Cylinder Lock Plunger		.75
7112	Cylinder Lock Plunger Pin		.30
7513	Cylinder Lock Plunger Spring		.30
7162	Cylinder Stop Assembly, (includes Cylinder Stop 7114, Cylinder Stop Cross Pin 7115)		1.85
7158	Cylinder Stop Spring		.30
7245	Cylinder Ejector Alignment Pin		.30
*7580	Ejector, (Not Sold Separately, Must be Qualified to Cylinder)		3.00
7117	Ejector Alignment Dowel		.30
7579	Ejector Rod, Blued		1.25
7477	Ejector Rod, Nickel		1.85
7577	Ejector Rod Retaining Ring		.30
7578	Ejector Rod Return Spring Washer		.30

CAUTION: FOR SAFETY'S SAKE DO NOT ATTEMPT TO REPAIR REVOLVER WITHOUT RECEIVING RELIABLE

Part Number	Part Name	Model (R-106)	Price	Part Number	Part Name	Model (R-106)	Price
7576	Ejector Rod Return Spring		.30	7574	Hand		1.25
*7651	Frame, Blue, (Not Sold Separately)		8.00	7181	Hand Spring		.30
*7458	Frame, Nickel, (Not Sold Separately)		12.00	7140	Link Pivot Pin		.60
7600	Grip, Brown, R.H.		2.50	7182	Hammer Sleeve		.30
7601	Grip, Brown, L.H.		2.50	10620	Sight, Front for Blue, Nickel, 4" Barrels		1.25
7621	Grip Alignment Pin		.30	10620	Sight, Front for Blue, Nickel, 6" Barrels		1.25
7313	Grip Screw		.30	7244	Sight, Rear		1.50
7301	Grip Escutcheon Nut		.35	7184	Trigger for Blued and Nickel Revolvers		3.75
7187	Hammer, for Blued and Nickel Revolvers		4.50	7290	Trigger and Trigger Spring Contact Pin Assembly for Blued and Nickel Revolvers		4.00
7189	Hammer Assembly, (includes Hammer 7187, Hammer Pawl 7129, Pin 7130, Spring 7131)		7.50	*7611	Trigger Guard, Blued		7.50
7129	Hammer Pawl		1.25	*7411	Trigger Guard, Nickel		8.50
7130	Hammer Pawl Pin		.30	7149	Trigger Pivot Pin		.30
7131	Hammer Pawl Spring		.30	7270	Trigger Spring		.30
7133	Hammer Pivot Pin, Blued		.30	7149	Trigger Spring Retaining Pin		.30
7160	Hammer Pivot Pin, Nickel		.40	7130	Trigger Spring Contact Pin		.30
7134	Hammer Safety Stop		.30	7642	Trigger Guard Assembly Pin, Blue		.30
7135	Hammer Spring		.30	7442	Trigger Guard Assembly Pin, Nickel		.40
7645	Hammer Spring Guide Assembly		1.50				

INSTRUCTIONS FOR OPERATION AND CARE OF YOUR "SENTINEL" REVOLVER

LOADING AND FIRING:

1. Be sure that hammer is forward.
2. Pull ejector rod forward and, at the same time, swing out cylinder to left by pressing right index finger against it (see Figure 1).
3. Insert one .22 caliber short, long or long rifle cartridge in each of the nine chambers of the cylinder.
4. Return cylinder to frame by pressing thumb against cylinder. Do not push ejector latch forward when closing cylinder. The revolver is now ready to fire.
5. Revolver may be fired double action merely by squeezing trigger for each shot.
6. Target shooting, or other shooting demanding a maximum of accuracy, is usually done single action. For single-action shooting, pull back hammer to cocked position for each shot.
7. To unload revolver or remove fired cartridge cases, pull ejector rod forward, swing out cylinder to left (see Figure 1), and push ejector rod to rear (see Figure 2).
8. Spring loaded ejector will return automatically to forward position.
9. Because cylinder chambers are counterbored, revolver may be "dry-fired" without injury to cylinder.

Sentinel revolvers are sighted in at a range of 50 feet. If lateral adjustment is desired because of individual preference in sighting or holding,

tap the rear sight gently, using a brass or plastic hammer. Move the rear sight in the direction you want the point of impact to move.

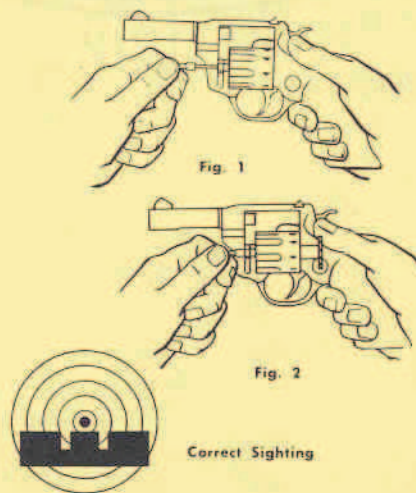

CARE AND CLEANING SENTINEL

1. If, after extensive shooting, cleaning becomes necessary, the use of kerosene or any other good quality cleaning solution is recommended.
2. In cleaning the face of the cylinder or muzzle, an old toothbrush or similar brush should be used. Unless mud or foreign matter enters the bore, it should be cleaned very sparingly. If cleaning be-

comes necessary, a stiff bristle brush or copper wire brush for .22 caliber guns should be used. After brushing, the bore should be swabbed with flannel patches attached to a .22 caliber cleaning rod (patches should be moistened with a good quality gun oil). The swabbing of the bore should be continued until the patches come out clean. IT IS STRONGLY EMPHASIZED THAT THE BORE RARELY REQUIRES CLEANING EXCEPT FOR THE PRESENCE OF MUD OR FOREIGN MATTER.

3. In cleaning the cylinders of the revolver, the same procedure as used in the cleaning of the bore should be employed.

4. The entire gun should be wiped dry of kerosene or cleaning solution with a clean absorbent cloth and then the surfaces should be wiped with a lightly oiled patch.

5. For best results in rust prevention only gun oils containing silicones should be used.

6. A few drops of light-bodied oil should be applied to the action internally near the pivot point of the hammer. Retract the hammer first — then work the trigger double action a few times to distribute the oil. The same procedure applies to the cylinder crane link and the ejector latch slot in the housing affixed to the barrel.

7. Avoid using heavy-bodied oils. No animal or vegetable oils should ever be used in guns.

8. If the gun is used in climates where extreme cold prevails, powdered graphite should be substituted for oil in lubricating the internal mechanism. In moist climates the gun should be cleaned more frequently and preferably stored in a container treated with silicones to prevent rust.

