

PM2 INSTRUCTION MANUAL



IF YOU WON'T READ THIS OWNERS MANUAL AND HEED THE WARNINGS AND INSTRUCTIONS.
PLEASE DO NOT BUY THE GUN

YOU NEED TO READ:

10 LIFE SAVING WARNINGS:

1. Removing the magazine from the shotgun does not mean that the gun is empty - or unloaded - or not able to fire... if a round is in the chamber, this shotgun **CAN BE FIRED**, with the **MAGAZINE IN OR OUT**...
2. Always point the muzzle of any firearm in a safe direction whether the gun is loaded or unloaded...
3. No hands over muzzle / no way / no time / no how...
4. Use correct ammunition as referenced by markings on barrel of your shotgun... if you have **ANY** doubt about cartridge length or gauge or load, call us or write to us... we are able to answer your questions.
5. Use ammunition made by well known manufacturers and sold by dependable/knowledgeable shop keepers... **DO NOT** use non standard or hand loaded or remanufactured or reloaded ammunition... too often the few cents that you save can be very costly in damages or injuries...
6. **NEVER ALTER** your shotgun or allow anyone not connected with or authorized to represent the manufacturer to **MODIFY, CHANGE, or ADJUST** any of the working parts of your gun...
7. Learn to clean your barrel and to inspect it very regularly... any obstruction in a shotgun barrel is very dangerous. Small bits of cartridge wad or mud or snow or dirt or water can cause great personal injury to the shooter and observers as well as irreparable damage to the gun...
8. Wear ear protection and eye protection whenever and wherever you shoot your shotgun...
9. Treat every gun as if it is loaded... all the time.
10. Your gun can not think... you must be alert and thoughtful at all times to insure your safety and the safety of the people and property near you... no drugs... no drinking...

EUROPEAN AMERICAN ARMORY

P.O. Box 3496 Bright Station, Hialeah, FL 33013

GENERAL INFORMATION:

The basic operation and design of all of the better grade slide or pump action shotguns is quite similar... our gun is outstanding due to:

1. The carefully selected materials used in many of our parts
2. The fit and finish of the metal to metal part match up
3. The unique magazine leading arrangement which has been developed and tested and perfected. This shotgun should only be used with brass and plastic shotgun shells. All plastic shotgun shells may cause magazine feeding problems

EXTERNAL CONTROL PARTS:

1. Slide or forearm moves rearward to remove spent or empty cartridge cases or to unchamber a live round that is not to be fired... slide or forearm moves forward to pick up a live cartridge from the magazine and carry it into the firing chamber.
2. Action unlock lever will, when held down, allow opening of the slide for quick inspection or unloading of chamber.
3. Cross trigger safety will block the trigger when engaged so that the red ring is not showing and will permit trigger to fire gun when red ring is showing. **CAUTION:** this safety **ONLY** blocks the trigger.
4. Magazine release lever, when pushed forward permits insertion or removal of the magazine. A pendulum motion of the magazine during insertion and/or removal insures lips of the magazine body to securely engaged on release lever.

TO LOAD YOUR SHOTGUN:

The removable box magazine will hold 6 rounds of 12 Ga 2 3/4" or 3" factory ammo... do not try to force more than the 6 rounds into the magazine because you will either damage the cartridge or the magazine by trying to load more than the designated capacity.

AFTER MAGAZINE IS LOADED:

1. Engage cross trigger safety so that red ring is not showing
2. Point muzzle in safe direction
3. Push action unlock lever to allow forearm on slide to move rearward
4. Inspect chamber and bore to make sure that barrel is clean and unobstructed and that chamber is empty
5. Magazine may now be inserted by engaging forward lip of magazine body into bottom of receiver and, with pendulum motion, rotating rear of magazine up into receiver smartly.
6. You may now load the chamber. This is done by sliding forward the forearm, which will strip a round from the magazine and put it into the chamber ready to fire as soon as the cross trigger safety has been pushed to the off position and the red ring shows...

TO FIRE YOUR SHOTGUN:

Make sure you have the gun pointed in a safe direction and pull the trigger rearward till it stops at the trigger guard.

Should shot shell fail to fire do not move gun into another position and do not open the action for at least 60 seconds... A defective cartridge may be slowly igniting and could go off after a long delay from the time you pulled the trigger. At the end of 60 seconds from the time you pulled the trigger and the round did not go off, you may carefully pull back the slide or forearm to remove the defective cartridge. Do not try to fire that cartridge again... it should be considered dangerous and it should be safely isolated until it can be destroyed...

Sliding the forearm forward will chamber a new round from the magazine. After firing, the spent or empty hull is ejected by pulling the forearm completely rearward.

When the magazine is empty the action remains open. Do not try to force it shut with an empty magazine in the gun.

UNLOADING:

After engaging the cross trigger safety so that red ring does not show, the gun may be unloaded quite easily...

Make sure you are pointing the gun in a safe direction, push magazine release lever forward till it touches body of magazine; while keeping release lever forward, use pendulum like motion to swing magazine out of shotgun receiver body.

To clear round out of chamber, hold back action unlock lever and then cycle forearm or slide rearward to eject the round in the chamber. Visibly inspect chamber to insure that the gun is empty.

FIELD STRIPPING

Even though little maintenance is required to keep your shotgun in trouble free working order, proper care will ensure a life time of function. Described below are the sequences for disassembly, cleaning, and re-assembly.

ANY DISASSEMBLY OF THE SHOTGUN PAST THE FOLLOWING INSTRUCTIONS SHOULD BE DONE BY A COMPETENT GUNSMITH.

TOOLS AND CLEANING MATERIALS REQUIRED:

1/8 PUNCH, SMALL HAMMER, GUN CLEANING SOLVENT, BRUSHES, RODS, GUN LUBRICANTS, AND CLEANING RAGS.

1. Engage cross trigger safety
2. Point muzzle in safe direction
3. Remove magazine
4. Push action unlock lever to allow forearm on slide to move rearward
5. Inspect chamber to make sure gun is unloaded
6. Move forearm forward to center of slide position
7. Unscrew cap (Part No. 685) and remove barrel
8. With punch remove ramp pin (Part No. 626)
9. Remove feed ramp (Part No. 412) with your fingers or by pushing a long rod through the forearm guide tube
10. With punch remove trigger assembly pins (Part No. 626)
11. Remove trigger assembly with hand (do not disassembly trigger assembly)
12. Slowly and **very** carefully pull forearm forward to remove bolt assembly
13. Clean barrel inside with a solvent-soaked brush to remove residues until brush comes out clean, then dry and lubricate
14. Using a small brush clean all parts and receiver interior, then dry and lubricate
15. Carefully reinstall bolt and forearm assembly
16. Reinstall trigger assembly
17. Reinstall feed ramp
18. Move forearm to center of stroke
19. Carefully reinstall barrel
20. Reinstall cap
21. Hold back action unlock lever and then cycle forearm rearward and the pull forearm forward
22. Making sure the gun is unloaded and pointing in a safe direction, release cross trigger safety and pull trigger to check for function
23. If problems check reassembly procedure and if you can not remedy problems call EAA for help
24. If no problems put on cross trigger safety and gun is ready for use
25. If the gun is put away for a long period of time, keep bolt shut and hammer disengaged and cross trigger safety on. Oil outer surfaces lightly with a quality oil

PM2 PARTS BREAKDOWN DRAWING

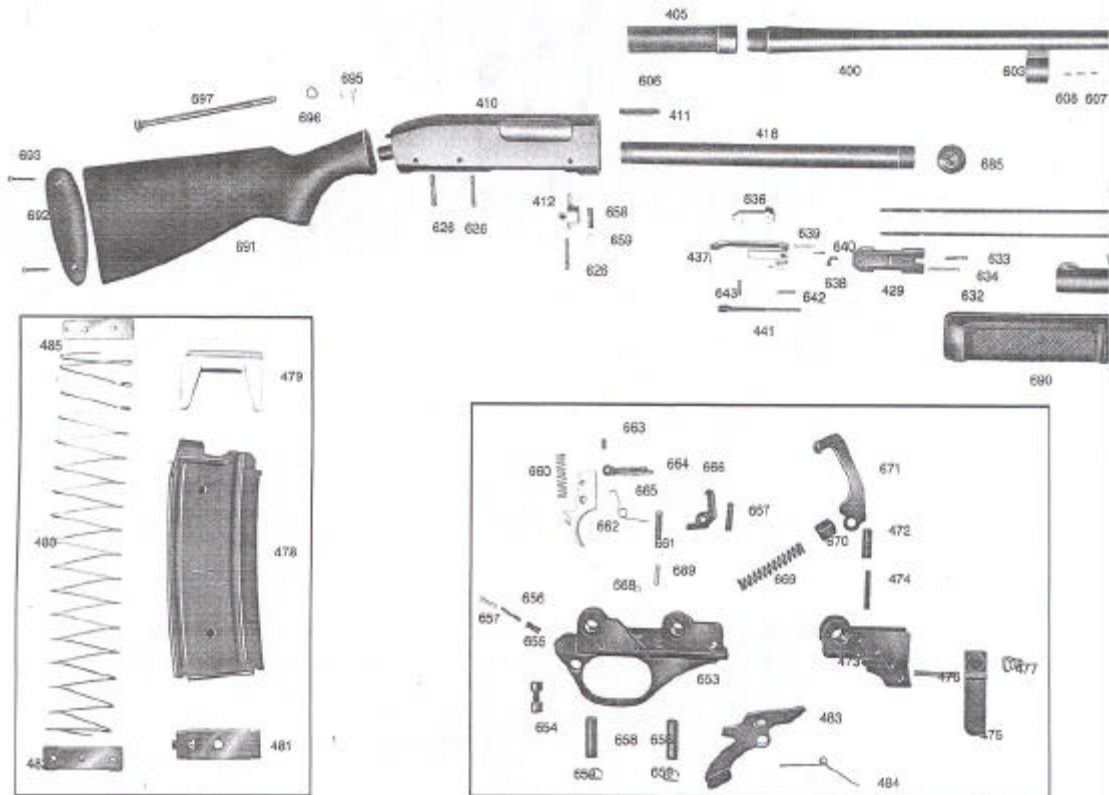

PM2 PARTS LIST

400	BARREL	836	LOCKING BLOCK	671	HAMMER
405	BARREL EXTENSION	437	BREACH BLOCK	472	HAMMER PIN
505	EJECTOR	838	EXTRACTOR	473	MAGAZINE RELEASE CATCH HOUSING
507	CAP DETENTE	839	EXTRACTOR SPRING	474	MAGAZINE RELEASE HOLDING PIN
508	CAP DETENTE SPRING	840	EXTRACTOR PLUNGER	475	MAGAZINE RELEASE
509	CAP DETENTE PIN	441	FIRING PIN	476	MAGAZINE RELEASE PIN
600	BARREL LUG	642	FIRING PIN SPRING	477	MAGAZINE RELEASE SPRING
410	RECEIVER	843	FIRING PIN RETAINING PIN	483	ACTION UNLOCK LEAVER
411	LOCKING BLOCK SHOE	650	TRIGGER HOUSING	484	ACTION UNLOCK SPRING
412	FEED RAMP	854	SAFETY	689	OVER TRAVEL PIN
505	BUSHING	855	SAFETY DETENTE		
659	LOCK SPRING	855	SAFETY SPRING		
625	TRIGGER HOUSING PIN & RAMP PIN	657	SAFETY DETENTE RETAINING PIN	691	STOCK
418	FORE ARM GUIDE TUBE	860	TRIGGER SPRING	692	BUTT PLATE
585	CAP	861	TRIGGER PIN	693	BUTT PLATE SCREW
504	FRONT SIGHT	662	TRIGGER	696	STOCK WASHER
428	ACTION BAR	663	TRIGGER BAR PIN	696	STOCK LOCK WASHER
429	BOLT CARRIER	664	TRIGGER BAR	697	STOCK BOLT
530	FORE ARM IRON	665	SEAR SPRING	478	MAGAZINE BODY
531	FORE ARM IRON NUT	666	SEAR	479	MAGAZINE FOLLOWER
533	BOLT PLUNGER	667	SEAR PIN	480	MAGAZINE SPRING
534	BOLT PLUNGER SPRING	668	RING	481	MAGAZINE FLOOR PLATE
580	FORE ARM	669	HAMMER SPRING	482	MAGAZINE RETAINING PLATE
632	BOLT PLUNGER RETAINING PIN	670	HAMMER SPRING CUP	485	MAGAZINE FOLLOWER GUIDE

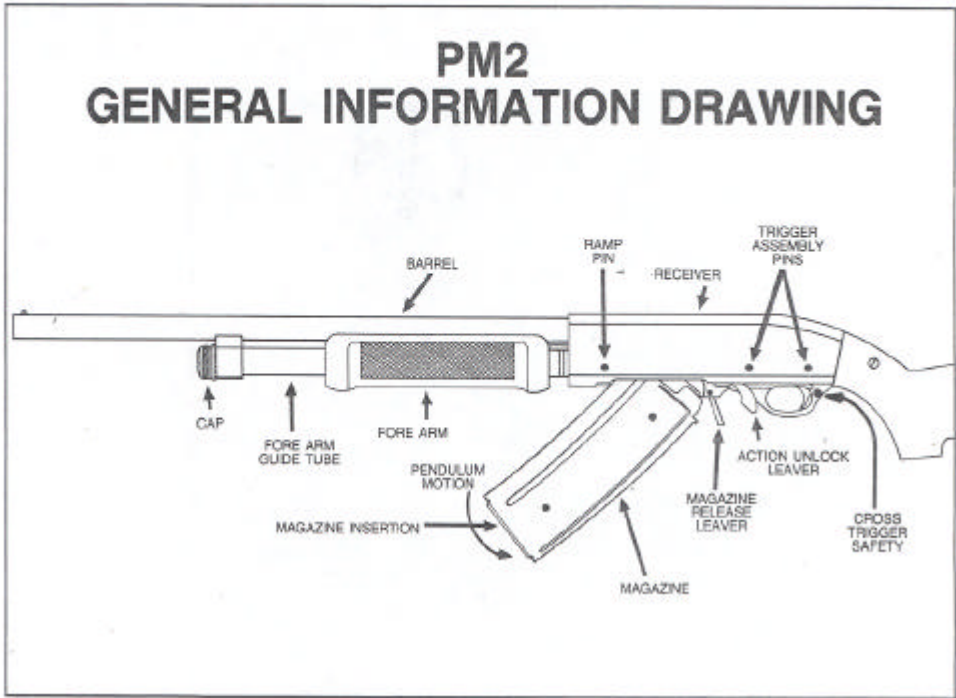

WARNING!

This gun was manufactured to perform properly with the original parts as designed. It is your duty to make sure any parts you buy are installed correctly and that neither replacements nor originals are altered or changed. Your gun is a complex tool with many parts that must relate correctly to other parts. Putting a gun together wrong or with modified parts can result in a damaged gun, danger, and injury or death to you and others through malfunction. Always let a qualified gunsmith work on your gun or at least check any work not performed by a gunsmith. We at EAA think this is a small price to pay for firearms safety.

**FAILURE TO READ AND UNDERSTAND THESE WARNINGS
MAY BE DETRIMENTAL TO YOU OR OTHERS!**

WARNINGS

READ THIS AND BE A SAFE SHOOTER

Always keep the muzzle pointed in a safe direction.

Never point a gun at any person or thing you don't intend to shoot.

Treat every gun as if it is loaded... all the time.

Get instructions from a competent firearms instructor before using any gun.

Never rely on a gun's "safety" to protect you from unsafe gun handling. A safety is only a mechanical device, not a substitute for common sense.

Keep your finger **off the trigger** until you are actually aiming at the target ready to shoot.

Don't alter or modify your gun, and have guns serviced regularly.

Be certain the gun is unloaded before cleaning.

Always empty guns before entering a house, car, truck, boat, RV, camp or any building.

Never leave a loaded gun unattended.

Store guns and ammunition separately **beyond the reach of children.**

Don't "test the safety" by pulling the trigger while the safety is on.

Be sure of your target and backstop before you shoot. Ask yourself what your bullet will hit if it misses the target.

Be sure the barrel is clear of obstruction before shooting.

Guns and alcohol or drugs don't mix. Don't take them before or during shooting activities.

Never pull a gun towards you by the muzzle. Don't climb a tree or cross a fence or ditch with a loaded gun.

Load and unload with the muzzle pointed in a safe direction.

If a gun fails to fire when trigger is pulled, keep it pointed at target for at least 60 seconds. Sometimes slow primer ignition will cause a "hang fire" and the cartridge will go off after a short pause.

Never shoot at hard flat surfaces or water... bullets will ricochet.

When receiving a gun always open the action and check that it's unloaded.

Never put your hand over the muzzle of a gun.

**FAILURE TO READ AND UNDERSTAND THESE WARNINGS
MAY BE DETRIMENTAL TO YOU OR OTHERS!**

WARNINGS

READ THIS AND BE A SAFE SHOOTER

Never leave a gun where it could fall and fire.

Always wear protective shooting glasses when shooting on the range or in a field or forest.

Old or reloaded ammo may be dangerous. We recommend against using it.

Spectators should be 10 feet behind and away from the shooter while loading, firing and unloading.

Wear hearing protection when shooting, or at a shooting range, or near shooting activities.

Load the gun only when on the range preparing to fire, and unload it before leaving the range.

Don't try to change your gun's trigger pull, because alterations of trigger pull usually affect sear engagement and may cause accidental firing.

If you do drop your gun, unload it and check it for proper function before using it again.

Always wear fluorescent orange vest, hat or jacket when in the woods or fields.

Never let water, snow, mud or other material enter barrel.

Firearms should be unloaded when not actually in use.

Many ammunition identifications sound similar. Make sure you do not use wrong size ammo in your gun.

Write to us concerning any items or circumstances which you don't understand and which might relate to your safety and the operation of any of our products.

WARNING

ANY BORE OBSTRUCTION, EVEN IF IT IS ONLY PARTLY BLOCKED, MAY CAUSE THE GUN TO BLOW UP IF IT IS FIRED, OR MAY CAUSE DAMAGE TO THE GUN SUCH AS A BULGED BARREL. TO AVOID INJURY OR DEATH TO THE SHOOTER OR BYSTANDERS, CHECK THE BARREL BEFORE SHOOTING OR IF A SHOT DOES NOT SOUND NORMAL.

LIFE TIME LIMITED WARRANTY

All EAA guns are warranted to the original retail customer for life from date of purchase against defects in material and workmanship. All parts and labor or replacement (at our option) are covered.

Transportation to and from our repair facilities, damage caused by failure to perform normal maintenance, sales outside the United States, damage due to use of high velocity, high pressure, reloaded or other nonstandard ammunition, or any unauthorized repair, modification, misuse, abuse, or alteration of the product is not covered by this Limited Warranty.

Any implied warranties, including the implied warranties of merchantability and fitness for a particular purpose, are limited to one year from date of original retail purchase. Consequential or incidental damages or expenses, or any other expenses are not covered by this warranty.

To obtain warranty performance send your product with proof of retail purchase, freight prepaid, to:

EAA
4480 EAST 11th AVENUE
HIALEAH, FL 33013

HOME SAFETY IS PROBABLY YOUR BIGGEST CONCERN.

Hoppe's Gun Guardian is a good inexpensive gun lock kit. It works on any firearm (rifle, pistol or shotgun) or airgun, yet is instantly removable by an adult.

Hoppe's Gun Guardian kits are available in gun shops and sporting goods departments, or from Hoppe's, Airport Industrial Mall, Coatesville, PA 19320, has tested them and we recommend them. After all, you have invested this much in your new gun. Now invest a little more in your children's safety.

USED FIREARMS

If you got your EEA firearm as a used gun, **BEFORE USING IT** you should unload it and check all its functions to be sure it works correctly. Firearms are sometimes altered to work incorrectly, or parts may be removed, lost or replaced with incorrect parts. First, unload it and check it yourself and then:

1. Take it to a good gunsmith who knows about this model of EEA firearm, and have him check it over, or.
2. Send it to EEA along with \$30.00 and your name and address, and our gunsmiths will inspect it and send it back to you with a report on its condition. This service is also available if you have an older EEA product, or if you think your EEA gun has been dropped, damaged or just needs to be checked.

EAA
4480 EAST 11th AVENUE
HIALEAH, FL 33013

YOUR OWNER'S MANUAL

This manual contains important warnings which must be understood **BEFORE** using this firearm. Always keep it with the firearm.

When you lend, give or sell the firearm, be sure the manual goes with it. You can get a copy of this manual from EAA on request.