

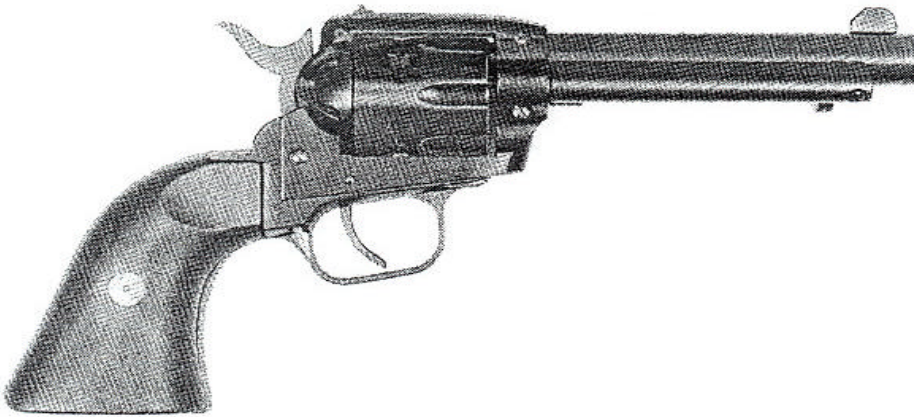

**EASA MODEL:**



# SINGLE ACTION REVOLVER



**READ THESE  
INSTRUCTIONS!**

## SPECIFICATIONS

<i>Caliber</i>	22LR, 22L or 22S 22 Mag ('M' Models Only)	<i>Finish</i>	Gold, Chrome, Blue or Blue with gold backstrap and trigger guard
<i>Barrel Length</i>	4.75 Inches	<i>Safety</i>	Manual Hammer Block, Half Cock Hammer
<i>Overall Length</i>	10.0 Inches	<i>Capacity</i>	6 Chambers (Load only 5)
<i>Weight</i>	32 Ounces	<i>Grips</i>	Target with thumb rest or European Walnut
<i>Sights</i>	Drift Adjustable		
<i>Sight Radius</i>	5.75 Inches		

Important

Read This Book Before using  
Firearm

# 1

## ALWAYS ENGAGE HAMMER BLOCK

Keep the Hammer Block engaged all the time, except at the actual moment of firing.

Pull hammer back to the first notch.

Turn Hammer back **UP**

When Hammer Block is **DOWN** a **RED DOT** can be seen to the left of the Hammer.

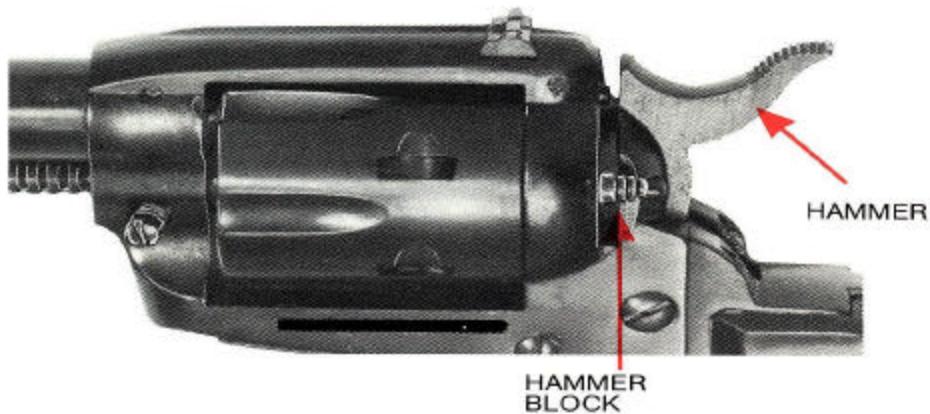

**Do not disengage Hammer Block until aiming at target, ready to shoot.**

The Hammer Block does not interfere with any functions of the Revolver except the hammer's contact with the firing pin.

Dry firing is bad for this gun, whether the Hammer Block is engaged or not.

# 2

## HOW TO LOAD

**Keep the Hammer Block engaged.**

**Point gun away in a safe direction.**

Pull hammer back to second notch.  
(Cylinder will rotate freely).

Swing the loading gate out and down to open.

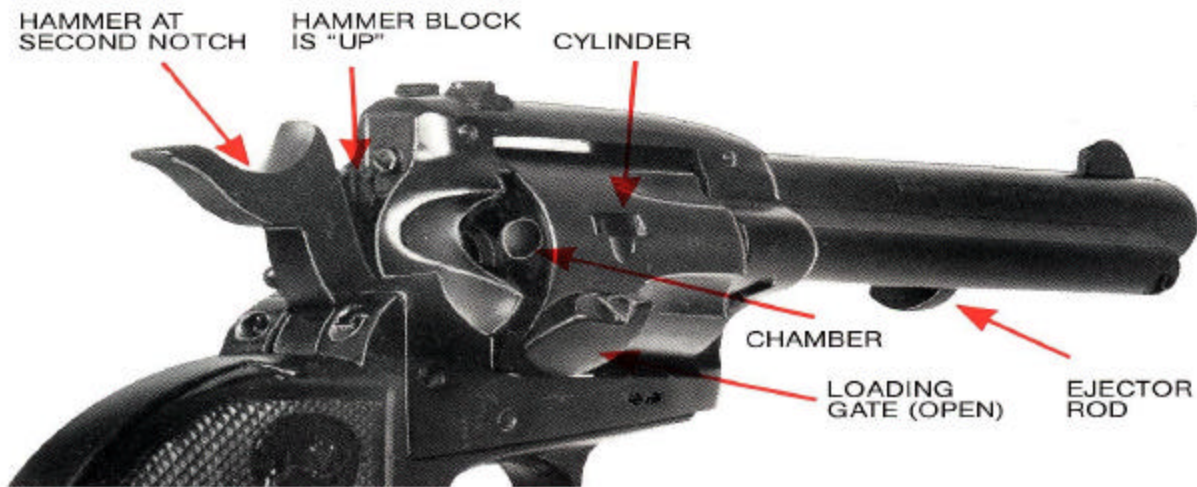

**DO NOT EVER carry a live round (loaded cartridge) in the chamber lined up with the hammer-firing pin-barrel, even if the Hammer Block is engaged. Keeping an empty chamber in line with the firing pin is good insurance against any kind of accidental firing.**

### LOADING TIP

One way to load your revolver and finish with an empty chamber lined up with the firing pin is to load one chamber **but not the next one**, then load the other four chambers (load one, skip one, load four), close loading gate and pull hammer all the way back with a brisk, smooth stroke. Then **controlling the hammer very carefully with your thumb** squeeze the trigger and let the hammer down gently to the first notch position.

If you do not understand this procedure ask your firearms instructor to explain it to you.

# 3

## HOW TO COCK AND FIRE

**Keep the Hammer Block engaged.**

**Keep your finger off the trigger and out of the trigger guard**

Pull hammer all the way back with a brisk, smooth stroke.

Point revolver at the target area.

Turn Hammer Block **DOWN** to disengage.

Aim.

**THINK!** What will you **HIT** if you **MISS** the target?

Put your finger on the trigger and squeeze.

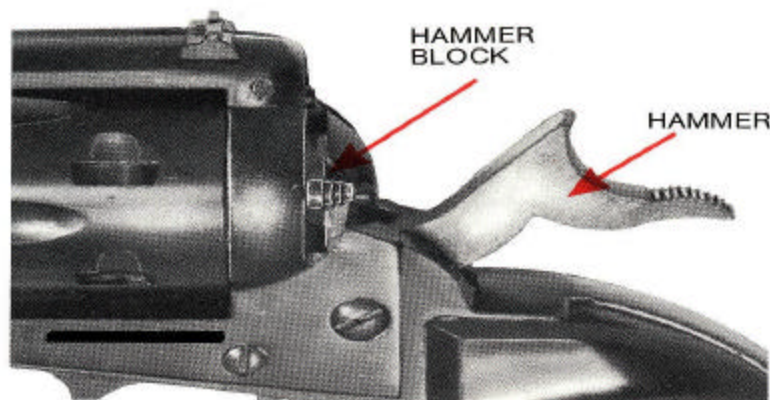

**“Quick-draws” and “fanning” the hammer are dangerous to you and others, and abusive for your gun.**

**Never “quick-draw” a loaded revolver.**

**“Fanning” the hammer will void the warranty.**

**REVOLVERS HAVE “SIDE BLAST” or “CYLINDER BLAST”, hot gasses and particles escaping at high speeds to the sides of the gun from the clearance gap between the cylinder and barrel. Keep people behind and away from you and keep your hands and body clear of the sides of the revolver when firing.**

# 4

## HOW TO UNLOAD

**Keep the Hammer Block engaged.**

**Point gun away in a safe direction.**

Pull hammer back to second notch.  
(Cylinder will rotate freely).

Open loading gate.

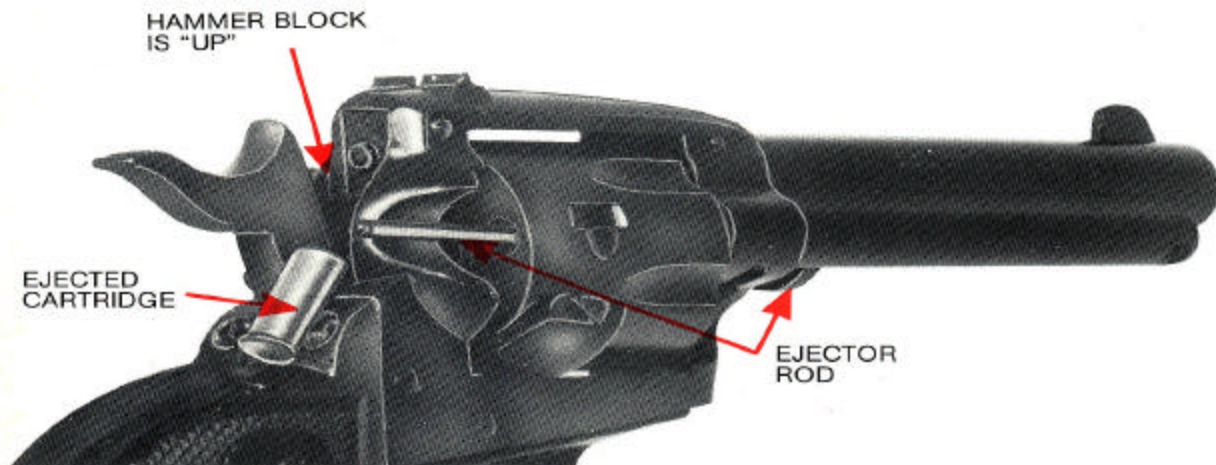

Line up chamber with ejector rod, push ejector rod back through chamber to push out cartridge.

**Do not let loaded cartridges drop to the floor or ground. Rimfire ammo may go off and injure you or others if dropped.**

Return ejector rod to its forward position, turn cylinder one click and repeat until cylinder is empty. Then return hammer to its first notch position.

## ammunition

MODEL EASA - All .22 short, long and Long Rifle rimfire ammunition, standard velocity, high velocity, hypervelocity or shotshells.

MODEL EASAM COMBO - With .22 LR cylinder, same as above. With .22 Magnum cylinder use only .22 WMR (Winchester Magnum Rimfire) ammunition.

# 5

## HOW TO CHANGE CYLINDERS IN THE EASA COMBO

### Keep the Hammer Block engaged.

Pull hammer back to second notch (cylinder will rotate freely).

### Check every chamber to be sure revolver is completely unloaded.

Press base pin retainer on left side.

Pull base pin forward out of revolver.

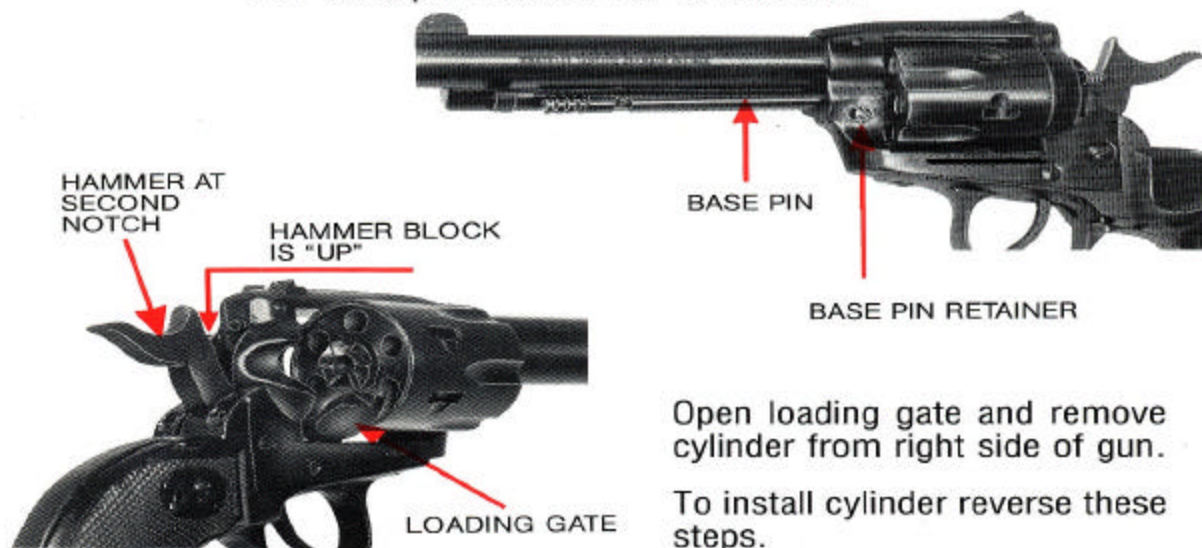

Open loading gate and remove cylinder from right side of gun.

To install cylinder reverse these steps.

**Before loading,** test base pin by pulling it forward without pressing base pin retainer. If installed correctly you should not be able to pull it out.

**Never remove or install a loaded cylinder. If dropped or struck a blow the cartridges can fire.**

EVERY CYLINDER IS HAND FITTED AND TIMED TO THE REVOLVER IT COMES WITH. BOTH COMBO CYLINDERS HAVE BEEN HAND FITTED TO YOUR GUN. IF YOU BUY A NEW CYLINDER OR WANT TO ADD A .22 MAGNUM CYLINDER TO THE SINGLE CYLINDER IT MUST BE FITTED AND TIMED BY A COMPETENT GUNSMITH TO ENSURE PROPER CYLINDERS-BARREL ALIGNMENT. IMPROPER USE OR ABUSE CAN CAUSE EXCESSIVE WEAR AND IMPROPER ALIGNMENT. SEE INSTRUCTIONS, SECTION 3.

## **WARNINGS**

### **READ THIS AND BE A SAFE SHOOTER**

Never leave a gun where it could fall and fire.

Check ammo to be sure it is right size and caliber.

Old or reloaded ammo may be dangerous. We recommend against using it.

Spectators should be 10 feet behind and away from the shooter while loading, firing and unloading.

Load the gun only when on the range preparing to fire, and unload it before leaving the range.

Never carry any handgun in your pocket, purse or tucked in a belt or waistband. Use a pistol case or a proper holster with safety flap or strap.

Don't try to change your gun's trigger pull, because alterations of trigger pull usually affect sear engagement and may cause accidental firing.

If you do drop your gun, unload it and check it for proper function before using it again.

Always wear fluorescent orange vest, hat or jacket when in the woods or fields.

Check all chambers in cylinder after firing, to make sure that all cartridges have fired.

Never "HORSEPLAY" with a revolver. Quick draw and hammer "fanning" are dangerous for you and abusive for your gun.

Many ammunition identifications sound similar. Make sure you do not use wrong size ammo in your revolver.

Write to us concerning any items or circumstances which you don't understand and which might relate to your safety and the operation of any of our products.



**E.A.A. 4480 EAST 11<sup>th</sup> AVE  
HIALEAH, FL. 33013**

## WARNINGS

### READ THIS AND BE A SAFE SHOOTER

Never point a gun at any person or thing you don't intend to shoot.

Treat every gun as if it is loaded... all the time.

Get instructions from a competent firearms instructor before using any gun.

Never rely on a gun's "safety" to protect you from unsafe gun handling. A safety is only a mechanical device, not a substitute for common sense.

Keep your finger off the trigger until you are actually aiming at the target ready to shoot.

Be certain the gun is unloaded before cleaning.

Always empty guns before entering a house, car, truck, boat, RV, camp or any building.

Never leave a loaded gun unattended.

Store guns and ammunition separately beyond the reach of children.

Don't "test the safety" by pulling the trigger while the safety is on.

Be sure of your target and backstop before you shoot. Ask yourself what your bullet will hit if it misses the target.

Be sure the barrel is clear of obstruction before shooting.

Guns and alcohol or drugs don't mix. Don't take them before or during shooting activities.

Never pull a gun towards you by the muzzle. Don't climb a tree or cross a fence or ditch with a loaded gun.

Load and unload with the muzzle pointed in a safe direction.

If a gun fails to fire when trigger is pulled, keep it pointed at target for at least 30 seconds. Sometimes slow primer ignition will cause a "hang fire" and the cartridge will go off after a short pause.

Never shoot at hard flat surfaces or water... bullets will ricochet.

When receiving a gun always open the action and check that it's unloaded.

Never put your hand over the muzzle of a gun.



## **HOME GUN SAFETY IS PROBABLY YOUR BIGGEST CONCERN.**

Hoppe's Gun Guardian is a good inexpensive gun lock kit. It works on any firearm (rifle, pistol or shotgun) or airgun, yet is instantly removable by an adult.

Hoppe's Gun Guardian kits are available in gun shops and sporting goods departments, or from Hoppe's, Airport Industrial Mall, Coatesville, PA. 19320. EAA has tested them and we recommend them. After all, you have invested this much in your new gun. Now invest a little more in your children's safety.

**THIS REVOLVER WAS TEST FIRED AND INSPECTED BY THE ITALIAN NATIONAL PROOF BANK IN: 25063 GARDONE V.T. (BS) ITALY**

### **LIFETIME LIMITED WARRANTY**

All EAA guns are warranted to the original retail customer for life from date of original purchase against defects in material and or workmanship. All parts and labor or replacement (at our option) are covered. YOU must send your Factory Registration Card to obtain warranty coverage.

Transportation to and from our repair facilities, damage caused by failure to perform normal maintenance, sales outside the United States, damage due to the use of high velocity, high pressure, reloaded or other nonstandard ammunition, or any unauthorized repair, modification, misuse, abuse, including abuse by "fanning" the hammer, or alteration of the product is not covered by this Limited Warranty. Any implied warranties, including the implied warranties of merchantability and fitness for a particular purpose, are limited to one year from date of original retail purchase. Consequential or incidental damages or expenses, or any other expenses are not covered by this warranty.

To obtain warranty performance send your product with proof of retail purchase, freight prepaid, to:

**European American Armory Corp.  
4480 EAST 11<sup>th</sup> AVE.  
Hialeah, FL. 33013.**

### **YOUR OWNERS'S MANUAL**

This manual contains important warnings which must be understood **BEFORE** using this firearm. Always keep it with the firearm.

When you lend, give or sell the firearm, be sure the manual goes with it. You can get a copy of this manual from EAA on request.

## EXPLODED VIEW DRAWING

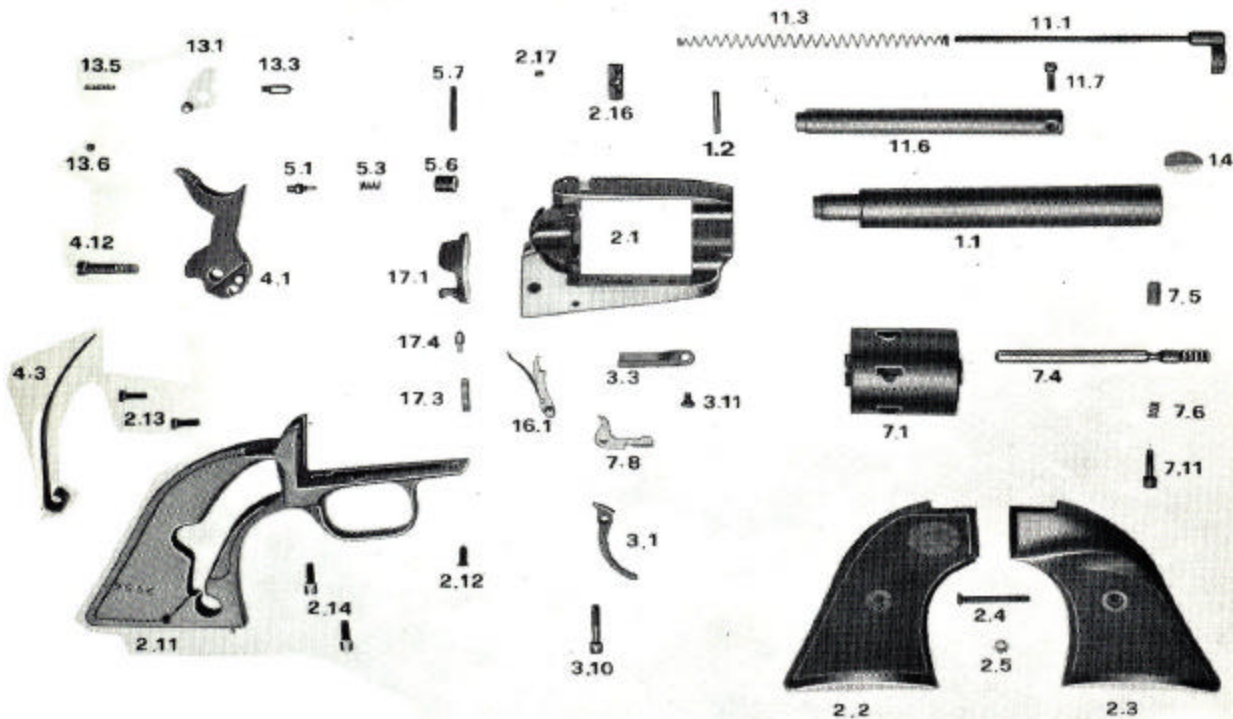

## PARTS LIST

1.1 Barrel	3.1 Trigger	7.6 Base pin lock spring
1.2 Barrel pin	3.3 Trigger spring	7.8 Bolt
1.4 Front sight	3.10 Bolt and trigger screw	7.11 Base pin lock screw
2.1 Frame	3.11 Bolt and trigger spring screw	11.1 Ejector
2.2 Right grip	4.1 Hammer	11.3 Ejector spring
2.3 Left grip	4.3 Mainspring	11.6 Ejector tube
2.4 Grip screw	4.12 Hammer screw	11.7 Ejector screw
2.5 Grip nut	5.1 Firing pin	13.1 Manual safety
2.11 Backstrap	5.3 Firing pin spring	13.3 Safety screw
2.12 Backstrap front screw	5.6 Recoil plate	13.5 Safety plunger spring
2.13 Backstrap top screws	5.7 Recoil plate pin	13.6 Safety plunger
2.14 Backstrap bottom screws	7.1 Cylinder	16.1 Hand
2.16 Rear sight	7.4 Base pin	17.1 Gate
2.17 Rear sight screw	7.5 Base pin lock nut	17.3 Gate detent spring
		17.4 Gate detent

## WARNING

THIS GUN WAS MANUFACTURED TO PERFORM PROPERLY WITH THE ORIGINAL PARTS AS DESIGNED. IT IS YOUR DUTY TO MAKE SURE ANY PARTS YOU BUY ARE INSTALLED CORRECTLY AND THAT NEITHER REPLACEMENTS NOR ORIGINALS ARE ALTERED OR CHANGED. YOUR GUN IS A COMPLEX TOOL WITH MANY PARTS THAT MUST RELATE CORRECTLY TO OTHER PARTS. PUTTING A GUN TOGETHER WRONG OR WITH MODIFIED PARTS CAN RESULT IN A DAMAGED GUN, DANGER, AND INJURY OR DEATH TO YOU AND OTHERS THROUGH MALFUNCTION. ALWAYS LET A QUALIFIED GUNSMITH WORK ON YOUR GUN OR AT LEAST CHECK ANY WORK NOT PERFORMED BY A GUNSMITH. WE AT EAA THINK IS A SMALL PRICE TO PAY FOR FIREARMS SAFETY.