

Model - 105 .177

Model - 106 .22

# CROSMAN

## "BULLSEYE"

### PISTOL

"POWER WITHOUT POWDER"

## INSTRUCTIONS

### AND

## PARTS LIST

CROSMAN ARMS CO., Inc.

FAIRPORT, N. Y.

#### Valve Testing Procedure

If your pistol fails to hold compression test as follows: cock pistol by pulling back bolt till it clicks, push bolt in and lock. Pump six strokes and insert muzzle end in a container of water. If no bubbles appear the exhaust valve is functioning properly.

Test for check valve: open pump lever until plunger cup is behind air vent hole. Without moving pump lever apply moistened finger to air vent hole. If no bubbles appear check valve is functioning properly.

#### To Clean or Replace Valves

1. Remove Tenite grip No. 45; two screws No. 46.
2. Remove frame No. 21; screws No. 20, 24.
3. Removal of frame will release safety spring No. 35 and ball No. 40. Do not lose these parts.
4. Remove hammer spring stop No. 11; two screws.
5. Remove spring No. 12 and hammer No. 13.
6. Remove cocking screw No. 10 from bolt No. 9.
7. Remove bolt No. 9. Removal of bolt will release bolt spring No. 8 and two spring balls No. 7. Do not lose these parts.
8. Remove front sight screw No. 38 and pin No. 32; front sight No. 30-31 and pump assembly.
9. Hold pump tube No. 22 by putting 3/16" round rod thru front sight pin holes in pump tube. DO NOT clamp barrel or breech in vise. Remove exhaust valve nut No. 14 by turning to left with special Crosman body nut wrench.
10. To push out exhaust valve No. 15, 16, 17, spring No. 18 and check valve No. 19, insert 3/16" round rod in muzzle end of pump tube and push thru small hole in center of compression chamber.
11. Wrap soft cloth around small wood stick and clean chamber. Never use a metal rod or you will damage check valve seat. Wipe off valves.
12. Drop in check valve and spring then insert body complete with gasket and exhaust valve. Push in and line up blind hole with hole in tube. Insert 5/32" rod while tightening lock nut. Hold tube thru front sight holes with 3/16" rod.
13. Replace bolt with spring and balls. Screw in cocking screw.
14. Drop in hammer; drop in hammer spring.
15. Push in hammer stop and replace screws.
16. Install pump mechanism, front sight, pin and screw.
17. Replace frame and pistol grip.

#### To Replace Pump Cup

1. Remove front sight screw No. 38 and front sight pin No. 32.
2. Pull out front sight No. 30-31, and pump assembly.
3. Loosen set screw in pump guide No. 49.
4. Unscrew pump rod No. 41 from pump guide No. 49.
5. Unscrew hex nut No. 53 from rod No. 41.
6. Unscrew oil felt retainer No. 52 from rod.
7. Remove compression head washer No. 44 from rod.
8. Remove old cup No. 43 and replace with new cup.
9. Replace compression head washer.
10. Screw on felt retainer moderately tight while holding on pump rod.
11. Lock assembly with hex nut.
12. Screw assembly in pump guide.
13. Insert and adjust pump to obtain maximum air intake.
14. Replace front sight, pin and screw.

#### Lubrication

For lubricating purposes use only Crosman "Lubro 90" a special lubricant developed by our engineers. Remit 25c in stamps for a large tube. In an emergency if Crosman "Lubro 90" is not available, use a superior grade light oil. Do not lubricate pistol excessively as oil collects dust and grit.

#### To Remove Pells From Plugged Barrel

If for any reason a pellet or pellets become jammed in the barrel, insert a 5/32" flat end round rod at muzzle end and gently tap out pellets. DO NOT ATTEMPT TO REMOVE PELLETS BY MELTING OUT OF BARREL.

## Component Parts of Crosman "Bullseye" Pistol

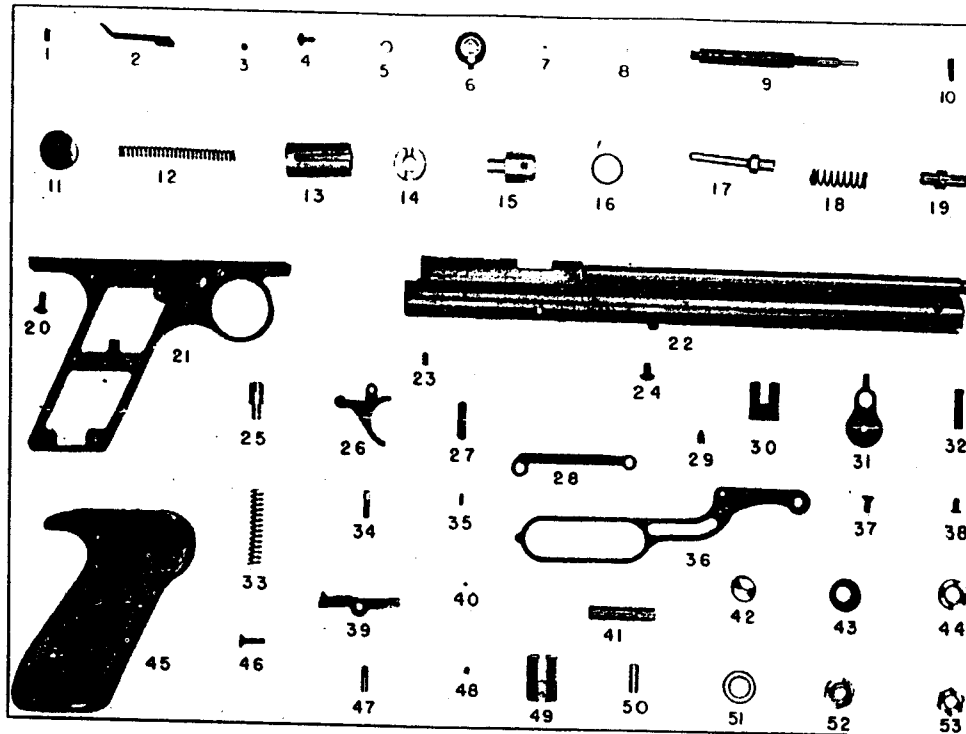

Part No.	Price	Part No.	Price
1. Rear Sight Elevating Screw	\$ .05	27. Safety	.50
2. Rear Sight	.50	28. Pump Lever Link	.40
3. Rear Sight Lock Screw	.05	29. Pump Lever Rivet	.10
4. Breech Bolt Lock Screw	.10	30. Front Sight Guide	1.60
5. Spring Washer	.05	31. Front Sight Blade	.25
6. Breech Bolt Lock	.25	32. Front Sight Pin	.20
7. Breech Bolt Spring Ball	.05	33. Sear Spring	.10
8. Breech Bolt Spring	.10	34. Trigger Pin	.10
9. Breech Bolt	.80	35. Safety Spring	.10
10. Cocking Screw	.10	36. Pump Lever	1.80
11. Hammer Spring Stop	.50	37. Front Sight Blade Screw	.05
12. Hammer Spring	.25	38. Front Sight Pin Screw	.10
13. Hammer	.60	39. Sear Lever	.50
14. Valve Nut	.25	40. Safety Spring Ball	.05
15. Exhaust Valve Body	1.00	41. Pump Adjusting Rod	.40
16. Exhaust Valve Gasket	.05	42. Compression Head	.30
17. Exhaust Valve Stem	1.00	43. Pump Cup	.25
18. Check Valve Spring	.15	44. Compression Head Washer	.15
19. Check Valve	1.00	45. Plastic Grip (Tenite)	5.00
20. Frame Rear Screw	.05	46. Grip Screw	.10
21. Pistol Frame	3.00	47. Sear Pin	.05
★ 22. Breech Barrel and Pump Tube Assembly, 8.50; Barrel	2.00	48. Pump Lock Screw	.05
23. Hammer Lock Screw	.05	49. Pump Guide	.60
24. Frame Front Screw	.05	50. Pump Guide Pin	.10
25. Sear Spring Head	.35	51. Lubricating Felt	.10
26. Trigger	.50	52. Felt Retainer	.40
		53. Pump Lock Nut	.05

★ Must be Replaced at Factory