

SHARPS Sporting Rifle

Care and Loading Instructions

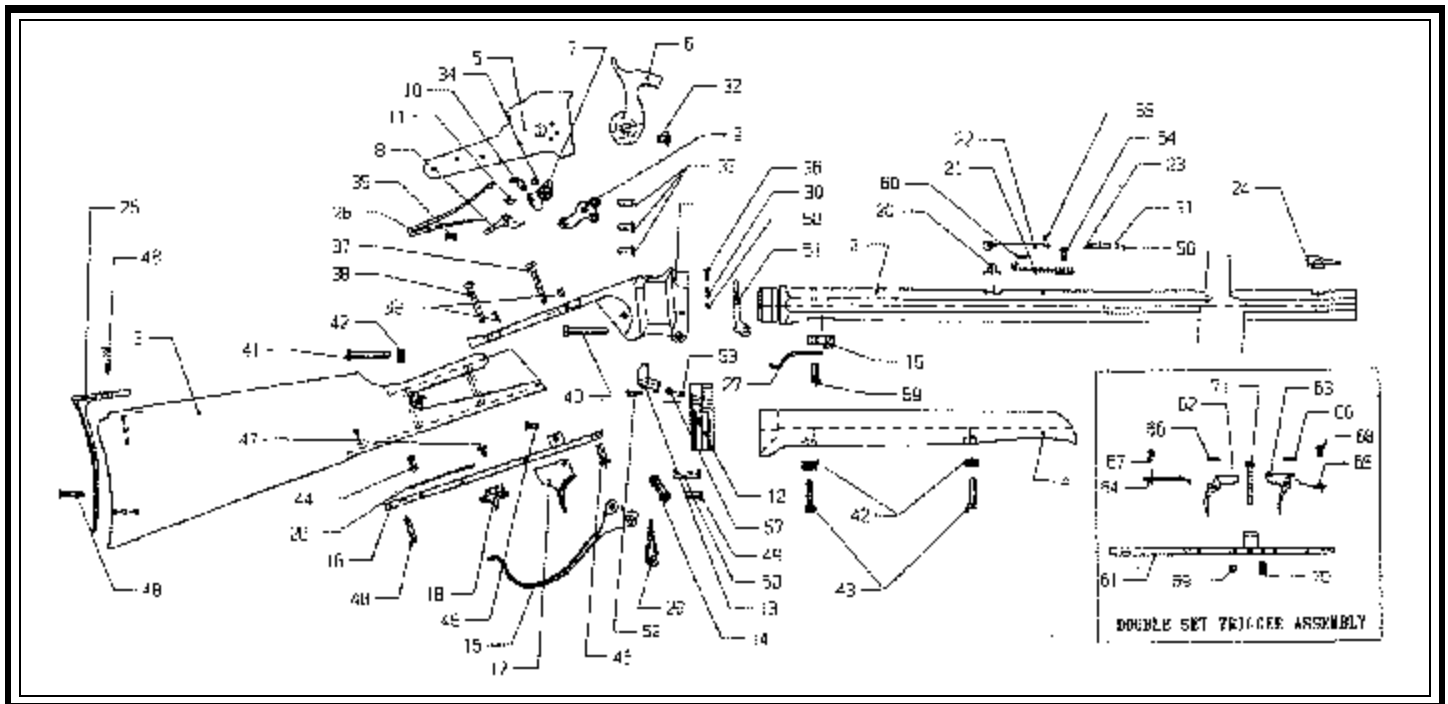

1	ARMI1	Frame	31	ARMI31	Rear Sight Slide Spring	54	ARMI54	Rear Sight Spring
2	ARMI2	Barrel	32	ARMI32	Hammer Screw			Screw
3	ARMI3	Stock	33	ARMI33	Tumbler Screw	55	ARMI55	Rear Sight Slide
4	ARMI4	Forend	34	ARMI34	Stirrup Screw			Retainer Screw
5	ARMI5	Side Plate	35	ARMI35	Main Spring Retainer	56	ARMI56	Friction Ball (Rear Sight
6	ARMI6	Hammer		Screw				Slide)
7	ARMI7	Tumbler	36	ARMI36	Lever Pin Plunger	57	ARMI57	Firing Pin
8	ARMI8	Sear		Screw		58	ARMI58	Lever Pin Plunger
9	ARMI9	Bridle	37	ARMI37	Front Tang Screw	59	ARMI59	Lever Action Spring
10	ARMI10	Stirrup	38	ARMI38	Rear Tang Screw			Screw
11	ARMI11	Fly	39	ARMI39	Creedmore Sight Base	60	ARMI60	R. Sight Leaf Pin To
12	ARMI12	Breech Block		Holes				Right Sight Spring
13	ARMI13	Firing Pin Pusher	40	ARMI40	Side Plate Front Screw	61	ARMI61	Double Set Trigger
14	ARMI14	Link	41	ARMI41	Side Plate Rear Screw			Guard Plate
15	ARMI15	Lever	42	ARMI42	Side Plate Screw	62	ARMI62	Rear Trigger
16	ARMI16	Trigger Guard Plate		Washer		63	ARMI63	Front Trigger
17	ARMI17	Trigger	43	ARMI43	Forend Screw	64	ARMI64	Rear Trigger Spring
18	ARMI18	Trigger Lock	44	ARMI44	Trigger Lock Spring	65	ARMI65	Front Trigger Spring
19	ARMI19	Barrel Lug		Screw		66	ARMI66	Trigger Pin
20	ARMI20	Rear Sight Base	45	ARMI45	Trigger Screw	67	ARMI67	Rear Trigger Spring
21	ARMI21	Rear Sight Spring	46	ARMI46	Front Guard Screw			Screw
22	ARMI22	Rear Sight Leaf	47	ARMI47	Trigger Lock Screw	68	ARMI68	Front Trigger Spring
23	ARMI23	Rear Sight Slide	48	ARMI48	Rear Guard Screw/Butt			Screw
24	ARMI24	Front Sight		Plate		69	ARMI69	Rear Trigger Regulating
25	ARMI25	Butt Plate	49	ARMI49	Link To Lever Screw			Screw
26	ARMI26	Main Spring	50	ARMI50	Link To Breech Block	70	ARMI70	Regulating Screw
27	ARMI27	Lever Spring		Screw		71	ARMI71	Front Tang Screw
28	ARMI28	Trigger Lock Spring	51	ARMI51	Extractor			
29	ARMI29	Receiver Lever Pin	52	ARMI52	Firing Pin Screw			
30	ARMI30	Lever Pin Plunger	53	ARMI53	Firing Pin Spring			
		Spring						

INITIAL CARE AND CLEANING

1. Before handling this or any other firearm, always make sure the firearm is unloaded and pointed in a safe direction.
2. Using a quality gun solvent, remove all excess factory lubricant. Field stripping the firearm will facilitate this process. (See Field Stripping). Relubricate all moving contact points with a quality “spray type” gun lubricant.
3. Thoroughly clean the bore, and remove all excess solvent with clean, dry patches, replacing them as often as necessary until they come out clean and dry.
 - a. A slight film of gun oil should be left in the barrel during long periods of storage, however, the cleaning procedure **MUST** be repeated before shooting the firearm. **The barrel must always be clean and dry before shooting.**

FIELD STRIPPING

1. After making sure the gun is unloaded, and with the muzzle pointed in a safe direction, field strip the gun.
 - a. With the action **CLOSED**, place the hammer in the half-cock position. You will notice a tiny plunger pin located on the right side of the frame.
 - b. The lever hinge pin is located on the lower front of the frame on the right hand side of the rifle. While pushing in on the tiny plunger pin, rotate the arm of the lever hinge pin forward past the plunger pin, approximately 180 degrees from its original position. Turn the rifle upside down. While rotating forward and backward a few degrees, and pulling outward, remove the lever hinge pin. After the lever hinge pin has been removed, slide the lever and the breech block up and out of the rifle.
 - c. You have now field stripped the rifle. Further disassembly should be attempted only by a competent gunsmith.
 - d. Reverse the above procedure for reassembly.

SAFETY

1. We strongly recommend you practice the procedure of placing the rifle on safe **before** attempting to load and fire the rifle.
2. To place the rifle on safe, slowly drop the hammer to the half-cock position. We strongly recommend not loading the rifle until you are in the hunting field, or on the target range and you are ready to shoot safely.

LOADING AND FIRING

1. Use only factory loaded ammunition, or black powder hand loaded. Ammunition used should not exceed 25,000 c.u.p.
2. To load the rifle, first point the muzzle downrange in a safe direction. Place the rifle on safe, by placing the hammer in the half-cock position. Extend the lever downward, fully opening the breech. Carefully insert one cartridge of correct caliber completely into the breech and close the action. You are now ready to fire the rifle.
3. To fire, point the rifle downrange toward your target and fully cock the hammer. While pointing at your target, slowly pull on the rear trigger until it sets. While aiming at your target, slowly squeeze the front trigger and your rifle will fire.
 - a. If your rifle is equipped with an adjustable set trigger assembly. Screw the trigger adjusting screw inward or outward until the desired trigger pressure is obtained. Always adjust the set triggers with an unloaded rifle !!! Use an empty case in the chamber when setting, so the firing pin has something to contact when pulling the trigger. If more than 5 shots are required to set the triggers, use a different empty case.

SIGHTING

1. Your Sharps Rifle is equipped with an adjustable rear sight with a provision for windage and elevation. Sighting adjustments should be made with the front sight, which, for the models provided with dove tail, is adjustable for windage. With a brass hammer, the front sight can be moved left or right, depending on which direction your rifle happens to be shooting. Move the front sight in the direction you are shooting. If you are shooting to the left, move your front sight left; if it shoots right, move the front sight right.