

# OWNER'S MANUAL

# Charles Daly

## Installation, Operating and Assembly Instruction Manual

### Charles Daly Gas Operated Autoloading Shotgun

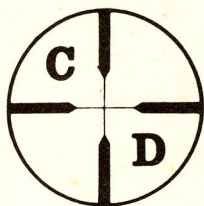

**IMPORTANT: PLEASE READ THIS OWNER'S MANUAL TO INSURE BEST PERFORMANCE.**

#### PART NAME AND LOCATION

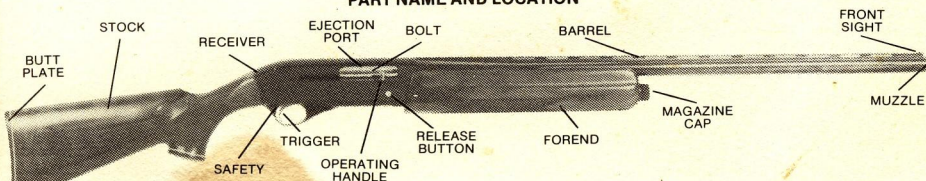

FIGURE 1

## OPERATING INSTRUCTIONS



Failure to obey a safety warning may result in injury to you or to others.



### ALWAYS KEEP THE MUZZLE POINTED IN A SAFE DIRECTION

Prior to using live ammunition, familiarize yourself thoroughly with these operating instructions, referring to **FIGURE 1**. Get accustomed to the feel of your new shotgun — know the forces required to operate the action, to pull the trigger and above all, **KNOW THE LOCATION OF THE SAFETY** which, on this firearm, is located at the rear of the trigger guard. The safety is “**ON SAFE**” when pushed from left to right covering the red band. When the safety is “**OFF SAFE**,” the red band will be visible on left side and trigger can be pulled.

#### TO ASSEMBLE

1. Push safety to the “**ON SAFE**” position. Insert operating handle in hole in bolt. Pull operating handle to rear locking the bolt in the open position.

**CAUTION:** To prevent damage or injury **DO NOT** depress release button with barrel or forend removed. Unscrew magazine cap and remove forend.

2. Grip barrel forward of barrel lug/gas chamber. Align the breech end of the barrel with the opening in the front of the receiver. At the same time align the hole in the barrel lug/gas chamber with the end of the magazine tube. Push barrel into receiver until barrel is fully seated with notch at rear end of barrel engaged with locator in receiver.
3. Replace forend over magazine tube. Replace magazine cap and turn cap until barrel and forend are tightly assembled in place.

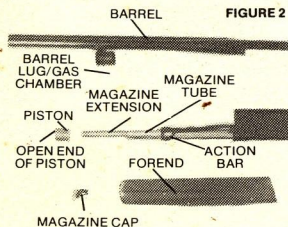

#### TO TAKE DOWN



### MAKE SURE THE GUN IS NOT LOADED

Barrel may be removed or interchangeable barrel assembled *without adjustment*.

#### TO REMOVE BARREL

Push safety “**ON SAFE**”. With hands and fingers clear of bolt and operating handle, push release button on right side of receiver to close action. Unscrew magazine cap, remove forend. Grip barrel firmly and pull barrel forward and away from gun.

#### TO LOAD



Clean inside of the barrel and chamber to remove all grease and other possible obstructions before firing your shotgun.



Push safety “**ON SAFE**.” Point muzzle in a safe direction.

**CHARLES DALY  
GAS OPERATED  
AUTOLOADING SHOTGUN  
12 GAUGE**

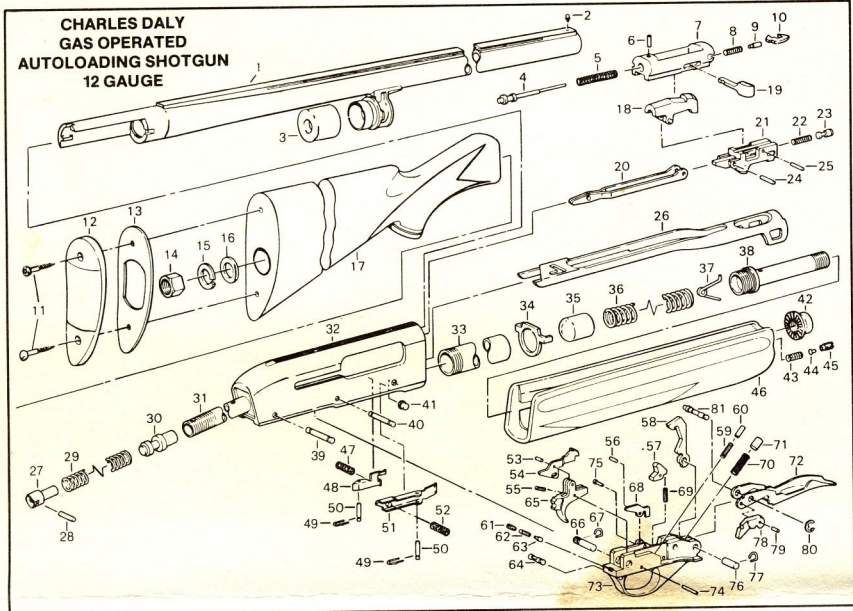

**WHEN ORDERING PARTS, IT IS NECESSARY TO SPECIFY MODEL NUMBER SERIES, CALIBER AND SERIAL NUMBER.**

Key No. CDP-Part No.	Part Name	Key No. CDP-Part No.	Part Name	Key No. CDP-Part No.	Part Name
1	CDA-50-1J Barrel Assembly	28	CDP-50-461 Action Spring Plug Pin	55	CDP-50-284 Trigger Spring
2	CDP-50-218 Front Sight	29	CDP-50-463 Action Spring	56	CDP-50-308 Release Lever Pin
3	CDP-50-445 Piston	30	CDP-50-464 Action Spring Follower	57	CDP-50-205 Sear
4	CDP-50-77 Firing Pin	31	CDP-50-447 Action Spring Tube	58	CDP-50-107 Hammer
5	CDP-50-83 Firing Pin Spring	32	CDP-50-2J Receiver	59	CDP-50-305 Lifter Pawl Spring
6	CDP-50-349 Firing Pin - Stop Pin	33	CDP-50-355 Magazine Tube	60	CDP-50-351 Lifter Pawl Plunger
7	CDP-50-25J Breech Bolt Assembly 12 Ga.	34	CDP-50-80 Forend Support	61	CDP-50-380 Safety Plunger Screw
8	CDP-50-68 Firing Pin - Stop Pin	35	CDP-50-143 Magazine Follower	62	CDP-50-381 Safety Plunger Spring
9	CDP-50-67 Extractor Plunger	36	CDP-50-156 Magazine Follower Spring	63	CDP-50-197 Safety Plunger
10	CDP-50-59 Extractor	37	CDP-50-567 Magazine Extension Retaining	65	CDP-50-192 Safety Trigger
11	CDP-50-32 Butt Plate Screw (2)	38	CDP-50-490 Magazine Tube Extension	65	CDP-50-192 Safety Trigger
12	CDP-50-5 Butt Plate	39	CDP-50-786 Trigger Guard Pin Rear	66	CDP-50-279 Trigger Guard Pin Bushing Rear
13	CDP-50-616 Butt Plate Liner	40	CDP-50-787 Trigger Guard Pin Front	67	CDP-50-782 Trigger Guard Pin Retaining Rear
14	CDP-50-623 Stock Retaining Nut	41	CDP-50-471 Release Button	68	CDP-50-184 Release Lever
15	CDP-50-256 Stock Bolt Lock Washer	42	CDP-50-475 Magazine Cap	69	CDP-50-209 Sear Spring
16	CDP-50-253 Stock Bolt Washer	43	CDP-50-478 Magazine Cap Stop Spring	70	CDP-50-166 Mainspring
17	CDP-50-3 Stock Assembly	44	CDP-50-477 Magazine Cap Stop Plunger	71	CDP-50-167 Mainspring Plunger
18	CDP-50-134 Locking Bolt	45	CDP-50-476 Magazine Cap Stop	72	CDP-50-121 Lifter
19	CDP-50-360 Operating Handle	46	CDP-50-4J Forend	73	CDP-50-99 Trigger Guard
20	CDP-50-449 Link Assembly	47	CDP-50-33 Cartridge Stop Spring	74	CDP-50-285 Trigger Pin
21	CDP-50-363 Slide	48	CDP-50-301 Cartridge Stop	75	CDP-50-206 Sear Pin
22	CDP-50-404 Operating Handle Plunger Spring	49	CDP-50-500 Retaining Spring, small	76	CDP-50-424 Hammer Bushing
23	CDP-50-403 Operating Handle Plunger	50	CDP-50-394 Cartridge Stop Pin	77	CDP-50-783 Trigger Guard Pin Retaining Front
24	CDP-50-450 Link Pin	51	CDP-50-469 Lifter Latch	78	CDP-50-127 Lifter Pawl
25	CDP-50-303 Operating Handle Plunger Pin	52	CDP-50-470 Lifter Latch Spring	79	CDP-50-128 Lifter Pawl Pin
26	CDP-50-443 Action Bar	53	CDP-50-538 Sear Trip Pin	80	CDP-50-568 Lifter Pin Retainer
27	CDP-50-460 Action Spring Plug	54	CDP-50-537 Sear Trip	81	CDP-50-129 Lifter Pin
					CDP-50-151 Owners Manual



**Outdoor Sports Headquarters, Inc.**  
**Post Office Box 1327, Dayton, Ohio 45401**

## USE THE CORRECT AMMUNITION AS IDENTIFIED ON THE BARREL

1. To Load Chamber — Open action Drop shell through ejection port onto lifter.

FIGURE 3

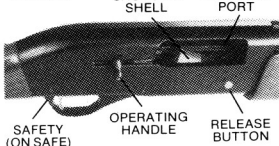

**CAUTION:** To prevent damage or injury, make certain the shell is laying in the proper position on the lifter before performing the next instruction. See Figure 3.

2. With hands and fingers clear of bolt and operating handle, push release button on right side of receiver to close action.
3. To load magazine — Action must be closed. While pushing release button, push shell against lifter then forward *FULLY* into magazine. Make sure that rim of shell snaps past cartridge stop to avoid

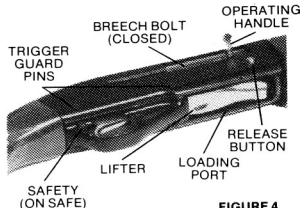

FIGURE 4

shell sliding back over lifter. If this should happen the action may be cleared by manually operating the bolt with the operating handle and releasing. If the chamber is loaded, the shell in the chamber will be ejected. After clearing action, finish loading magazine. Magazine holds a maximum of 3 shells.

4. To load chamber from magazine — Shells can be fed from loaded magazine by pulling operating handle fully rearward and releasing.

### TO FIRE



1. With muzzle pointed in a safe direction, push safety from right side of trigger guard. Red band will be visible on left side of trigger guard.

2. When on target, place finger on trigger and pull each time you wish to fire. Trigger must be released and pulled for each shot. Gun will reload chamber after firing until magazine is empty.



3. Action will remain *OPEN* when the last shell is fired. If the action is *CLOSED*, the gun should be considered *LOADED*.



4. Immediately put safety "ON SAFE" when through firing.

### TO UNLOAD WITHOUT FIRING



1. Always point muzzle in a safe direction and make sure safety is "ON SAFE."
2. Pull operating handle rearward to open action and eject live shell in chamber; repeat operation until magazine and chamber are empty.
3. Visually inspect chamber and magazine to be sure both the chamber and magazine have no live shells present.



**NEVER STORE A LOADED GUN**

# TEN COMMANDMENTS OF FIREARMS SAFETY

A good hunter is a safe hunter. He knows there is no place for horseplay in hunting. He learns and obeys the commandments of firearms safety and insists that his companions know and follow them, too.

Every hunter — whether novice or experienced outdoorsman — should review these commandments before each hunting season to be sure that his gun handling, both at home and in the field, sets a good example for others.

1. Don't rely on your gun's safety. Treat every gun as if it were loaded and ready to fire.

2. Don't shoot unless absolutely sure of your target and what is beyond it.
3. Always be sure the barrel is clear of obstructions. Only carry ammunition of the proper size for the gun you are using.
4. Never point your gun at anything you do not want to shoot. Watch your muzzle so the other person doesn't have to.
5. Never leave your gun unattended unless you unload it first.
6. Avoid alcoholic beverages both before and during shooting.

7. Never carry a loaded gun when you climb a tree, cross a fence, jump a ditch or go through areas where you are apt to slip or trip.
8. Never shoot at a hard, flat surface or the surface of water. Make sure you have a safe backstop.
9. Carry only empty guns, taken down or with the action open, into your camp, car or home.
10. Store guns and ammunition separately, beyond the reach of children.

## CLEANING INSTRUCTIONS



**MAKE SURE GUN IS NOT LOADED**

**BARREL CLEANING** (Fig. 1) — Push safety "ON SAFE." Close action. Unscrew magazine cap and remove forward. Remove barrel. Replace magazine cap to magazine tube. Clean barrel with cleaning rod and lightly oiled soft cloth. Scrub bore with powder solvent, if necessary, and wipe clean. Re-oil very lightly.

**ACTION CLEANING** — An evaporating solvent should be used. Take necessary precautions. Action mechanisms remain clean much longer after shooting if lubrication is used sparingly.

**DISASSEMBLY OF GUN** — For cleaning or service of *ACTION* and *GAS MECHANISM* and reassembly should be done as follows:

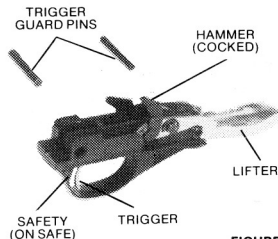

FIGURE 5

**Trigger Guard Assembly (Fig. 5)** — Push safety "ON SAFE". Close action. Push out front and rear trigger guard pins from either end. Remove trigger guard assembly from receiver. Inspect and brush clean whenever necessary. Clean as a unit. **NOTE:** Do not allow cocked hammer to snap forward with trigger guard assembly, breech bolt, or barrel removed from receiver of gun.

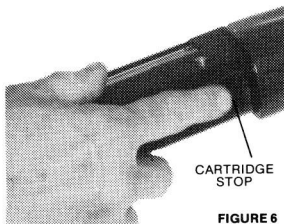
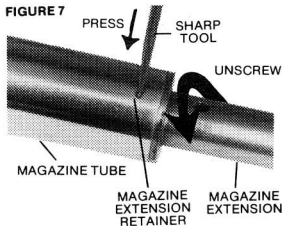

FIGURE 6

**Breech Bolt Assembly - Gas**

**Mechanism** — Parts (Fig. 6). Push Safety "ON SAFE". Close action. Unscrew magazine cap. Remove forend and barrel. Pull out operating handle. (**NOTE:** Reassemble in proper location through bolt and into slide block slot.) Remove piston from magazine tube extension. Reach into lifter opening from beneath receiver and depress cartridge stop in receiver. Pull action bar assembly and breech bolt from receiver and magazine tube. Lift breech bolt (and attached locking block) from rear of bar. **NOTE:** Cartridge stop must be pressed again to allow re-entry of action bar assembly and breech bolt into receiver. When reassembling, make

FIGURE 7



certain link enters action spring follower and piston is in correct assembly position, with open end facing muzzle.

FIGURE 8

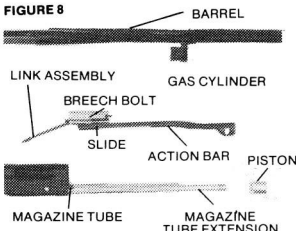

Remove magazine tube extension by pressing retainer with small pointed tool or paper clip while unscrewing extension. (**CAUTION:** Magazine tube extension is under pressure from follow spring).

Remove follower and spring and clean, wipe inside of magazine tube with cloth and solvent using cleaning rod. When cleaning, brush or scrape to remove residue, if necessary. Wipe all parts clean, including gas cylinder attached to barrel and magazine tube. **Important:** After cleaning gas mechanism parts — wipe Clean and Dry. Use as little oil as possible. Gas mechanism parts include gas cylinder on barrel, piston, magazine tube extension, outer surface of magazine tube and action bar.

When reassembling do not attempt to force the magazine extension retainer past the rim of the magazine tube. When this point is reached, depress the magazine extension retainer so that you can continue to screw the extension into the magazine tube without forcing. Make sure that magazine tube extension retainer locks into hole in magazine tube.

The outside of your gun should be wiped with oil to prevent rust. Invisible "prints" of moisture can cause rusting unless removed. Exposure to unfavorable weather or moisture from condensation also requires additional care. **REMEMBER — RUST IS NEGLECT.**

**BELOW FREEZING WEATHER** — Special attention should be taken that oil is removed from action parts. If a lubricant is desired — use dry graphite or similar non-congealing lubricant. Take care also to prevent rusting from condensation and wetness (cold weather to warm room temperature) on action parts and barrel bore, barrel chamber.

**MAINTENANCE:** Gun should be checked periodically by a competent gunsmith to ensure proper operation and any necessary replacement of worn or damaged parts.

**TO INSTALL OR REMOVE MAGAZINE CAPACITY PLUG:** Lock action open and make sure chamber and magazine are unloaded.



**CAUTION:** To prevent damage or injury, do not press release button with barrel removed.

Remove forend, barrel, piston and magazine tube extension per previous instructions. Install or remove magazine capacity plug. When installing, make sure that the magazine extension retainer spring is inserted in the groove provided in the magazine capacity plug. Reassemble per previous instructions.

**Instructions for Returning Complete Firearms for Service.**

If service is required, your complete firearm may be sent to the following address:

**Outdoor Sports Headquarters, Inc.**  
2290 Arbor Blvd.  
Dayton, Ohio 45439



**MAKE SURE CHAMBER AND MAGAZINE ARE UNLOADED**

**NOTE: DO NOT** send scopes, slings or gun cases with your firearms.



**Charles Daly**

Distributed Exclusively by:

**Outdoor Sports Headquarters, Inc.**

**Post Office Box 1327, Dayton, Ohio 45401**