

SAVE THIS BOOKLET

BROWNING®



Operation and Care of

T-BOLT .22 Caliber
Bolt Action Rifle

VERY IMPORTANT

These instructions should be carefully noted

BROWNING ARMS CO.

1706 Washington Avenue — St. Louis, Missouri 63103

8350 Mountain Sightz Avenue — Montreal 9, Quebec, Canada

BROWNING



We are pleased that you have chosen the Browning T-Bolt .22. Your rifle is of an entirely new design and we feel sure you will find it unusually accurate, pleasant and easy to operate, and extremely safe to shoot and handle. In its manufacture we have endeavored to incorporate the very finest in materials and craftsmanship, and with just reasonable care this rifle should provide you with many years of dependable service.

If, by any chance, you have any observations to make regarding its performance or appearance, we hope you will write us immediately; your new Browning must be flawless.

We would also like to know more about you as a Browning owner and would appreciate your taking a moment to complete and return the card found on the inside back cover which also serves as your registration of this rifle with our Company.

Thank you.

BROWNING ARMS COMPANY

BROWNING Gun Owner's Personal Record

Keep This Record For Future Reference

Browning Model.....Serial Number.....

Purchase Price.....Date of Purchase.....

Purchased From.....

Please fill out and mail the card at the rear of this booklet.

Your new rifle has been carefully examined, targeted and proofed before leaving the factory. It need only have the light film of rust preventative compound wiped from the barrel bore, breech bolt and all external metal surfaces and it is ready to shoot. Browning Gun Oil or a similar product will serve nicely for this purpose.

Although disassembly is rarely necessary, the simple steps involved are described below as well as those required for reassembly. They will familiarize you with the various parts of the rifle.

The Browning T-Bolt consists of two basic units, the stock and the barreled action, (Figure 1). The receiver, magazine housing, magazine, trigger mechanism, breech bolt and barrel make up the barreled action. The walnut stock and trigger guard comprise the stock unit.

DISASSEMBLY

1. Remove the breech bolt by drawing it straight rearward to its normal "open" position; then depress the trigger and draw the breech bolt completely from the action.

2. Press the magazine latch rearward and remove the clip magazine.

3. Loosen the take-down screw.

4. Lift the barreled action from the stock.

5. Under normal circumstances, disassembly is neither necessary nor advised for adequate cleaning. It is only when the rifle has been heavily exposed to water or dirt that it would be considered essential.

ASSEMBLY

1. With the breech bolt removed, merely fit the action and barrel to the recessed and cut out portions of the stock. In doing so the trig-

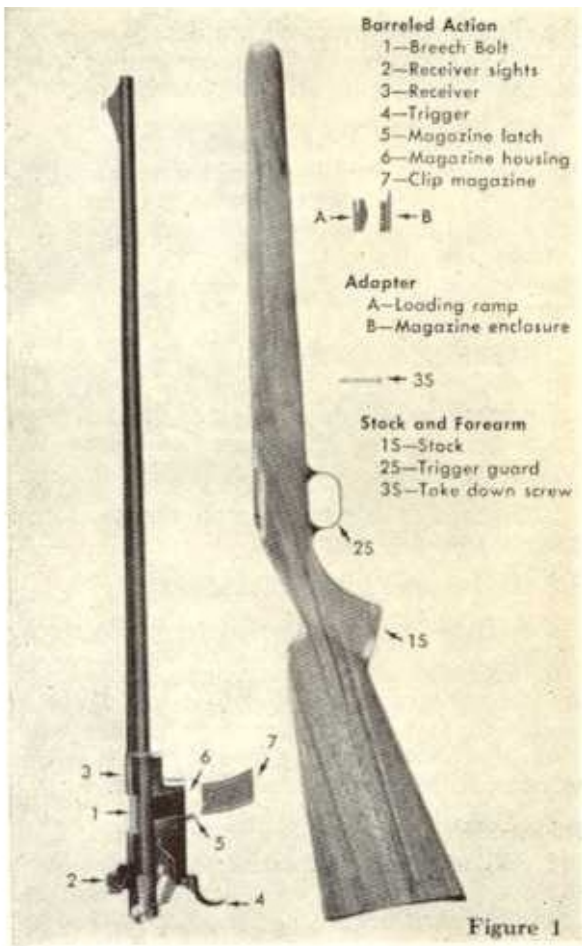

ger will pass through the opening in the stock into the trigger guard. Force is not required in fitting the two units together.

2. Tighten the take down screw securely to insure proper bedding of the barrel.

3. Pull the trigger rearward, align the bolt with the barrel, insert through the rear face of the receiver and slide forward. If the cross bolt of the breech bolt is closed, open before inserting by pulling rearward on the bolt handle.

4. Insert the clip magazine in the magazine recess and snap into place.

MANUAL SAFETY

The thumb safety is located on the left rear of the receiver, convenient to the thumb of either the right or left hand. When the safety button is raised to its UP position, the rifle is ON SAFE; when depressed to its DOWN position, the safety is OFF, and the rifle is





ready to fire. In the OFF SAFE position, a red warning dot is exposed (See Figures 2 & 3). This is a positive safety which locks the trigger and makes it impossible to open the bolt. When the safety is OFF, the rifle cannot fire until the breech bolt is completely forward and locked into position by its cross bolt.

LOADING AND FIRING

The Browning T-Bolt .22 Rifle has a clip magazine which holds five Long Rifle cartridges. With the magazine inserted empty, the rifle may also be fired as a single shot by loading the chamber after each shot, in which event either Short, Long, or Long Rifle cartridge may be used.

1. To load, open the breech bolt by drawing it to its rearward position, then release the magazine by pressing the magazine latch rearward and pulling the magazine from its recess in the underside of the stock.

2. The magazine is loaded by placing the brass end of each cartridge into the notch on the top of the magazine and pushing downward. When the magazine is loaded, insert it into the magazine opening and push upward until it is locked into place by the magazine latch.

3. To load the first shell into the chamber merely push the bolt handle straight forward until the breech bolt is fully closed. This forward movement cocks the rifle, picks up the top cartridge from the magazine, and carries it into the chamber. The rifle is now ready for firing and should be placed "ON SAFE" until actual shooting commences.

4. After the first cartridge has been fired, a straight rearward pull of the bolt handle extracts and ejects the spent shell case and pushing the bolt handle straight forward chambers another cartridge ready for firing.

5. A smooth, effortless, straight rearward and forward movement of the bolt handle is all that is necessary to complete the ejecting and loading cycle. As with any bolt action rifle, the slamming of the bolt forward with unnecessary force can contribute to occasional feeding problems.

6. In the event the shooter wishes to load a full magazine and the chamber, the procedure would be to open the bolt, hand feed one cartridge into the chamber, close the bolt,

place the safety "ON SAFE," release the magazine, and load it as described above. The rifle is now ready to fire and contains six cartridges.

UNLOADING

To unload the rifle, first pull the breech bolt rearward to clear the chamber, then remove the clip magazine and strip from its top any remaining cartridges with the thumb.

To prevent dropping the magazine when removing it from the rifle, it is good practice to cup the left hand around the magazine as the latch is released with a finger of the right hand.

SINGLE SHOT CONVERSION

The Single Shot Bolt Action Rifle has long been recommended as the safest kind of rifle with which to train a youngster or the adult beginner.

With this Browning T-Bolt Rifle is provided a two-piece adapter (Figure 1) which permits its quick conversion to a single shot model. It is the recommendation of the Browning Arms Company that this rifle be converted to the single shot version if it is going to be used in teaching a youngster or any beginner.

The two-piece adapter may be installed without disassembly of the rifle:

1. Remove the clip magazine.
2. Adapter Piece (A) is the loading ramp

and is inserted into the top of the magazine housing through the receiver opening after the breech bolt has been removed (Figure 4). The loading ramp has a horizontal slot through its axis and should be inserted with the open end of the slot toward the chamber. With reasonable pressure with the thumb of either hand the ramp will snap and lock into place just below the level of the chamber. Then try the bolt carefully to be sure the ramp is properly seated and does not obstruct

the movement of the breech bolt. Either .22 Short, Long, or Long Rifle cartridges may be dropped on the loading ramp and fed into the chamber by closing the breech bolt in conventional single shot fashion.

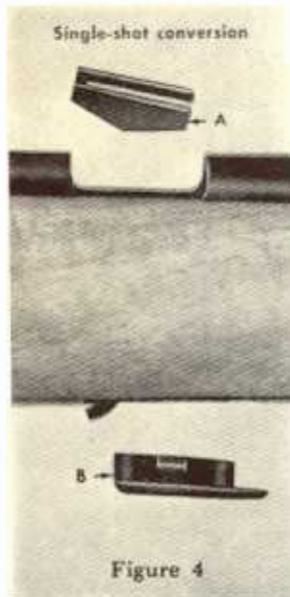

3. In the magazine recess in the bottom of the stock, insert Adapter Piece (B) (Figure 4), which merely serves as an enclosure. It is inserted with the lip forward or toward the muzzle and snapped into place with slight thumb pressure.

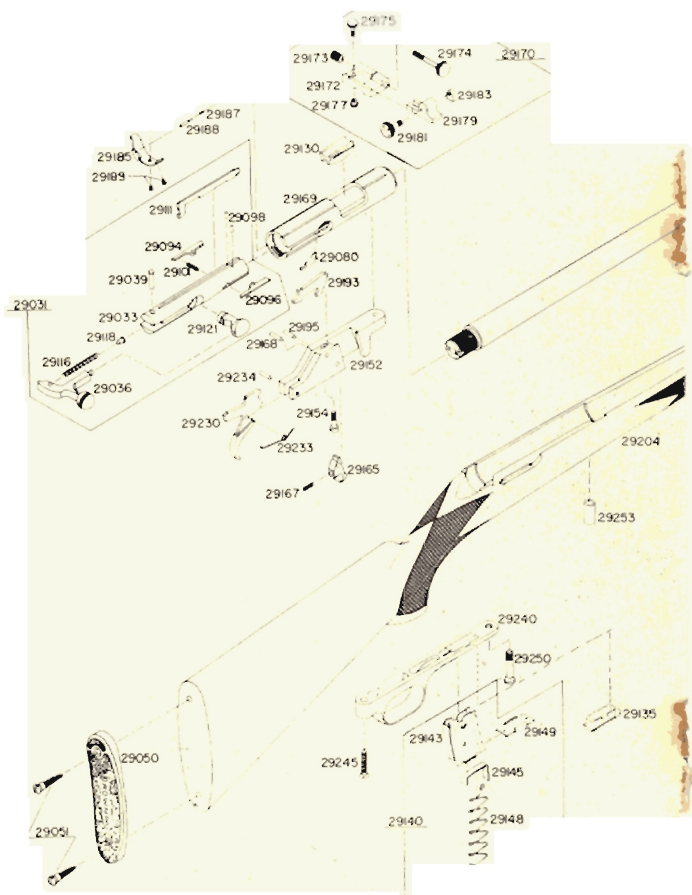



BROWNING T-BOLT

.22 Caliber Bolt Action Rifle Parts List

Code No.	Description
29001	Barrel 22"
29003	Barrel 24"
29031	Bolt Assembly — Includes Breech Bolt, Bolt Handle, Bolt Handle Pin, Extractor Left, Extractor Right, Extractor Pins, Extractor Spring, Firing Pin, Firing Pin Spring, Firing Pin Spring Follower and Cross-Bolt
29033	Breech Bolt
29036	Bolt Handle
29039	Bolt Handle Pin
29050	Butt Plate
29051	Butt Plate Screw
29080	Ejector
29094	Extractor — Left
29096	Extractor — Right
29098	Extractor Pin — Left or Right
29101	Extractor Spring — Left and Right
29111	Firing Pin
29116	Firing Pin Spring
29118	Firing Pin Spring Follower
29121	Cross-Bolt
29130	Loading Ramp (Single Shot)
29135	Magazine Enclosure (Single Shot)
29140	Clip Magazine Complete
29143	Clip Magazine Body
29145	Clip Magazine Follower
29148	Clip Magazine Follower Spring
29149	Clip Magazine Floorplate
29152	Magazine Housing
29154	Magazine Housing Screw
29165	Magazine Latch
29167	Magazine Latch Spring
29168	Magazine Latch Pin
29169	Receiver
29170	Receiver Sight Assembly — Complete
29172	Receiver Sight Base
29173	Receiver Sight Mounting Screw Bushing
29174	Receiver Sight Mounting Screw
29175	Receiver Sight Adjusting Screw — Horizontal
29177	Receiver Sight Adjusting Screw Bushing — Horizontal
29179	Receiver Sight Eyepiece Housing
29181	Receiver Sight Eyepiece
29183	Receiver Sight Eyepiece Adjusting Bushing — Vertical
29185	Safety Body
29187	Safety Click Pin Spring
29188	Safety Click Pin
29189	Safety Screw
29191	Safety Selector
29193	Sear
29195	Sear Pin
29196	Sight Ramp — Front
29197	Sight Blade — Front
29198	Sight Ramp Retaining Pin
29202	Stock — Standard Model T-1 Oil Finish
29204	Stock — Deluxe Model T-2 Checkered and Lacquer Finish
29230	Trigger
29233	Trigger Spring
29234	Trigger Pin
29240	Trigger Guard
29245	Trigger Guard Screw — Rear
29250	Take Down Screw
29253	Take Down Screw — Bushing

IMPORTANT:

When ordering parts, list code number, part name, caliber, model and serial number.

REPEATER CONVERSION

The conversion of the rifle back to the repeater version is comparatively simple but not so easy that it could be done readily by a youngster.

1. First remove Magazine Enclosure (B) from the underside of the stock by applying pressure with the thumb to its rearward portion and lifting the front lip outward with the thumbnail or any appropriate tool.

2. Disassemble the barreled action from the stock as described on page 1 of these instructions.

3. Apply inward and upward pressure to the exposed triangular loading ramp Adapter Piece (A) causing it to snap out of the top of the magazine housing (Figure 5).

4. Reassemble the rifle and insert the clip magazine.



SIGHTS

The receiver of the T-Bolt is grooved to accept the receiver sight provided with this rifle as well as Browning's .22 Scope and Mount, or most other scope mounts designed for a grooved receiver (Figures 6 & 7).

1. The receiver sight may be positioned at any point along the receiver groove desired but a position where the rear face of the eye-



Sight

1—Locking knob
2—Horizontal adjustment knob

3—Eyepiece knob
4—Horizontal graduation
5—Vertical graduation

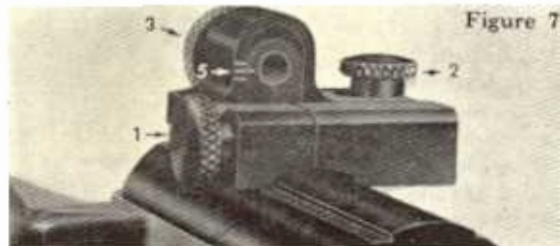

piece knob is about $\frac{3}{8}$ " forward of the rear face of the receiver seems about right for average vision.

2. The knob for locking the receiver sight on the receiver is on the right side of the sight body.

3. The horizontal adjustment is controlled by the knob at the left top of the sight body.

4. Vertical correction is accomplished by loosening and moving the eyepiece knob itself which incorporates the rear sight aperture.

5. For both horizontal and vertical corrections white graduation marks are etched into the sight base to assist zeroing or sighting-in processes. One graduation moves point of impact $2\frac{3}{4}$ " at 50 yards.

6. In sighting-in, remember this simple rule: Always move the rear sight in the same direction you want the point of bullet impact to move.

CLEANING AND CARE

Ordinary good judgment will dictate that the metal parts of the gun should receive a light film of oil after the gun has been exposed to weather or handling. Do not, however, pour excessive oil into the action. Very little oil does an adequate job and surplus oil will only soften the stock or provide a base for dirt to collect in the action.

1. To clean the barrel, remove the breech bolt and magazine and insert the cleaning rod

with oiled patch from the breech end. After considerable shooting, it is occasionally desirable to use a wire brush to clear possible lead fouling from the barrel.

2. Wipe the breech bolt and interior portions of the action with an oiled cloth as usage dictates. If the breech bolt is kept clean and slightly lubricated, it will prove to be one of the smoothest operating actions you have ever experienced.

3. The T-Bolt **T-2** has a highly polished, lacquer finished stock. A good furniture wax on all polished surfaces now and then provides the best possible protection.

4. The T-Bolt **T-1** has an oil finish which may be easily cared for and, if desired, greatly enriched through a little industry on the part of the owner. A slightly brighter sheen may be acquired by using a good furniture wax. However, the oil finish on this stock is a perfect base for a hand rubbed finish of almost any degree of brilliance. Merely apply as many hand rubbed coats as desired of any of the good linseed oil base commercial stock finishes or, if preferred, use triple boiled linseed oil. Before application of these linseed oil finishes, be sure any waxed surfaces formerly applied are completely removed.

5. When storing your rifle, choose a safe place away from children and one where moisture is not present.

Before Each Shooting Session, Make Certain There Is No Obstruction of Any Type in the Barrel.