

Operation and Care of BROWNING® CHALLENGER .22 Automatic Pistols



VERY IMPORTANT • SAVE THIS BOOKLET
These instructions should be carefully noted

BROWNING®



We are proud that you have chosen a Browning. In its manufacture we have endeavored to incorporate the very finest in materials and craftsmanship, and with just reasonable care this gun should provide you with many years of pleasure and dependable service. If, by any chance, you have any observations to make regarding its performance or appearance, we hope you will write us immediately.

We would also like to know more about you as a Browning owner and would be grateful if you could take but a moment to complete and return the registration card found on the inside back cover.

Thank you.

BROWNING

BROWNING, New Gun Owner's Record

Keep this record for future reference

Browning Model.....

Serial Number.....

Gauge or Caliber.....

Purchase Price.....

Purchased From.....

Date of Purchase.....

Important: Please fill out and mail the Registration Card at the back of the booklet.

BROWNING

Route #1, Morgan, Utah 84050

Distributed in Canada by: Browning Arms Co. of Canada, Ltd.

5350 Ferrier Street, Montreal, Que. H4P1L9

CHALLENGER .22 AUTOMATIC PISTOL

NOMENCLATURE

In conventional gun terminology the position and movement of pistol parts are described as they occur with the pistol horizontal and in normal firing position; i.e. the muzzle is forward or front; the pistol grip is rearward or rear; the trigger is downward or underneath; the sights are upward or on top.

CAUTION

a. Always visually check your pistol to be certain that it does not inadvertently contain any ammunition. Whenever possible, keep the thumb safety in the "on safe" position by pressing it upward into the recess provided for it in the slide.

b. Whether you believe the pistol to contain ammunition or to be empty, always remember to point the muzzle in a safe direction.

c. Before firing your pistol make sure there are **NO OBSTRUCTIONS** in the barrel and clean the bore using a cleaning rod and patch. Wipe away any anti-rust compounds present in the action-chamber areas.

AMMUNITION — Your pistol must be used only with .22 Long Rifle Cartridges. The barrel and action of this pistol have been made with substantial safety margins over the pressures developed by established com-

mercial loads. Nevertheless, Browning can assume no responsibility for incidents which occur through use of cartridges of non-standard dimension or those developing excessive pressures.

GENERAL OPERATION

Your new Browning is a recoil operated, semi-automatic pistol. With the chamber and magazine loaded and the safety in the "off safe" or "fire" position, the pistol will fire a single round with each successive pull of the trigger until the magazine and chamber are empty. The slide of this pistol is designed to stay open after the last cartridge has been fired.

SAFETY FEATURES

Thumb Safety: To put the mechanism "on safe" with the slide fully forward, the thumb safety is pressed upward into the recess provided for it in the slide. In this position the sear is blocked and the firing pin cannot move forward. The slide can also be drawn rearward and the thumb safety elevated into a second recess for the purpose of locking the slide back. With the slide locked in its rearward position the pistol, of course, cannot fire. This is an additional safety meas-



ure when on the range or while in storage. Also, since the slide stays open automatically after the last shot is fired, it is a signal the gun is empty (Fig. 1).

It is important to remember that a **cartridge in the chamber can be fired after the magazine has been removed so always check the chamber to be certain a live cartridge is not present.**

LOADING AND FIRING

After putting the thumb safety in the "on safe" position, press the magazine latch at the bottom of the pistol grip and remove the magazine. Insert the cartridges into the magazine by pushing them down and sliding them rearward with your thumb. The magazine will hold up to 10 cartridges. Insert the loaded magazine into the grip, being certain that the magazine is pressed completely in until retained by the magazine latch (Fig. 2).



Figure 2

tion and chamber to be sure that a live cartridge is not remaining in the pistol. The stop open latch does not operate with the magazine removed unless the slide is locked into its rearward position manually or unless the magazine is removed after the last shot is fired, in which event the slide has already been locked rearward automatically.

SIGHTS

The pistol is equipped with a precision rear sight which is screw adjustable for both horizontal and vertical correction.

1. To move point of impact to the right, simply loosen the coin slotted screw, located on the right side of the sight, by turning in a counter-clockwise direction and tighten the screw on the left side by turning in a clockwise direction. This causes the rear sight to move to the right. To move the point of impact to the left, just reverse this procedure (Fig. 3).
2. To raise the point of impact, turn the elevation screw located just behind the rear sight in a clockwise direction. To lower, turn the elevation screw in a counter-clockwise direction (Fig. 3).



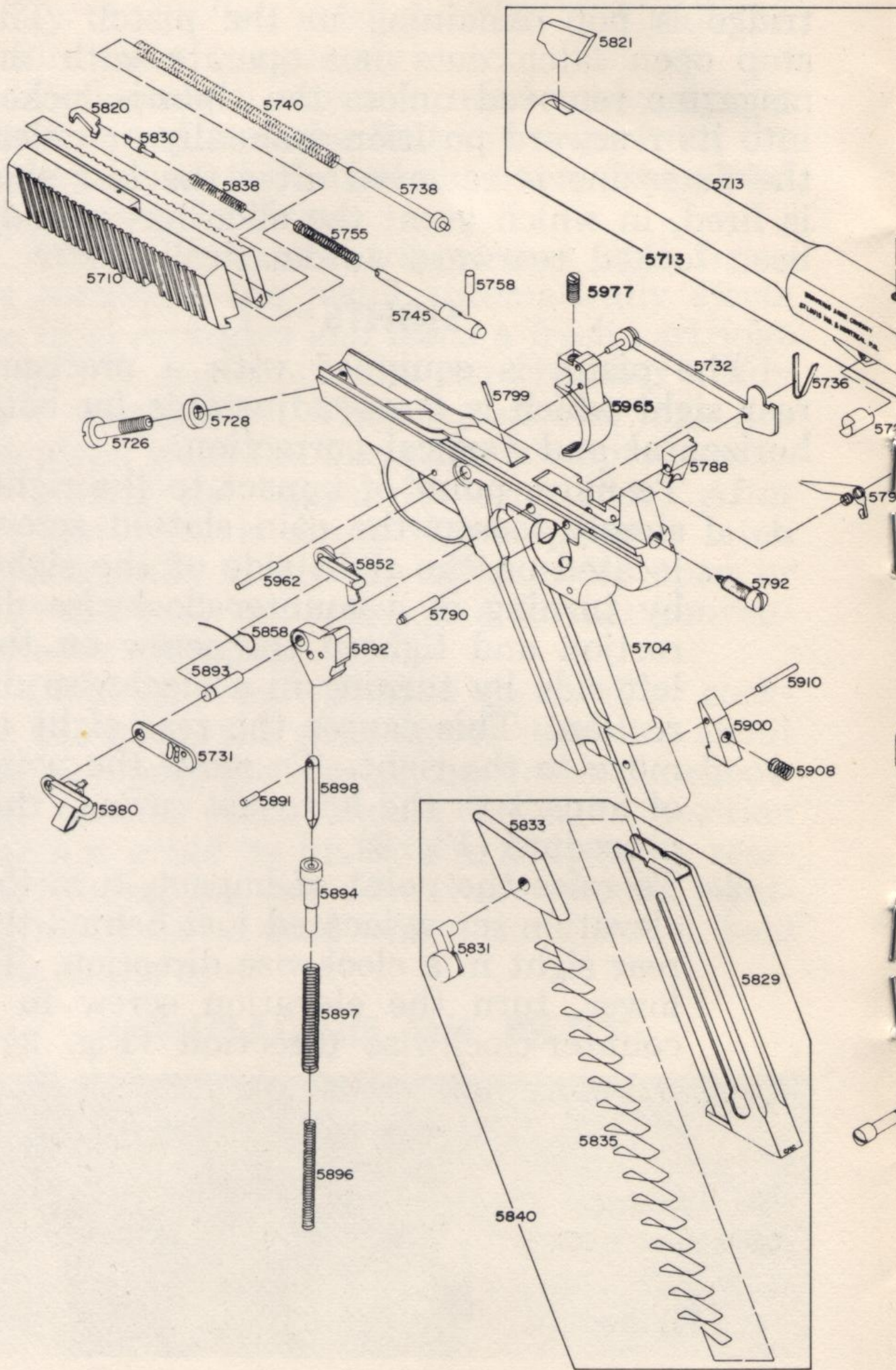

BROWNING®

CHALLENGER .22 Caliber Automatic Pistol

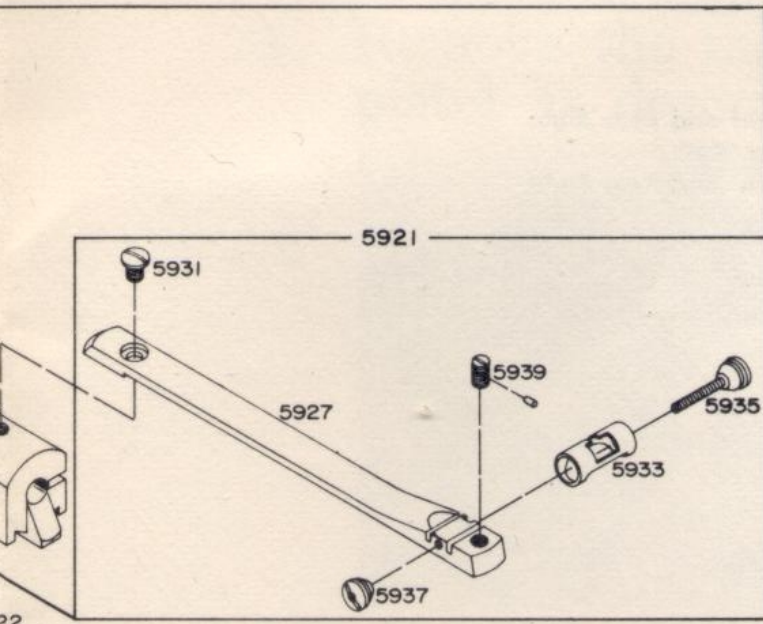

22
5793

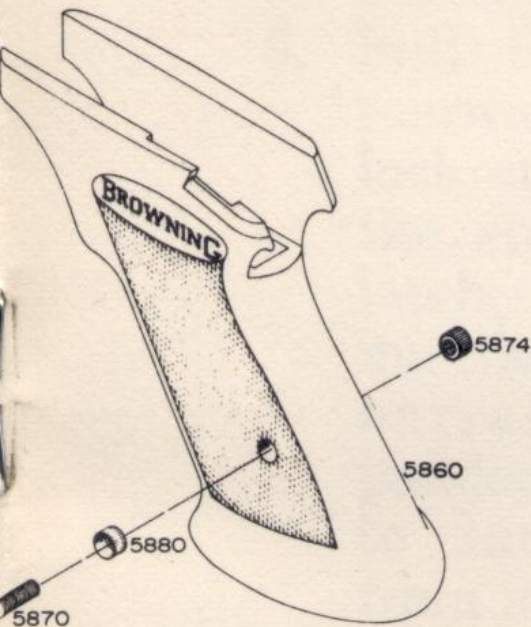

IMPORTANT: When ordering parts, list code number, part name, caliber, model and serial number.

.22 Caliber CHALLENGER Pistol Parts List

Code Number	Name
5704.....	Frame — with Ejector
5710.....	Slide
5711.....	Barrel with Front Sight and Rear Sight Assem. Complete 4 $\frac{3}{4}$ "
5713.....	Barrel with Front Sight and Rear Sight Assem. Complete 6 $\frac{3}{4}$ "
5722.....	Barrel Guide Pin
5726.....	Barrel Mounting Screw
5728.....	Barrel Mounting Screw Washer
5731.....	Click Plate
5732.....	Disconnecter
5736.....	Disconnecter Spring
5738.....	Recoil Spring Guide
5740.....	Recoil Spring
5745.....	Firing Pin
5755.....	Firing Pin Spring
5758.....	Firing Pin Retaining Pin
5788.....	Sear
5790.....	Sear Pin
5791.....	Sear Spring
5793.....	Sear Spring Pin
5799.....	Ejector
5820.....	Extractor
5838.....	Extractor Spring
5830.....	Extractor Plunger
5826.....	Sight Blade — Front
5827.....	Sight Blade Retaining Pin
5828.....	Sight Ramp — Front
5829.....	Magazine Body
5831.....	Magazine Button
5833.....	Magazine Follower
5835.....	Magazine Spring
5840.....	Magazine Complete
5852.....	Stop Open Latch
5858.....	Stop Open Latch Spring
5860.....	Grip
5870.....	Grip Screw
5874.....	Grip Escutcheon Threaded
5880.....	Grip Escutcheon Unthreaded
5891.....	Hammer Link Pin
5898.....	Hammer Link Strut
5892.....	Hammer
5893.....	Hammer Pin
5894.....	Main Spring Plunger
5896.....	Main Spring — Inner
5897.....	Main Spring — Outer
5900.....	Magazine Latch
5908.....	Magazine Latch Spring
5910.....	Magazine Latch Pin
5921.....	Sight Assembly Rear — Complete
5927.....	Sight Base — Rear
5931.....	Sight Base Mounting Screw — Rear
5933.....	Sight Aperture — Rear
5935.....	Sight Adjusting Screw — Rear — Windage
5937.....	Sight Adjusting Screw Nut — Rear — Windage
5939.....	Sight Adjusting Screw — Rear — Elevation
5965.....	Trigger — Gold Plated — with Backlash Screw
5962.....	Trigger Pin
5977.....	Trigger Backlash Adjustment Screw
5792.....	Trigger Pull Adjustment Screw
5980.....	Safety

DISASSEMBLY

1. Remove the magazine and unload the pistol as described previously.

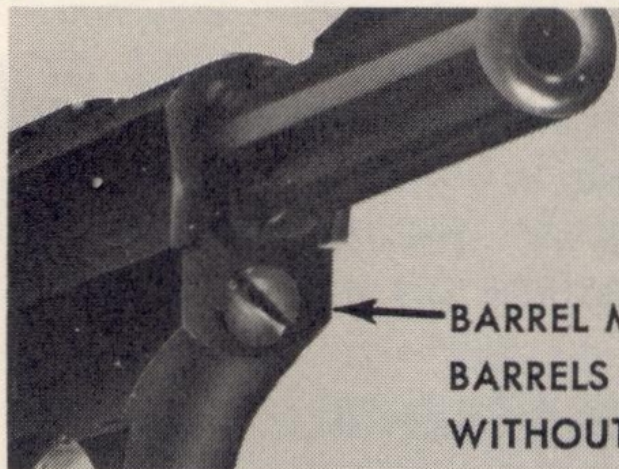

Figure 4

BARREL MOUNTING SCREW
BARRELS INTERCHANGEABLE
WITHOUT FITTING

2. Located under the barrel on the front of the frame is a coin slotted barrel mounting screw. Using a screwdriver or a dime, loosen this screw until it becomes disengaged from the barrel (Fig. 4). It is unnecessary to remove the screw completely from the frame.

3. Pull the slide rearward and lock open with the stop open latch. Tap the muzzle of the barrel on a padded surface to loosen it from its locked position (Fig. 5).



Figure 5

4. Slide the barrel rearward and upward to separate it from the frame (Figure 2, page 3).

5. Release the slide and allow it to move slowly forward and off the front of the frame, being careful not to lose control of the recoil spring (Fig. 2, page 3).

This is sufficient disassembly for all practical cleaning and lubricating required. Further disassembly is recommended only for competent gunsmiths or the factory repair department.

REASSEMBLY

1. Replace the slide on the guide rails of the frame and push rearward until the nib on the end of the recoil spring guide can be placed in the hole in the rear part of the frame (Fig. 2, page 3). Then continue to push the slide as far rearward as it will go and lock in this rearward position with the stop open latch.
2. Place the barrel on the frame so that the barrel guide pin aligns with the barrel guide pin recesses in the frame. Pull the barrel forward into position on the frame and allow the slide to move forward to its closed position.
3. Secure the barrel to the frame by tightening the barrel mounting screw.

Caution: Do not apply maximum pressure when tightening the barrel mounting screw. This should be tightened to just a snug fit. The barrel mounting system is a new patented "V-WAY-WEDGE" locking system, which locks the barrel into tight alignment and prevents the slightest instability.

4. Replace the magazine.

TRIGGER PULL ADJUSTMENT

The adjusting screw to regulate the trigger pull is located on the rear face of the frame. Turn this screw in a counter-clockwise direction to lighten the trigger pull for the more meticulous type of target shooting. When the top of the screw head is approximately flush with the outside surface or face of the frame, tension is off the screw and maximum reduction of trigger pull has been effected. It is inadvisable to loosen this adjustment screw beyond this point.

The screw is turned in a clockwise direction to increase the trigger pull for greater safety in general shooting. Trigger pull may be increased as desired. The screw head eventually bottoms against the recess in the frame. This determines its maximum limit.

TRIGGER BACKLASH ADJUSTMENT

The adjusting screw to regulate trigger backlash is located in the top surface of the trigger (Fig. 6). This screw is reached by first removing the barrel of this pistol. Leave the slide locked in the rearward position. The adjusting screw can then be reached with a small screwdriver through the top of

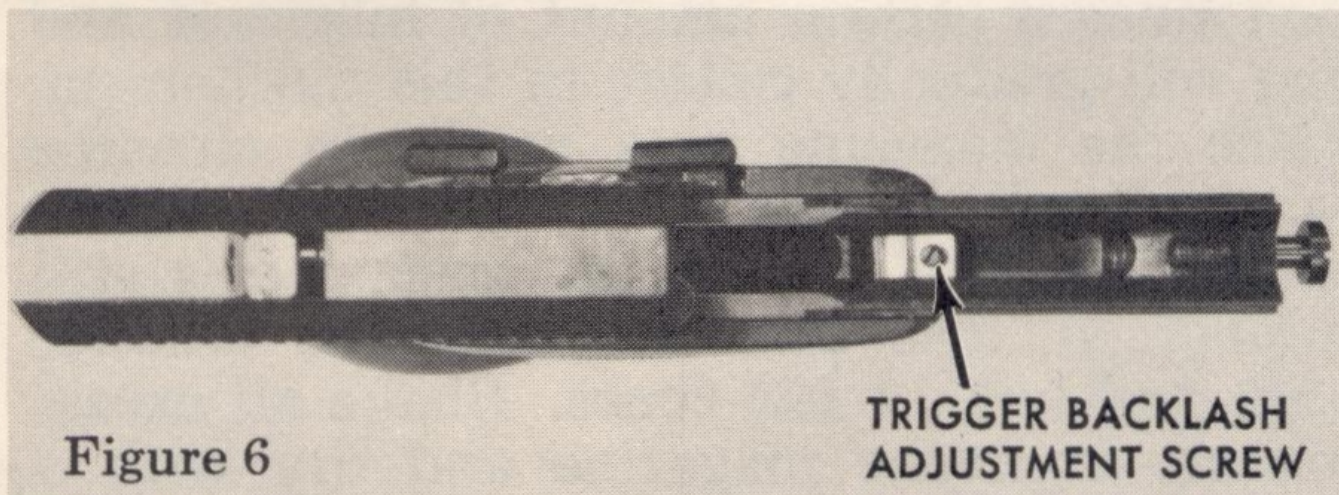

Figure 6

TRIGGER BACKLASH
ADJUSTMENT SCREW

the frame. Turning the adjusting screw in a counter-clockwise direction increases backlash. Beyond a certain point, backlash can be reduced no more and further tightening of the backlash screw will only stiffen trigger pull, ultimately causing the trigger to become inoperative.

CLEANING

The slide assembly may be cleaned with any good gun cleaning solvent or light oil and then dried with a clean cloth, or preferably blown dry with air pressure, if available.

The barrel may be cleaned with a good quality powder solvent such as Browning Liquid Gunsmith. Ordinarily a light lubricating oil will suffice for this purpose. When cleaning the bore of the barrel, it is preferable to enter the cleaning rod from the chamber end of the barrel. Use a small brush to remove dirt or other foreign matter from other parts of the action. Lubricate the pistol with a good light gun oil. All moving parts should be occasionally lubricated. Use oil sparingly; a very light film is sufficient. Browning Gun Oil is ideally suited for this purpose.

The magazine should be cleaned after every 1,000 to 1,500 rounds for best operation since a certain amount of lubricant and dirt will gradually collect in this mechanism. Place the magazine in a good gun cleaning solvent and agitate to loosen and remove grease and dirt. While the magazine is still submerged, also pull the magazine follower back and forth a few times. Shake all excess solvent from the magazine and dry with a cloth, or preferably blow dry with air pres-

sure, if available.

Caution: Most solvents are highly inflammable. Appropriate safety measures should be practiced when working with solvents.

SERIAL NUMBER: The serial number of your pistol can be found stamped on the front of the pistol grip portion of the frame.

SPECIFICATIONS

Caliber	.22 Long Rifle
Capacity of Magazine	10 Cartridges
Over-all length	9-3/16 or 11-7/16 inches*
Length of Barrel	4-1/2 or 6-3/4 inches
Height of Pistol	4-7/8 inches
No. of Rifling Grooves	6 Grooves
Twist of Rifling	Right Hand
Weight of Pistol	35 or 38 oz. *
Sights	1/8" wide removable Front; Windage
Sight Radius	6 ³ / ₄ " or 9"* and Elevation Adjustment Rear
	*4-1/2" barrel or 6-3/4" barrel

OTHER BROWNING PRODUCTS

GUN CARE PRODUCTS —

Gun Oil cleans, lubricates, and protects metal and bluing. It's designed to function in extreme temperatures. Available in pour-spout or aerosol can. **Liquid Gunsmith** is a swift penetrating, hard scrubbing bore and metal cleaner that lubricates as it cleans. Comes in aerosol cans.

.22 RIM-FIRE AMMUNITION —

Maximum accuracy and performance are yours with the **Browning Nail Driver .22 Ammunition**. Available in High Velocity Shorts, Long Rifles and Long Rifles Hollow Points as well as Standard Long Rifles. We also make all popular calibers of centerfire rifle, hand gun ammunition and power rated shotgun shells.



**PLACE
STAMP
HERE**

BROWNING

Route 1

Morgan, Utah 84050

BROWNING REGISTRATION CARD

Model

Your Name

Address

City and State Zip

Dealer Purchased From

City in Which Purchased

Serial Number Caliber

Price Date Purchased

Your Age

YOUR REASONS FOR SELECTING A BROWNING (Check one or more)

- I have used Browning Guns before
- Recommended by another Browning owner
- Recommended by my Browning Dealer
- Saw an Advertisement
- Saw Browning printed literature
- Read magazine article

How many Browning Sporting Arms do you now own?

WHAT MAGAZINES DO YOU READ REGULARLY? (List in order of preference)

1.
2.
3.
4.

WHAT WILL BE THE PRIMARY USE OF YOUR NEW BROWNING FIREARM? (Check one or more where applicable)

- | | | |
|--------------------------------------|--------------------------------------|-----------------------------------|
| <input type="checkbox"/> Squirrel | <input type="checkbox"/> Varmint | <input type="checkbox"/> Plinking |
| <input type="checkbox"/> Rabbit | <input type="checkbox"/> Crow | <input type="checkbox"/> Target |
| <input type="checkbox"/> Other | <input type="checkbox"/> Other | |

Suggestions for Improvement:

.....

.....

.....

.....