



# ARMSCOR

## ARMSCOR 1911 MS (Mid-size) PISTOL

### USER'S MANUAL

Armcor now introduces the new downsized Model MS 1911-A1 pistol in Caliber .45 Auto / Caliber 9mm. It is basically a shortened version of the original full size (FS) 1911-A1.

The overall length of the MS Pistol is one inch shorter but with the same grip length giving the same firepower and good handling characteristics as with the full size parent. Most features present in the standard version are available in this model skeletonized trigger and combat hammer, beavertail grip safety, squared slide serration, lowered ejection port and beveled magazine well. Added features include the extended ejector, use of a reverse recoil spring plug and a full-length recoil spring guide that acts as a stabilizer. Dovetail front and rear sights are standard on all MS Pistols.

The MS uses the same internal parts of the full-size model except for the shortened barrel bushing.

Disassembly of the MS pistol is done by first removing the slide stop and separating the slide- barrel- recoil spring assembly from the frame. The recoil spring guide is then pushed forward compressing the recoil spring until the small hole on it comes of the reverse plug. A paper clip with 5/16 inch of its end bent at 90-degree angle (fig. 1) is inserted into the hole trapping the spring assembly (fig. 2). At this point, the recoil spring guide assembly can now be pulled out rearward of the spring tunnel (fig. 3). No

further disassembly is recommended for routine cleaning and maintenance purposes.

**SPECIFICATIONS:**

Model	: MS 1911 –A1
Caliber	: 45 Auto / 9mm
Action	: Semi-auto, Recoil Operated
Magazine Capacity	: 8 rounds / 9 rounds
Effective Range	: 50 Yards
Overall Width	: 1 5/16”
Overall Length	: 7 1/8 “
Overall Height	: 5 1/8 “
Weight (empty)	: 2.16 lb
Trigger Pull	: 4.0 to 6.5 lb
Barrel Length	: 3 1/2”
Sights (Front & Rear)	: Mounted on Dovetail Cut
Rifling Twist	: Right Hand, one turn in 16”
Number of Grooves	: 6 grooves
Finish	: Blued

NOTE: Specifications subject to change without prior notice.

<b>PART NO.</b>	<b>DESCRIPTION</b>
4501MS	Barrel
4502MS	Barrel Bushing
4503	Barrel Link
4504	Barrel Link Pin

4505MS	Slide
4506	Slide Stop
4507	Slide Stop Plunger
4508	Plunger Spring
4509	Firing Pin
4510	Firing Pin Spring
4511	Firing Pin Stop
4512	Extractor
4513 A	Front Sight
4514	Rear Sight
4515MS	Recoil Spring
4516MS	Recoil Spring Plug
4517MS	Recoil Spring Guide
4518MS	Frame
4518PT	Plunger Tube
4519S	Magazine Box
4520S	Magazine Spring
4521S	Magazine Follower
4522S	Magazine Follower Plate
4523S	Magazine Base Pad
4524S	Magazine Release
4525	Magazine Release Lock
4526	Magazine Release Spring
4527S	Grip Pane Right
4528S	Grip Pane Left
4549S	Grip Screw
4529GSB	Grip Screw Bushing

4530	Trigger Shoe
4531S	Trigger Stirrup
4532	Trigger Stirrup Pin
4533C	Hammer
4534	Hammer Pin
4535	Hammer Strut
4536	Hammer Strut Pin
4537	Sear
4538	Sear Pin
4539	Sear Spring
4540	Disconnecter
4541ASL	Ambidextrous Safety Left
4541ASR	Ambidextrous Safety Right
4543	Ejector
4544	Ejector Pin
4545BGS	Beavertail Grip Safety
4546	Main Spring
4547	Main Spring Cap
4548	Main Spring Cap Pin
4549	Main Spring Housing
4550	Main Spring Housing Pin
4551	Main Spring Housing Pin Retainer

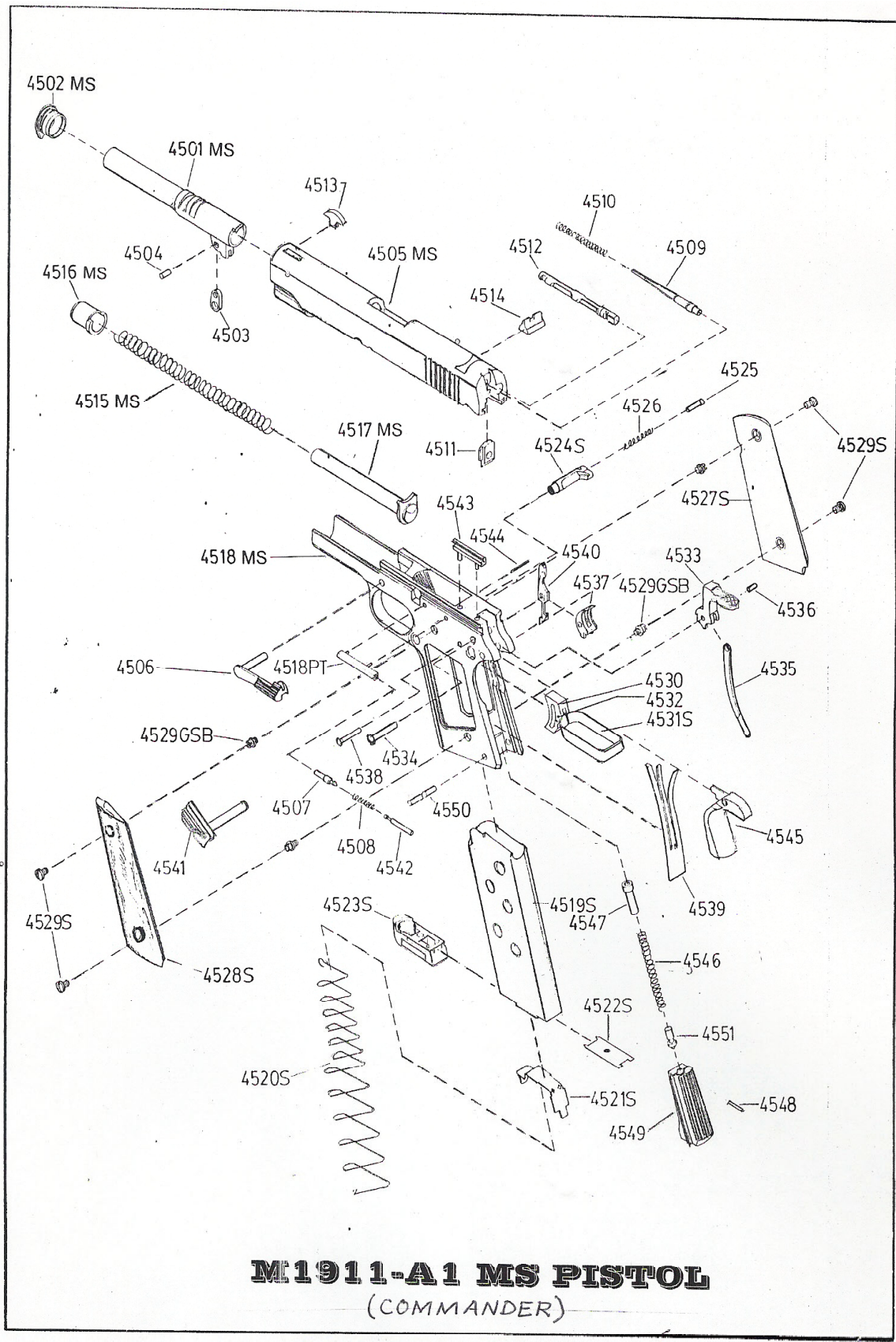

**M1911-A1 MS PISTOL**  
 (COMMANDER)