



ARMSCOR

MODEL 14P

USER'S MANUAL

WARNING:

READ THE INSTRUCTIONS AND SAFETY PRECAUTIONS IN THIS MANUAL CAREFULLY BEFORE USING THIS FIREARM.

DISCHARGING FIREARMS IN POORLY VENTILATED AREAS, CLEANING FIREARMS OR HANDLING AMMUNITION MAY RESULT IN EXPOSURE TO LEAD AND OTHER SUBSTANCES KNOWN TO THE STATE OF CALIFORNIA TO CAUSE BIRTH DEFECTS, REPRODUCTIVE HARM AND OTHER SERIOUS PHYSICAL INJURY. HAVE ADEQUATE VENTILATION AT ALL TIMES. WASH YOUR HANDS THOROUGHLY AFTER EXPOSURE.

INSTRUCTIONS FOR OPERATING AND CARE

This rifle is shipped from the factory with the gunstock packed separately from the barrel receiver assembly and bolt assembly.

ASSEMBLY

Remove the screw from the stud on the underside of the barrel and directly opposite the trigger housing. (Note that the stud can be moved sideways and is kept from sliding out by staking the ends of the dovetail cut). Fit barrel-receiver and trigger housing assembly to the stock such that the stud freely fits into the hole provided for it in the gunstock. Tighten screw to nest barrel on the stock.

TO PUT BOLT INTO RECEIVER

Before putting bolt into receiver. Note first if bolt is cocked. If not, push bolt into receiver as far as possible, then rotate bolt handle upward, thus cocking bolt. With safety in "F" position and bolt cocked, pull trigger fully, insert bolt into receiver and close fully. Turn bolt handle downward to lock.

TO LOAD MAGAZINE

Hold magazine firmly in one hand. With the other hand place cartridge on top just forward of notch and press head downward under ears at rear of magazine. Repeat until maximum number of cartridges is loaded.

TO MAKE SAFE

Pull safety on right side of receiver in the direction of the “S” mark. This locks trigger and gun cannot be fired.

TO ATTACH MAGAZINE

Position magazine open end up and ears rearward. Push magazine inward until it engages with magazine catch.

TO OPEN ACTION

Hold bolt handle and rotate cocking cam counter clockwise. As soon as the lugs clear the lug seat, pull bolt handle fully rearward.

TO CLOSE ACTION

Push bolt handle fully forward and rotate cocking cam clockwise until lugs are properly seated..

TO FIRE

BE SURE GUN IS POINTED TOWARD TARGET. With action closed, push safety to “F” position. Pull trigger. To repeat, open and close action. The discharged shell will be ejected and a new cartridge will be fed into the chamber. Pull trigger. Repeat process until magazine is empty if desired.

TO REMOVE MAGAZINE BOX

To disengage magazine, pull magazine catch rearward, hold on lock and pull box downward and out.

TO LOAD RIFLE FOR SINGLE SHOT

Insert cartridge directly into barrel with empty magazine box in place.

CARE OF RIFLE

After firing wipe out bore with clean patch, followed by oily patch if firearm is to be used again soon.

If firearm is to be stored, use a good grade of gun grease in bore as well as outside.

Interior of barrel should be cleaned free of grease before firing to ease passage of bullet and to prevent swelled bore or injury to barrel. Always keep cocking cam in bolt assembly slightly oiled.

If short cartridges are used, clean chamber after shooting as lead accumulated at forward end of chamber prevents free chambering of long cartridges unless removed.

CONSISTENT USE OF 22 CALIBER LONG RIFLE CARTRIDGES IS RECOMMENDED.

CAUTION

The safety in your firearm is correctly designed, fitted and tested. However, any mechanical device can fail. Never point your firearm at anything but a safe target and never rely upon the safety to justify careless handling.

SPECIFICATIONS:

Barrel Length	:	22.875 inches
Trigger Pull	:	3.500 inches
Length of Pull	:	13.500 inches
Drop at Heel	:	2.000 inches
Drop at Comb	:	1.500 inches
Overall Length	:	39.75 inches
Weight	:	6.500 pounds
Magazine Capacity:		6 , 10 , 15 , Cal. 22 LR
Front Sight	:	Open Type
Rear Sight	:	Rocky Mountain Partridge type with Serrated Blade for Elevation
Stock	:	Philippine Mahogany

Ordnance Steel Precision Rifled Barrel
Six (6) Grooves, Right Hand Twist
Positive Thumb Operated Safety

PART NAMES	PART NOS.
A – BARREL-RECEIVER ASSEMBLY	
Barrel Receiver Cross Pin	1401
Barrel	1402
Barrel Take Down Stud	1403
Barrel Take Down Screw	1404
Barrel Take Down Screw Washer	1405
Ejector	1406
Ejector Screw	1407
Front Sight Hood	1408
Front Sight Ramp	1409
Front Sight Screw	1410
Rear Sight Elevator	1411
Rear Sight Leaf	1412
Rear Sight Leaf Blank Insert	1413
Receiver	1414
B – BOLT ASSEMBLY	
Bolt	1415
Cocking Cam	1416
Cocking Cam Handle	1417
Cocking Cam Stud	1418
Cocking Cam Stud Retainer	1419
Cocking Cam Stud Retainer Spring	1420
Extractor Left Hand	1421
Extractor Right Hand	1422
Extractor Plunger	1423

Extractor Spring	1424
Firing Pin	1425
Firing Pin Spring	1426
Firing Pin Spring Retainer Pin	1427
Firing Pin Spring Follower	1428
Hammer	1429
Firing Pin Cross Pin	1429-A

C – TRIGGR HOUSING ASSEMBLY

Magazine Catch Insert	1430-A
Magazine Catch	1430
Magazine Catch Pivot pin	1431
Magazine Catch Stop Pin	1432
Safety Latch	1433
Safety Latch Bearing	1433-A
Safety Latch Bearing Spring	1433-B
Safety Latch Pivot Pin	1434
Safety Latch Button	1435
Sear	1436
Sear Pivot Pin	1437
Sear Spring	1438
Sear Stop Pin	1439
Trigger	1440
Trigger Pivot Pin	1441
Trigger Spring	1442
Trigger Stop Pin	1443
Trigger Housing	1444
Trigger Housing Hold Down Screw, Front	1445
Trigger Housing Hold Down Screw, Rear	1446

D – MAGAZINE BOX ASSEMBLY

Magazine Box	1447
Magazine Spring	1448
Magazine Spring Follower	1449
Magazine Spring Retainer	1450
Magazine Spring Retainer Cross Pin	1451

E – GUN STOCK ASSEMBLY

Butt Plate (Plastic)	1452
Butt Plate Retainer Screw	1453
Gun Stock. Ordinary	1454

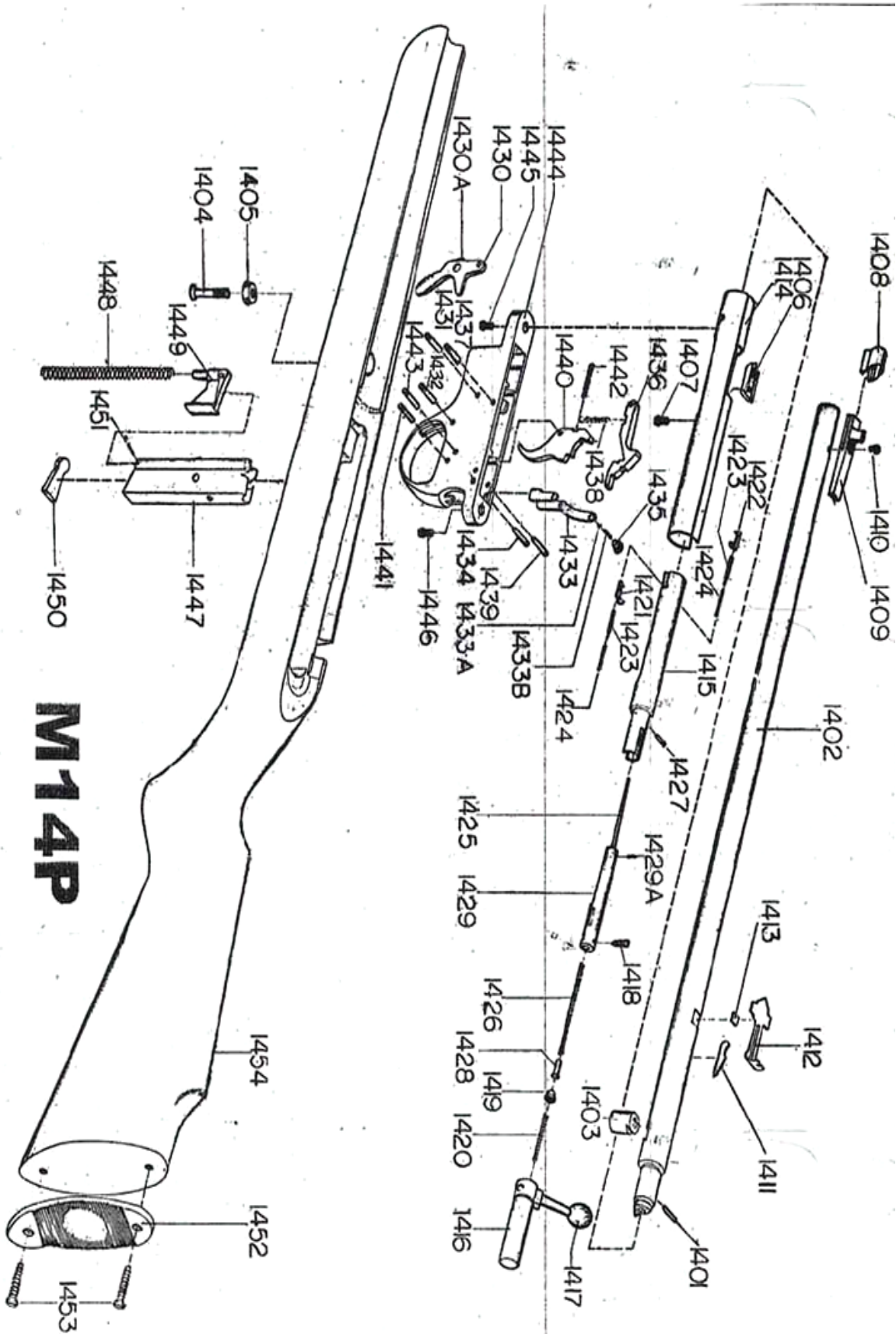

M14P