

The SureFire High-Capacity 60-/100-round magazine for 5.56 x 45mm NATO ammunition fits any firearm that accepts AR-15/M16-type mags; meets STANAG 4179 specifications. It is easily disassembled without tools. Constructed from Mil-Spec hard-anodized 6000-series aluminum, our magazines feed smoothly and reliably due to optimal geometry, non-binding coil springs, and ingenious nesting polymer followers.

FEATURES:

- Compatible with all AR-15 variants, including M4, M16, and other variants
- STANAG 4179 compliant
- Fully loaded magazine seats into weapon on a closed bolt
- Magazine can be left loaded and stored for prolonged periods of time without fatiguing springs
- Requires no special lubricants
- Weight of magazine is centered under the weapon
- Fits in most dual-mag pouches (60-round model)

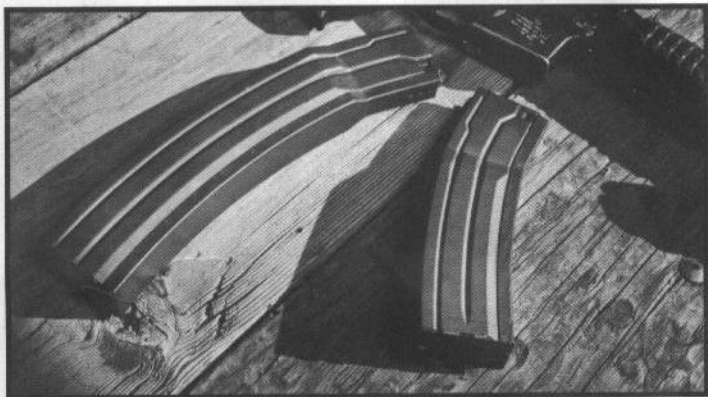

MAG5-60 & MAG5-100 SHOWN

Disclaimer

Do not use any firearm, firearm accessory, or ammunition—under any circumstances—without having received proper instruction from a qualified professional, and only in compliance with applicable laws. To ensure that SureFire's high-capacity magazines are compatible and/or safe to use with your firearm, firearm accessories, and ammunition, review your firearm manufacturer's specifications. SureFire is not responsible for damage to the magazine resulting in whole or in part from criminal or negligent use, improper or careless handling, modifications or alterations, unauthorized repairs, defective, improperly loaded, non-standard, non-SAAMI/NATO-specification ammunition, abuse, misuse, or neglect. SureFire accepts no responsibility or liability for your actions including, without limitation, any accident, injury, or damage that may result.

WARRANTY

SureFire, LLC warrants our high-capacity magazine products to be free from defect in workmanship and materials. We will repair, replace, or refund your original purchase price of this product, at our discretion, if it is determined by us to be defective. Normal wear and tear is not covered, nor is damage resulting from abuse, neglect, or altering this product from its original state.

WARRANTY CLAIMS

Before returning any product, you MUST obtain a Return Merchandise Authorization number (RMA#) from a customer service representative. To obtain a Return Merchandise Authorization number (RMA#) for repair or replacement of product, contact Customer Service by phone or send an e-mail or FAX request to:

Toll Free: 800-828-8809
Outside the U.S.: 714-545-9444
Fax: 714-545-9537
Email: helpyou@surefire.com

When a Return Merchandise Authorization number (RMA#) has been issued, send product to:

SureFire, LLC.
Repairs Department, RMA# _____
4750 Longley Lane, Suite 202
Reno, NV 89502

SureFire will pay any reasonable shipping costs to return the unit to you.

71-01-839
REV. A
4-2011

60-/100-Round High-Capacity Magazine

Disassembly:

1. Use punch or screwdriver to pry up floor plate and slide rearward to remove. (Illustration 1)
2. Remove divider/spring guide through bottom opening. (See illustration 2 for this and remaining steps)
3. Remove bottom spring and spring cup. Note: Depress and gently rock bottom spring to clear floor-plate tabs on magazine body to avoid damaging plating on spring.
4. Remove top spring and four-column follower.
5. Remove two-column follower spring and two-column follower.

Assembly:

1. Invert and insert the divider/spring guide in through the top of the magazine body so its curvature aligns with the curvature of the magazine body. Note: Divider/spring guide follower is purposely being inserted upside-down in order to align springs and followers during assembly process.
2. Insert the two-column follower and its attached spring into magazine body and align slot in two-column follower with inverted divider/spring guide.
3. Install four-column-follower top spring to the cylindrical portion of the four-column follower.
4. Insert four-column follower with attached top spring into magazine body and align with divider/spring guide.
5. Attach four-column-follower bottom spring to the spring cup. Note: Spring must be fully seated against lip of spring cup.
6. Insert spring cup and bottom spring into magazine body. Note: Cup must be inserted at 45-degree angle between floor-plate tabs at bottom of magazine. Must depress each spring coil and move in side-to-side motion to avoid contact with the tabs until the bottom spring is fully installed into magazine body.
7. Remove the inverted divider/spring guide from the opening at the top.
8. Insert divider/spring guide, through bottom opening of magazine, into the center of the bottom spring until fully seated.
9. Press divider/spring guide until floor plate has room to be re-inserted.
10. Slide floor plate until it's fully engaged with the magazine body. Note: Ensure gray spring guide base is visible through hole in floor plate.

Illustration 1

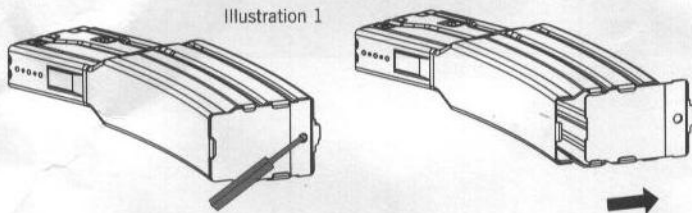

Internal Component List:

1. Two-column follower
2. Spring for two-column follower
3. Four-column follower
4. Top spring for four-column follower
5. Spring cup
6. Bottom spring for four-column follower
7. Divider/spring guide
8. Floor plate

Illustration 2

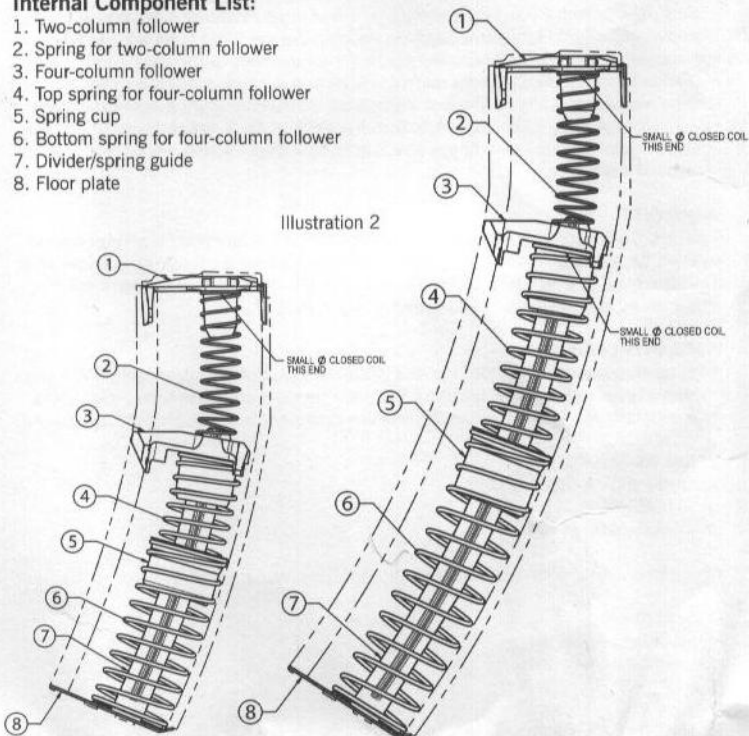

MAG5-60

MAG5-100