

INSPECTION

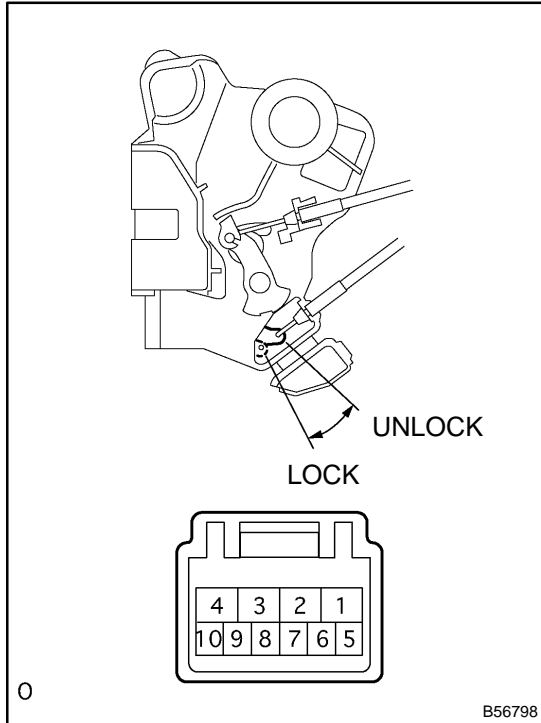

1. INSPECT DRIVER'S DOOR LOCK

(a) Inspect the door lock motor operation.

Standard:

Measuring condition	Operation
Battery positive (+) Terminal - 4 Battery negative (-) Terminal - 1	Lock
Battery positive (+) Terminal - 1 Battery negative (-) Terminal - 4	Unlock

If the result is not as specified, replace the door lock assembly.

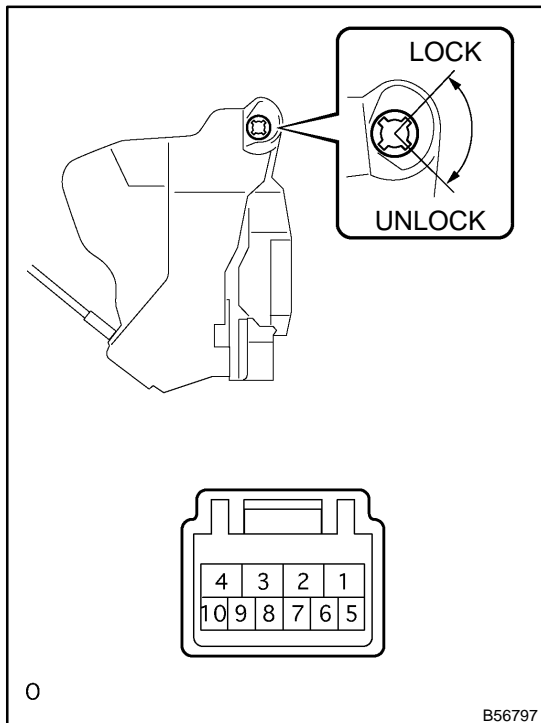

(b) Inspect the door lock and unlock switch continuity.

Standard:

Door lock position	Terminal No.	Specified condition
Lock	7 ↔ 9	Continuity
OFF	-	-
Unlock	7 ↔ 10	Continuity

If the result is not as specified, replace the door lock assembly.

(c) Inspect the position switch continuity.

Standard:

Door lock position	Terminal No.	Specified condition
Lock	7 ↔ 8	No continuity
OFF	-	-
Unlock	7 ↔ 8	Continuity

If the result is not as specified, replace the door lock assembly.

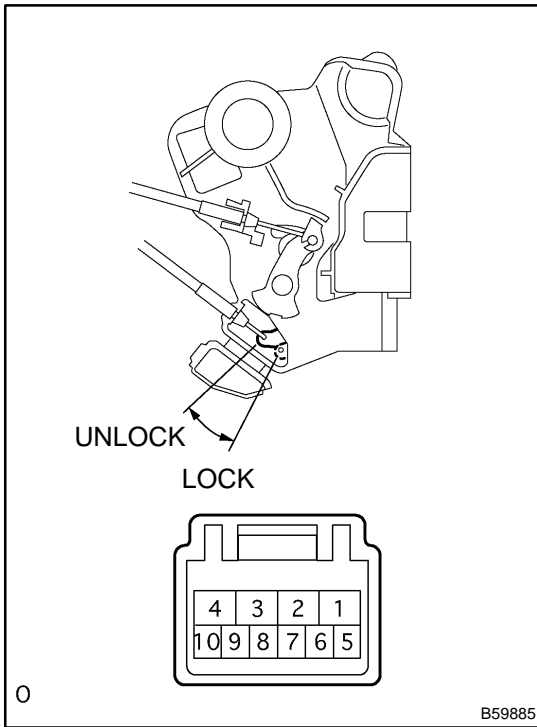

2. INSPECT PASSENGER'S DOOR LOCK

(a) Inspect the door lock motor operation.

Standard:

Measuring condition	Operation
Battery positive (+) Terminal – 4 Battery negative (–) Terminal – 1	Lock
Battery positive (+) Terminal – 1 Battery negative (–) Terminal – 4	Unlock

If the result is not as specified, replace the door lock assembly.

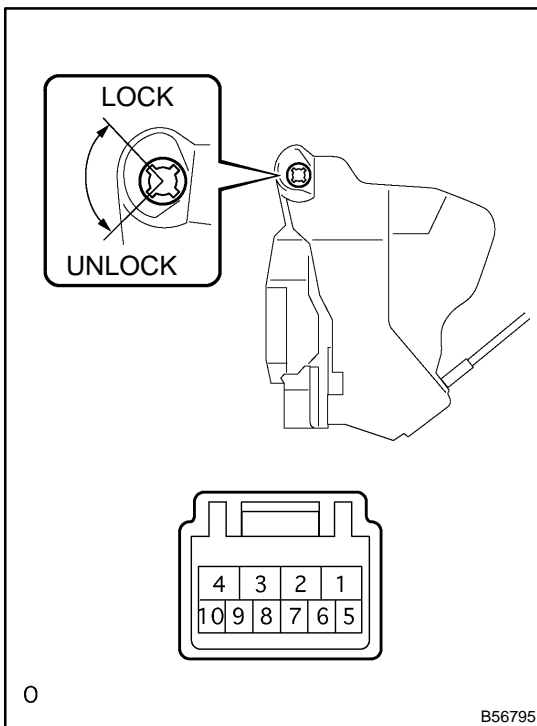

(b) Inspect the door lock and unlock switch continuity.

Standard:

Door lock position	Terminal No.	Specified condition
Lock	6 ↔ 8	Continuity
OFF	–	–
Unlock	5 ↔ 8	Continuity

If the result is not as specified, replace the door lock assembly.

(c) Inspect the position switch continuity.

Standard:

Door lock position	Terminal No.	Specified condition
Lock	7 ↔ 8	No continuity
OFF	–	–
Unlock	7 ↔ 8	Continuity

If the result is not as specified, replace the door lock assembly.

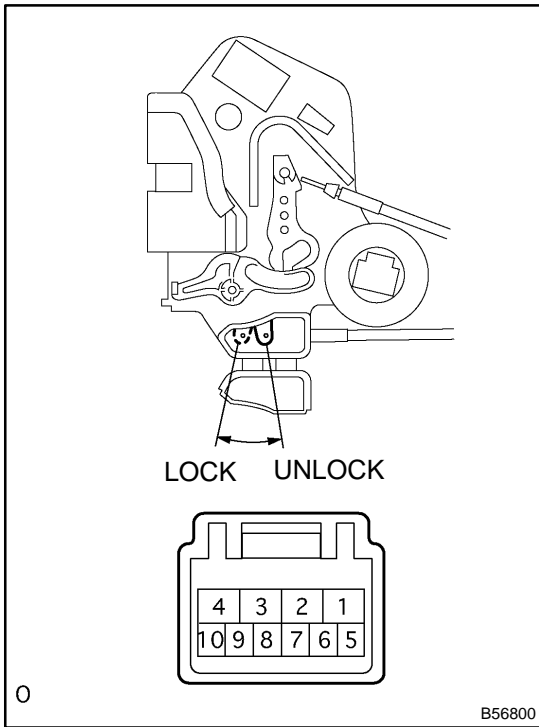

3. INSPECT REAR DOOR LOCK LH

(a) Inspect the door lock motor operation.

Standard:

Measuring condition	Operation
Battery positive (+) Terminal - 4 Battery negative (-) Terminal - 1	Lock
Battery positive (+) Terminal - 1 Battery negative (-) Terminal - 4	Unlock

If the result is not as specified, replace the door lock assembly.

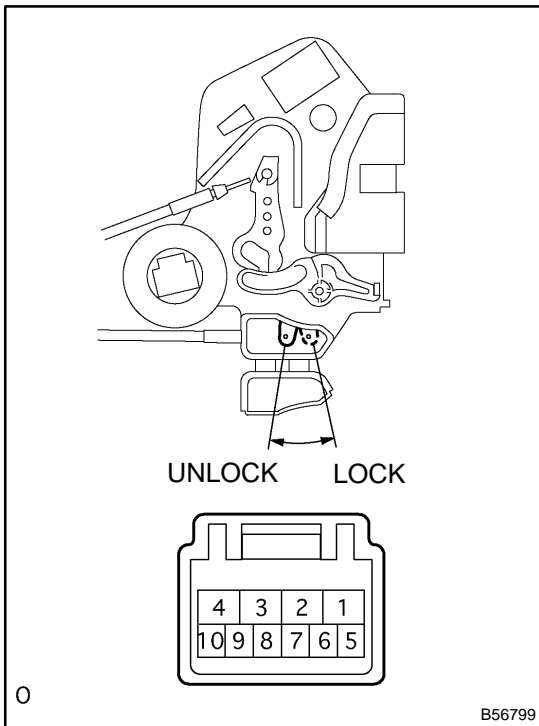

4. INSPECT REAR DOOR LOCK RH

(a) Inspect the door lock motor operation.

Standard:

Measuring condition	Operation
Battery positive (+) Terminal - 4 Battery negative (-) Terminal - 1	Lock
Battery positive (+) Terminal - 1 Battery negative (-) Terminal - 4	Unlock

If the result is not as specified, replace the door lock assembly.

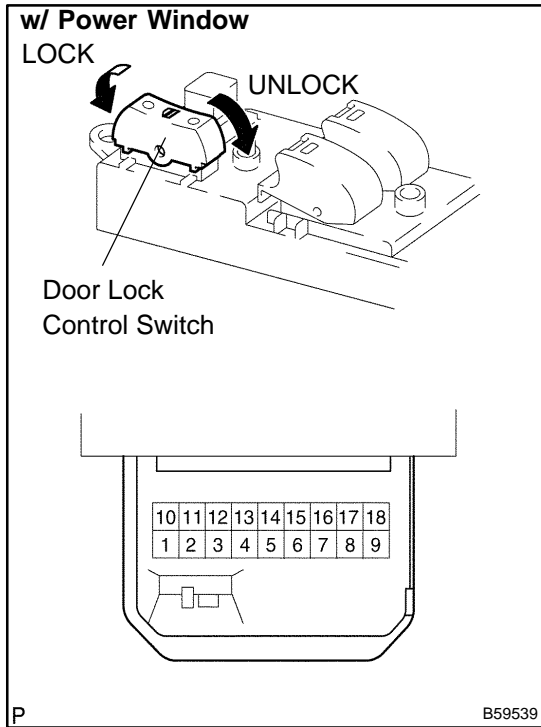

5. INSPECT POWER WINDOW REGULATOR MASTER SWITCH ASSY

- (a) w/ Power window:
Inspect the door lock control switch continuity.

Standard:

Switch position	Terminal No.	Specified condition
Lock	1 ↔ 3 ↔ 5	Continuity
OFF	–	No continuity
Unlock	1 ↔ 3 ↔ 8	Continuity

If the result is not as specified, replace the switch.

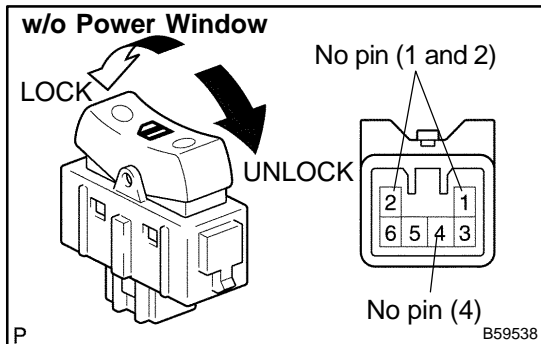

- (b) w/o Power window:
Inspect the door lock control switch continuity.

Standard:

Switch position	Terminal No.	Specified condition
Lock	3 ↔ 6	Continuity
OFF	–	No continuity
Unlock	3 ↔ 5	Continuity

If the result is not as specified, replace the switch.

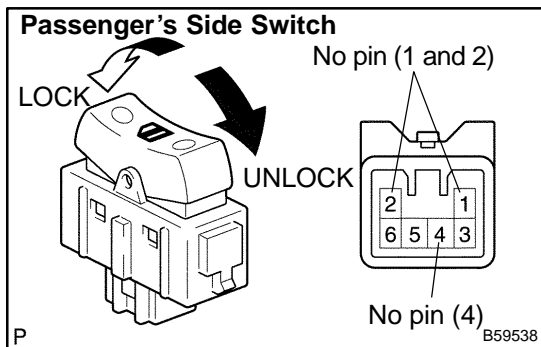

6. INSPECT DOOR CONTROL SWITCH ASSY

- (a) Passenger's side switch:
Inspect the door lock control switch continuity.

Standard:

Switch position	Tester connection	Specified condition
Lock	3 ↔ 6	Continuity
OFF	–	No continuity
Unlock	3 ↔ 5	Continuity

If the result is not as specified, replace the switch.