

FRONT NO.1 SPEAKER ASSY REPLACEMENT

670E0-01

HINT:

COMPONENTS: See page 67-1

1. REMOVE FRONT ARMREST ASSY LH(See page 75-7)
2. REMOVE POWER WINDOW REGULATOR MASTER SWITCH ASSY (W/ POWER WINDOW)
(See page 75-7)
3. REMOVE FRONT ARMREST BASE PANEL UPPER LH (W/O POWER WINDOW)
(See page 75-7)
4. REMOVE FRONT DOOR WINDOW REGULATOR HANDLE ASSY (W/O POWER WINDOW)
(See page 75-7)
5. REMOVE FRONT DOOR LOWER FRAME BRACKET GARNISH LH(See page 75-7)
6. REMOVE FRONT DOOR TRIM BOARD SUB-ASSY LH(See page 75-7)

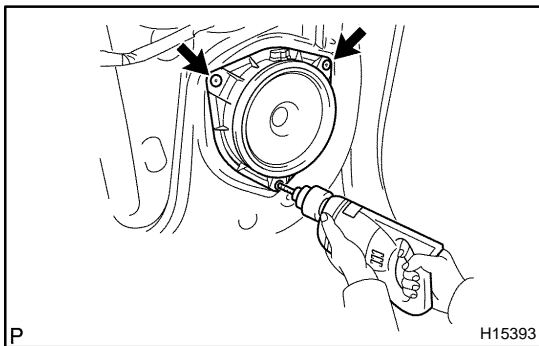

7. REMOVE FRONT NO.1 SPEAKER ASSY

- (a) Disconnect the connector.
- (b) Using a rivet cutter and air drill, drill out the rivets and remove the front No.1 speaker assy.

NOTICE:

- Prizing the hole with a drill can lead to damage to the rivet hole or breaking the drill.
- Take care as the cut rivet is hot.

HINT:

Even if flange is taken off, continue drilling and push out remaining fragments with the drill.

- (c) Using a vacuum cleaner, remove the drilled rivet and their dust from the inside of the door.

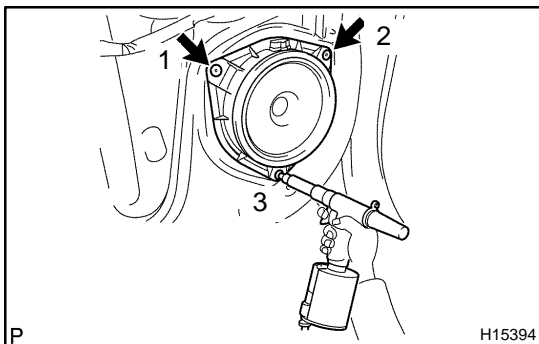

8. INSTALL FRONT NO.1 SPEAKER ASSY

- (a) Using an air riveter and nose piece No.1, strike rivets into the door panel to install the front No.1 speaker assy to the door panel.

NOTICE:

Install them in the order shown in the illustration.

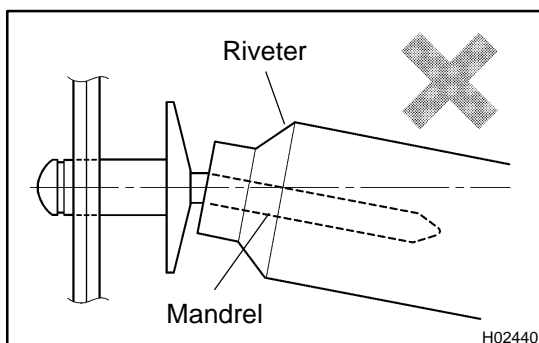

NOTICE:

- Do not prize a riveter, as riveter is damaged, it is not tightened and the mandrel is bent.

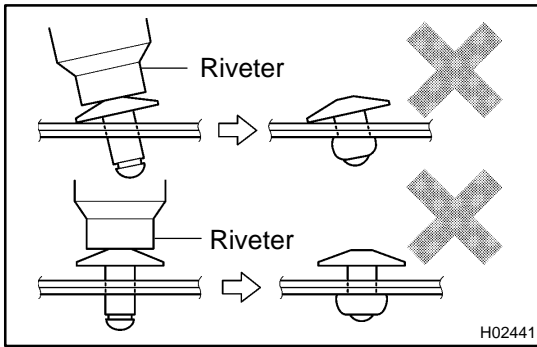

- Do not tilt the riveter and disconnect the rivet from the material while handling a riveter, as the materials are not tightened firmly.

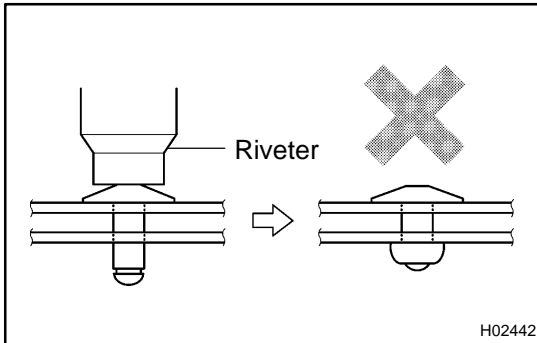

- Install the rivet while attaching materials, as they are not tightened firmly.
- (b) Connect the connector.

9. INSTALL FRONT DOOR WINDOW REGULATOR HANDLE ASSY (W/O POWER WINDOW)
 (See page [75-7](#))