

## REPLACEMENT

### HINT:

For parking brake cable assy No.2, perform the same procedure to the parking brake cable assy No.3.

1. REMOVE REAR WHEEL
2. REMOVE REAR BRAKE DRUM SUB-ASSY (See page 32-31)
3. REMOVE REAR BRAKE AUTOMATIC ADJUST LEVER LH (See page 32-31)
4. REMOVE FRONT BRAKE SHOE (See page 32-31)  
SST 09718-00010
5. REMOVE PARKING BRAKE SHOE STRUT SET LH (See page 32-31)
6. REMOVE REAR BRAKE SHOE (See page 32-31)  
SST 09718-00010

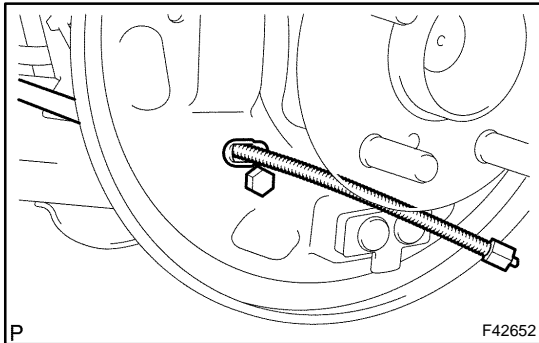

7. DISCONNECT PARKING BRAKE CABLE ASSY NO.3
  - (a) Remove the bolt, and disconnect the parking brake cable assy No.3 from the backing plate.

8. REMOVE EXHAUST PIPE ASSY FRONT (See page 15-2)
9. REMOVE FRONT FLOOR HEAT INSULATOR NO.1 (See page 33-7)
10. REMOVE FRONT FLOOR HEAT INSULATOR NO.2 (See page 33-7)
11. REMOVE FUEL TANK PROTECTOR NO.1
  - (a) Remove the 5 nuts and fuel tank protector No.1.

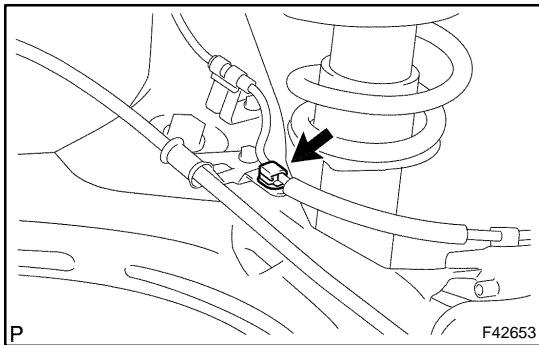

12. REMOVE PARKING BRAKE CABLE ASSY NO.3
  - (a) Using a clip remover, disconnect the skid control sensor wire harness clip from the clamp.
  - (b) Remove the 4 bolts and cable retainer from the body.
  - (c) Disconnect the parking brake cable assy No.3 from the equalizer, and remove the parking brake cable assy No.3.
13. INSTALL PARKING BRAKE CABLE ASSY NO.3
  - (a) Connect the parking brake cable assy No.3 to the equalizer.

- (b) Install the parking brake cable assy No.3 with the 4 bolts and cable retainer.

**Torque: 5.4 N·m (55 kgf·cm, 48 in·lbf)**

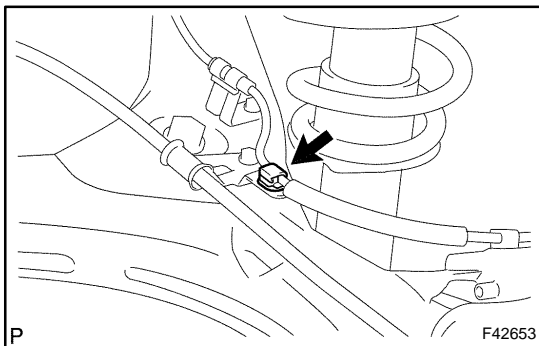
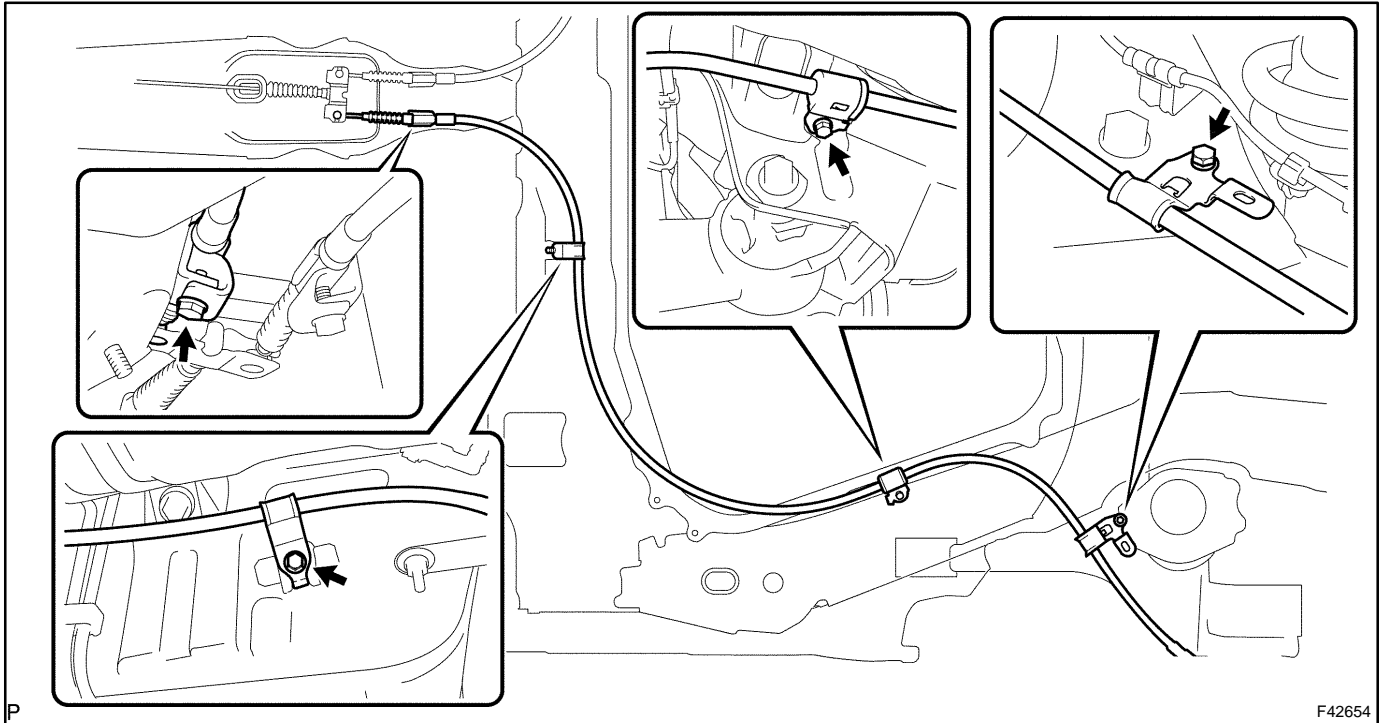

- (c) Connect the skid control sensor wire harness clip to the clamp.

**14. INSTALL FUEL TANK PROTECTOR NO.1**

- (a) Install the fuel tank protector No.1 with the 5 nuts.

**Torque: 5.5 N·m (55 kgf·cm, 48 in·lbf)**

**15. INSTALL FRONT FLOOR HEAT INSULATOR NO.2 (See page 33-7)**

**16. INSTALL FRONT FLOOR HEAT INSULATOR NO.1 (See page 33-7)**

**17. INSTALL EXHAUST PIPE ASSY FRONT (See page 15-2)**

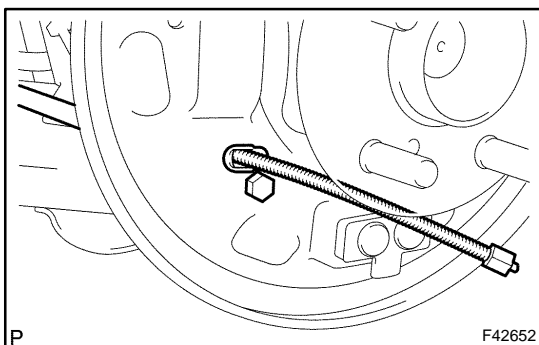

**18. CONNECT PARKING BRAKE CABLE ASSY NO.3**

- (a) Connect the parking brake cable assy No.3 to the backing plate with the bolt.

**Torque: 7.8 N·m (80 kgf·cm, 69 in·lbf)**

19. **APPLICATION HIGH TEMPERATURE GREASE (See page 32-31)**
20. **INSTALL REAR BRAKE SHOE (See page 32-31)**  
SST 09718-00010
21. **INSTALL PARKING BRAKE SHOE STRUT SET LH (See page 32-31)**
22. **INSTALL FRONT BRAKE SHOE (See page 32-31)**  
SST 09718-00010
23. **INSTALL REAR BRAKE AUTOMATIC ADJUST LEVER LH (See page 32-31)**
24. **CHECK REAR DRUM BRAKE INSTALLATION (See page 32-31)**
25. **INSTALL REAR BRAKE DRUM SUB-ASSY**
26. **ADJUST REAR DRUM BRAKE SHOE CLEARANCE (See page 32-31)**
27. **INSTALL REAR WHEEL**  
Torque: 103 N·m (1,050 kgf·cm, 76 ft·lbf)
28. **INSPECT PARKING BRAKE LEVER TRAVEL (See page 33-2)**
29. **ADJUST PARKING BRAKE LEVER TRAVEL (See page 33-2)**
30. **CHECK EXHAUST LEAKAGE**