

FRONT AXLE LH HUB BOLT REPLACEMENT

300A5-02

HINT:

COMPONENTS: See page 30-16

1. REMOVE FRONT WHEEL
2. SEPARATE FRONT DISC BRAKE CALIPER ASSY LH (See page 30-17)
3. REMOVE FRONT DISC

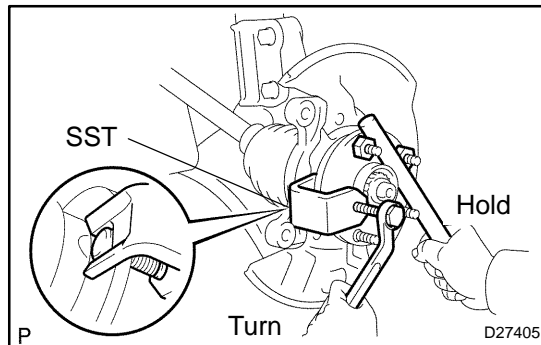

4. REMOVE FRONT AXLE LH HUB BOLT

- (a) Using SST and a hammer handle or an equivalent, remove the LH hub bolt.
SST 09628-10011

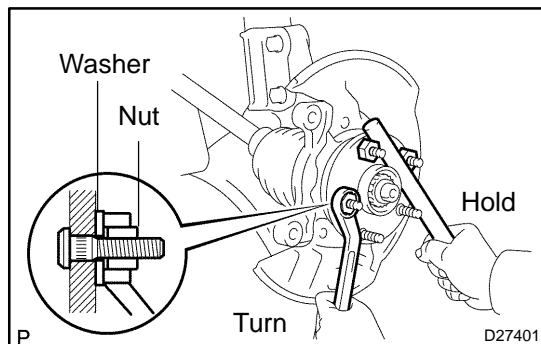

5. INSTALL FRONT AXLE LH HUB BOLT

- (a) Install a washer and nut to a new LH hub bolt as shown in the illustration.
- (b) Using a hammer handle or an equivalent to hold the hub sub-assy LH, install the LH hub bolt by tightening the nut.

6. INSTALL FRONT DISC
7. INSTALL FRONT DISC BRAKE CALIPER ASSY LH (See page 30-17)
8. INSTALL FRONT WHEEL
Torque: 103 N·m (1,050 kgf·cm, 76 ft·lbf)