

# STABILIZER BAR FRONT

## REPLACEMENT

2607Z-01

HINT:

COMPONENTS: See page 26-3

### 1. REMOVE FRONT WHEEL

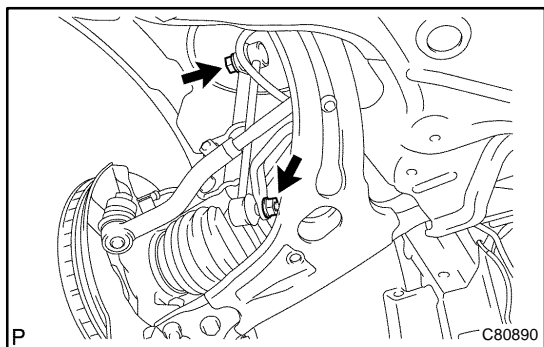

### 2. REMOVE FRONT STABILIZER LINK ASSY LH

(a) Remove the 2 nuts and stabilizer bar link.

HINT:

If the ball joint turns together with the nut, use a hexagon wrench (6 mm) to hold the stud.

### 3. REMOVE FRONT STABILIZER LINK ASSY RH

HINT:

Remove the RH side by the same procedure as the LH side.

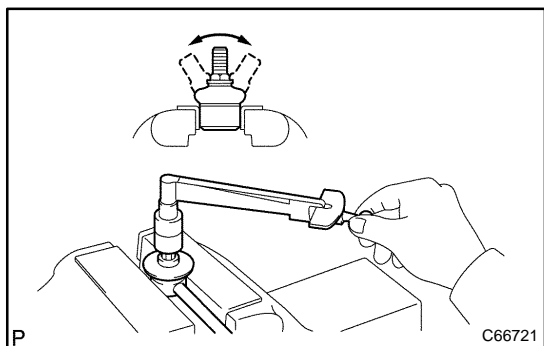

### 4. INSPECT FRONT STABILIZER LINK ASSY

(a) As shown in the illustration, flip the ball joint stud back and forth 5 times, before installing the nut.

(b) Using a torque wrench, turn the nut continuously at a rate of 2 – 4 seconds per 1 turn and take the torque reading on the 5th turn.

**Turning torque:****0.05 – 1.96 N·m (0.5 – 20 kgf·cm, 0.4 – 17 in.-lbf)**

### 5. SEPARATE FRONT SUSPENSION ARM SUB-ASSY LOWER NO.1 LH(See page 26-13)

### 6. SEPARATE FRONT SUSPENSION ARM SUB-ASSY LOWER NO.1 RH

HINT:

Remove the RH side by the same procedure as the LH side.

### 7. SEPARATE RACK & PINION POWER STEERING GEAR ASSY(See page 26-13)

### 8. SUSPEND ENGINE ASSY

AT: (See page 40-9)

MT: (See page 41-17)

### 9. SEPARATE FRONT SUSPENSION CROSSMEMBER SUB-ASSY(See page 26-13)

### 10. REMOVE STABILIZER BAR FRONT

(a) Remove the 4 bolts, front stabilizer bracket No.1 LH, front stabilizer bracket No.1 RH, 2 front stabilizer bar bushes No.1 and stabilizer bar front from the front suspension crossmember sub-assy.

(b) Remove the 2 front stabilizer bar bushes No.1 from the stabilizer bar front.

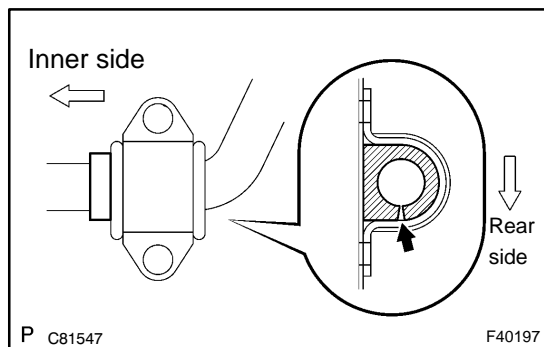

### 11. INSTALL STABILIZER BAR FRONT

- (a) Install 2 front stabilizer bar bushes No.1, front stabilizer bracket No.1 LH and front stabilizer bracket No.1 RH to the stabilizer bar front.

#### HINT:

Install the bushing to the inner side of the bushing stopper on the stabilizer bar.

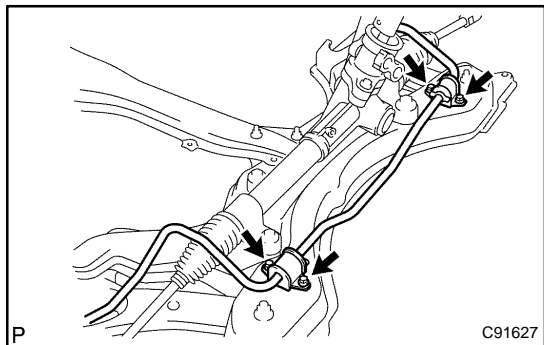

- (b) Install the stabilizer bar front and 4 bolts to the front suspension crossmember sub-assy.

**Torque: 19 N·m (194 kgf·cm, 14 ft·lbf)**

### 12. INSTALL FRONT SUSPENSION CROSSMEMBER SUB-ASSY(See page 26-13)

SST 09670-00010

### 13. INSTALL RACK & PINION POWER STEERING GEAR ASSY(See page 26-13)

### 14. INSTALL FRONT SUSPENSION ARM SUB-ASSY LOWER NO.1 LH(See page 26-13)

### 15. INSTALL FRONT SUSPENSION ARM SUB-ASSY LOWER NO.1 RH

#### HINT:

Install the RH side by the same procedures as the LH side.

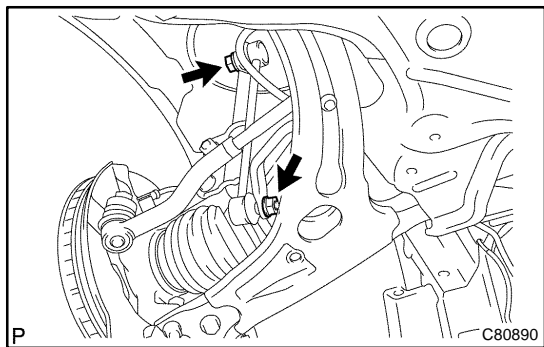

### 16. INSTALL FRONT STABILIZER LINK ASSY LH

- (a) Install the stabilizer bar link with the 2 nuts.

**Torque: 74 N·m (755 kgf·cm, 55 ft·lbf)**

#### HINT:

If the ball joint turns together with the nut, use a hexagon wrench (6 mm) to hold the stud.

### 17. INSTALL FRONT STABILIZER LINK ASSY LH

#### HINT:

Install the RH side by the same procedure as the LH side.

### 18. INSTALL FRONT WHEEL

**Torque: 103 N·m (1,050 kgf·cm, 76 ft·lbf)**

### 19. INSPECT AND ADJUST FRONT WHEEL ALIGNMENT(See page 26-5)