

# LOWER BALL JOINT ASSY FRONT LH REPLACEMENT

2607Y-04

HINT:

COMPONENTS: See page 26-3

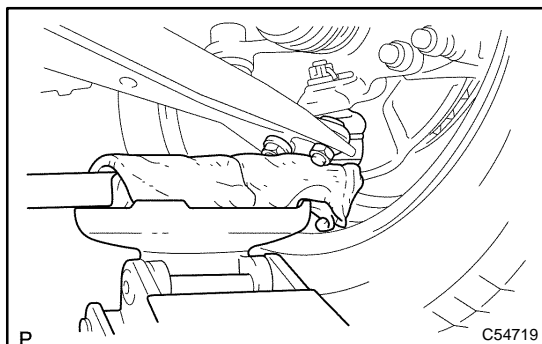

1. **INSPECT LOWER BALL JOINT ASSY FRONT LH**
  - (a) Jack up front side of the vehicle.
  - (b) Check the rattle of the lower ball joint assy front LH.

2. **REMOVE FRONT WHEEL**
3. **REMOVE FRONT AXLE HUB LH NUT(See page 30-6)**  
SST 09930-00010
4. **DISCONNECT SPEED SENSOR FRONT LH (W/ ABS)(See page 30-6)**
5. **SEPARATE TIE ROD END SUB-ASSY LH(See page 30-6)**  
SST 09628-62011
6. **SEPARATE FRONT SUSPENSION ARM SUB-ASSY LOWER NO.1 LH(See page 30-6)**
7. **SEPARATE FRONT AXLE ASSY LH(See page 30-6)**

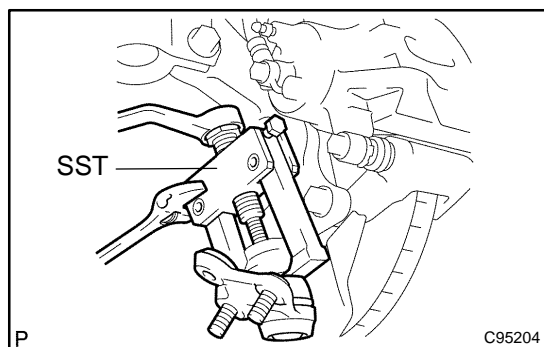

8. **REMOVE LOWER BALL JOINT ASSY FRONT LH**
  - (a) Remove the cotter pin and castle nut.
  - (b) Using SST, remove the lower ball joint assy from the steering knuckle LH.  
SST 09628-62011

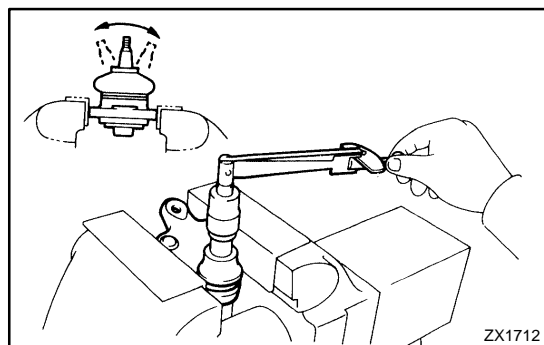

9. **INSPECT LOWER BALL JOINT ASSY FRONT LH**
  - (a) As shown in the illustration, flip the ball joint stud back and forth 5 times, before installing the nut.
  - (b) Using a torque wrench, turn the nut continuously at a rate of 3 - 5 seconds per 1 turn and take the torque reading on the 5th turn.

**Turning torque:****0.98 - 4.9 N·m (10 - 50 kgf·cm, 8.7 - 43 in.·lbf)**

**10. INSTALL LOWER BALL JOINT ASSY FRONT LH**

(a) Install the lower ball joint assy front LH to the steering knuckle LH, tighten the castle nut.  
**Torque: 103 N·m (1050 kgf·cm, 76 ft·lbf)**

(b) Install a new cotter pin.

**11. INSTALL FRONT AXLE ASSY LH(See page 30-6)****12. INSTALL FRONT SUSPENSION ARM SUB-ASSY LOWER NO.1 LH(See page 30-6)****13. INSTALL TIE ROD END SUB-ASSY LH(See page 30-6)****14. INSTALL SPEED SENSOR FRONT LH (W/ ABS)(See page 30-6)****15. INSTALL FRONT AXLE HUB LH NUT(See page 30-6)**

SST 09931-00020

**16. INSTALL FRONT WHEEL**

**Torque: 103 N·m (1,050 kgf·cm, 76 ft·lbf)**

**17. INSPECT AND ADJUST FRONT WHEEL ALIGNMENT(See page 26-5)****18. CHECK ABS SPEED SENSOR SIGNAL (W/ ABS)(See page 05-297)**