

ECM (1ZZ-FE) (April, 2003)

REPLACEMENT

100HN-02

1. DISCONNECT BATTERY NEGATIVE TERMINAL
2. REMOVE GLOVE COMPARTMENT DOOR ASSY (See Page 71-10)

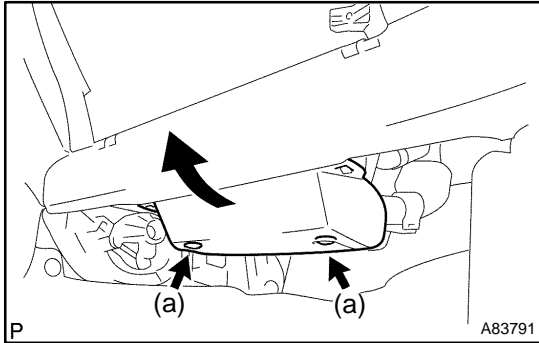

3. REMOVE ECM

- (a) Remove the 2 clips using a clip remover. Then, open the cover.

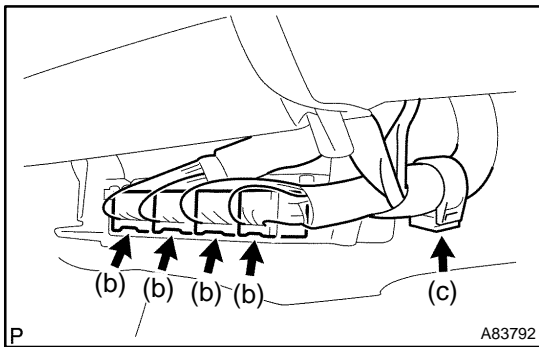

- (b) Disconnect the 4 ECM connectors.
- (c) Remove the wire harness from the wire harness clamp.

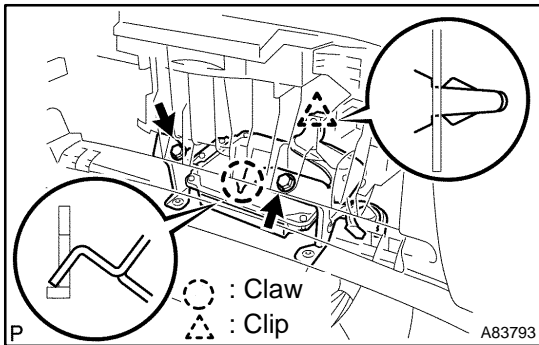

- (d) Remove the 2 bolts.
- (e) Unfasten the claw and clip, then remove the ECM.

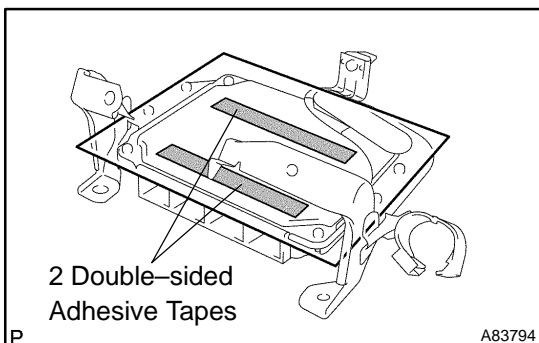

4. REMOVE ECM COVER

- (a) Take the 2 double-sided adhesive tapes off the ECM, then remove the ECM cover.

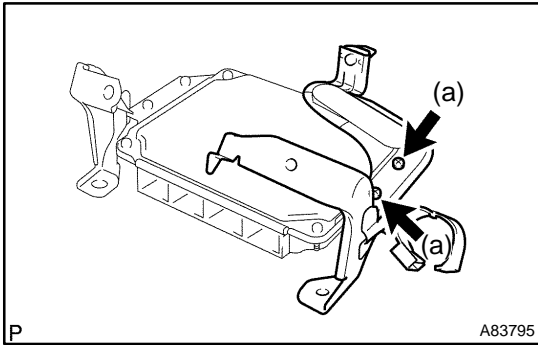

- 5. REMOVE ECM BRACKET NO.2 (DENSO MADE)**
 (a) Remove the 2 screws, then remove the ECM bracket No. 2.

- 6. REMOVE ECM BRACKET NO.1**
 (a) Remove the 2 screws, then remove the ECM bracket No. 1.

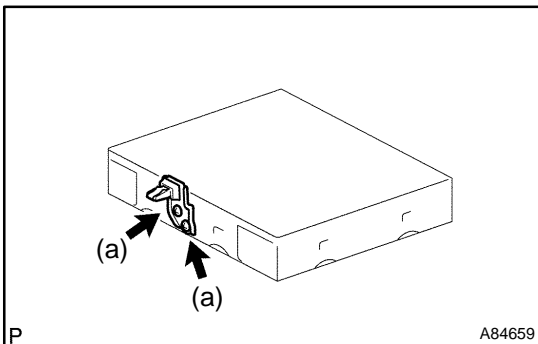
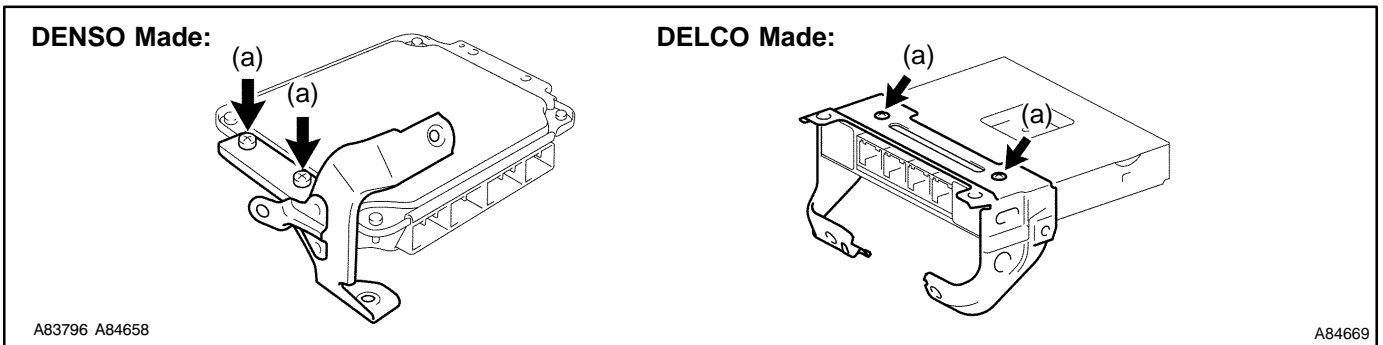

- 7. REMOVE ECM BRACKET NO.3 (DELCO MADE)**
 (a) Remove the 2 screws, then remove the ECM bracket No. 3.

- 8. INSTALL ECM BRACKET NO.3 (DELCO MADE)**
 Torque: 3.2 N·m (33 kgf·cm, 28 in.·lbf)
9. INSTALL ECM BRACKET NO.1
 Torque: 3.2 N·m (33 kgf·cm, 28 in.·lbf)
10. INSTALL ECM BRACKET NO.2 (DENSO MADE)
 Torque: 3.2 N·m (33 kgf·cm, 28 in.·lbf)

11. INSTALL ECM COVER

- (a) Install a new ECM cover to the ECM as shown in the illustration.

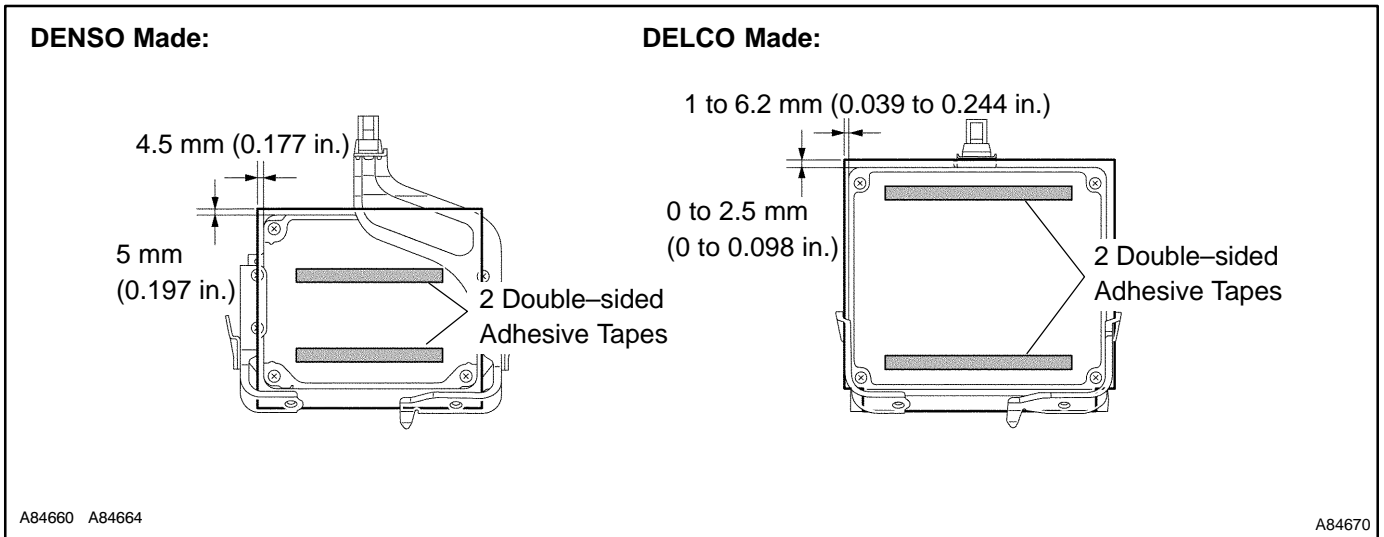

12. INSTALL ECM

Torque: 3.0 N·m (31 kgf·cm, 27 in·lbf)

13. INSTALL GLOVE COMPARTMENT DOOR ASSY

14. CONNECT BATTERY NEGATIVE TERMINAL

Torque: 5.4 N·m (55 kgf·cm, 48 in·lbf)

15. RESET MEMORY (A/T TRANSAXLE)

CAUTION:

Perform the **RESET MEMORY (AT initialization)** when replacing the ECM, engine assembly or automatic transaxle assembly.

- (a) The hand-held tester only.
 - (1) Connect the hand-held tester to the DLC3.
 - (2) Turn the ignition switch ON.
 - (3) Perform the RESET MEMORY procedure from the ENGINE menu.

CAUTION:

After performing the RESET MEMORY, be sure to perform the ROAD TEST as described earlier.