

DLASK SIG P228 BLUEPRINTS

These blueprints are for "Dlask" style cast steel, even though the blueprint states aluminum.

Please note that there are some hand drafted additions or modifications to my copies.

Page 2 of 10 Section K (cross section though lower grip panel screw boss), when compared to page 8 of 9 (detailed view K-K), The thread dimensions differ, real Sig would be M4 x 0.7. The parts kit from Dlask provides something near a M3 type thread.

Page 7 of 10, right most diagram rail dimensions seem to added.

Page 10 of 10, The magwell diagram (left diagram) has 4 ribs drafted in. These ribs serve to prevent the use of any Sig, Mecgar or other Hi-Cap mags. Removing them will allow the use of Pre-ban, Hi-Cap mags (as long as it is legal in your jurisdiction).

Matt

FILE

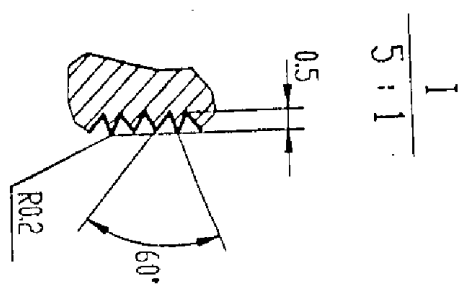
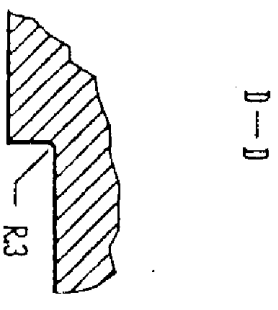
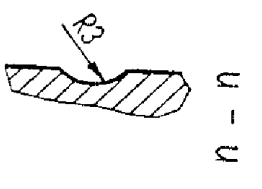
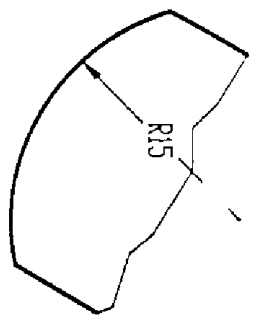
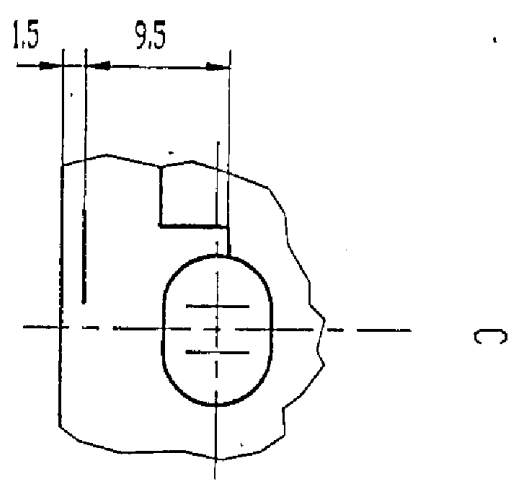
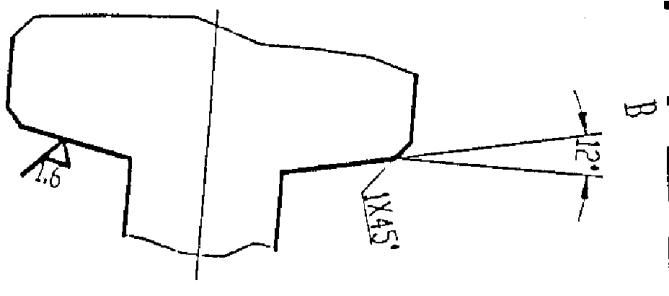

II
5:1

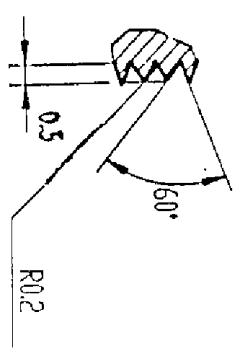

TITLE P 228

DATE Nov. 8. 95

DRAWN

APPROVED

MATERIAL AS56-76

SCALE

DRAWING NUMBER 8 of 9

FILE

E-E
10:1

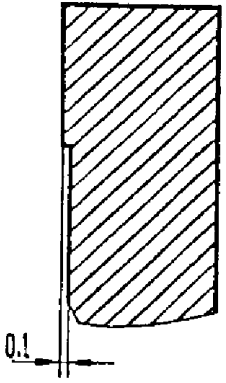

K-K
4:1

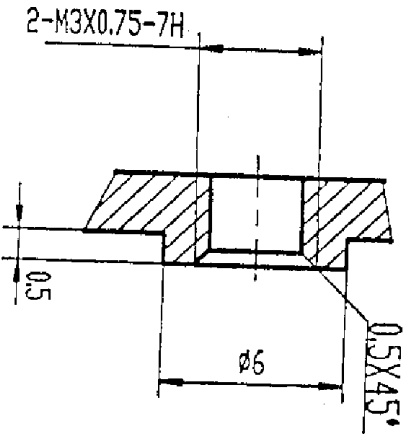

F-F

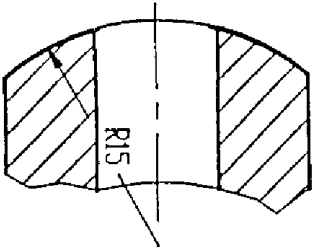

J-J

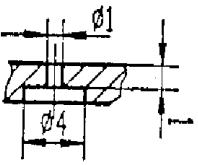

L-L

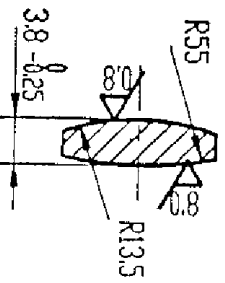

H-H

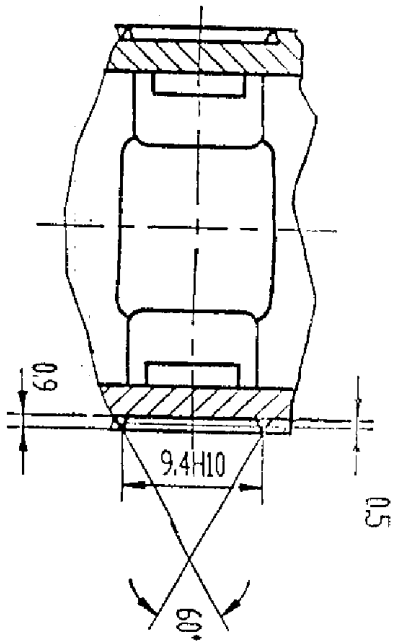

N-N

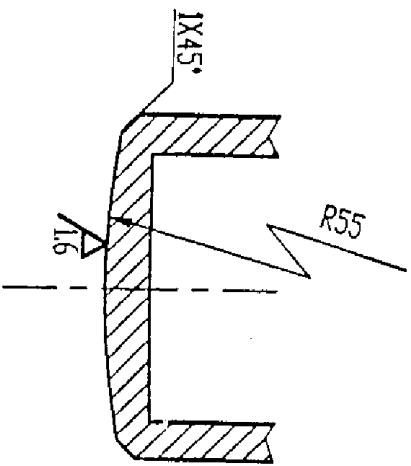

I-I

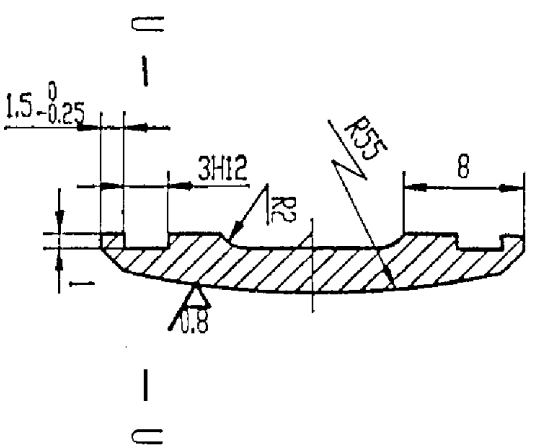

P-P

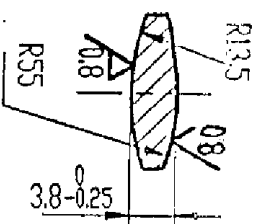

TITLE

P 228

DATE

3.8-0.25

DRAWN

APPROVED

MATERIAL

SCALE

7 of 9

DRAWING NUMBER

FILE

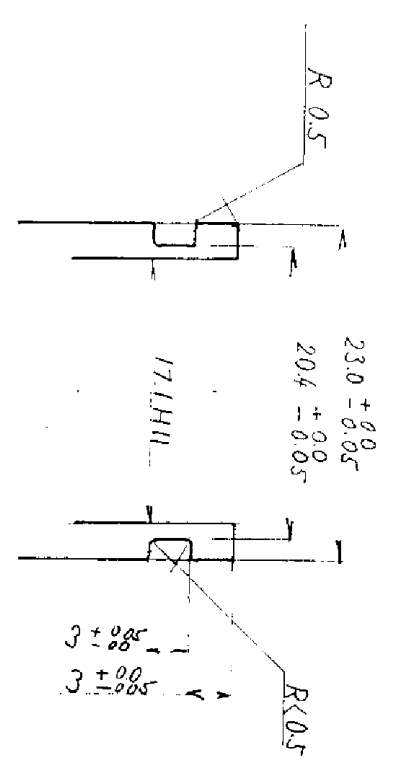
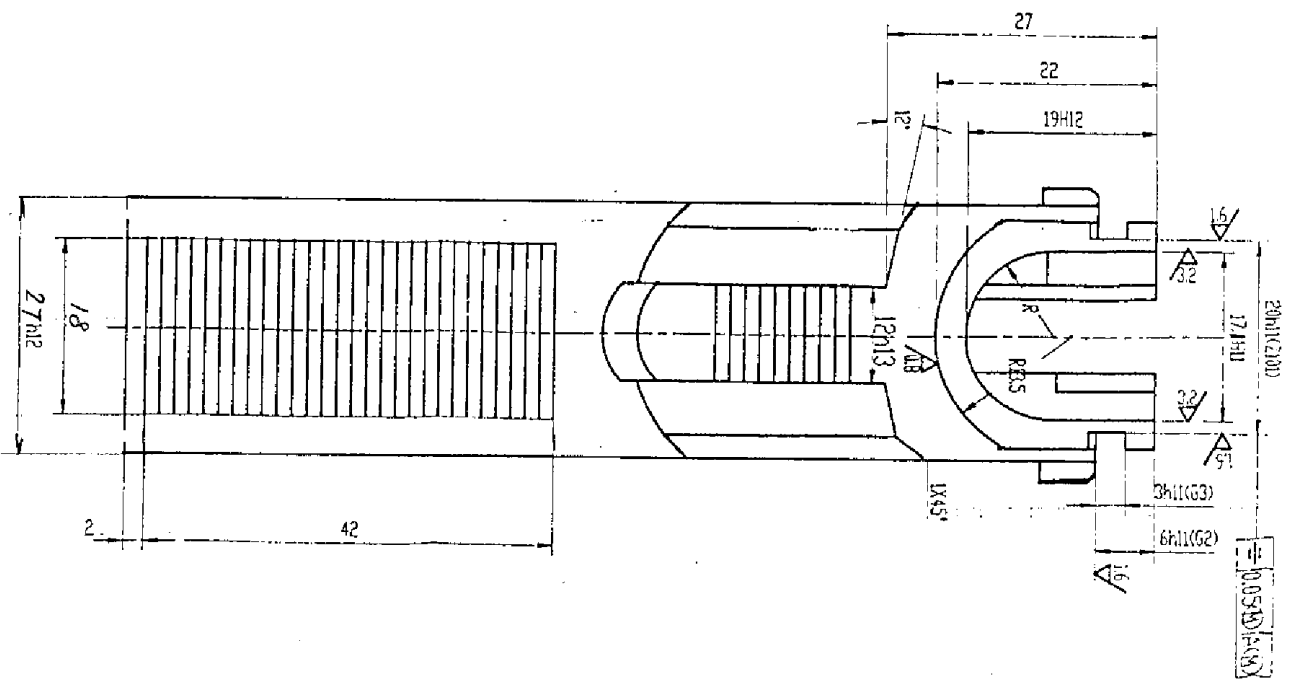
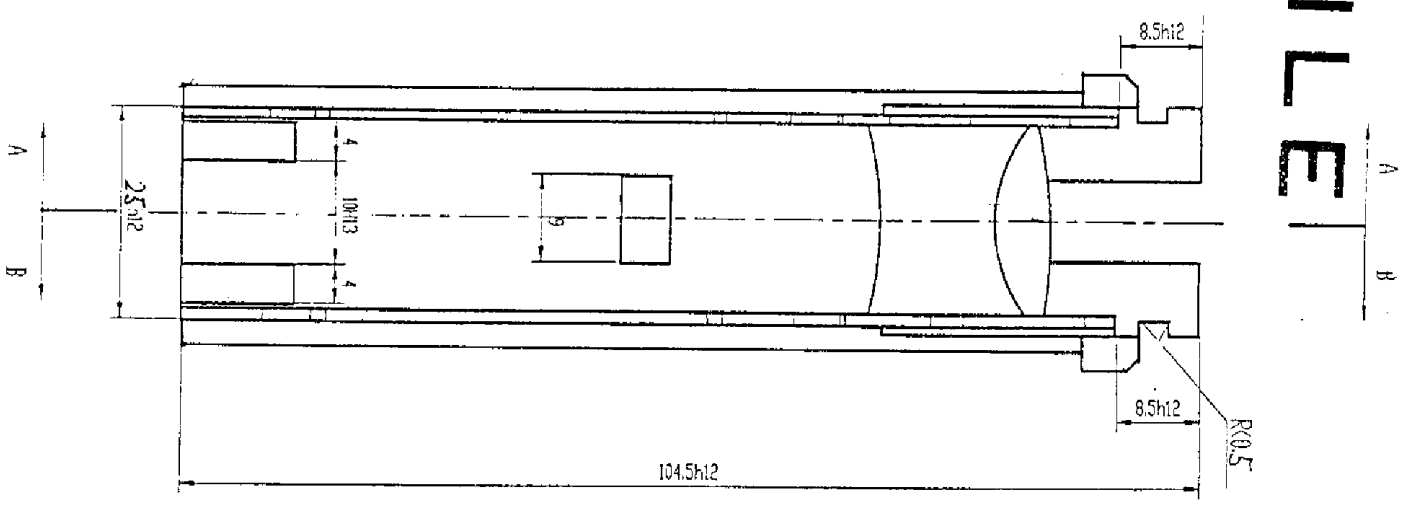

TITLE		P 228	
DATE	Mar 8 95	DRAWN	
APPROVED		MATERIAL	9856-76
SCALE		DRAWING NUMBER	6 of 9

FILE

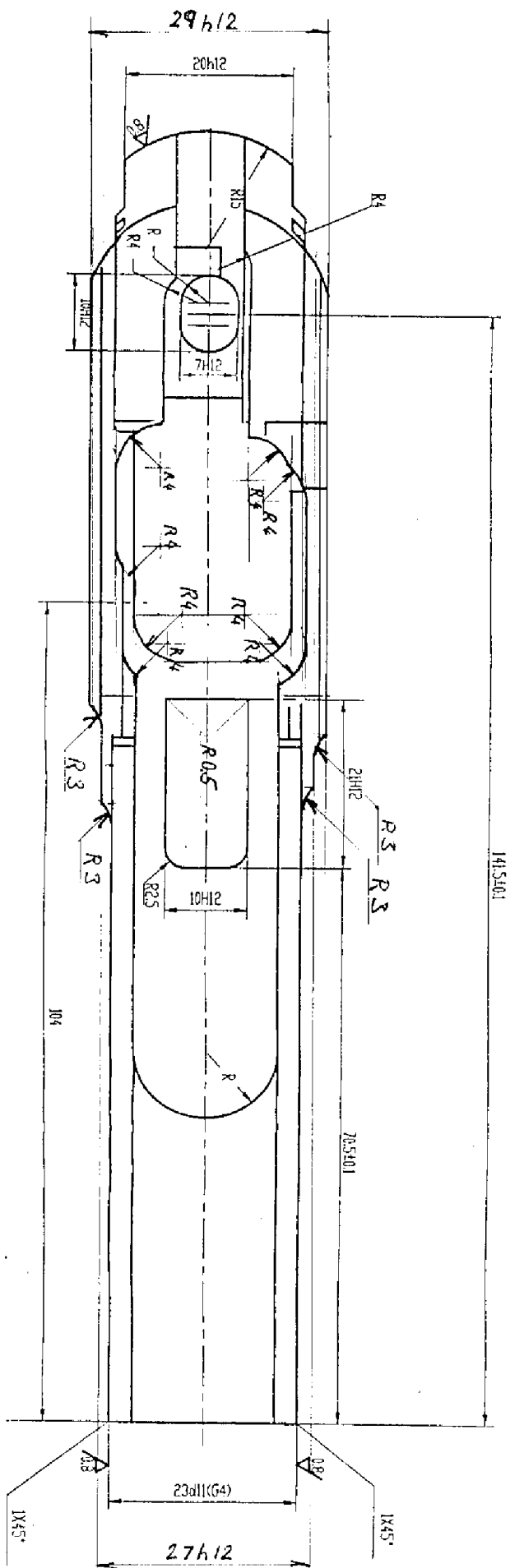

TITLE P 2228

DATE	DRAWN	APPROVED	MATERIAL	SCALE
Mar. 8. 05			A856-76	

S of 9

DRAWING NUMBER

FILE

A - A

150.5

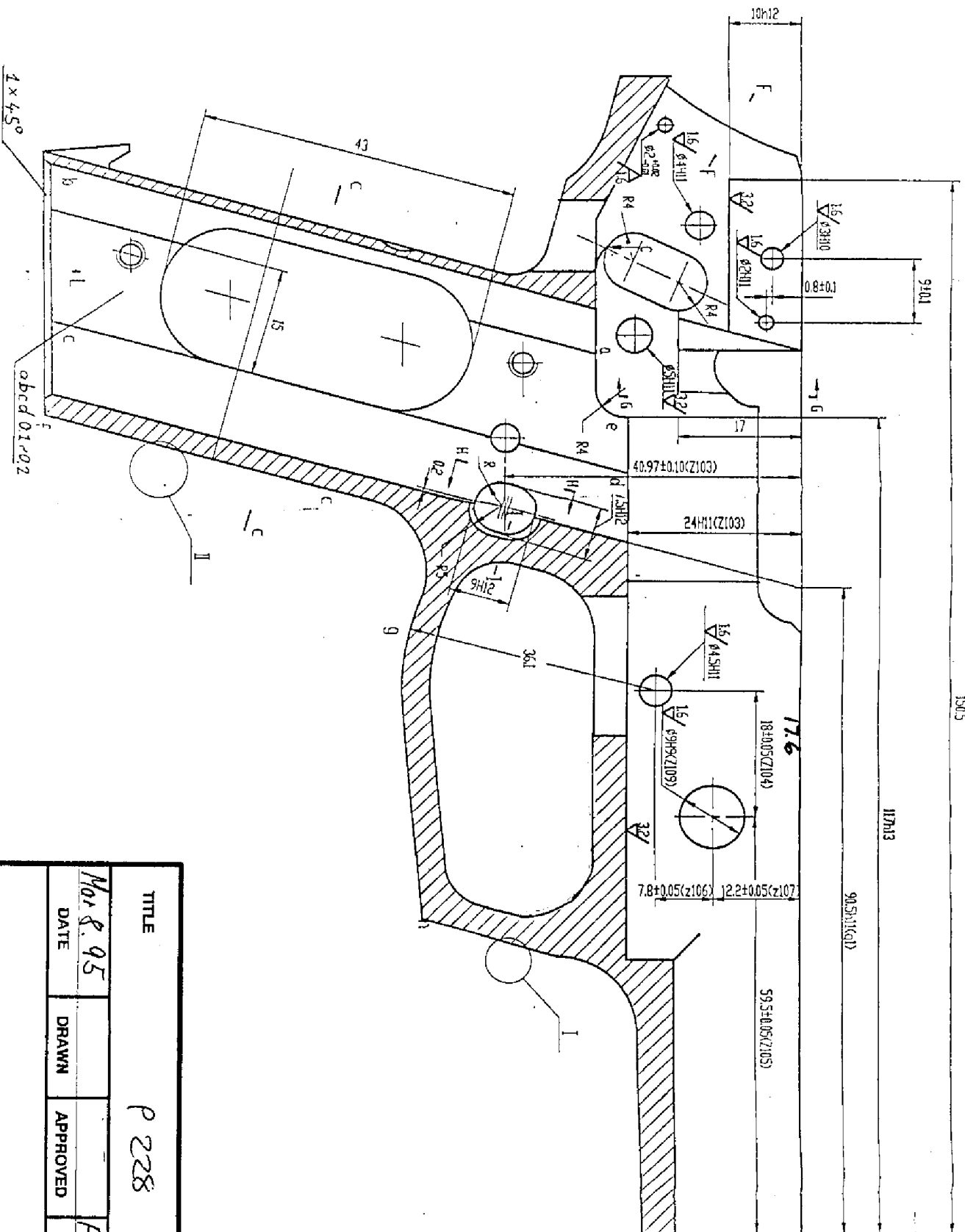

TITLE		P 228		
DATE	DRAWN	APPROVED	MATERIAL	SCALE
Nov 8. 95			A356-T6	
DRAWING NUMBER				4 of 9

FILE

B - B

6.3

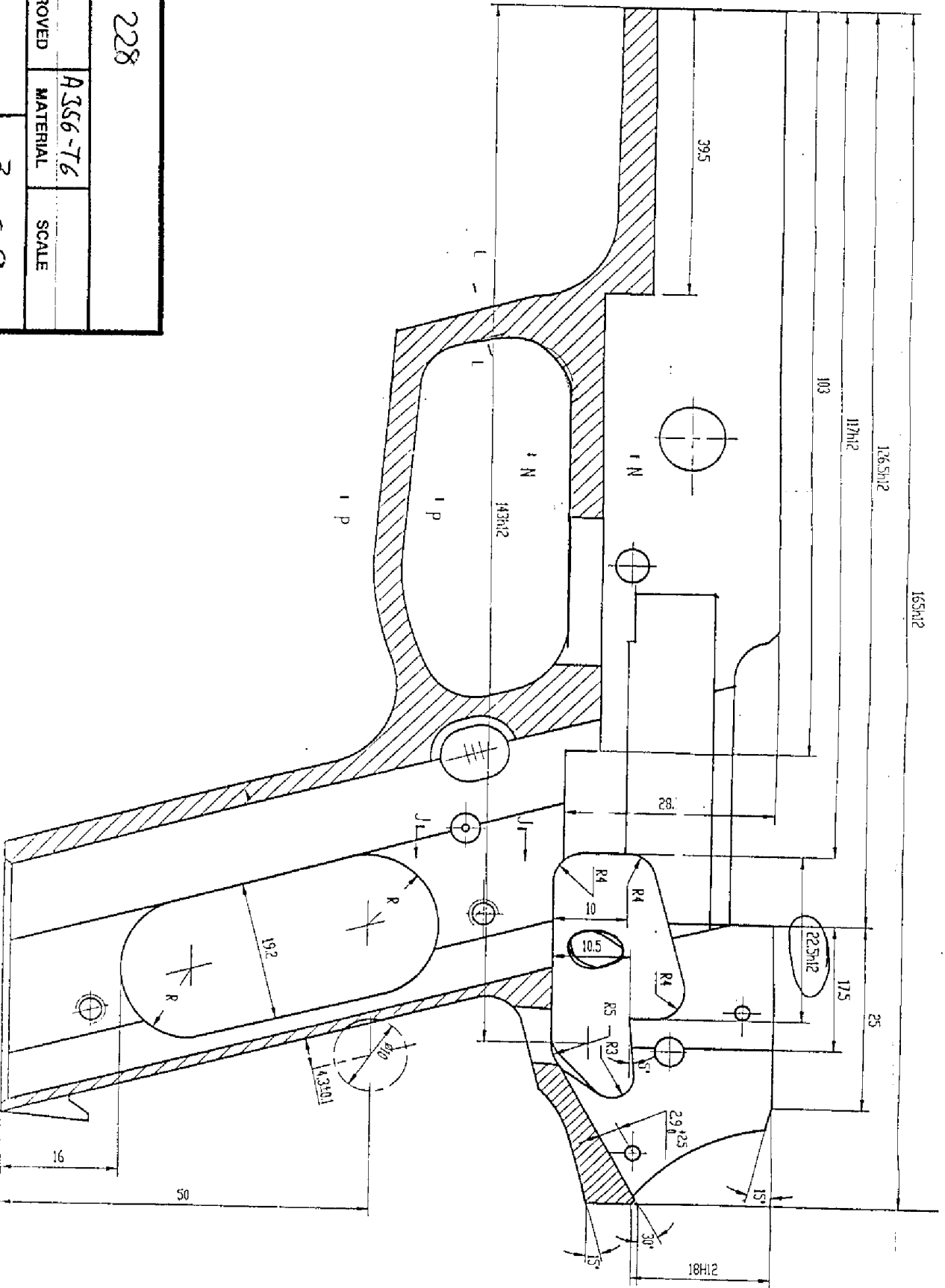

TITLE		P 228	
DATE	DRAWN	APPROVED	MATERIAL
Nov 8 95			A 356-T6
			SCALE
	DRAWING NUMBER		3 of 9

FILE

136±0.2

130±0.3

128±0.2

82±0.2

15

17.5

9.5

17±0.2

13

33

27

4

0

42±0.1

24

45°

0.7

2.1

R4

11.0±0.2

25±0.1

32.5±0.1

14±0.5

16

R9

R10

R9

R10

R11

R4

R4

25

R4

R8

7

R4

R4

65°

R4

R5

R14

15.1

R4

R4

R4

R4

R4

R4

R4

R4

R4

R4

R4

R4

R4

R4

R4

16

R9

R10

R9

R10

R11

R4

R4

25

R4

R8

7

R4

R4

65°

R4

R5

R14

15.1

R4

R4

R4

R4

R4

R4

R4

114±0.1

94.5

35.5

114±0.5

15±0.1

53±0.05

12

M4.2x

TITLE P 228

DATE Mar 8.95

DRAWN

APPROVED

MATERIAL A356-T6

SCALE

DRAWING NUMBER 2 OF 9

DRAWING NUMBER

FILE

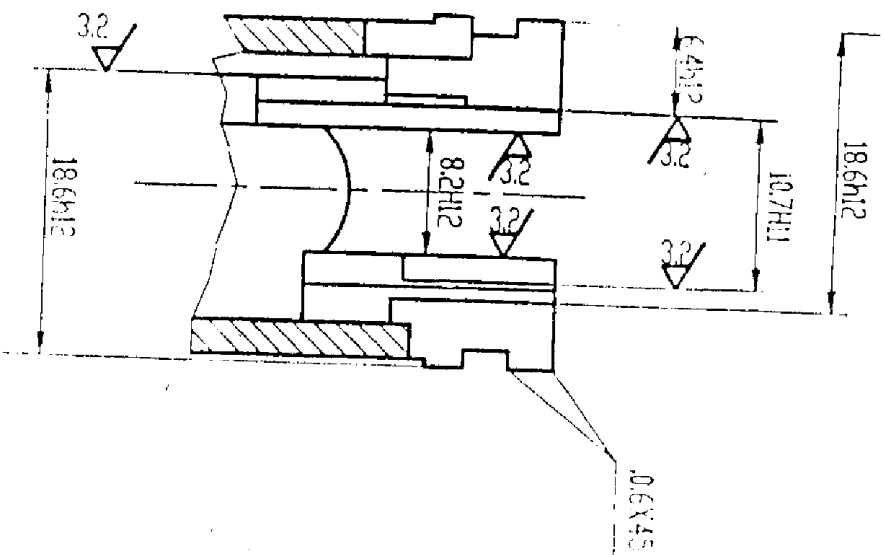
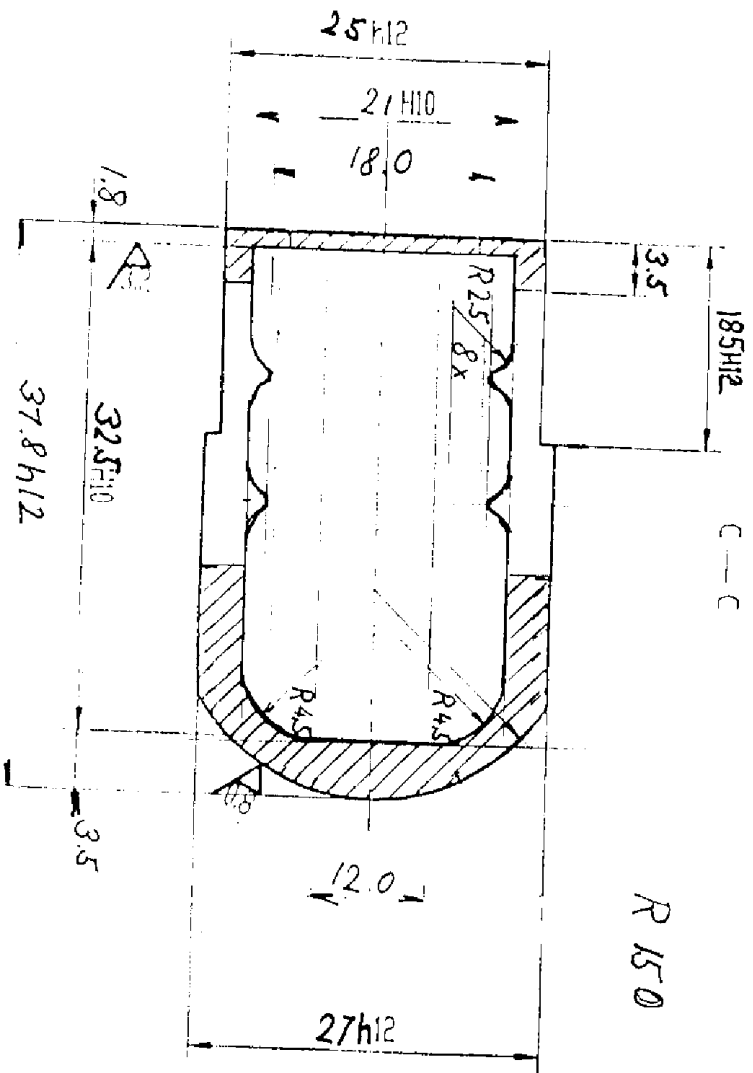

TITLE P 228

Nov 8. 95

DATE DRAWN APPROVED MATERIAL SCALE

ASS6-76

9 of 9

DRAWING NUMBER