

LEGENDARY
Communities

"Salem Hill"

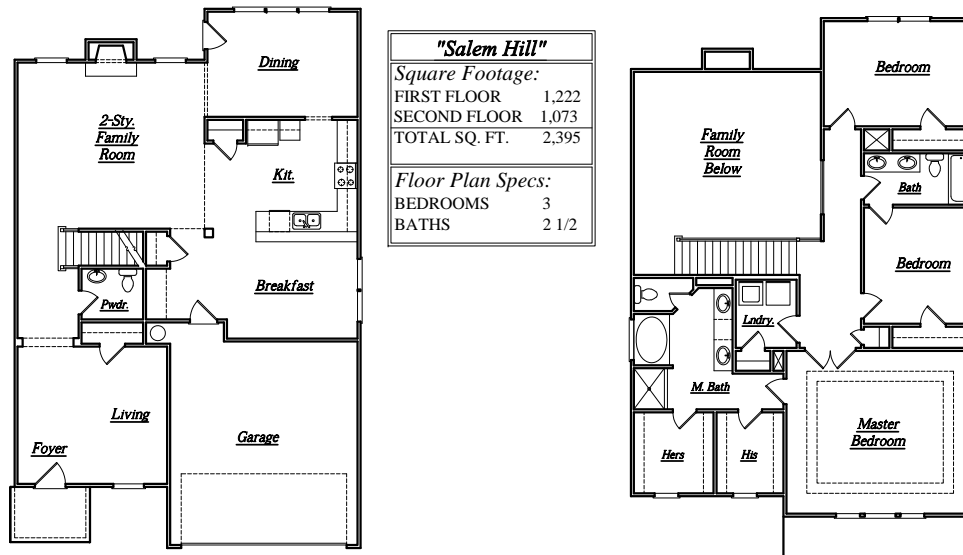

Copyright © 2009 * Floorplans and Elevations are subject to change

NOTICE OF COPYRIGHT LC Phenix City, LLC. THESE PLANS ARE COPYRIGHTED AND ARE SUBJECT TO COPYRIGHT PROTECTION AS ON "ARCHITECTURAL WORK" UNDER SECTION 102 OF THE COPYRIGHT ACT 17 U.S.C. AS AMENDED DEC. 1990, AND KNOW AS ARCHITECTURAL WORKS COPYRIGHT ACT OF 1990. THE PROTECTION INCLUDES BUT NOT LIMITED TO THE OVERALL FORM AS WELL AS THE ARRANGEMENT AND COMPOSITION OF SPACES AND ELEMENTS OF THE DESIGN UNDER SUCH PROTECTION. USE OF THESE PLANS, WORK, OR FORMS REPRESENTED CAN LEGALLY RESULT IN THE CESSION OF SUCH CONSTRUCTION, OVERBUILDING, REBUILDING, REDESIGNING, OR RE-TRADE.